

WIND RIVER

2023-24 Catalog



less can be more luxury can be affordable



Wind River homes are designed and built for beauty and function. We use high-quality materials and building processes that are meant to withstand the test of travel and time. Our models are designed for comfort and livability, prioritizing efficiency of space and open floor plans. Below are some key aspects of our Wind River standard:

- » Purpose-built, heavy-duty steel trailer
- » ZIP system structural sheathing vapor and air barrier
- » 4 ML coroplast sheeting under trailer for critter/moisture barrier
- » High-quality, energy star rated metal roof with 30-yr fade and chalk warranty
- » LP SmartSide engineered wood strand siding for superior protection against moisture, chipping, peeling, cracking, hail, wind, or termites (50-yr limited warranty)
- » High-quality, double-paned fiberglass windows for any climate or travel (limited lifetime warranty)
- » Closed-cell, high-density spray foam insulation
- » LG 220V high-efficiency mini-split for heating/cooling (5-yr limited warranty)
- » Takagi on-demand propane hot water heater (15-yr limited warranty)
- » High-quality, name brand appliances and fixtures
- » Solid wood or finish-grade Birch plywood cabinet and built-in construction
- » Exterior-grade Sherwin Williams paint for both exterior and interior

* Items marked with this star are upgrades from our base model options. Prices are listed in our Wind River order form.

Pictured: 32' Etowah with gable roofline, painted Alabaster shiplap walls, Special Walnut stained V-joint ceiling, dark-stained hardwood floors, and black windows.

Toccoa model

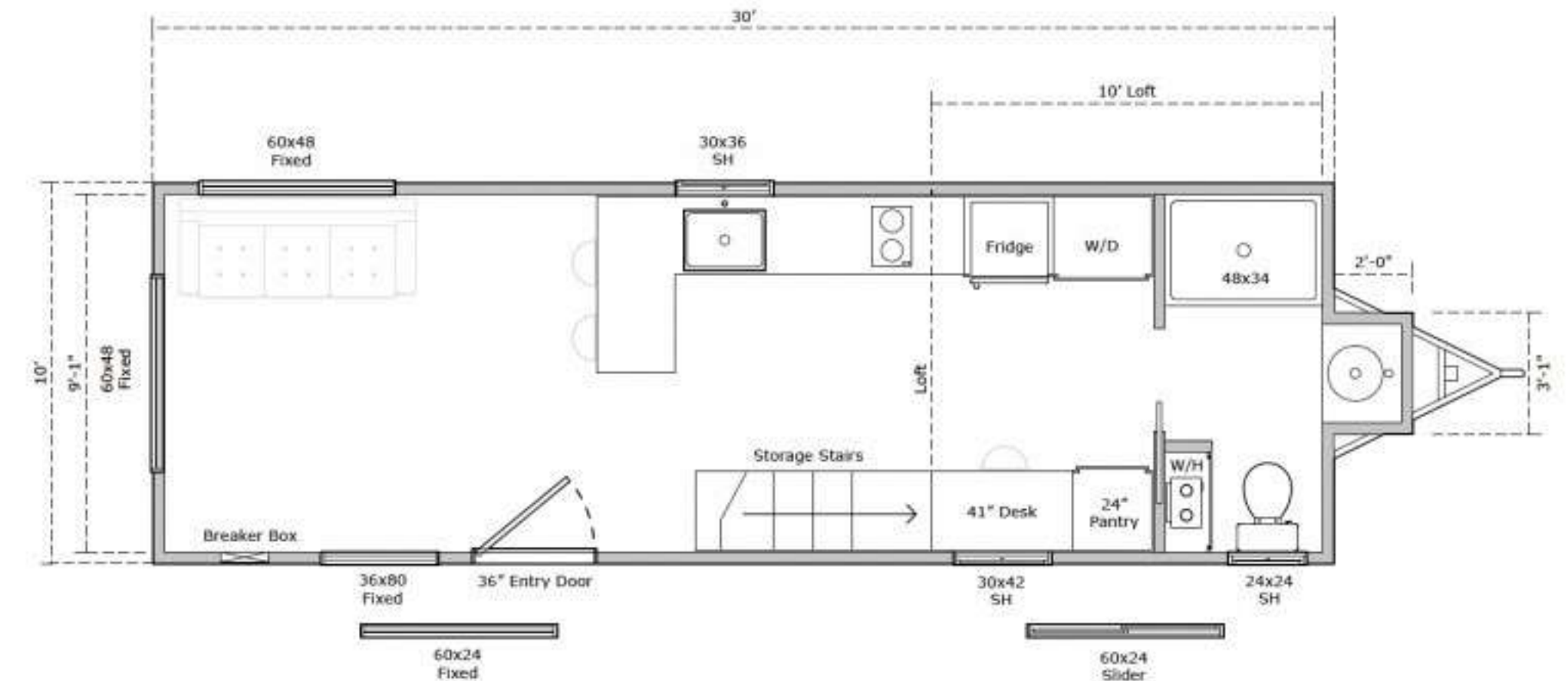

30' Toccoa - Side Entry

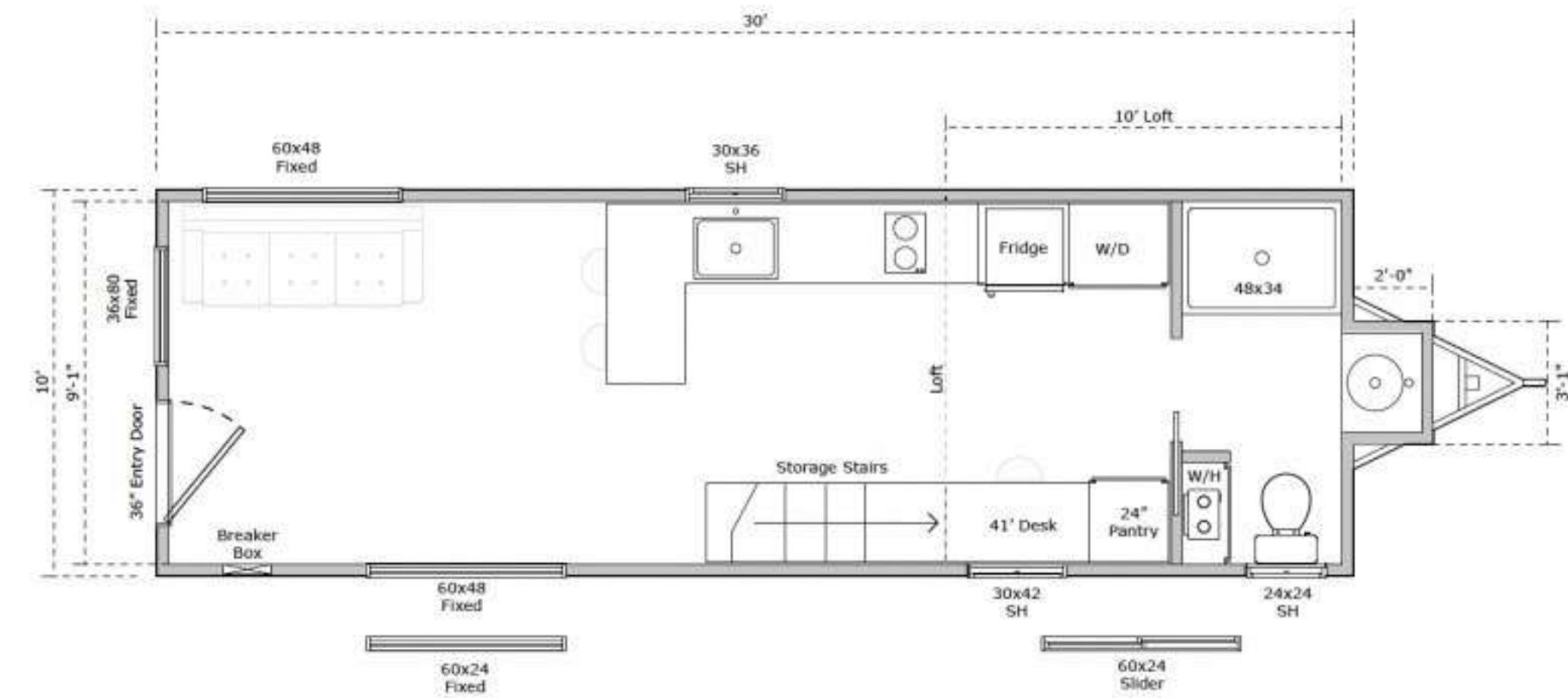
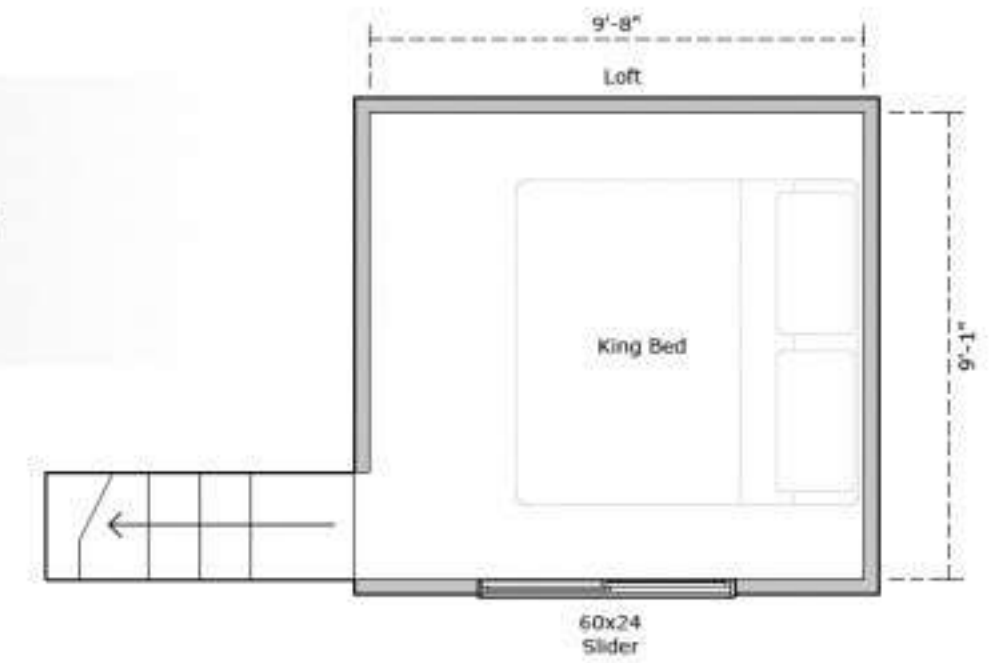

30' Toccoa - End Entry

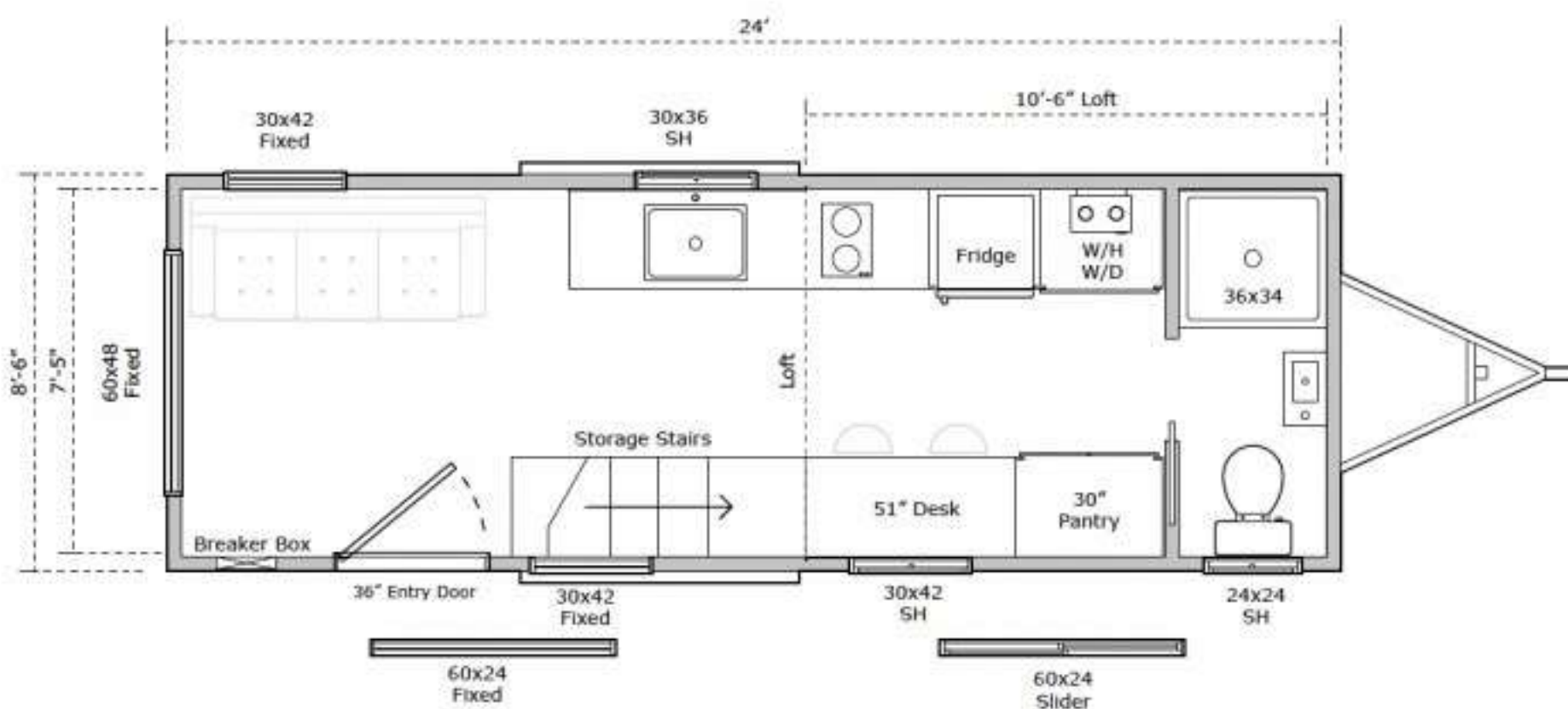
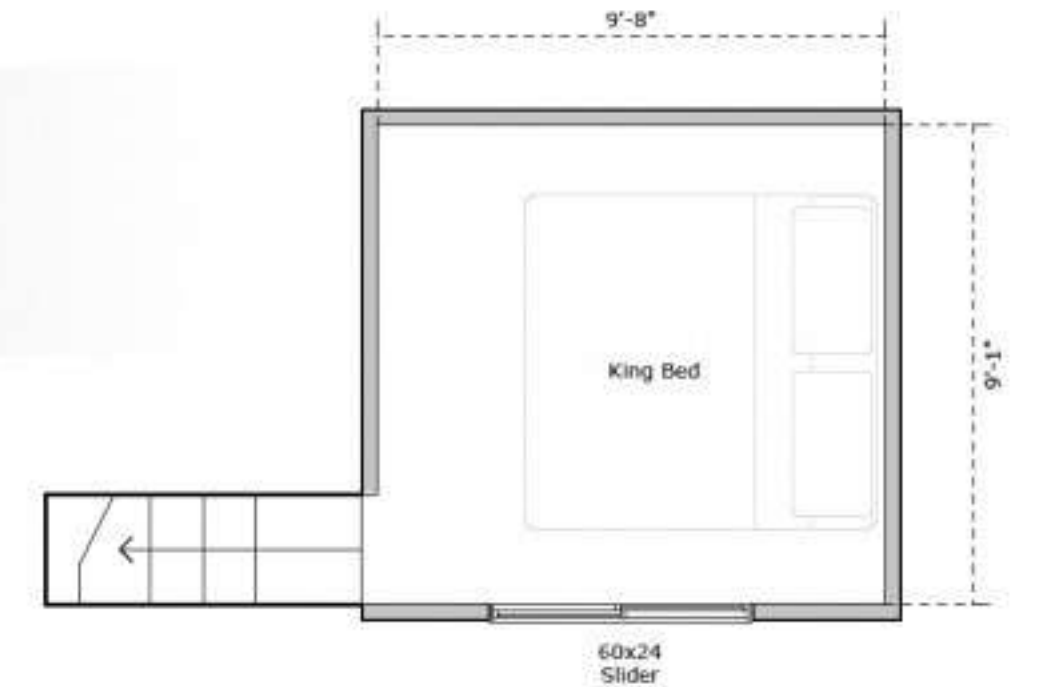

24' Toccoa

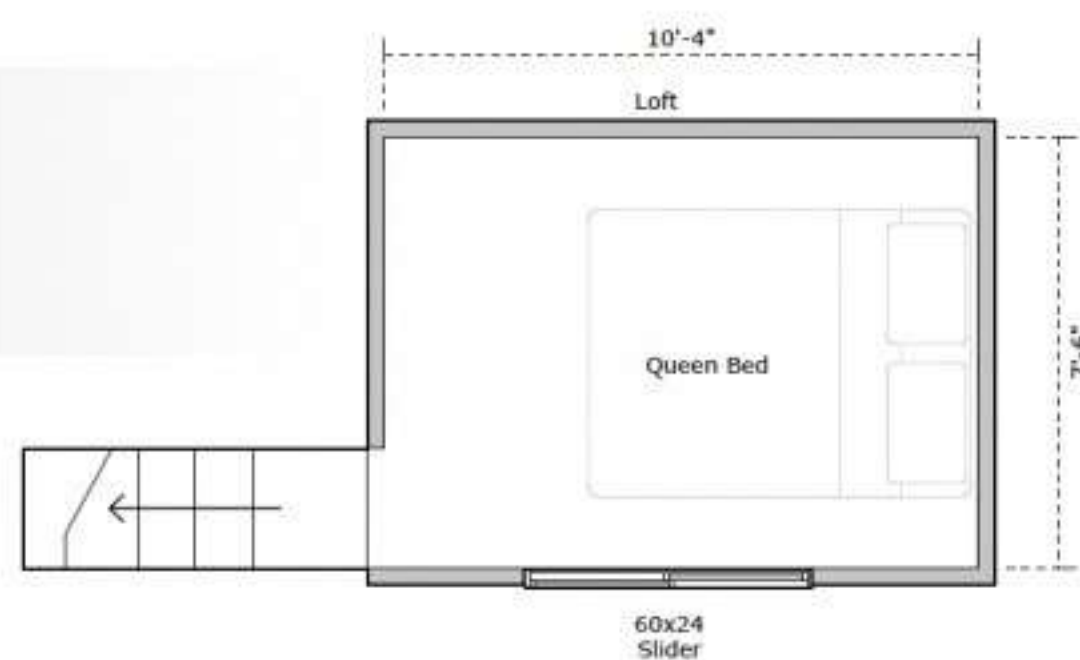

pingora model

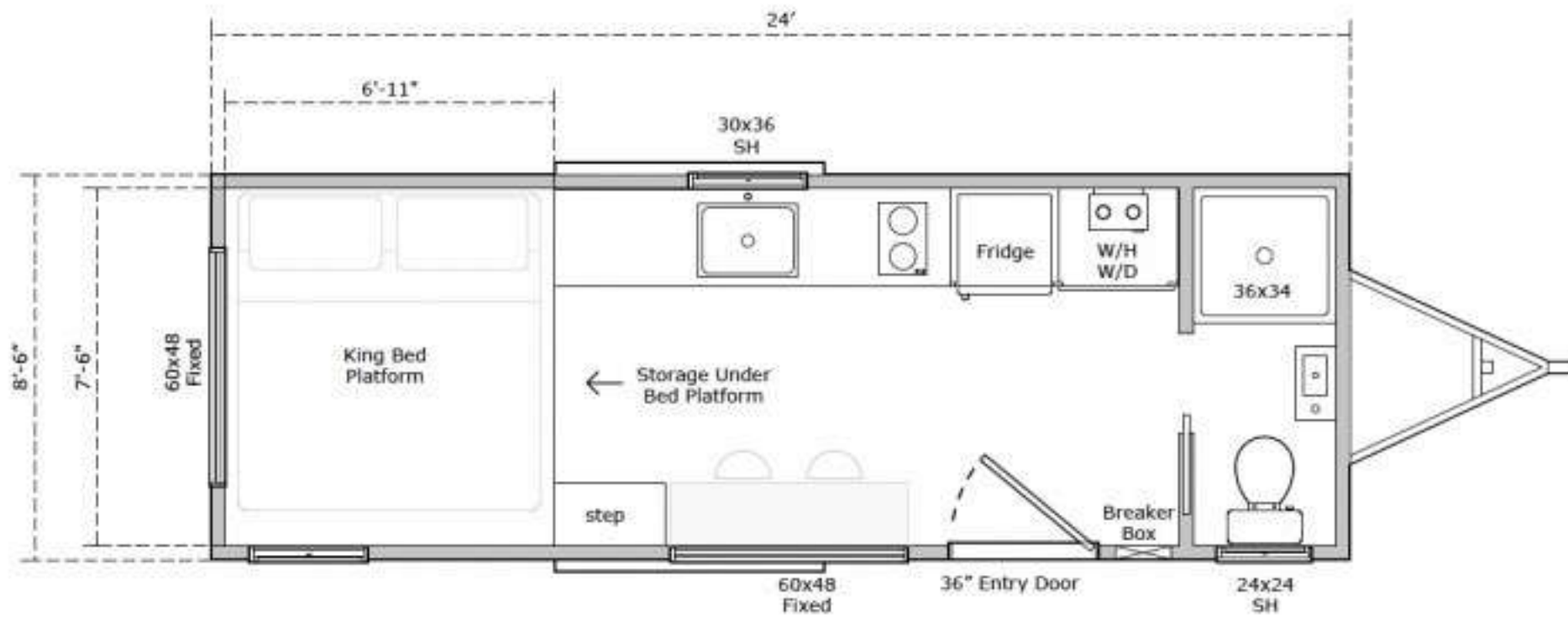

24' Pingora - Bed Platform

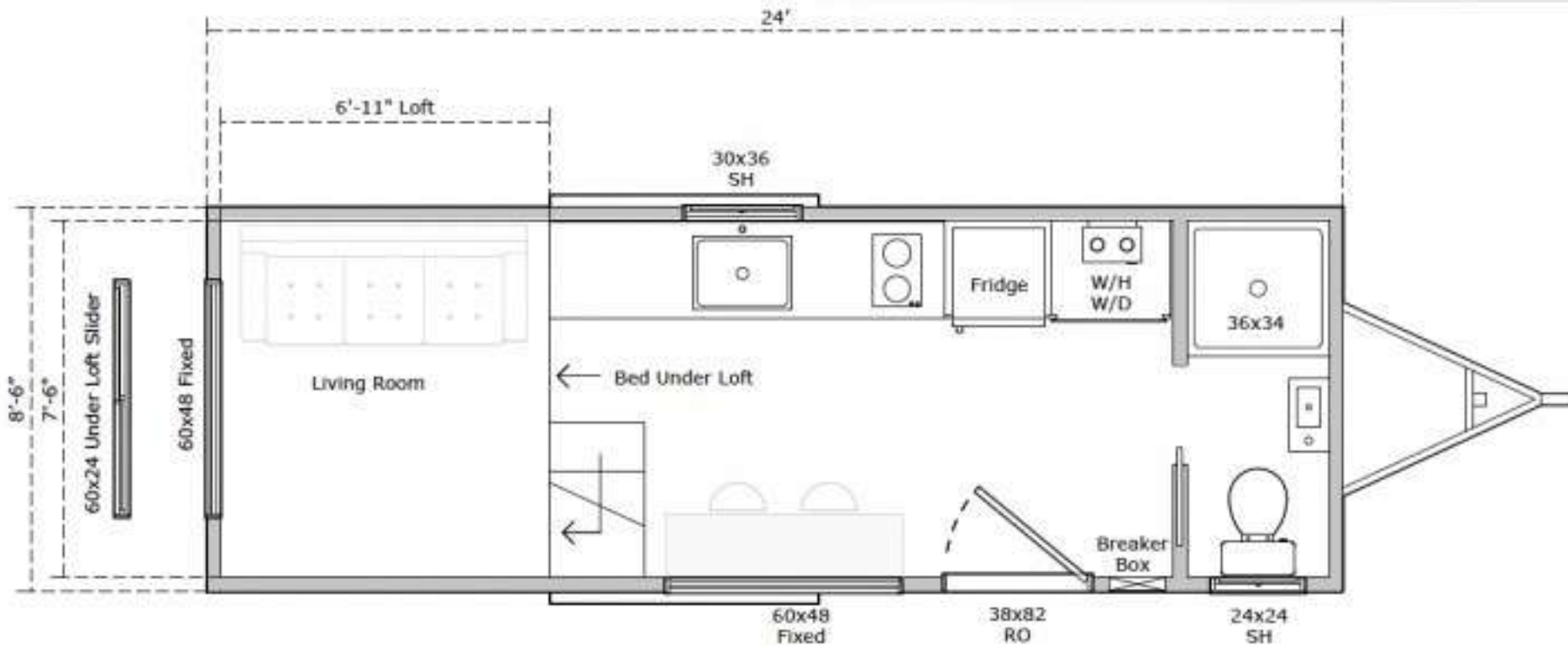

24' Pingora - Reverse Loft

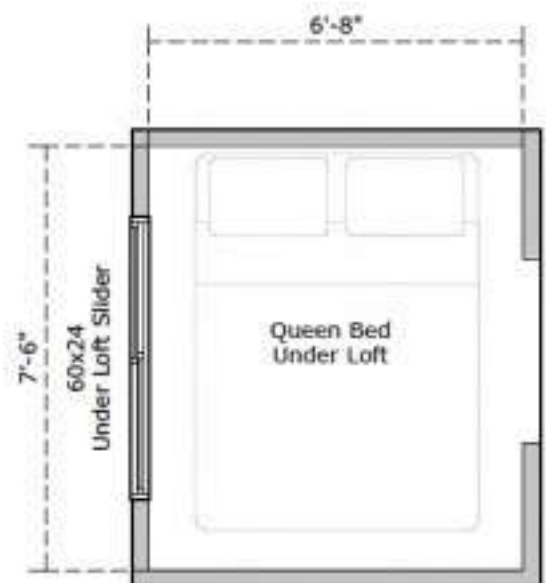

30' Pingora - Bed Platform

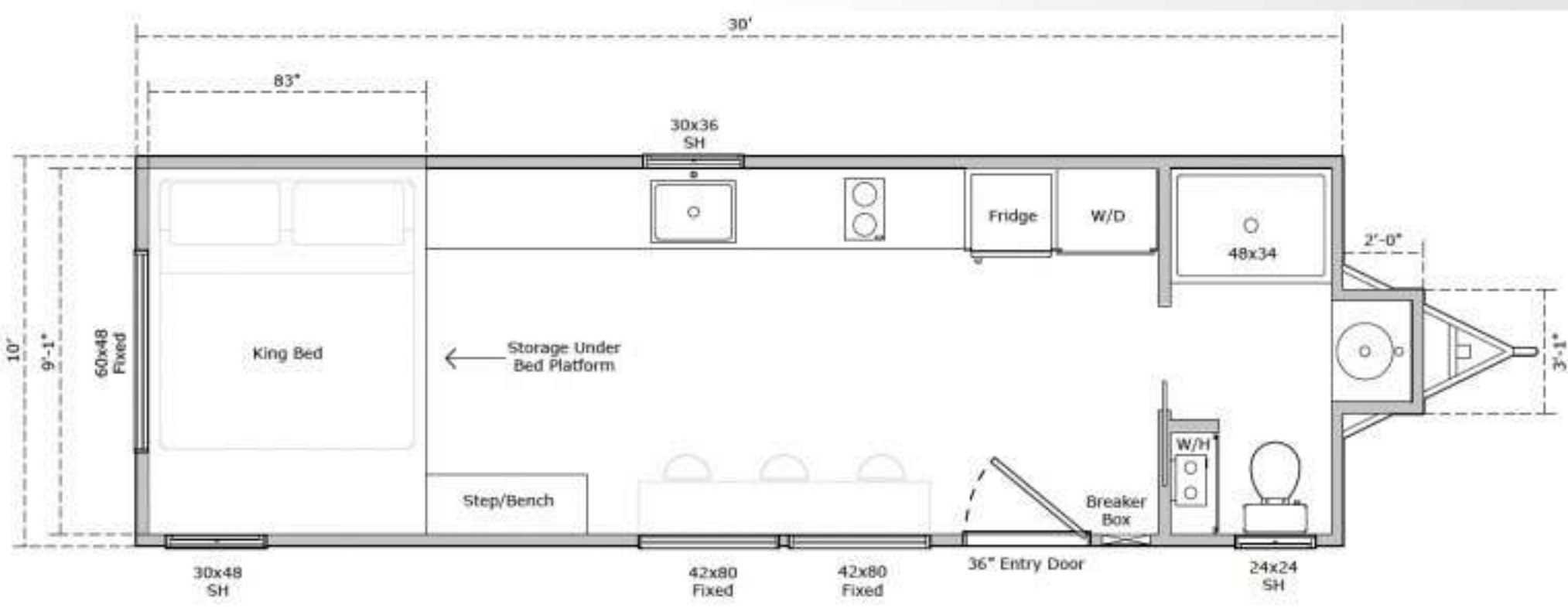

30' Pingora - Reverse Loft

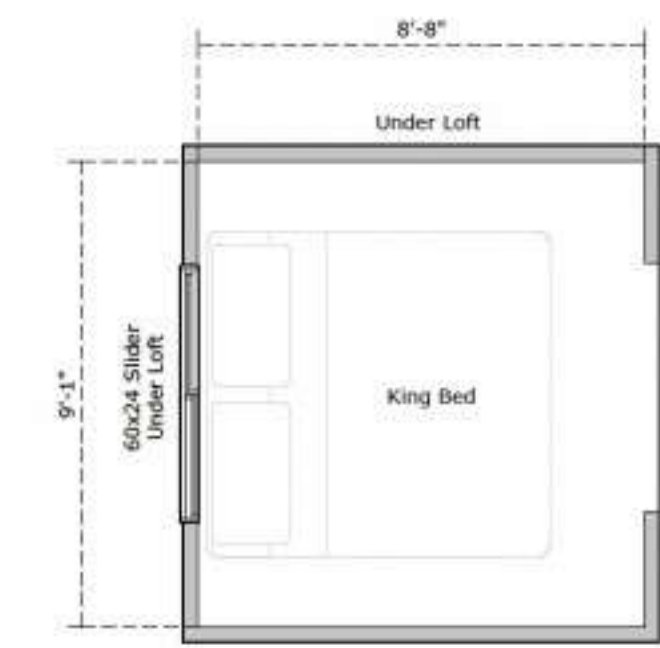
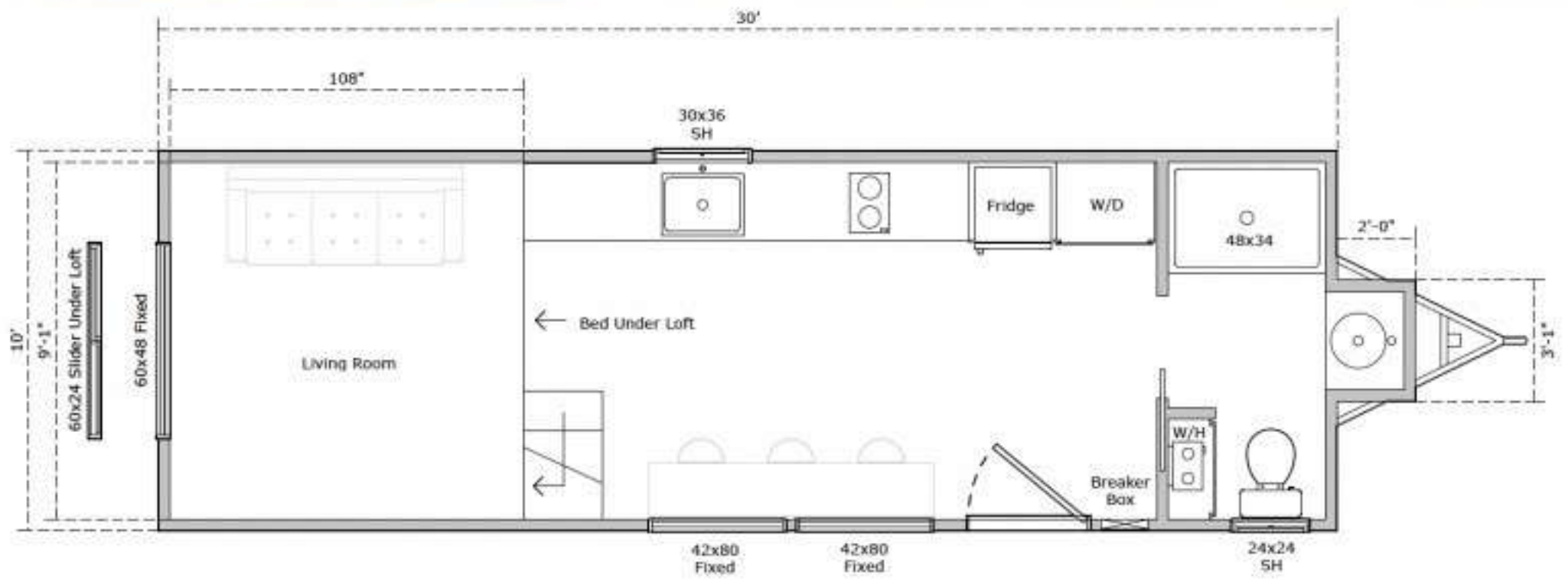

Ocoee model

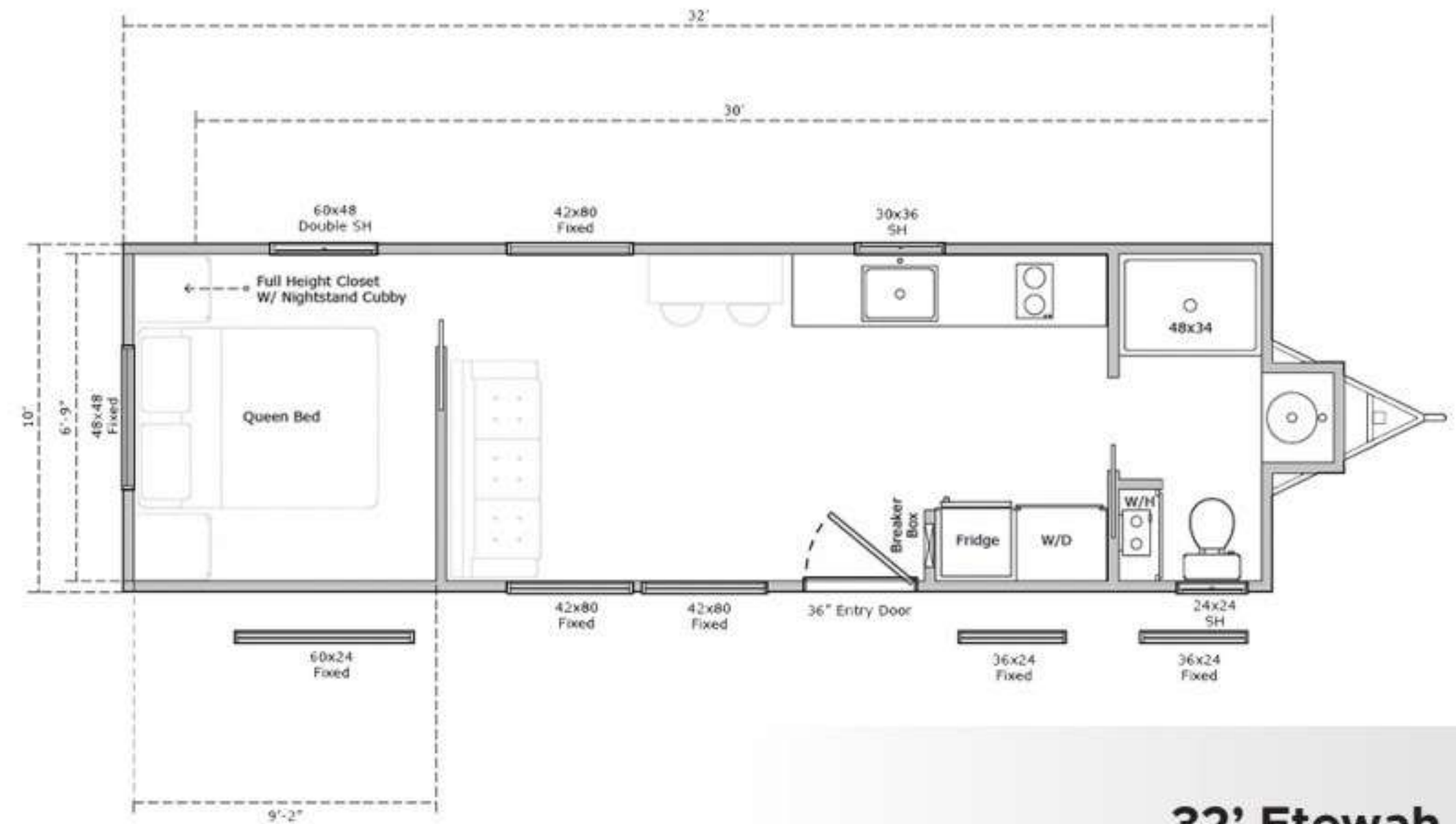

32' Etowah

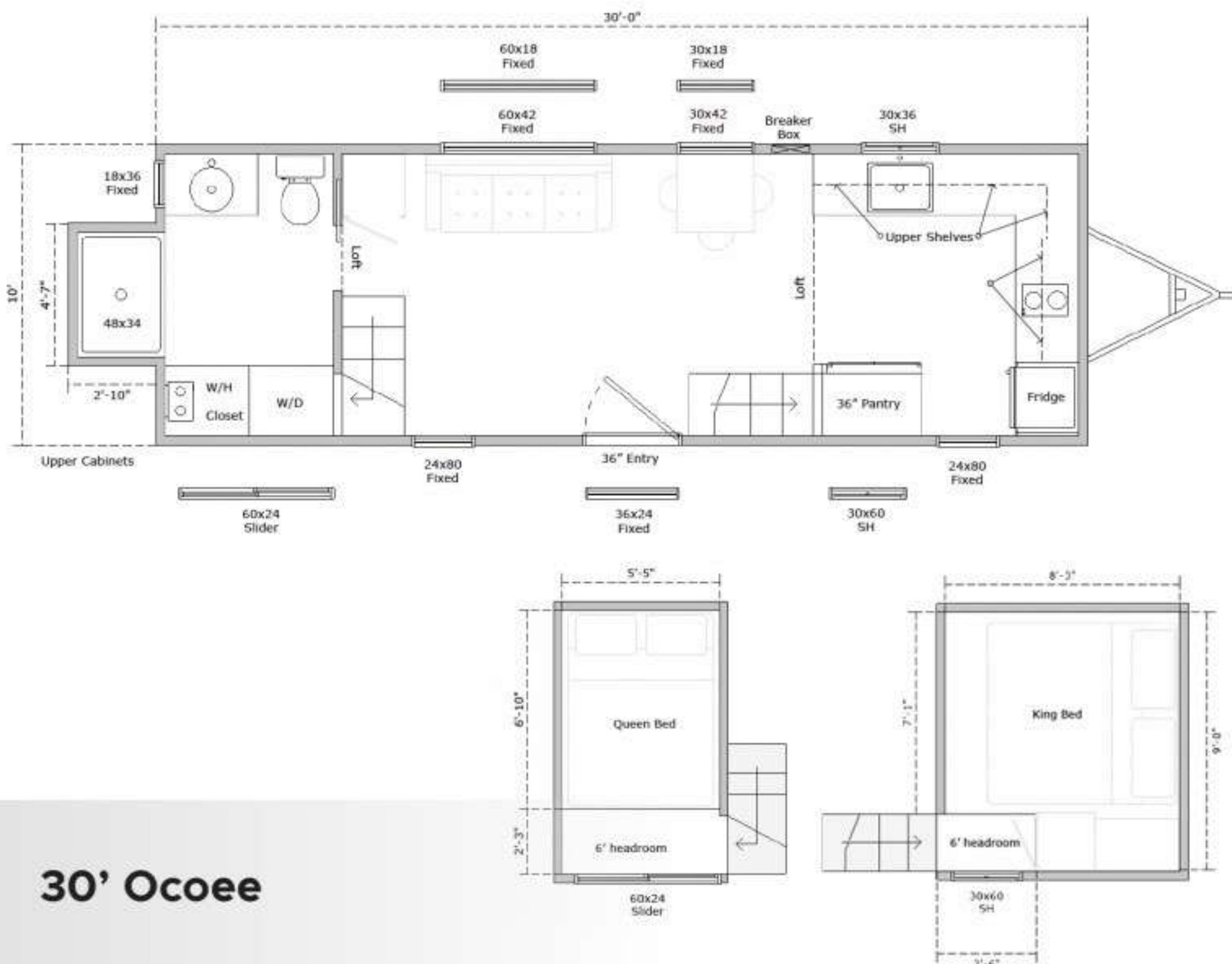

30' Ocoee



etowah model

rutledge model

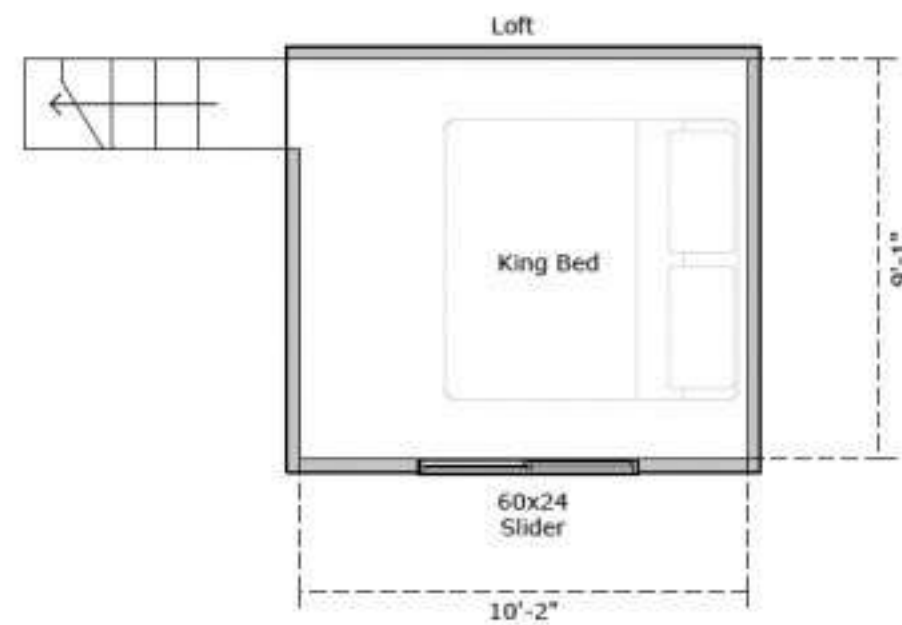
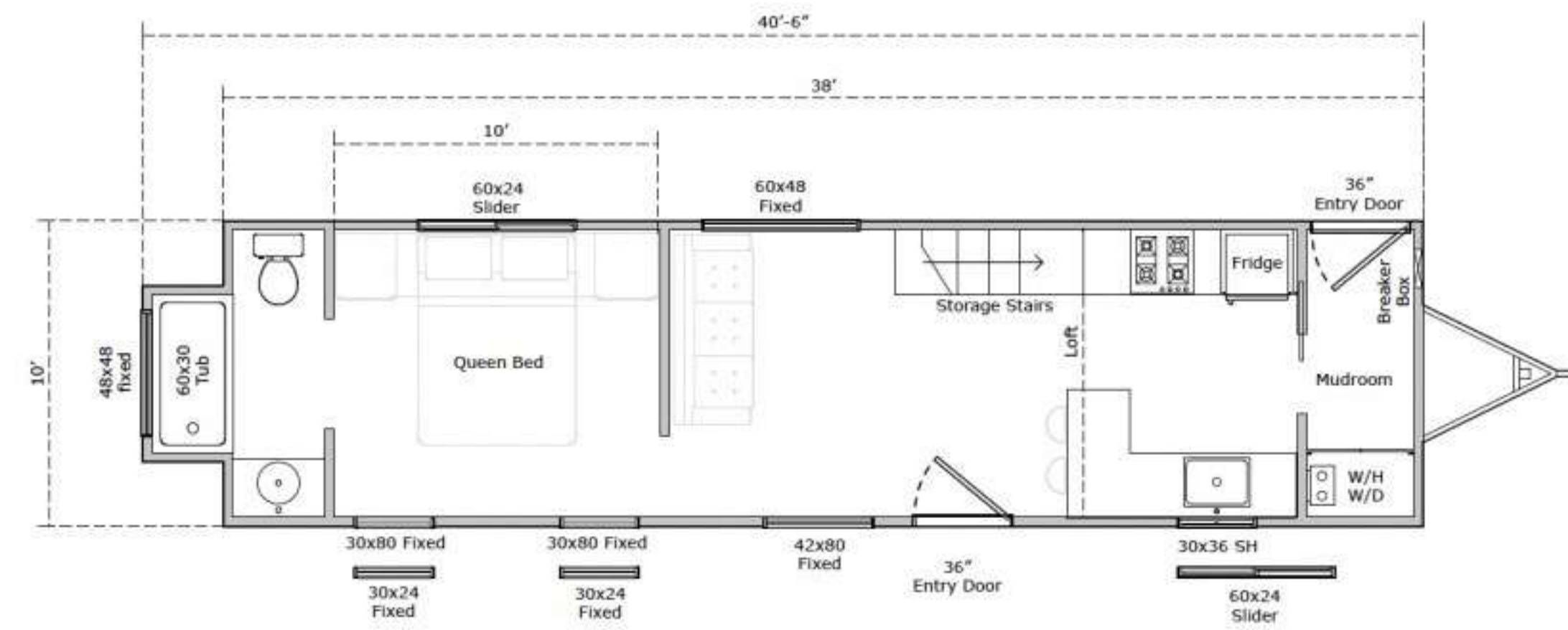

38' Rutledge - Mudroom

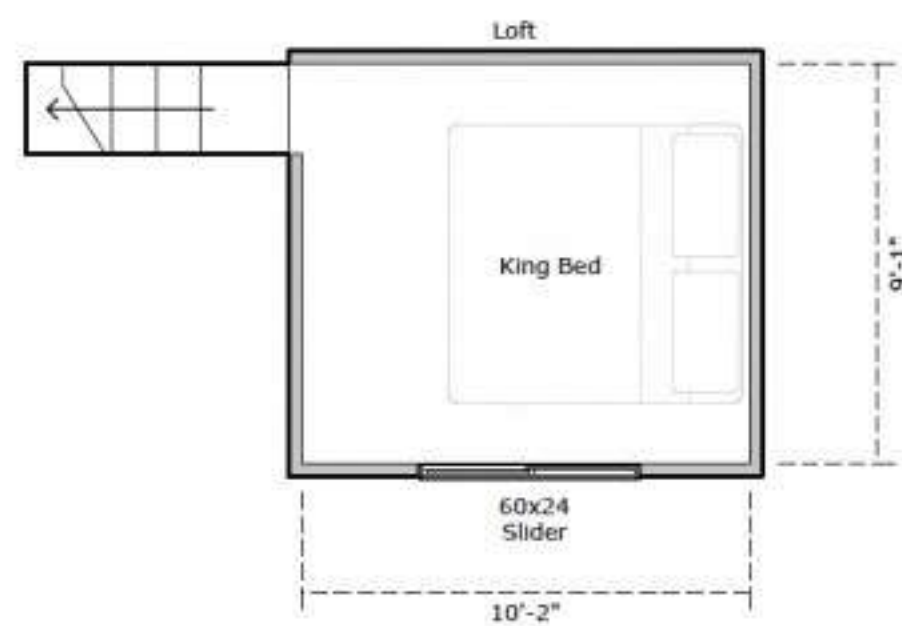
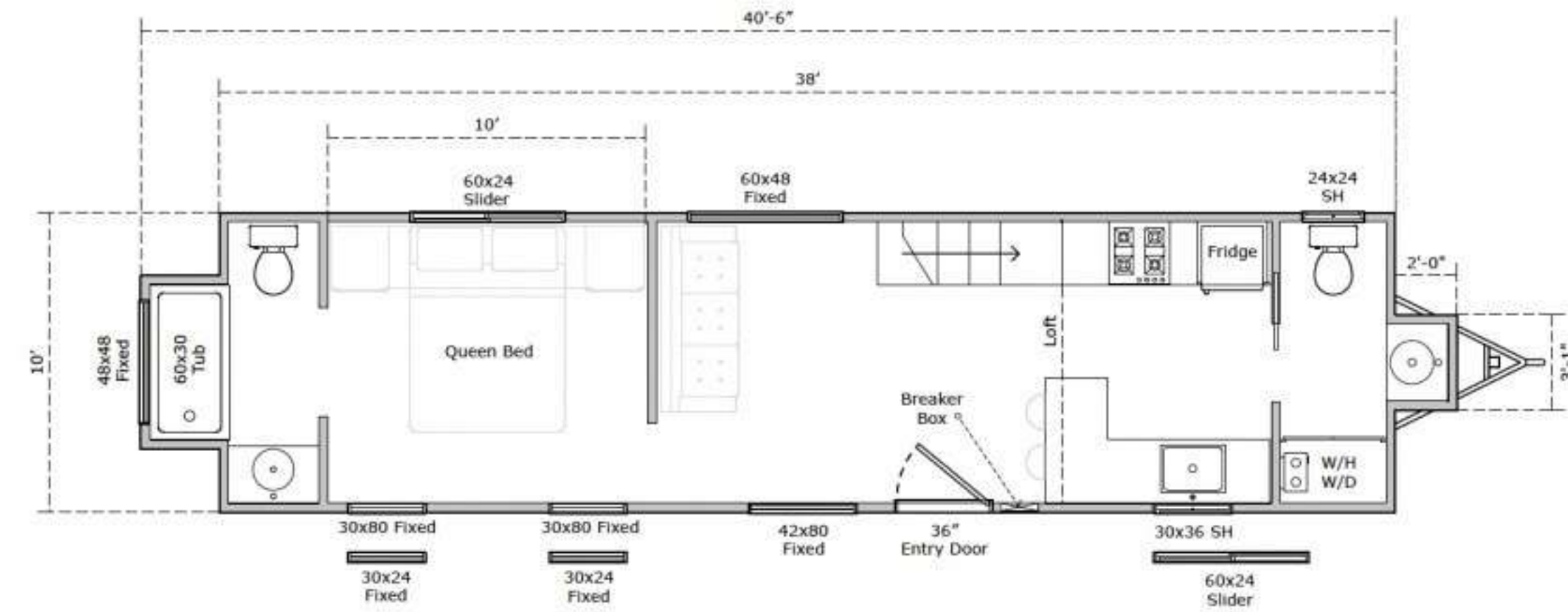

38' Rutledge - Half Bath



brooks model

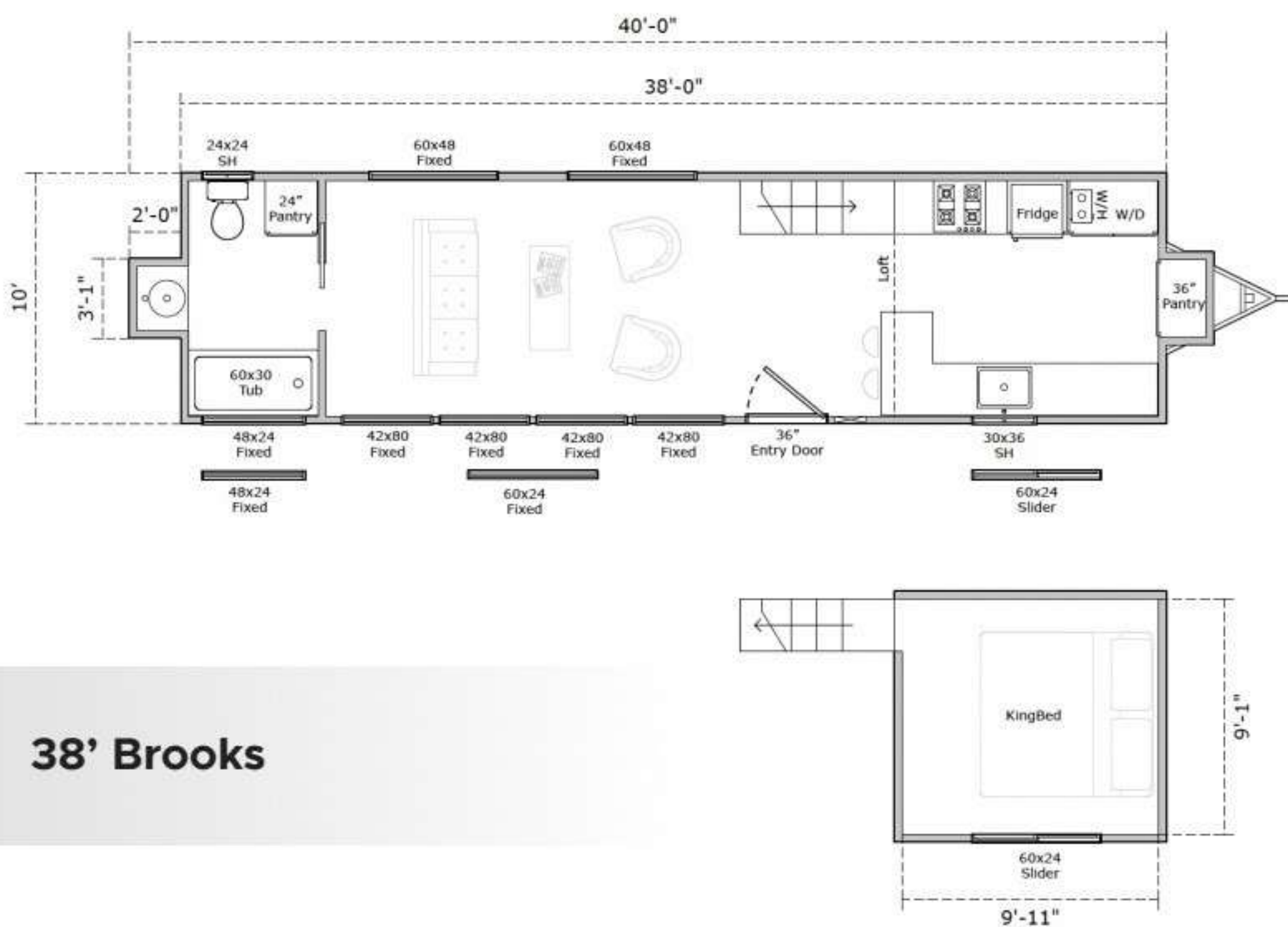

38' Brooks



Pictured: Toccoa with end entry, 50% Country Pine stained smooth panel walls, and a Cubic Mini wood stove (above).

rooflines & colors



Black HD Charcoal HD Bronze HD Barn Red HD

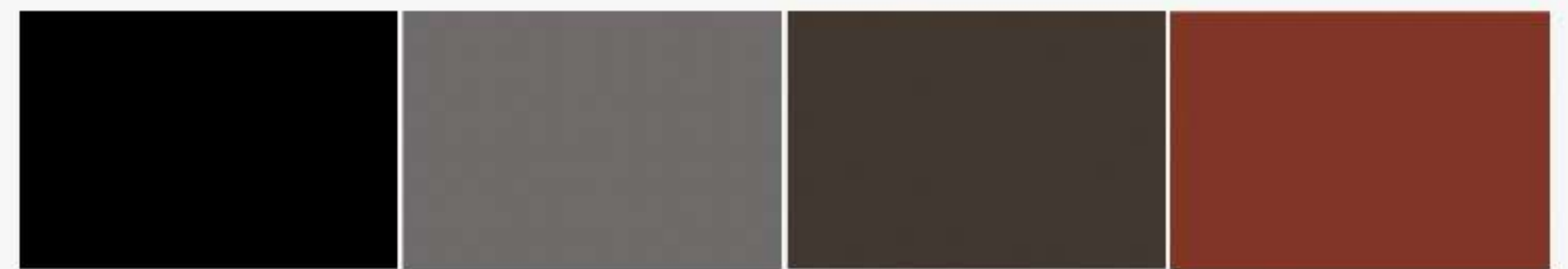

Black Charcoal Bronze Barn Red



Forest Green HD Light Gray Galvalume Copper *

pro tip

When choosing a roofline, consider both aesthetic and function. Any of our rooflines can suit your style when strategically paired with other exterior materials, but a well-chosen roofline can heighten your design. If function is your first priority, consider the roofline that will best suit your interior needs (such as headroom and light).

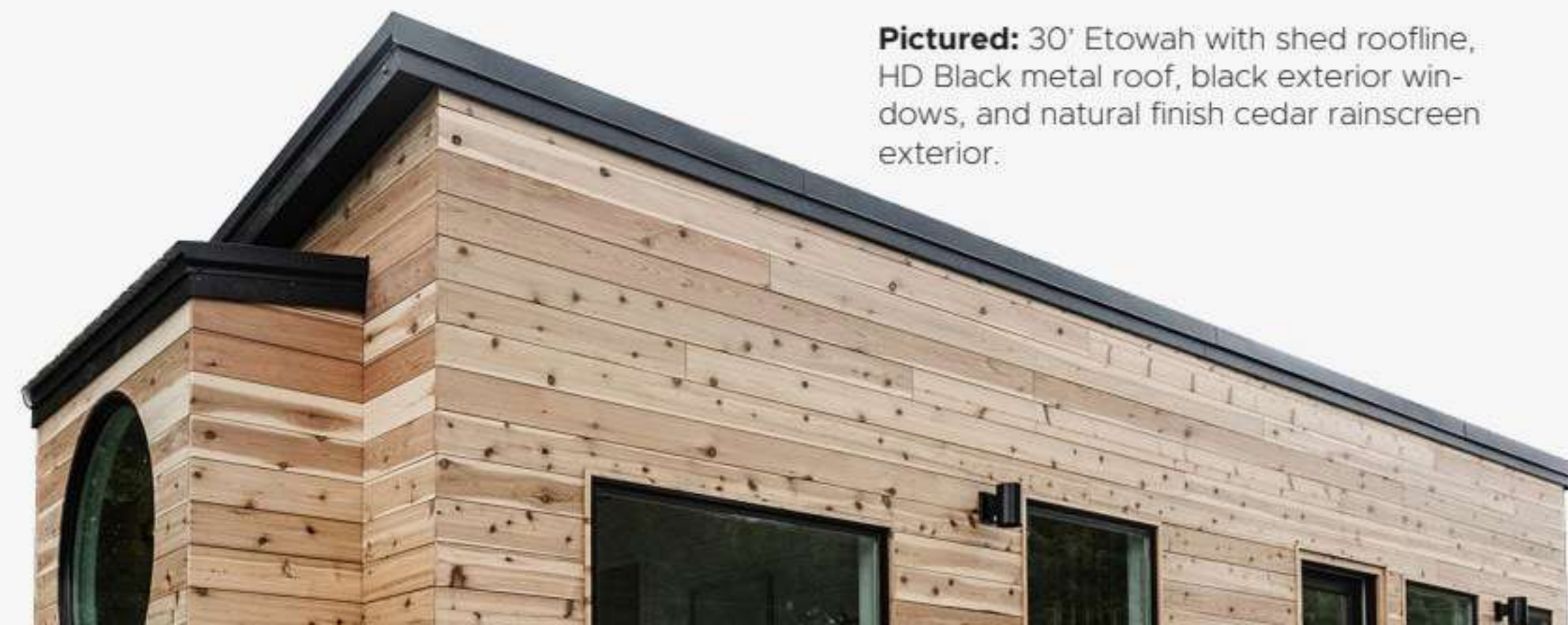

Pictured: 30' Etowah with shed roofline, HD Black metal roof, black exterior windows, and natural finish cedar rainscreen exterior.



siding

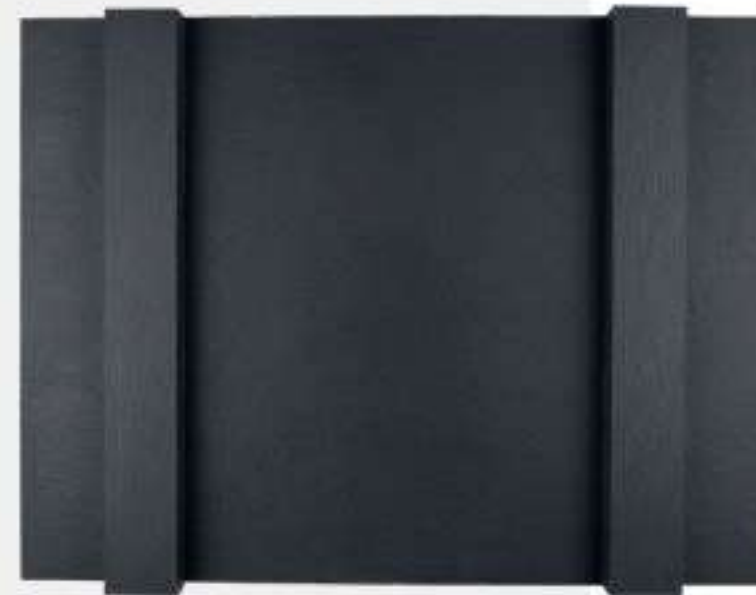

Smooth Board & Batten



Textured Board & Batten



Smooth Lap Siding



Textured Lap Siding

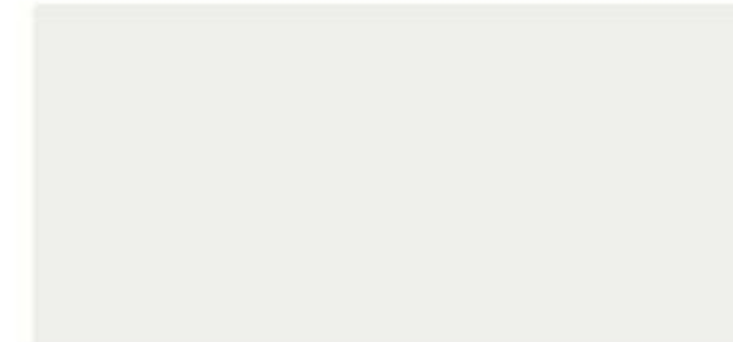

Extra White



Snowbound



Alabaster



Thunderous

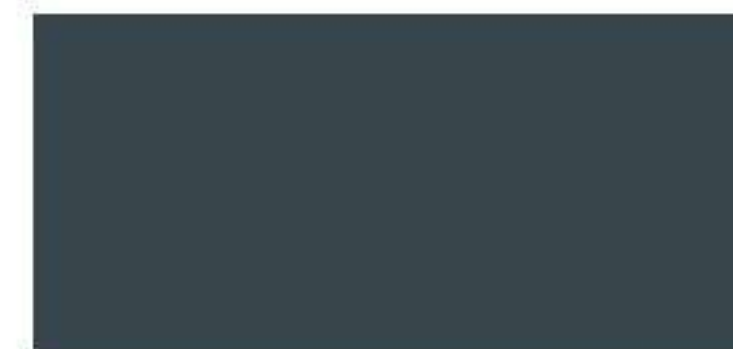

Gale Force



Urbane Bronze



Rock Bottom



Iron Ore

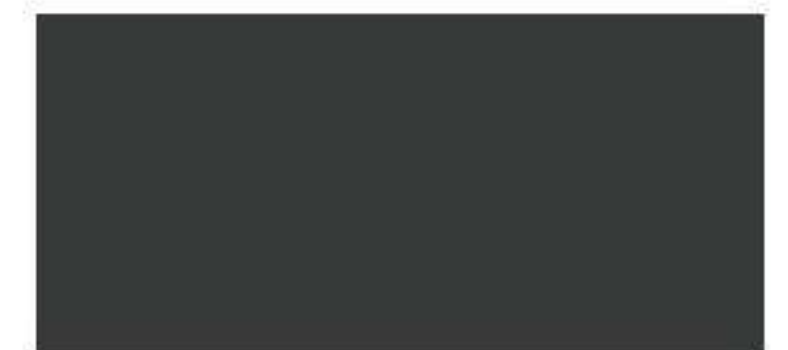

Greenblack

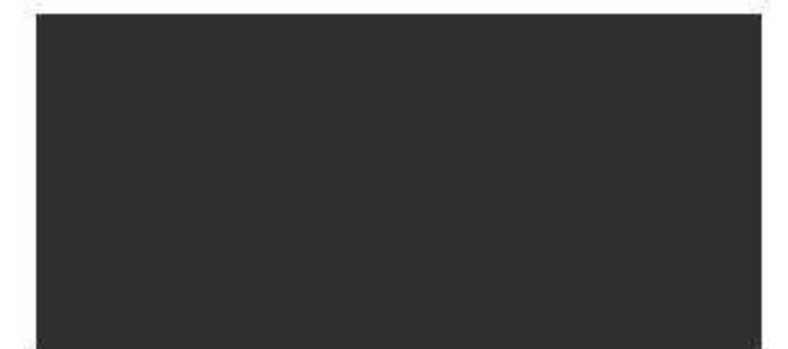

Caviar

Pictured: LP smooth board & batten siding in Iron Ore.

accents*

An exterior cedar accent—small or large—is a great way to add interest and an organic, natural feel to the exterior of your tiny home. Shown here are some of our favorite stains and examples of exterior accents. We offer small or large accent options for each model to fit your desired look and budget, as well as a variety of stain options to coordinate with your exterior palette.

Natural Cedar

Oxford Brown semi-trans

25% Oxford Brown



pro tip

For a striking contrast, orient your cedar accent the opposite direction as your siding (vertical for lap siding, horizontal for board & batten) and choose a color that is noticeably lighter or darker than your siding. For more subtle interest, orient your accent the same as your siding and choose a color similar in tone—this will still provide beautiful contrast with the natural wood grain and texture.

Fresh Brew

Hidden Valley semi-trans

Hidden Valley semi-solid

Black semi-solid



Pictured: 38' Rutledge (top right) with LP smooth lap siding in Urbane Bronze and 25% Oxford Brown vertical cedar accent. 24' Pingora (bottom right) with LP board & batten textured siding in Black Fox and Hidden Valley horizontal cedar accent.

windows & doors



Pictured: 30' Etowah with shed roofline, Galvalume metal roof, LP lap siding in Sierra Redwood with natural finish cedar rainscreen, and black exterior windows.

We use Marvin Essential fiberglass windows for all of our Wind River tiny homes. Fiberglass offers superior durability and energy efficiency, and resists fading, peeling, or cracking. Our sliding doors are Marvin Elevate. All other entry doors are custom made by Aluma Window Co. and are high-quality fiberglass with minimal molding.

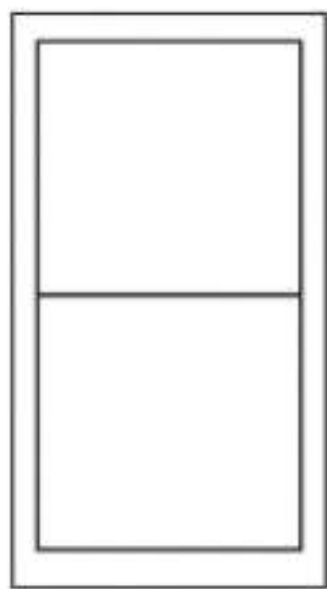

No Grids

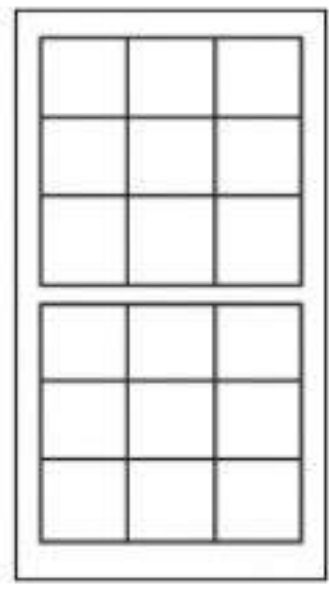

Grids *

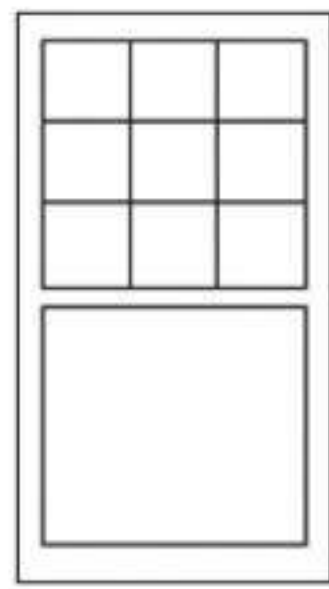

Half Grids *



Quarter Light

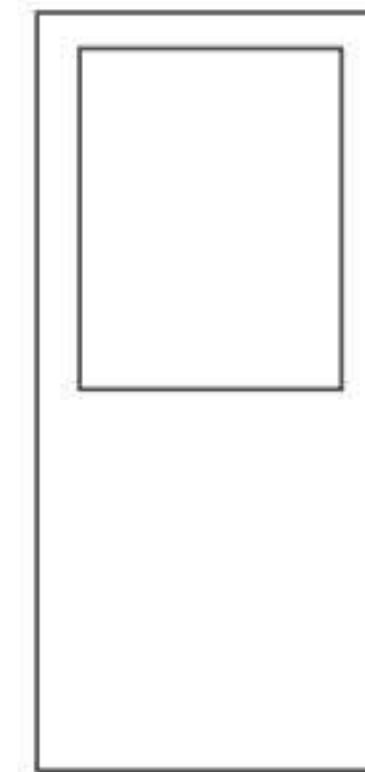

Half Light

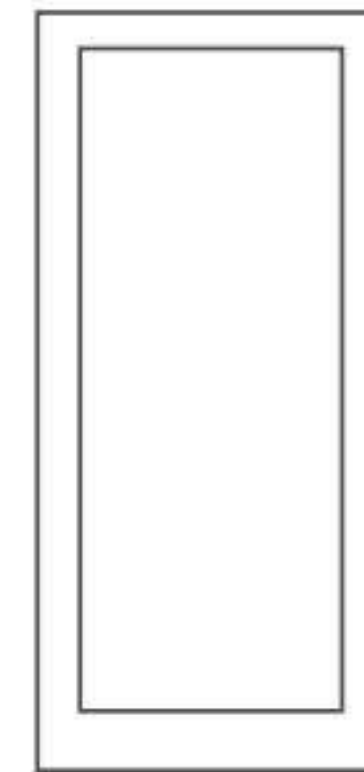

Full Light *



Stone White



Ebony *



Bronze *

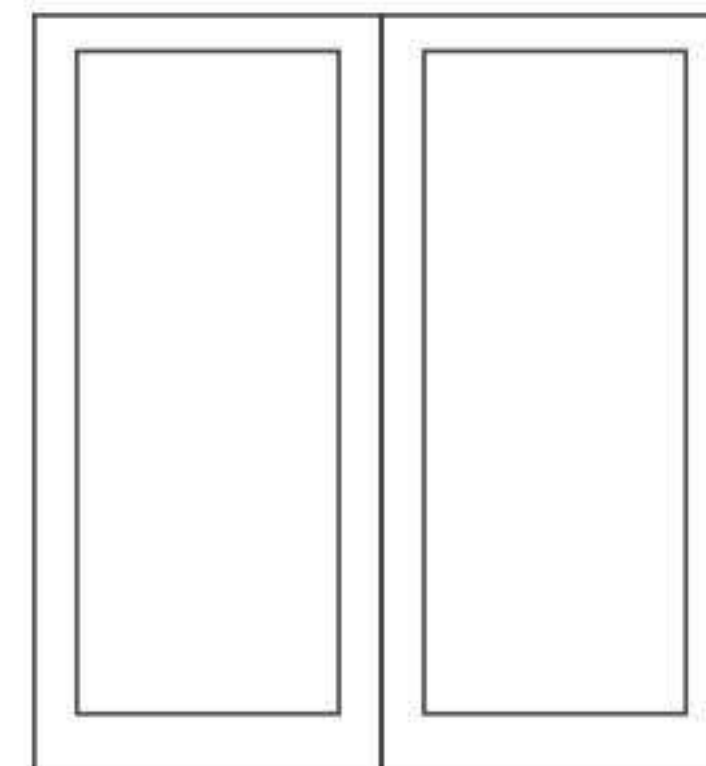

French Door *

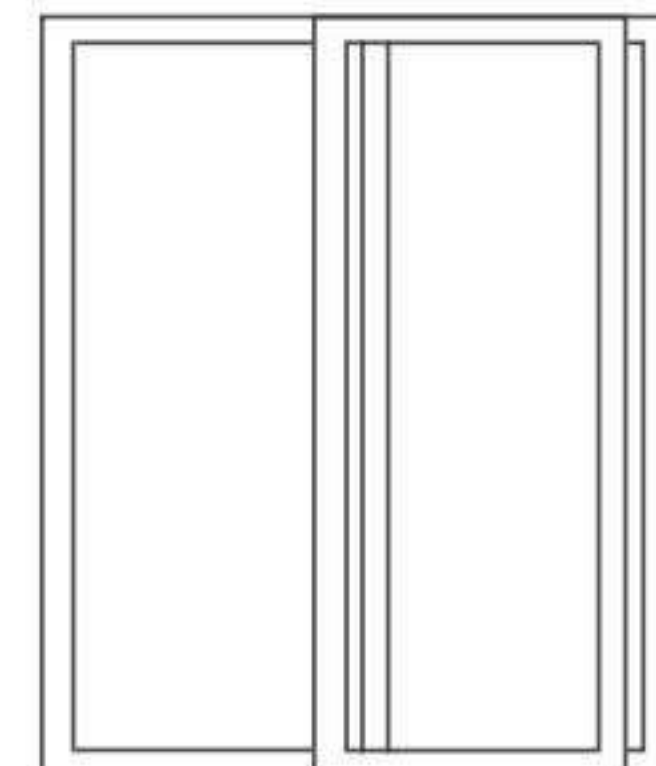

Sliding Door *

exterior hardware & fixtures

We use Schlage exterior door hardware and locks. A classic deadbolt is standard, but we also offer keyless entry upgrade options. For exterior lighting, we offer a variety of styles and finishes. You can also opt to install exterior lighting after you receive your home—the necessary rough-in box(es) and wires will be in place.

**Please note that fixture and hardware availability can change without notice. If we are unable to source the option you have chosen, we will offer you similar alternatives to choose from.*

Modern Exterior Sconce



Black
Silver



Black
Silver



Black
White
Silver

Custom Copper Outdoor Shower



Schlage Century Handleset



Matte Black
Aged Bronze
Satin Chrome
Satin Nickel

Matte Black
Aged Bronze
Satin Chrome
Satin Nickel

Traditional Exterior Sconce



Black
Galvalume



Black



Black
Bronze

Schlage Keyless Entry *



Matte Black
Aged Bronze
Satin Chrome
Satin Nickel

Pictured: 24' Toccoa with Alabaster painted shiplap and trim, white interior windows, Special Walnut stained v-joint ceiling, and stainless appliances.



walls & ceiling

Because our tiny homes are mobile, we do not use heavy sheetrock that is prone to cracking. All of our interior skins are wood and applied in a manner that allows for shrinking and expansion—and to withstand jostling and movement during travel. Our nickel-gap shiplap and V-joint tongue & groove are Spruce, and our smooth panels are Birch finish-grade plywood (applied with carefully planned shadow gaps). We use Minwax for all of our interior stains and offer a wide variety from light to dark.

For our paints, we use high-quality, exterior-grade paint from Sherwin Williams. Our standard options are Bright White and Alabaster (soft white), but we're happy to accommodate custom colors if you provide us the color code and necessary information.



Pictured: 24' Pingora with Alabaster painted shiplap walls, Special Walnut V-joint ceiling, and additional loft.



Stained Shiplap



Clear Poly



15% Hedgewood



50% Country Pine



Golden Oak



Hedgewood



Country Pine



Early American



Special Walnut



Sawyer



Provincial



English Chestnut



Dark Walnut



Espresso



Walnut



Black Gel Stain

Stained Smooth Panel



Alabaster



Clear Poly



15% Hedgewood



50% Country Pine



Golden Oak



Hedgewood



Country Pine



Early American



Special Walnut



Sawyer



Provincial



English Chestnut



Dark Walnut



Espresso



Walnut



Black Gel Stain

V-joint Tongue & Groove



Alabaster



Clear Poly



15% Hedgewood



50% Country Pine



Golden Oak



Hedgewood



Country Pine



Early American



Special Walnut



Sawyer



Provincial



English Chestnut



Dark Walnut



Espresso



Walnut



Black Gel Stain



Pictured: 30' Toccoa with Country Pine stained shiplap walls, Maibu Wide Plank Boca Raton flooring.

Pictured: 30' Ocoee with Malibu Wide Plank Point Reyes flooring, storage stairs, black flat panel cabinets, and butcher block countertop.



pro tip When choosing your hardwood flooring, you can choose to contrast or coordinate with your interior palette and other wood tones (an exact color-match is never possible as different woods take stains differently). Consider whether you want a classic look or to make a statement with a more trendy or modern aesthetic. You'll also want to consider lifestyle concerns—darker wood floors tend to show scratches more easily, while lighter wood floors are more likely to show dirt or hair and require more frequent cleaning.

flooring

All of our Wind River homes have 3/4-inch solid hardwood flooring—superior in both look and durability to engineered alternatives. Our three preferred brands offer a variety of tones and character to suit any style. As with all our interior skins, we nail down our hardwood flooring to allow for movement during the travel of your home.

**Please note that flooring options can change without notice. If we are unable to source the option you have chosen, we will offer you similar alternatives to choose from.*

Malibu Wide Plank



Pelican Hill



Point Reyes



Point Paradise



Pebble Beach



Solana



Ocean City



Antique Lace



Buttermilk



Ancient Arrow



Sandal



Wood Chip



Coffee



Golden Beige



Urban Bronze



Kona Oak



Natural



Golden Saddle



Butterscotch



Toasted Almond



Gingersnap



Southside Cliff



Trail Run

kitchen

Pictured: 24' Toccoa (below) with white painted shaker cabinets, butcher block counters, granite composite drop-in sink, and stainless appliances. 30' Ocoee (right) with black and white painted flat panel cabinets, butcher block counters, stainless top-mount sink, and stainless appliances.



We use only high-quality materials and name brand appliances and fixtures in our tiny homes. All of our cabinetry, built-ins, and shelving are built and finished in-house in our cabinet and paint shop. This allows us greater control over function and quality. Our cabinetry is built out of Poplar and Birch—we never use MDF or particle board—and we use high-quality soft-close hinges and drawer rails. Oak butcher block is standard, but we also offer granite and quartz countertop upgrades. We also have upgrade options for appliances (including a full range or full-height fridge).

**Please note that appliance and fixture availability can change without notice. If we are unable to source the option you have chosen, we will offer you similar alternatives to choose from.*

Shaker Cabinets



Extra White



Alabaster



Light French Grey



Caviar



Clear Poly



Early American



Hedgewood



Special Walnut



Dark Walnut

Cabinet Hardware



Traditional Bar Pull

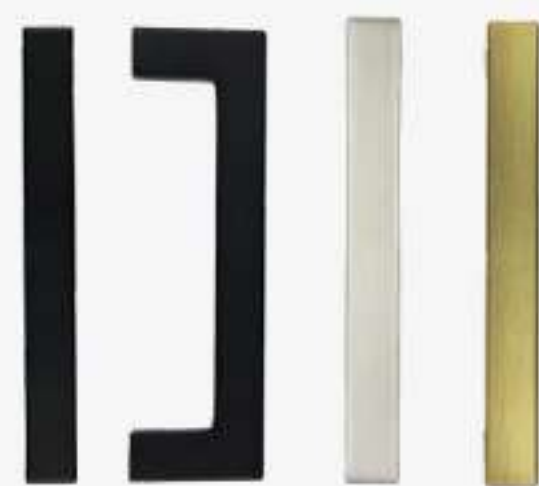

Square Bar Pull



Round Knob

Matte Black
Brushed Stainless
Brushed Gold

Flat Panel Cabinets



Alabaster



Clear Poly



15% Hedgewood



50% Country Pine



Golden Oak



Special Walnut



Hedgewood



Country Pine



Early American



Sawyer



Provincial



English Chestnut



Espresso



Dark Walnut



Walnut



Black Gel Stain



pro tip

Your cabinets should compliment and heighten the design of your home. Either shaker or flat panel cabinets can fit a classic, modern, or rustic design, depending on finish and the interior aesthetic of your home. Consider whether you want your cabinetry to blend with or contrast your walls or floors. We offer four standard paint color options, but you can also choose a custom color if you want to add a pop of color. When choosing your countertops, consider style and function. Butcher block is our standard—both beautiful and cost effective—but does require more care and upkeep than our stone countertop options.

Butcher Block Countertops



Tung Oil



Provincial



Dark Walnut

Stone & Solid Surface Countertops *

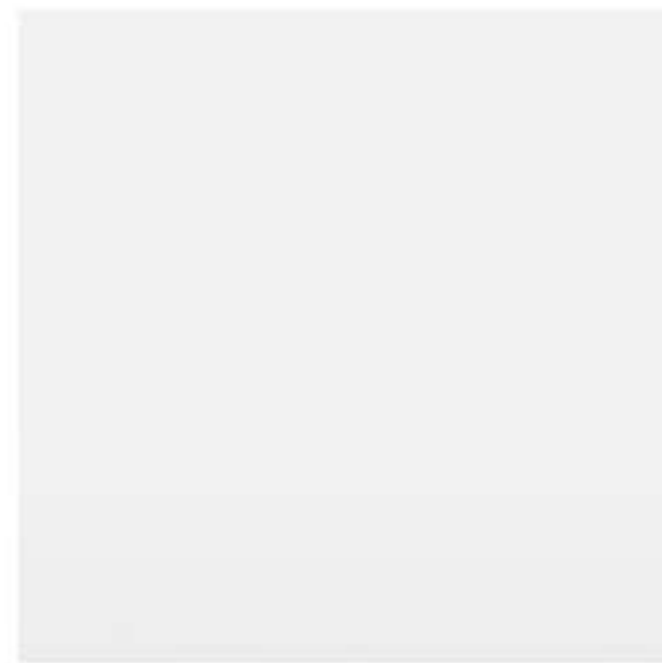

Super White Quartz



Carrara Marble Quartz



Grey Leathered Granite



Black Leathered Granite



Sparkling White Solid Surface



White Jasmine Solid Surface



Neutral Concrete Solid Surface



Wheathered Concrete Solid Surface

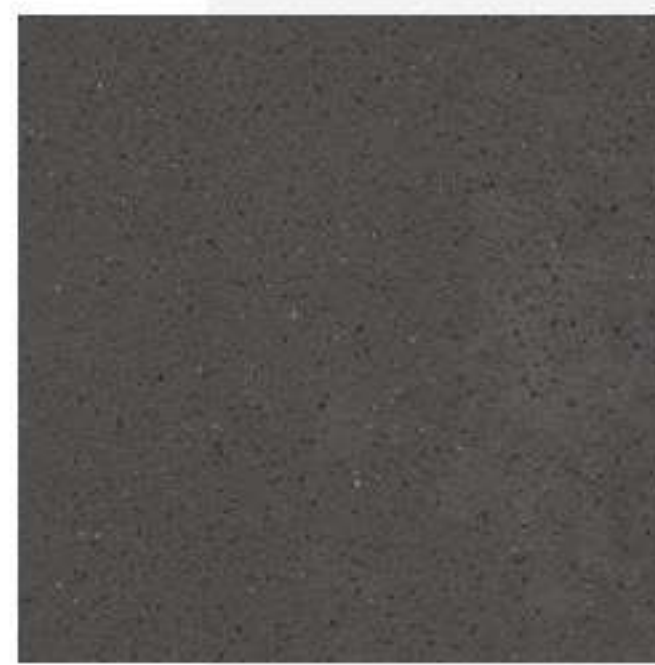

Carbon Concrete Solid Surface

Pictured: 24' Toccoa with 50% Country Pine stained smooth panel walls and flat panel Sawyer stained cabinets, leathered Steel Grey granite, stainless drop-in sink, and black 20" Prestige range.



Granite Composite Sinks



White



Gray



Black

Stainless Sink



Fireclay Farmhouse Sink *



CORIAN®
SOLID SURFACE

SINKOLOGY®

DELTA



Essa



Chrome



Stainless



Venetian Bronze



Matte Black



Chrome



Arctic Stainless



Champagne Bronze



Matte Black



Trinsic



Chrome



Arctic Stainless



Venetian Bronze



Matte Black



Coranto

Open Shelving



Tile Backsplash *



Pictured: 24' Toccoa (above) with Alabaster painted shiplap walls, stainless sink, butcher block counters, and Special Walnut stained open shelving. 30' Ocoee (left) with brightly painted flat panel cabinets, white quartz counters, penny tile backsplash, and stainless appliances.

Summit 2-Burner Electric Cooktop



Black 12"



White 12"



Black 15"



White 15"

Broan 24" Hood Vent



Stainless



White



Black



Summit Gas Cooktop *



Stainless 2-Burner



Stainless 4-Burner

Prestige 20" or 24" Gas Range *



Stainless



White



Black



Pictured: 24' Pingora with Whirlpool 3/4-size fridge, Summit 2-burner electric cooktop, and Summit 20" hood vent.



Whirlpool 3/4 Fridge



Stainless



White



Black

Summit Undercounter Fridge *



White



Black

Summit Full-Height Fridge *



Stainless

bathroom

Like our kitchens, we use only high-quality materials and fixtures in our bathrooms. We prefer Delta brand for shower trims, valves, and faucets. Our vanities (low-profile or full-height) are built and finished in-house with Birch or Poplar and soft-close hardware. A Kohler round-bowl flush toilet is standard, but we also offer alternative upgrade options for off-grid living, if desired.

Pictured: 24' Pingora (below) with Alabaster painted shiplap, Special Walnut stained low-profile vanity with white vessel sink, and 12 x 24" tile shower. 24' Toccoa (right) with 50% Country Pine stained smooth-panel walls and low-profile vanity, vessel sink, and standard white shower insert.



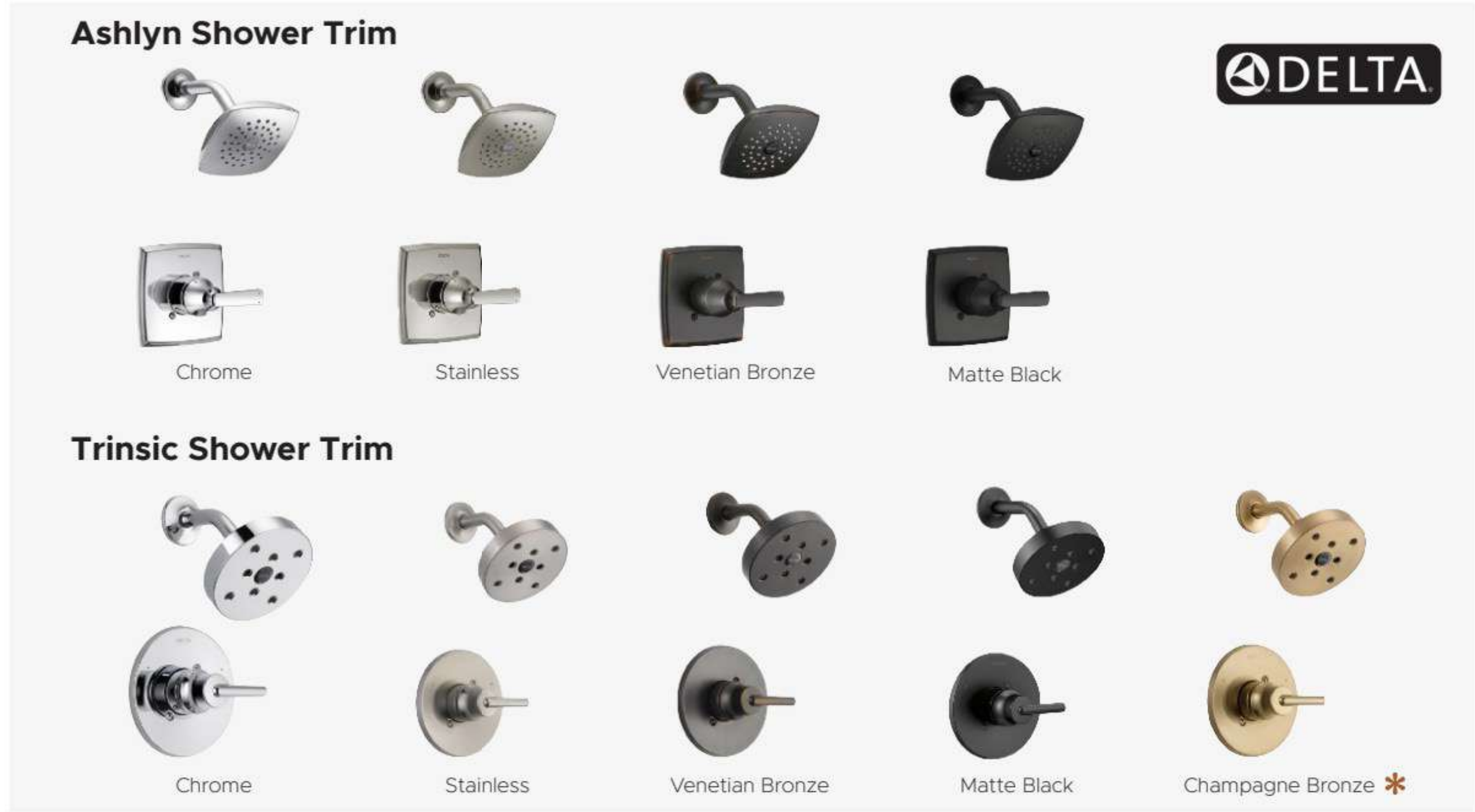

Atlas Concord 12x24" Ceramic Tile *



Low-profile Vessel Sink



Arvo



Chrome



Stainless



Matte Black



Champagne Bronze *

Round Drop-in Sink



Nicoli



Chrome



Stainless



Matte Black

Rectangle Drop-in Sink



Round Vessel Sink



Trinsic



Chrome



Stainless



Venetian Bronze



Matte Black



Champagne Bronze *

* Undermount sinks available with granite or quartz upgrades.



KOHLER.



Cimarron Flush Toilet

NATURE'S HEAD®



Composting Toilet *

All of our tiny homes come standard with a gravity flush toilet and connections (vent and outlet) for an alternative toilet in case of future needs. The two alternative toilet upgrades we offer are a Nature's Head composting toilet and a Separett urine diverting toilet. You can also opt for your home to be delivered without a toilet (connections only) if you prefer to have a different toilet installed after-the-fact.



Lighting & ceiling fans

We use low-profile, surface-mount LED lights for the primary lighting in our tiny homes. A ceiling fan also comes standard and can be placed in the living area or bedroom (for select models). In addition, we offer a variety of sconce options for over the kitchen sink and bathroom vanity (where possible). Dimmer switches for primary or auxiliary lighting can be added upon request.

Flush-mount LED Lights



White



Satin Nickel



Black



Hunter

Aker 36" Fan



White



Brushed Nickel



Black

Wright 1-Light Sconce



Satin Nickel



Matte Black



Warm Brass

Carson 1-Light Sconce



Satin Nickel



Matte Black



Warm Brass

Windom 2-Light Sconce



Brushed Nickel



Midnight Black



Bronze



Satin Brass

Towner Sconce



Brushed Nickel



Satin Brass



Brushed Nickel



Satin Brass

Our standard sconce options offer a variety of styles and finishes. If you prefer to choose a different option for your accent lighting, you can opt to install a bathroom sconce (where possible) after you receive your home—the necessary rough-in box and wires will be in place.

**Please note that lighting options often change without notice. If we are unable to source the option you have chosen, we will offer you alternatives to choose from.*

stairs & ladders

Our standard options for loft access are open storage stairs (for primary lofts) or a stowable ships ladder. We also offer upgrades for closed storage stairs (3 large cubbies and 1 drawer) and a stationary easy-climb ladder or lily pad ladder. Our alternative ladder options offer greater ease and comfort for climbing than a standard ladder, while offering a much smaller footprint than our standard storage stairs—a good option if you're concerned about space but still want easy access to your loft. The easy-climb ladder can be all wood construction or built with steel stringers and wood treads. The lily pad ladder is built with a steel post and wood treads. Wooden handrails and railings are standard (where applicable), but steel handrail upgrades are also available. For our traditional lofts, a knee wall is standard (upgrades available for wood or steel railings).

Open Storage Stairs



Stowable Ships Ladder



Lily Pad Ladder *

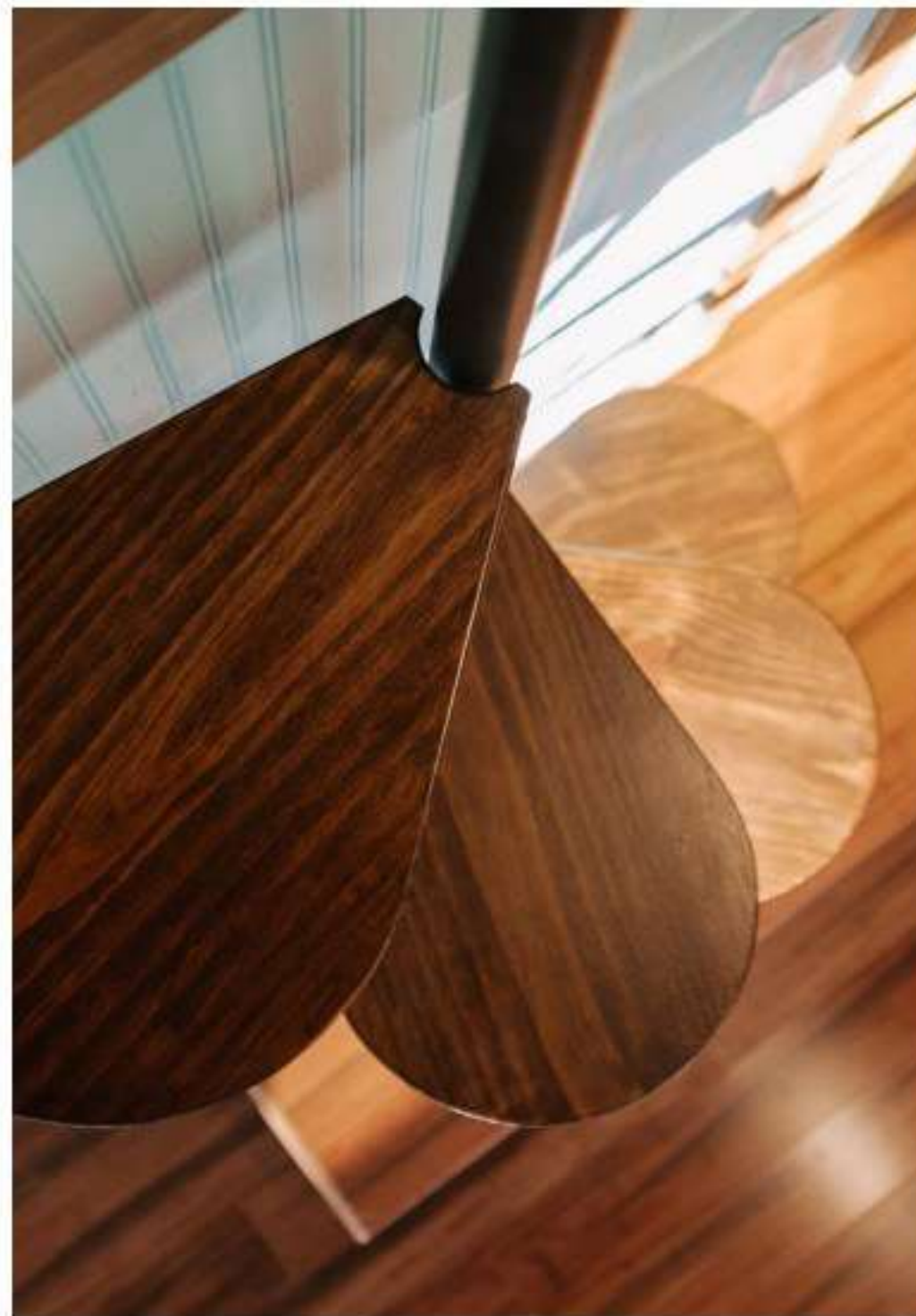

Easy-climb Ladder *



Closed Storage Stairs *





wood stoves & heaters

If your home will be placed in a colder climate—or you just love the cozy feeling of a warm fire—we offer miniature wood burning stove upgrades (pending approval by our design team). Depending on model and placement, the wood stoves can be wall- or floor-mounted. We also offer stand and wood storage upgrade options to accompany your stove, if desired. If you prefer the cozy feeling of a warm fire without the maintenance of a wood stove, we also offer an alternative propane option.



TINY WOOD STOVE





WIND RIVER
TINY HOMES



WIND RIVER
MODULAR