

Wave Recessed Aluminum Channel with Silicone Grip



The Wave Recessed Aluminum Channel with Silicone Grip uses high quality 6063 aluminum. The inner silicone grip maintains a strong grabbing force and protects the fixture from potential damage.

This profile controls installation tolerances by shielding rough edges and gaps of oversized grooves.



Dimensions (mm):

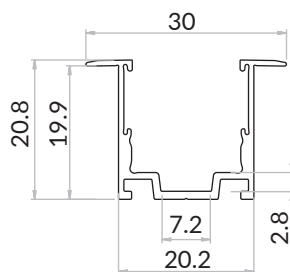

Tolerance: $\pm 0.2\text{mm}$

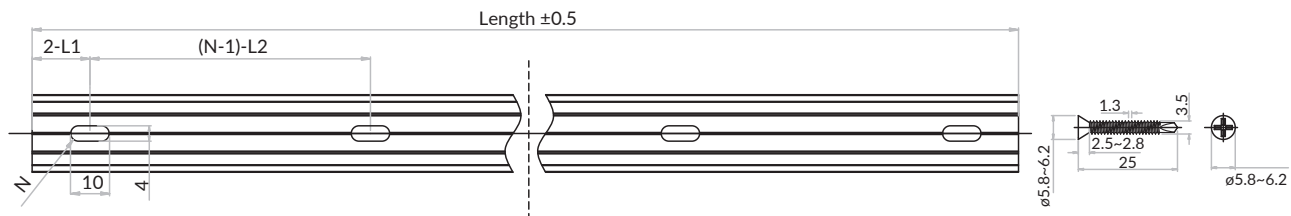
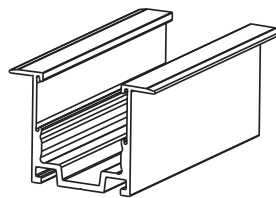

Note:

1. 2-L1 refers to two of symmetric L1 in each piece of profile.
 2. (N-1)-L2 refers to (N minus one) of symmetric L2 in each piece of profile.
- "N" hereby stands for its corresponding "Hole Number" in the below table.

Part Number	Length	L1	L2	Slotted Hole	Hole Number
CL-16-R-RA-02C-SE	20mm/0.787in	10mm/0.39in	/	4*10mm/0.16*0.39in	1
CH-16-R-RA-0M5-SE	500mm/19.68in	50mm/1.97in	200mm/7.87in	4*10mm/0.16*0.39in	3
CH-16-R-RA-01M-SE	1000mm/39.37in	100mm/3.93in	200mm/7.87in	4*10mm/0.16*0.39in	5
CH-16-R-RA-02M-SE	2000mm/78.74in	100mm/3.93in	200mm/7.87in	4*10mm/0.16*0.39in	10