

Wave Mini Standard Aluminum Channel with Silicone Grip

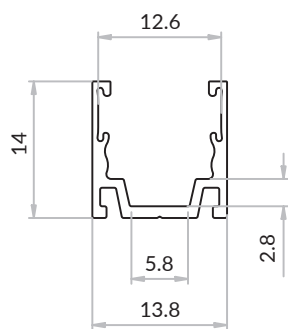

The Wave Mini Standard Aluminum Channel with Silicone Grip uses high quality 6063 aluminum. The inner silicone grip maintains a strong grabbing force and protects the fixture from potential damage.

Dimensions (mm):



Tolerance: $\pm 0.2\text{mm}$

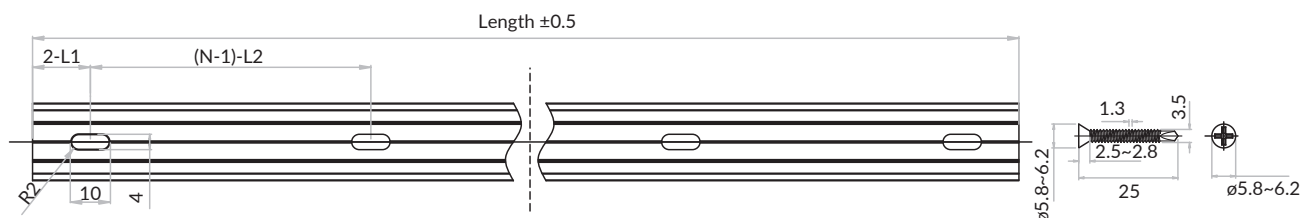
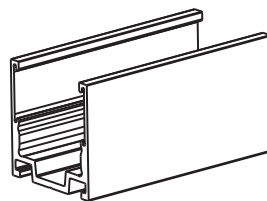

Note:

- 2-L1 refers to two of symmetric L1 in each piece of profile.
- (N-1)-L2 refers to (N minus one) of symmetric L2 in each piece of profile. "N" hereby stands for its corresponding "Hole Number" in the below table

Part Number	Length	L1	L2	Slotted Hole	Hole Number
CL-10-R-AL-02C-SE	20mm/0.787in	10mm/0.39in	/	4*10mm/0.16*0.39in	1
CH-10-R-AL-0M5-SE	500mm/19.68in	50mm/1.97in	200mm/7.87in	4*10mm/0.16*0.39in	3
CH-10-R-AL-01M-SE	1000mm/39.37in	100mm/3.93in	200mm/7.87in	4*10mm/0.16*0.39in	5
CH-10-R-AL-02M-SE	2000mm/78.74in	100mm/3.93in	200mm/7.87in	4*10mm/0.16*0.39in	10