

# VIVID S 270 DIRECT DMX SILICONE 24V



Version 1.4 | 04/06/2022

**For More Information**

**Toll Free: 1 (888) 580-6366**



# TECHNICAL SPECIFICATIONS | SILICONE

**VIVID S 270**

Version 1.4 | Specifications are subject to change without notice.

**DIRECT DMX**

Light Dimension	0.45 x 1.14in (11.5x29mm)	
Output	RGB	RGBW(27K, 30K, 40K)
LED Light	SMD LED Chip	
Max Fixture Length	*Due to the fragility of five-wire light fixtures, GLLS does not recommend exceeding lengths longer than 16.4ft(5m).	
With Single Power Feed	Full Load: 49.21ft (15m)	Full Load: 32.8ft (10m)
	Dynamic Load: 65.6ft (20m)	Dynamic Load: 49.2ft (15m)
With Dual Power Feed	Full Load: 98.4ft (30m)	Full Load: 65.6ft (20m)
	Dynamic Load: 131.2ft (40m)	Dynamic Load: 98.4ft (30m)
Light Surface	Round profile 270°	
Lumen Maintenance	70,000 Hours L70 @ 25°C : 90,000 L50 @ 25°C 50,000 Hours L70 @ 50°C : 70,000 Hours L50 @ 50°C	

## Electrical

Input Voltage	24V DC	
Power Consumption	3.66W/ft (12W/m)	4.57W/ft (15W/m)

## Physical

LED Count	18 LEDs/ft (60 LEDs/m)	18 LEDs/ft (60 LEDs/m)
Cutting Unit Length	6.56in (166.7mm) (10LEDs)	6.56in (166.7mm) (10LEDs)
Thermal Management	Free air convection	
Fixture Connections	End, side & bottom lead wires	
Minimum Bend Diameter	4.72in (120mm) (Side Bending)	

## Temperature Ranges

Installation	-40°F to 122°F (-40°C to 50°C)	-40°F to 122°F (-40°C to 50°C)
Operating	-40°F to 131°F (-40°C to 55°C)	-40°F to 113°F (-40°C to 45°C)
Max. Surface	185°F (85°C)	
Humidity	0-95% non condensing	

## Dependability

Warranty	10 Year Limited Warranty		
----------	--------------------------	--	--

## Safety

Testing	Tested to UL & CSA by Underwriters Laboratory for use in USA and Canada, complies with California Title 24 Requirements, Lighting Facts. Exceeds ANSI C78.377A, CE & RoHS Compliant.		
Certifications	Testing Organization	Certificate Serial N°	Report Reference
UL 2108	UL	E347880	E347880-20130503
CE-EMC	SGS	SZEM1712012372LMV	SZEM171201237201
IP Rating	IP68 With appropriately rated accessories.		

## Optical Parameters

### Available Colors

Color	CCT/Wavelength
Red	618-624nm
Green	522-530nm
Blue	468-474nm
RGB	R+G+B
2700K	2725 ± 85K
3000K	3045 ± 140K
4000K	3985 ± 150K

### Lumen Count

Color	Per Foot	Per Meter
Red	12lm	40lm
Green	34lm	110lm
Blue	6lm	20lm
R+G+B	52lm	170lm
2700K	34lm	110lm
3000K	34lm	110lm
4000K	34lm	110lm

### Side Bending

Light Profile

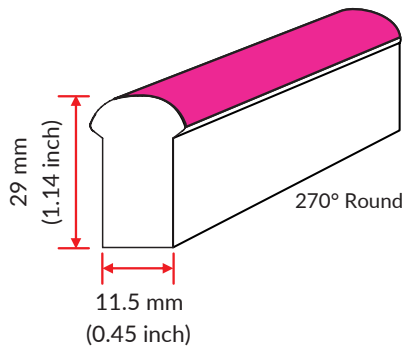

Bending Direction

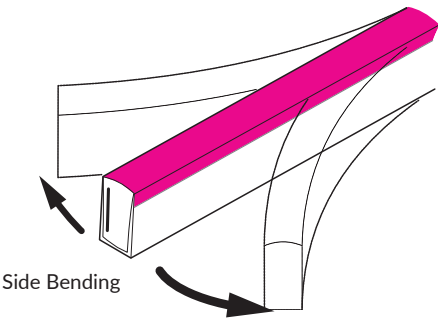

Minimum Bending Diameter

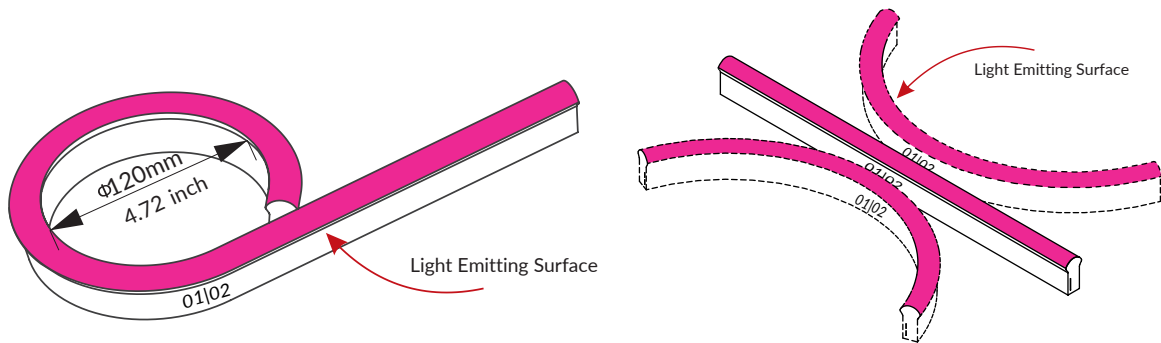

Fixtures

SF-11D-1- 01-5D-E-XXX-24DC

LED Color (3 digits)

LED Color (3 digits)
RGB - RGB
R27 - RGBW 2700K
R30 - RGBW 3000K
R40 - RGBW 4000K

Lead Connector

FA-11D-1-01-5D-SE-X-XX-XXX-S

Length (3 digits)  
Exit Type (2 Digits) For  
Fixture End (1 Digit)

For Fixture End (1 digit)	Exit Type (2 digits)	Length (3 digits)
1 - Input side	EN - End	0M3 - 0.98ft (30cm)
2 - Output side	BO - Bottom	01M - 3.28ft (1m)
0 - Jumpers/ Seamless Bottom/ Seamless End	SL - Side left	03M - 9.84ft (3m)
	SR - Side right	05M - 16.4ft (5m)
	EJ - End jumper	10M - 32.81ft (10m)
	BJ - Bottom jumper	000 - For End Cap
	SJ - Side jumper	

For full part number naming rules, please refer to the document on <https://www.glls.com/documentation/>



IP68: Submersible. Factory Assembly only

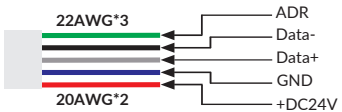

(Dimensions: mm)

Seamless

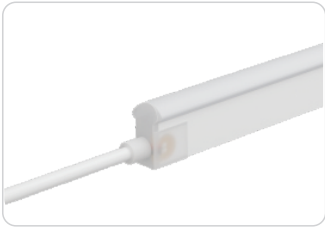

Seamless End Exit  
FA-11D-1-01-5D-SE-0-EN-XXX-S

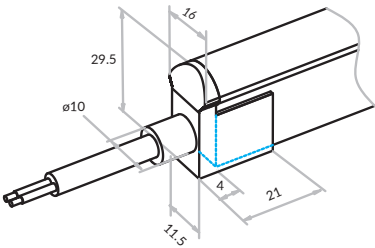

Seamless Side Exit  
FA-11D-1-01-5D-SE-1-SR-XXX-S  
FA-11D-1-01-5D-SE-2-SL-XXX-S

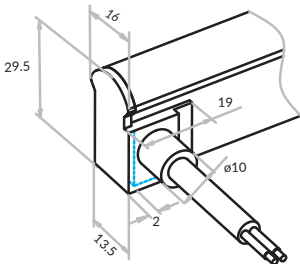

Seamless Bottom Exit  
FA-11D-1-01-5D-SE-0-BO-XXX-S

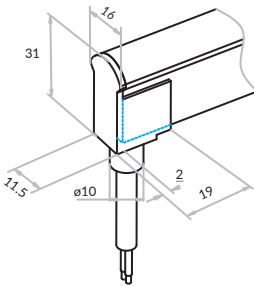

Seamless End Cap  
FA-11D-1-01-0W-SE-1-EC-000-P  
FA-11D-1-01-0W-SE-2-EC-000-P

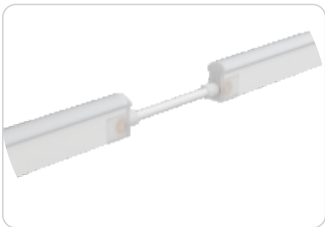
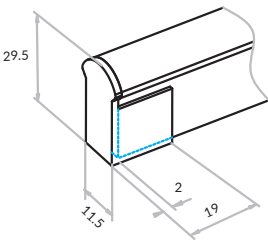

Seamless Jumper  
FA-11D-1-01-5D-SE-0-EJ-XXX-S

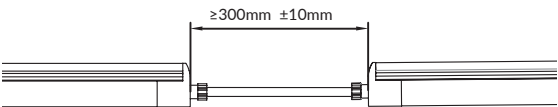

Cable Connectors



**Cable Connectors**  
NA-XX-BC-DC-CXX-F  
NA-XX-BC-DC-CXX-M  
  
NA-XX-BN-XXA-CXX-F  
NA-XX-BN-XXA-CXX-M  
  
NA-XX-PL-XXA-CXX-F  
NA-XX-PL-XXA-CXX-M

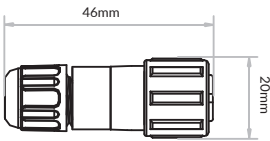

Anti-Wicking Ferrule

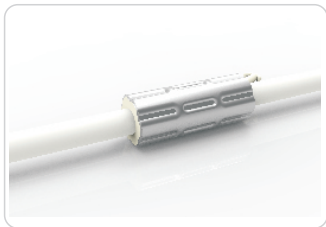

**Anti-wicking Ferrule**

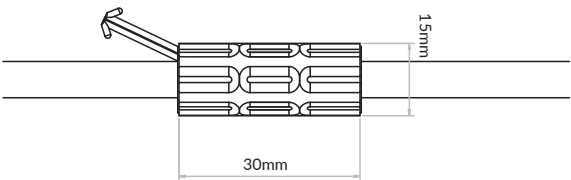
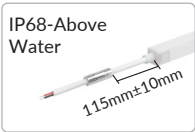

Wiring Diagram

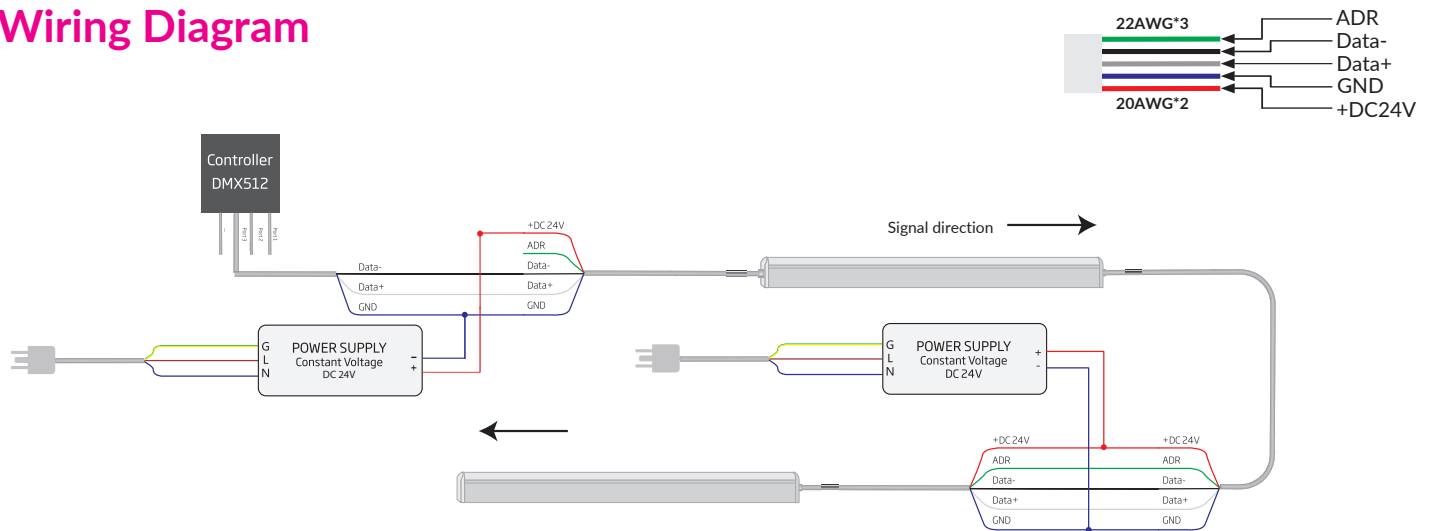



## Standard Aluminum Channel

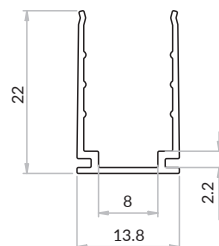
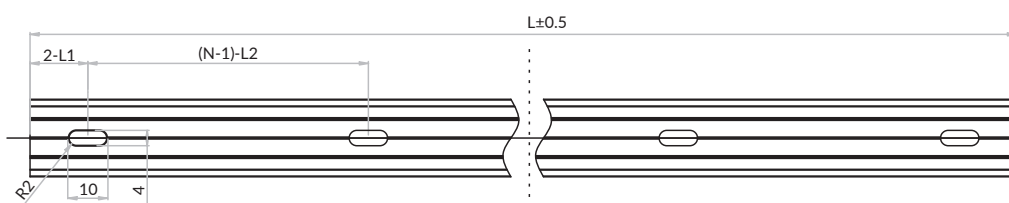
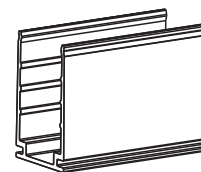

(Dimensions: mm)

Tolerance:  $\pm 0.2\text{mm}$ 

Note:

1. 2-L1 refers to two of symmetric L1 in each piece of profile.
2. (N-1)-L2 refers to (N minus one) of symmetric L2 in each piece of profile. "N" hereby stands for its corresponding "Hole Number" in the below table

W x H	Standard Length	Part Number	L1	L2	Screw Hole	Hole #
0.54 x 0.87in (13.8 x 22mm)	1.38in (35mm)	CL-11-R-AL-3C5-SD	0.69in (17.5mm)	/	0.39x0.16in(10x4mm)	1
	19.69in (500mm)	CH-11-R-AL-0M5-SD	1.97in (50mm)	7.87in (200mm)	0.39x0.16in(10x4mm)	3
	39.37in (1000mm)	CH-11-R-AL-01M-SD	3.94in (100mm)	7.87in (200mm)	0.39x0.16in(10x4mm)	5
	78.74in (2000mm)	CH-11-R-AL-02M-SD	3.94in (100mm)	7.87in (200mm)	0.39x0.16in(10x4mm)	10

## Recessed Aluminum Channel

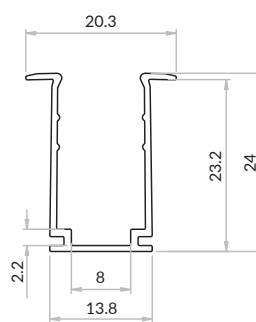
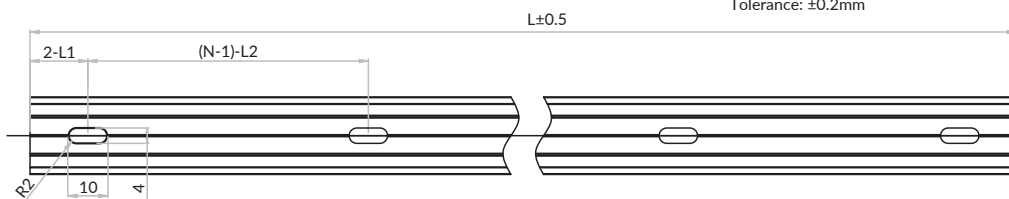
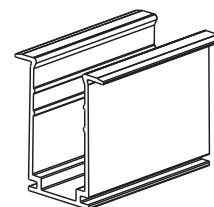

(Dimensions: mm)

Tolerance:  $\pm 0.2\text{mm}$ 

Note:

1. 2-L1 refers to two of symmetric L1 in each piece of profile.
2. (N-1)-L2 refers to (N minus one) of symmetric L2 in each piece of profile. "N" hereby stands for its corresponding "Hole Number" in the below table

W x H	Standard Length	Part Number	L1	L2	Screw Hole	Hole #
0.54 x 0.87in (13.8 x 22mm)	1.38in (35mm)	CL-11-R-RA-3C5-SD	0.69in (17.5mm)	/	0.39x0.16in(10x4mm)	1
	19.69in (500mm)	CH-11-R-RA-0M5-SD	1.97in (50mm)	7.87in (200mm)	0.39x0.16in(10x4mm)	3
	39.37in (1000mm)	CH-11-R-RA-01M-SD	3.94in (100mm)	7.87in (200mm)	0.39x0.16in(10x4mm)	5
	78.74in (2000mm)	CH-11-R-RA-02M-SD	3.94in (100mm)	7.87in (200mm)	0.39x0.16in(10x4mm)	10

Standard Aluminum Channel with Silicone Grip

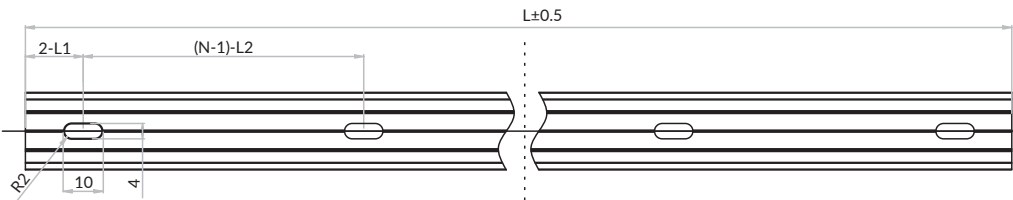
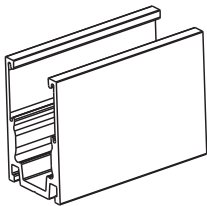
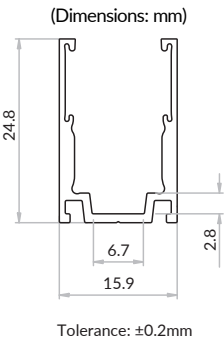

Note:

1. 2-L1 refers to two of symmetric L1 in each piece of profile.

2. (N-1)-L2 refers to (N minus one) of symmetric L2 in each piece of profile. "N" hereby stands for its corresponding "Hole Number" in the below table

W x H	Standard Length	Part Number	L1	L2	Screw Hole	Hole #
0.63 x 0.98in (15.9 x 24.8mm)	1.38in (35mm)	CL-11-R-AL-02C-SE	0.39in (10mm)	/	0.39x0.16in(10x4mm)	1
	19.69in (500mm)	CH-11-R-AL-0M5-SE	1.97in (50mm)	7.87in (200mm)	0.39x0.16in(10x4mm)	3
	39.37in (1000mm)	CH-11-R-AL-01M-SE	3.94in (100mm)	7.87in (200mm)	0.39x0.16in(10x4mm)	5
	78.74in (2000mm)	CH-11-R-AL-02M-SE	3.94in (100mm)	7.87in (200mm)	0.39x0.16in(10x4mm)	10

Recessed Aluminum Channel with Silicone Grip

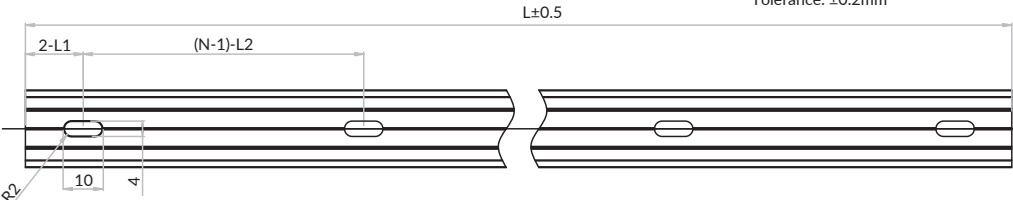
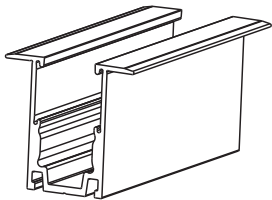
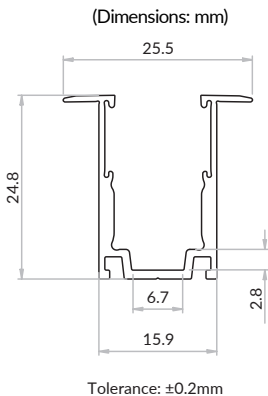

Note:

1. 2-L1 refers to two of symmetric L1 in each piece of profile.

2. (N-1)-L2 refers to (N minus one) of symmetric L2 in each piece of profile. "N" hereby stands for its corresponding "Hole Number" in the below table

W x H	Standard Length	Part Number	L1	L2	Screw Hole	Hole #
0.63 x 0.98in (15.9 x 24.8mm)	1.38in (20mm)	CL-11-R-RA-02C-SE	0.39in (10mm)	/	0.39x0.16in(10x4mm)	1
	19.69in (500mm)	CH-11-R-RA-0M5-SE	1.97in (50mm)	7.87in (200mm)	0.39x0.16in(10x4mm)	3
	39.37in (1000mm)	CH-11-R-RA-01M-SE	3.94in (100mm)	7.87in (200mm)	0.39x0.16in(10x4mm)	5
	78.74in (2000mm)	CH-11-R-RA-02M-SE	3.94in (100mm)	7.87in (200mm)	0.39x0.16in(10x4mm)	10

Transparent Reinforced Plastic Channel

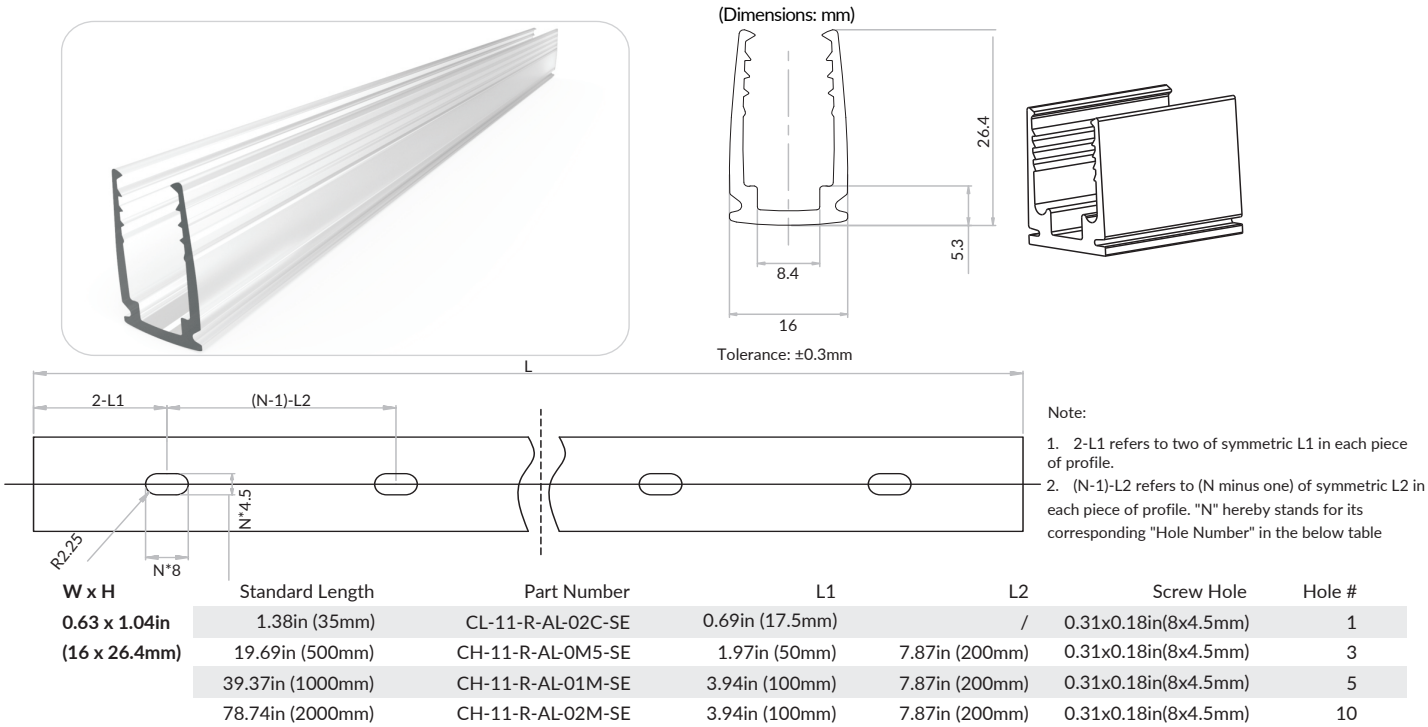

Bendable Serrated Aluminum Channel

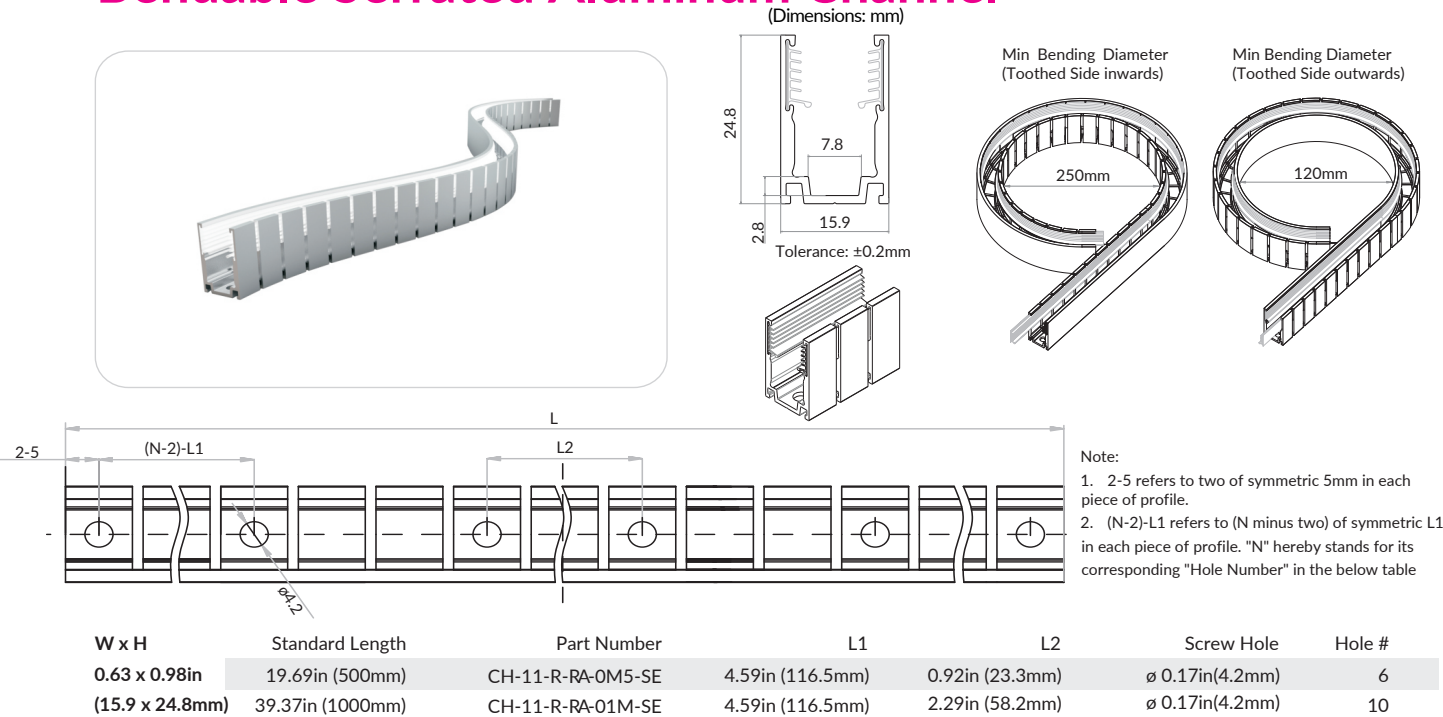

For more available mounting options, please refer to the series manual on <https://www.glls.com/documentation/>

