



crean | EST
1968
CONTRACT FLOORING & TILING

Company Profile

Over 50 Years of Industry Experience

Established in 1968 and now with over 50 years of industry experience we believe we are very well positioned to help and assist our Clients to deliver a best-in-class project.

We also believe that through hard work, and by constantly pursuing high standards, we can make this company the very best in its sector. It is this positive attitude that has made Crean a premier Flooring & Tiling contractor. We continually aspire to be our Client's contractor of choice.

Our Vision

To be the construction industry's Flooring and Tiling contractor of choice.



Central Bank of Ireland

Our Clients

Crean successfully delivers more than 250 contract Flooring and Tiling projects per year for diverse client base in Ireland. We believe our Clients are also our partners, we engage early. First, we help our Clients so that in turn our Client can help us. We believe in being proactive not reactive. Through this philosophy trust is built, relationships are strengthened and mutually beneficial results are achieved.

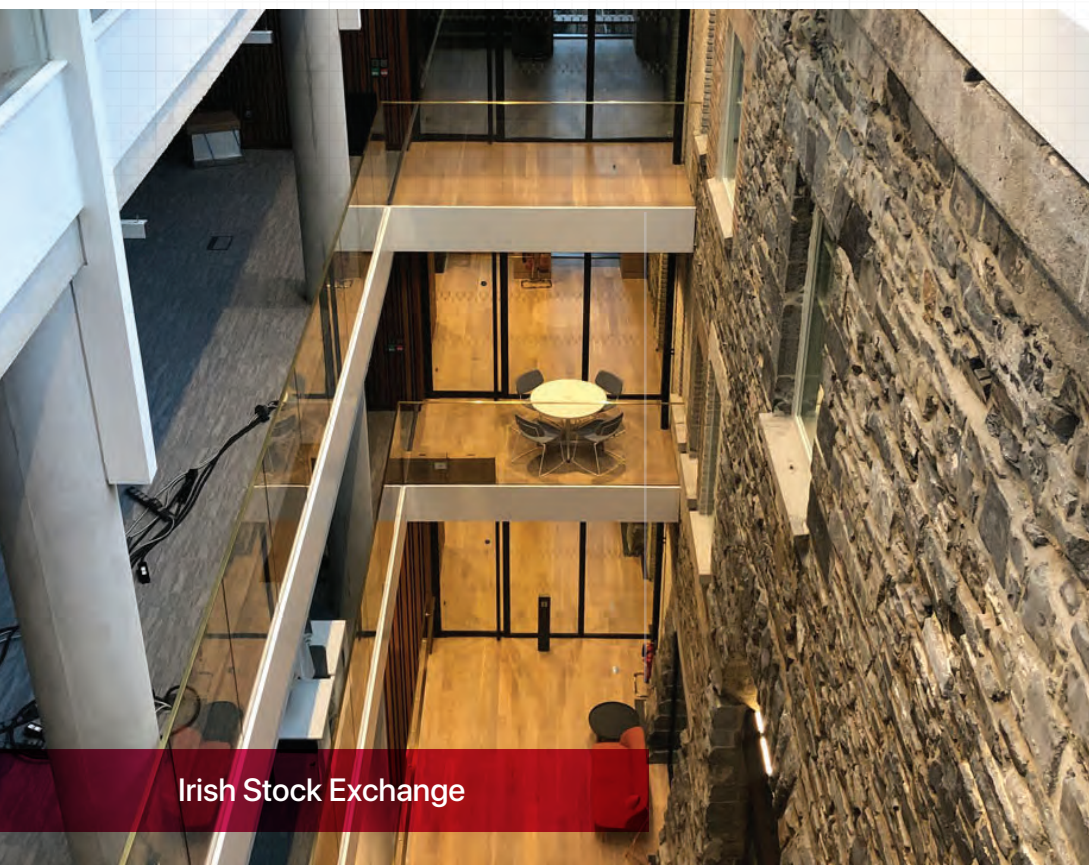

Irish Stock Exchange



Adare Manor

Internationally Recognised ISO Accreditations

We are extremely proud to have received the following ISO accreditations. This internationally recognised standard will help us deliver class leading service and product to our customers. We are Irelands first Flooring and Tiling company to be awarded three ISO accreditations.

ISO Accreditations

- ISO 9001 Quality Management
- ISO 14001 Environmental Management
- ISO 45001 Health & Safety Management

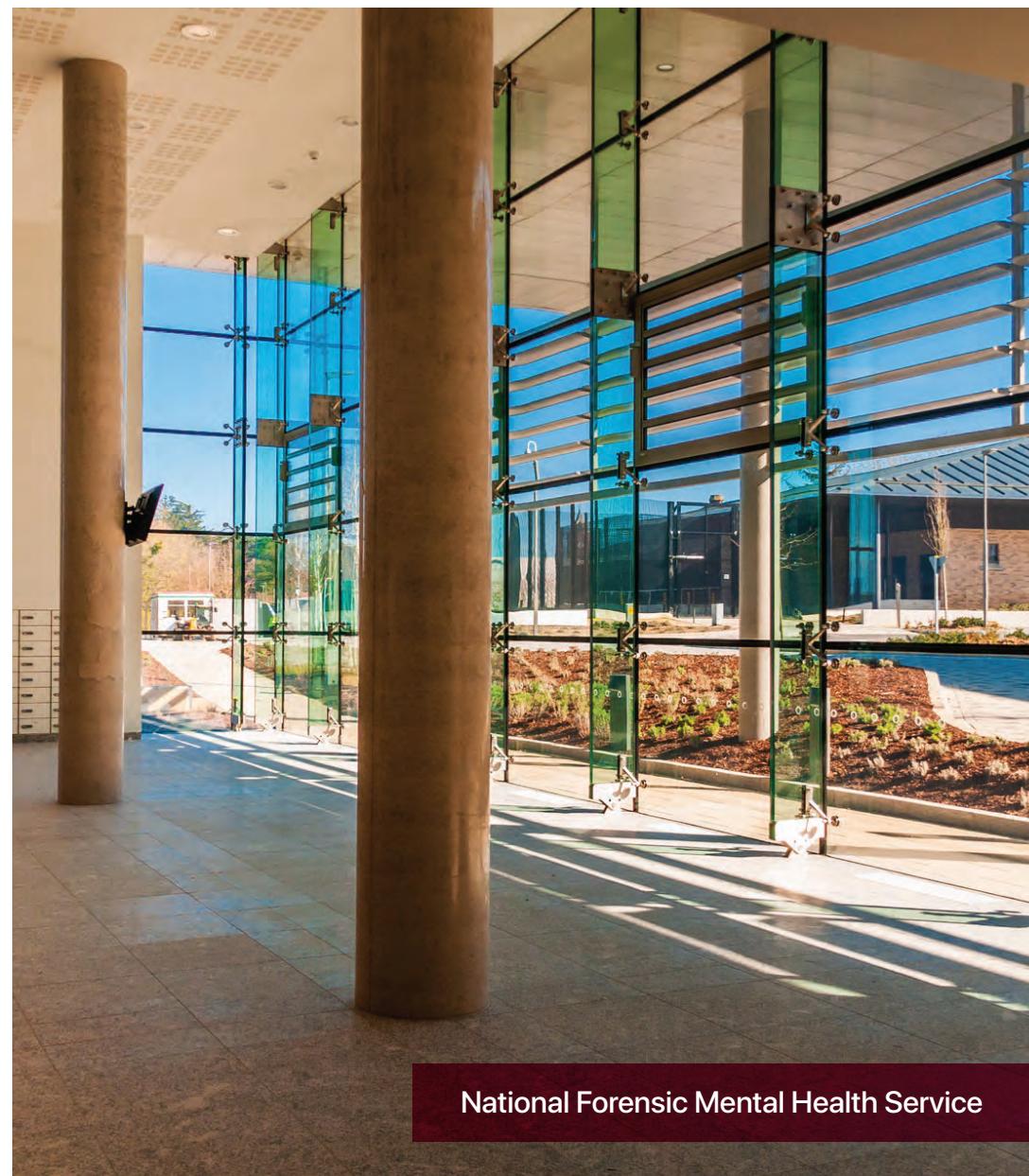

National Forensic Mental Health Service

Crean **Supply & Install** a wide product range:



Carpets



Linoleum



**Timber
Flooring**



**Rubber
Flooring**



**Safety
Flooring**



Tiles



**Vinyl
Flooring**

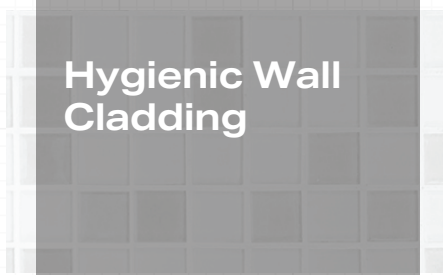

**Hygienic Wall
Cladding**



**Floor
Preparation**



**Entrance
Matting**



**Sports Floors &
Line Marking**



**Accessories
& Profiles**



Lansdowne Place

Supply Chain

Our supply chain and who we partner with is an integral part of what we offer our Clients. To us it's imperative that we only partner with best-in-class sustainable suppliers with world class sustainable products, this is inherent in our DNA.

A sustainable supply chain also helps improve productivity while saving money at the same time. By using sustainable techniques and resources, you increase efficiency and reduce cost.

We trust all our suppliers so when we say we deliver our client knows we will deliver a quality and sustainable product plus a reliable before and after sales service. This can only be delivered to our Clients when we partner with the very best.

Our Mission

Since 1968, we have been committed in the pursuit of delivering excellence in the provision of floor and wall finishes, to the residential and commercial construction industry in Ireland and the UK.

We will continue to build sustainable relationships with our Clients, suppliers and employees. We will achieve this through respect and trust so that we can nurture mutually beneficial outcomes for all vested partners.

Relevant Experience

The company presently delivers in excess of 200 projects per year across a range of different commercial sectors:

Commercial



Information Technology



Health



Pharmaceutical



Tourism/Leisure



Education



Retail



Residential

Lansdowne Place | Capital Docks | Bolands Quay Towers | Ayrfield Housing | Cardiff Lane Development | St Clares

Sustainability

Sustainability encapsulates every single aspect of our business, and it has done so since the company was founded. It is for good reason sustainability is also referenced in terms of our Clients & Supply Chain.

Businesses that are not sustainable don't survive or grow; our longevity & continued growth through good times & bad is testament to this & our people.

In recent times with thanks to the continued vision & innovation of our Management team, our accreditation for ISO has taken sustainability within our company to another level in terms of our interaction with our Staff, Clients & Supply Chain.

We particularly see ISO 9001 & 14001 accreditation as a further advancement of our already core principle of sustainability for the procurement & installation of environmentally responsible materials in collaboration with our Mutual Partners.

Current Key Projects

Client	Main Contractor	Value
Capital Docks Mixed Use Development, Dublin (including JP Morgan Fit-Out)	John Sisk & Son (Holdings) Ltd	€4,000,000.00
Coopers Cross Mixed Use Development, Dublin	John Sisk & Son (Holdings) Ltd	€3,900,000.00
Lansdowne Place Luxury Residential Development, Ballsbridge, Dublin	JJ Rhatigan & Company	€3,300,000.00
8th Lock Residential Development, Dublin	Ballymore	€2,200,000.00
Fibonacci Square, Ballsbridge (Facebook HQ), Dublin	John Sisk & Son (Holdings) Ltd	€1,600,000.00
Cardiff Lane Mixed Use Development, Dublin	Walls Construction Ltd	€1,500,000.00
6 Hanover Quay & Donnybrook Gardens Residential Developments, Dublin	Cairn Homes PLC	€1,400,000.00
Charlemont Square, Blocks 1 & 2, Dublin	JJ Rhatigan & Company	€1,350,000.00
Bolands Quay, Mixed Use Development (incl Bolands Mills Fit-Out)	BAM Contractors	€1,200,000.00
Limerick Prison	P.J. Hegarty & Sons	€1,100,000.00
ESB Headquarters, Fitzwilliam Street, Dublin	P.J. Hegarty & Sons	€1,050,000.00
Sandyford Central Residential, Dublin	John Paul Construction	€950,000.00
One South County Office Development, Leopardstown, Dublin	Collen Construction Ltd	€830,000.00
Rialto PCC/North Clondalkin Library/Spencer Hotel/Bluebell Avenue Residential	Townlink Construction Ltd	€815,000.00
Navan Shopping Centre, Meath	Graham Contruction (NI)	€800,000.00
Scoil An Athar Tadhg & Scoil Mhuire Gan Smál, Cork	MMD Construction	€725,000.00
Dorset Street Hotel, Dublin	Duggan Brothers (Contractors) Ltd	€700,000.00
St. Luke's General Hospital, Kilkenny	ESS Modular	€650,000.00
Adare Manor Leisure Facility, Limerick	John Paul Construction	€600,000.00
WeWork Fit-Out, Central Plaza, Dublin	TSK Group (UK)	€525,000.00

Former Key Projects Completed

Client	Main Contractor	Value
Wyeth Medica, Dublin	P.J. Hegarty & Sons	€3,300,000.00
Central Bank of Ireland HQ, Dublin	Walls Construction Ltd	€2,350,000.00
Eircom HQ	Pierse Contracting	€2,250,000.00
PwC (PricewaterhouseCoopers), Dublin	John Sisk & Son (Holdings) Ltd	€1,800,000.00
Intel, Leixlip	P.J. Hegarty & Sons	€1,500,000.00
Portlaoise Prison	Laing O' Rourke	€1,400,000.00
Fernbank Residential Development, Dundrum, Dublin	Direct c/o Irish Life Investments Managers	€1,150,000.00
Miesian Plaza Office Development, Dublin (including Shire Fit-Out)	John Paul Construction	€1,100,000.00
Xerox	John Sisk & Sons Ltd	€1,200,000.00
Phoenix Park Residential Development	Flynn O'Flaherty	€1,100,000.00
Shannon Airport	P.J. Hegarty & Sons	€1,100,000.00
Ulster Bank RBS, HQ	Ardmac	€1,100,000.00
St Vincent's Hospital	John Paul Construction	€1,000,000.00
Wheatfield Prison	John Sisk & Sons Ltd	€950,000.00
Radisson Blu Royal Hotel, Golden Lane, Dublin	JJ Rhatigan & Company	€900,000.00
Robswall Housing & Apartments, Malahide, Co. Dublin	Hollybrook Homes	€850,000.00
The Aviva Stadium	John Sisk & Son (Holdings) Ltd	€800,000.00
LinkedIn EMEA HQ, Dublin	Walls Construction Ltd	€675,000.00
National Indoor Arena, Dublin	Heron Buckingham JV	€650,000.00
Castlebar Swimming Complex, Co. Mayo	PJ McLoughlin & Sons Ltd	€635,000.00

Crean Group

Organisation and Support Structure





Alan Crean
Executive Chairman

David Cunningham
Sales Director

Brian Ruane
Managing Director

Tony Waters
Contracts Director

SALES/ESTIMATING DEPARTMENT

Seán Markham *MSCSI MRICS*
Associate Director - Commercial

Quantity Surveyor/Estimator

Quantity Surveyor/Estimator

Junior Quantity Surveyor/Estimator

Trainee Quantity Surveyor/Estimator

Estimating Admin

QUANTITY SURVEYING DEPARTMENT

Richard Quinn
Associate Director- Surveying

Senior Quantity Surveyor

Quantity Surveyor

Quantity Surveyor

Junior Quantity Surveyor

WAREHOUSE DISTRIBUTION

Mayo

Dublin

CONTRACTS MANAGEMENT

Senior Contracts Manager

Contracts Manager

Contracts Manager

Contracts Manager

Contracts Manager

Contracts Manager

Contracts Manager

Contracts Manager

ACCOUNTS DEPARTMENT

Jason Carey
Financial Controller

Credit Control/ Health & Safety

Payroll

Accounts Payable

Accounts Payable Administrator



Retail, Wholesale & National Distribution

Alan Crean

Executive Chairman

Declan Glynn

Director

**CERAMIC CITY
CHARLESTOWN**

Retail Sales

Accounts Assistant

**CERAMIC CITY
SLIGO**

Retail Sales

Retail Sales

**CERAMIC CITY
CASTLEBAR**

Manager

Retail Sales

Retail Sales

Retail Sales

Retail Sales

Retail Sales

**CERAMIC CITY WHOLESALE
& NATIONAL DISTRIBUTION**

National Specification Manager

Sales Account Manager

Sales Account Manager

Distribution Manager

Warehouse Manager

RETAIL, WHOLESALE & NATIONAL WAREHOUSE DISTRIBUTION



UK Office

Alan Crean
Managing Director

Brian Ruane
Director

ADMIN/ESTIMATING DEPARTMENT

Estimating Admin

Quantity Surveyor/Estimator
& ISO IMS Lead

Pre-Qualification

QUANTITY SURVEYING DEPARTMENT

Maria Weir
Commercial Director

Senior Quantity Surveyor

Trainee Quantity Surveyor

CONTRACTS MANAGEMENT DEPARTMENT

Daniel Hunt
Contracts Director

Site Manager

Trainee Site Manager

ACCOUNTS DEPARTMENT

Jason Carey
Financial Controller

Payroll

Accounts

HEALTH & SAFETY/CREDIT CONTROL

WAREHOUSE DISTRIBUTION

**HEAD OFFICE**

The Square, Charlestown
Co Mayo
F12 PW62

+353 94 925 4274
info@crean.ie

DUBLIN OFFICE

Unit 298,
Blanchardstown
Corp. Park 2,
Dublin 15
D15 XR25

+353 94 925 4274
info@crean.ie

LONDON OFFICE

Unit 25 Bates Industrial
Estate, Church Road
Romford
RM3 0HU

+44 1 708375510
info@crean.ie

**CASTLEBAR**

Moneen Industrial Estate
Castlebar
Co Mayo
F23 XP99

+353 94 902 4250
info@ceramiccity.ie

SLIGO

Ballast Quay
Sligo
Co Sligo
F91 XYV9

+353 71 916 0978
info@ceramiccity.ie

CHARLESTOWN

The Square
Charlestown
Co. Mayo
F12 PW62

+353 94 925 4274
info@ceramiccity.ie