

# CS-series 20

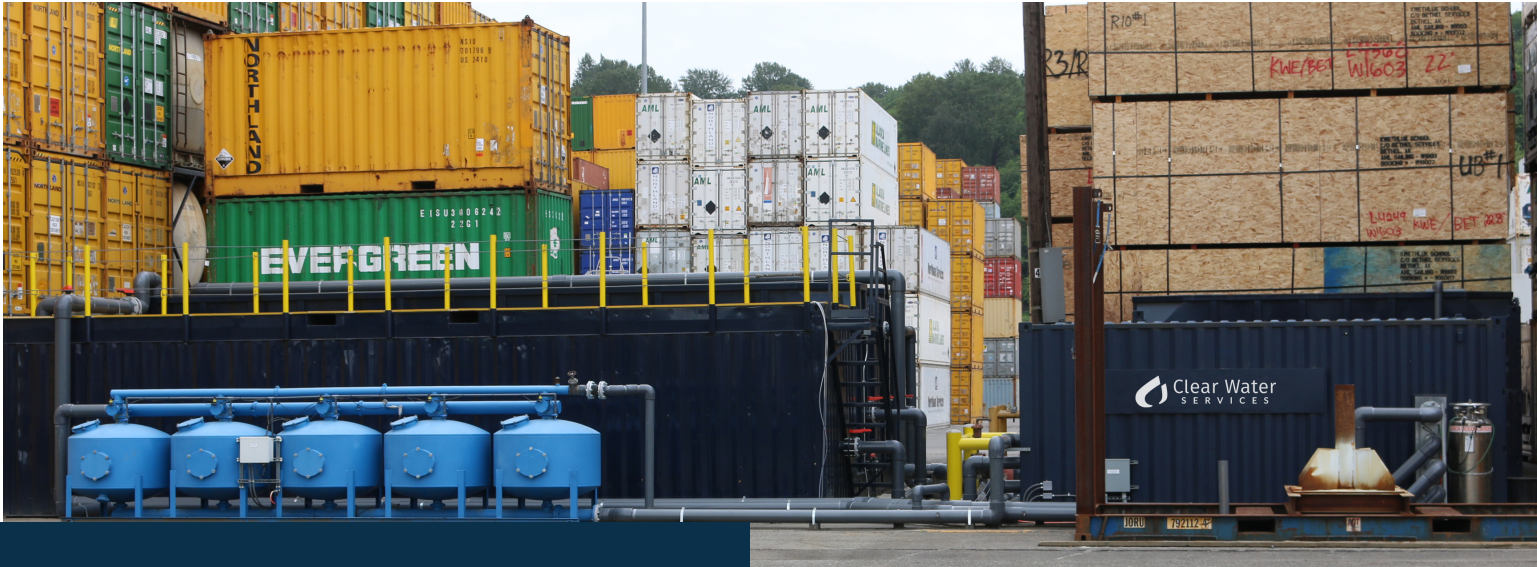

The CS-20 is a patented mobile unit designed to treat sediment-laden stormwater, groundwater, and industrial wastewater.

## Flow Capacity

Discharge/Treatment Rate: 100 - 1,000 GPM

## Applications

Constructed in a Conex box, the CS-20 is designed to be the center for a modular, mobile treatment system.

## Versatility

The CS-20 addresses multiple constituents of concern including turbidity, pH, metals, hydrocarbons and pesticides.

In addition to being the control unit for the treatment system, The CS-20 is designed to act as an on-site laboratory, monitoring station, and weather station.

## Smart Features

The CS-20 is equipped to remotely transmit water quality and alarm data information.

System safeguards keep you compliant in the worst conditions, including automatic re-circulation if needed. The on-site weather station, float system, and text messaging alarm warning provide a safety network unlike any other in the industry.

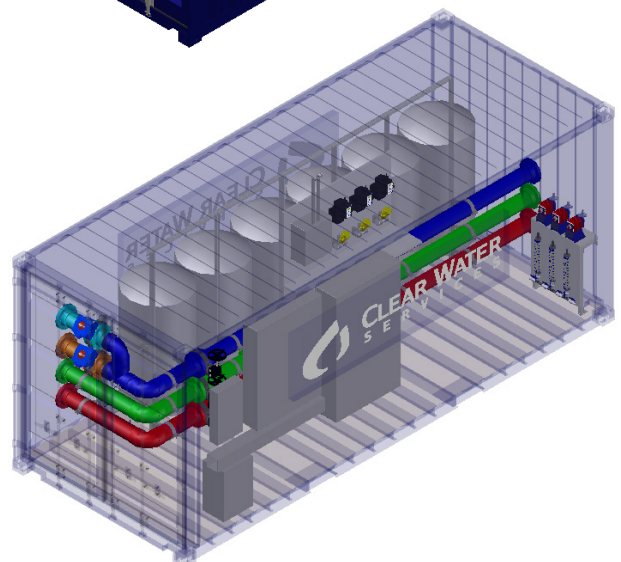
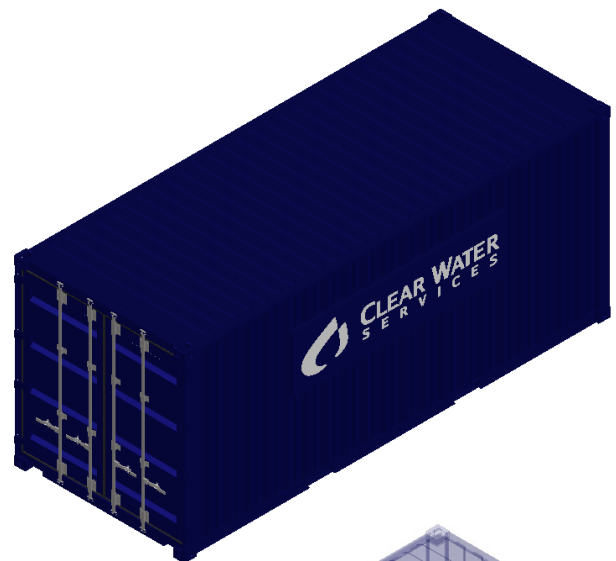

## General overview

Footprint:  
20'L x 9'W x 8'6"H

Exterior sand filters

Control Options:  
Micrologix 1400/1500 PLC  
HMI Interface

Power Requirements:  
100A  
480V 3-phase

Automated Features:  
Discharge Regulated Controls  
Automated Back flush Controls  
Alarm and Text Messaging  
Transmission  
Pump Controls

Chemical Injection Add-On Ready

WA, OR & CA Compliant

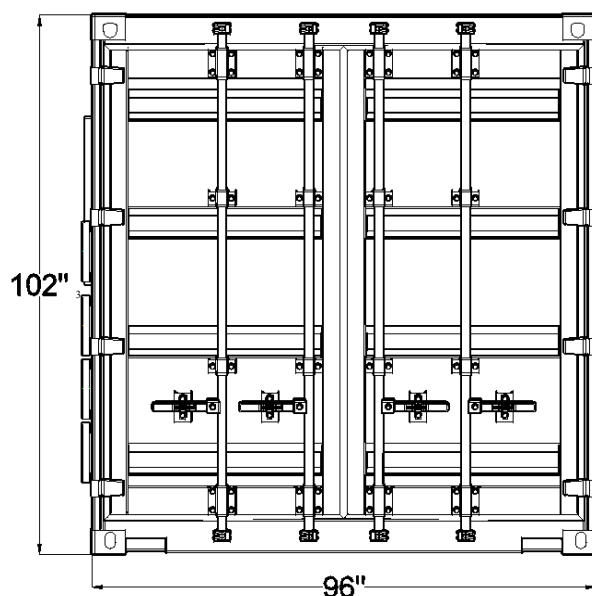
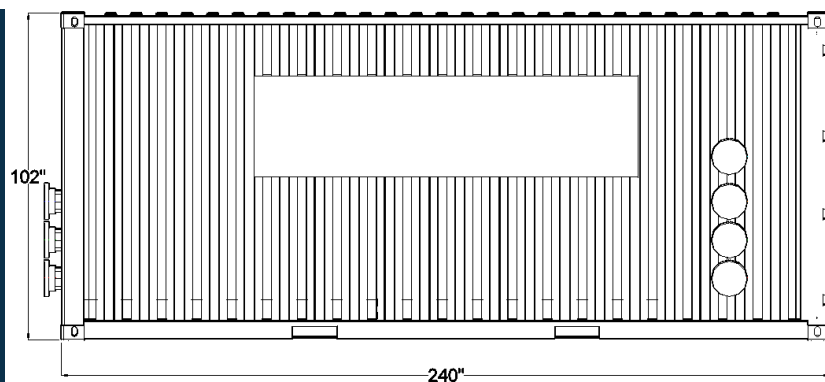

## System features

Modular unit capable of addressing multiple pollutants of concern.

System safeguards to disallow discharges above preset parameters.

Monitoring of influent and discharge water.

Radio telemetric data collection and transmission.

Self contained lab and weather station.

