



The **evoke flush range**



# EVOKE FLUSH

The aluminium system with the **slimmest sightlines on the market**

The Evoke flush range, it's designed for high performance and to be simple to install.

It provides solutions for the typical problems trade installers face with other aluminium systems.

No need for onsite scaffolding, it's quick to glaze and with the unique reverse butt joint option eliminating the need for dummy sashes or adaptors, you can maintain internal glazing with more affordable designs.

The system is 30% slimmer than its main competitors\*, delivering the best sightlines for the bright, light look everyone wants. It can reach WERs of Band A++ and has aesthetics that are at home in both contemporary and traditional properties. It is secure, low maintenance and more sustainable.



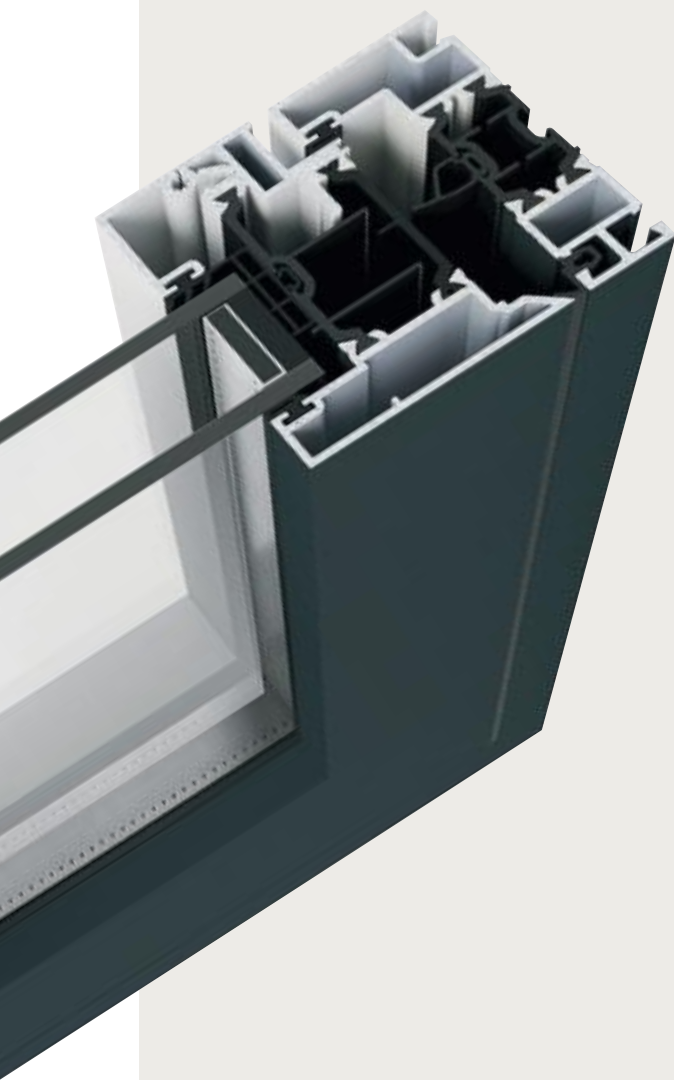

### Less frame, more light

Evoke's frames are 30% slimmer than those of the closest competitor. Based on an internally-glazed GGF standard window, with Evoke, there's an extra 12% glass area.



### Cleaner lines and adaptable style

The Evoke flush range has clean lines and the option of a genuine fully-flush casement. It has a contemporary style that also works with more traditional architecture. With a 36mm cill that replicates timber, it's also ideal for conservation areas.



### Swift installation

Flat rebates are easy to maintain and can save a couple of minutes per sash when fitting glazing packers. Evoke's frames also have a flat back that's easier to pack when you're on site.



### Thermal performance

Strong aluminium sections allow large glazed areas, while advanced thermal break technology ensures no compromise on insulation. Evoke flush can reach a WER of Band A++ and U-values of 0.95W/m<sup>2</sup>K with triple glazing.



### Reduced cost, reduced waste

Evoke uses approximately 30% less aluminium than comparable systems. It's therefore more affordable, more sustainable and less likely to generate waste.



### More integration

Evoke is also compatible with PVC-U cills and trims.



Offers **12% more glass area**



Market-leading slim sightlines - **30% slimmer sightlines** than main competitors



Knock in bead with pre-inserted gasket which makes the system **20% quicker to install**



**Consistent glass lines:** Profile designed to keep the glass aligned for casement and fixed lights



**Innovative patent-pending reverse butt joint:** fabrication without the need for dummy sashes or reverse adaptor profiles



Flush inside and out:  
**choice of two sashes**



**Easy-clean** rebates



Tailed gasket to **improve thermal performance**



# FASTER INSTALLATION



Evolve uses knock-in beads. Without wedge gaskets, glazing is faster.



Flat, easy-clean rebates make glazing packers easy to fit.



Frames are flat backed, so easier to pack during installation.



Internal glazing as standard avoids the need for scaffolding.



Thresholds can be replaced without disturbing the doorframe.

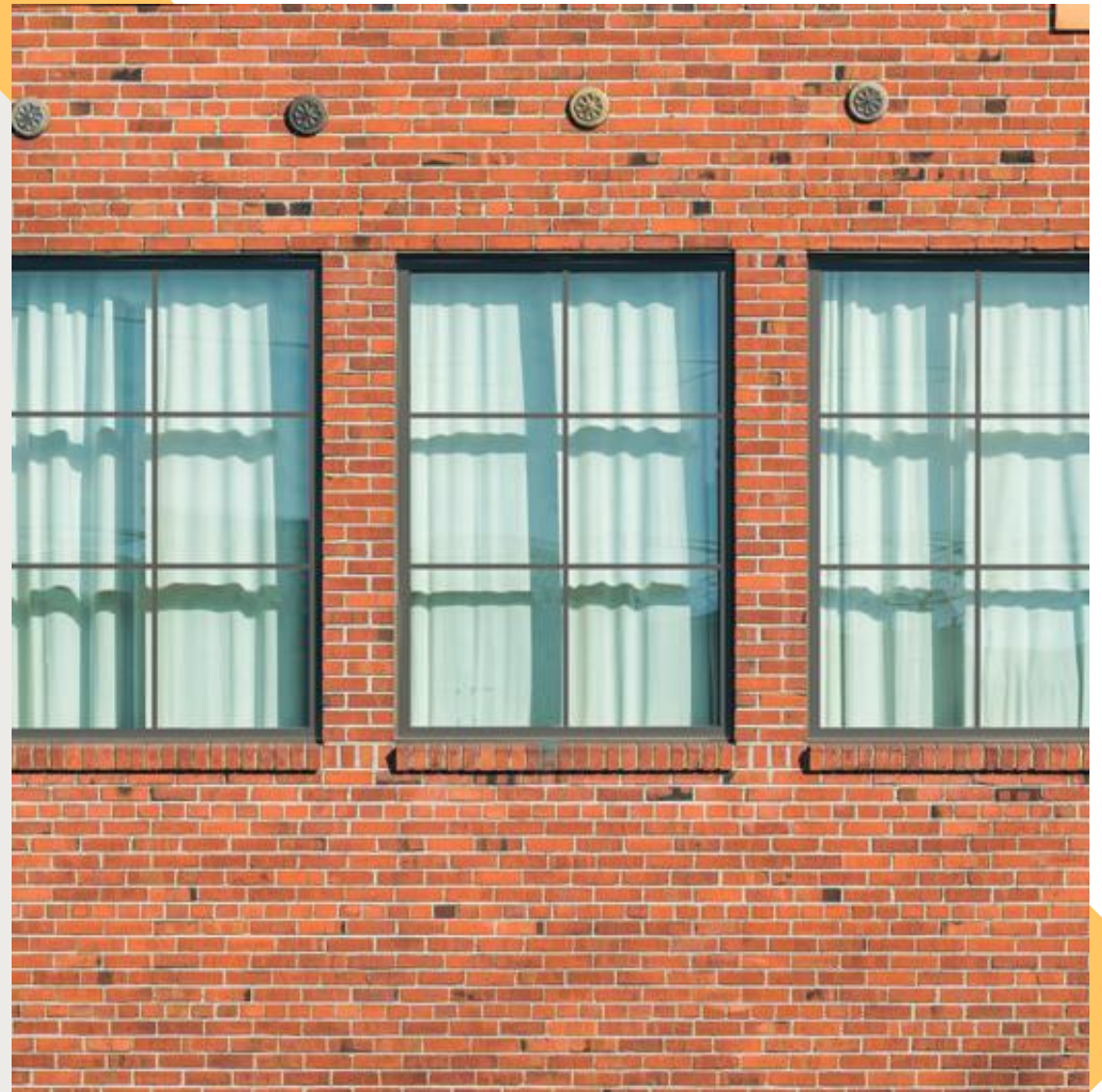

# THE EVOKE WINDOW RANGE

**Everything you need** is included in the Evoke window range.

The system is complete and has dedicated ancillary products so that whatever your customer is looking for, you've got the answer.

The layout of windows – the number of fixed and opening panes, the simplicity of the lines or the extra details that give character – everything is adaptable, and every component is designed to work together.

There are two types of casement: a standard flush design with a stepped shape internally, and a fully-flush option with flush lines inside and outside. Bay and bow windows are no problem – all the assemblies needed, all the trims and all the cills are included in the Evoke system. Where astragal bars are required, Evoke has them. If you want the advantages of a two-part cill, it's yours.

WER  
up to Band  
A++



U-values  
can be as low  
as 0.95W/m²K



Air  
permeability  
tested to 600Pa



Water  
tightness to  
600Pa



Wind load  
resistance to  
2000Pa



Can be  
double or triple  
glazed





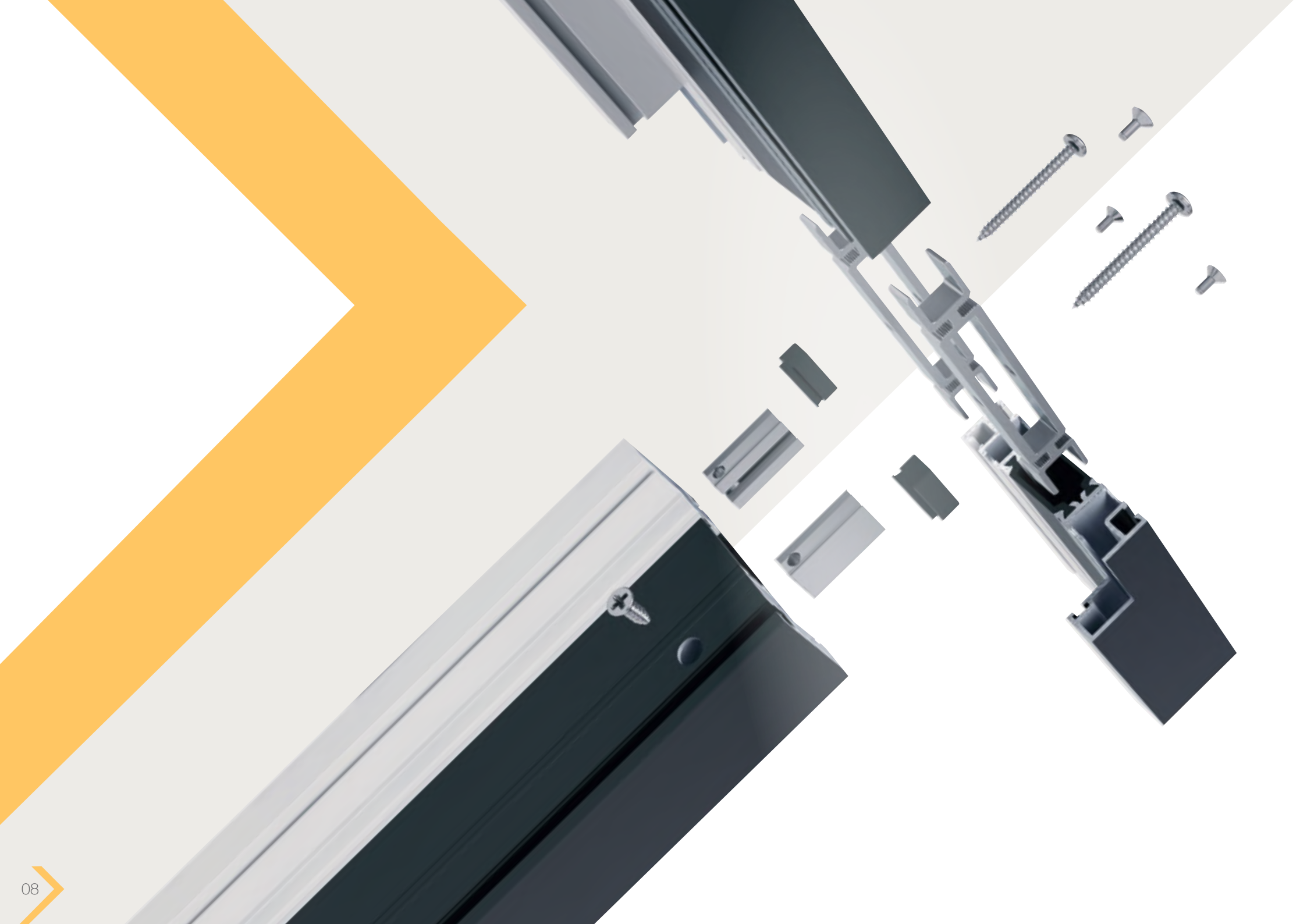

# THE INNOVATIVE REVERSE BUTT JOINT

Most aluminium systems compromise and use dummy sashes, couplers or reverse rebate adaptors to ensure their windows can be internally glazed.

Unfortunately, this detracts from the appearance of windows and uses more resources.

The Reverse Butt Joint from Evoke flush range is unique. It's a patent-pending design which solves the problem, allowing internally glazed windows without the extra, chunky sashes. The window's wonderful slim lines are preserved, and more daylight can enter your home.

- Improved appearance with simple, clean styling
- Internal glazing without compromise
- Uses less material, therefore, more planet friendly
- Lighter, brighter homes
- More affordable design







## Evolve 70 flush casement window

Designed for a flush appearance to the exterior, finished frames have a neat step internally. The system allows for almost any arrangement of top or side-hung sashes and fixed lights, with the revolutionary reverse butt joint removing the need for adaptors and dummy sashes.



### Dimensions

- Side-hung sash – max 721mm x 1321mm
- Top-hung sash – max 1221mm x 1221mm
- Sightline (frame to vent) 61.5mm
- Sightline (vent to mullion) 79.5mm
- Sightline (fix light) 36mm
- Glazing thickness: 28-44mm



### Performance

- WER up to Band A++ with triple glazing
- U-values as low as 0.95W/m²K
- Meets Building Regs without foams or special polyamides.



### Aesthetics

- Market-leading slim sightlines
- Astragal bars
- Thicker cill to replicate timber
- Needs no dummy sashes
- Flush sash
- Square look.



### Installation

- Flat back to frames
- Flat rebates for easy-fit glazing packers
- Knock-in beads.



### Guarantees

- 10-year mechanical performance guarantee
- 25-year surface paint finish guarantee
- Lifetime security guarantee on hardware.







## Evolve 70 fully flush casement window

A true, interior and exterior, fully-flush design that makes the most of Evolve's ultra-slim styling. The advantage of the reverse butt joint allows frames of almost any layout to be made without the complexity or expense of dummy sashes or adaptors.



### Dimensions

- Side-hung sash – max 721mm x 1321mm
- Top-hung sash – max 1221mm x 1221mm
- Sightline: (frame to vent) 75mm
- Sightline: (vent to mullion) 93mm
- Sightline: (fix light) 36mm
- Sightline thickness: 28mm - 44mm.



### Performance

- WER up to Band A++ with triple glazing
- U-values as low as 0.95W/m²K
- Meets Building Regs without foams or polyamides
- 40mm and 45mm polyamide thermal breaks to compensate for larger sightline.



### Aesthetics

- True flush sash indoors and out (no stepped frame)
- Astragal bars
- Market-leading slim sightlines
- Thicker cill to replicate timber
- Needs no dummy sashes
- Square look.



### Installation

- Flat back to frames
- Flat rebates for easy-fit glazing packers
- Up to 44mm triple glazing
- Same bead as fixed light
- Knock-in beads.



### Guarantees

- 10-year mechanical performance guarantee
- 25-year surface paint finish guarantee
- Lifetime security guarantee on hardware.

## Evolve 70 window **cross** section drawings



**External Flush**



**Fully Flush**



**Reverse Butt**

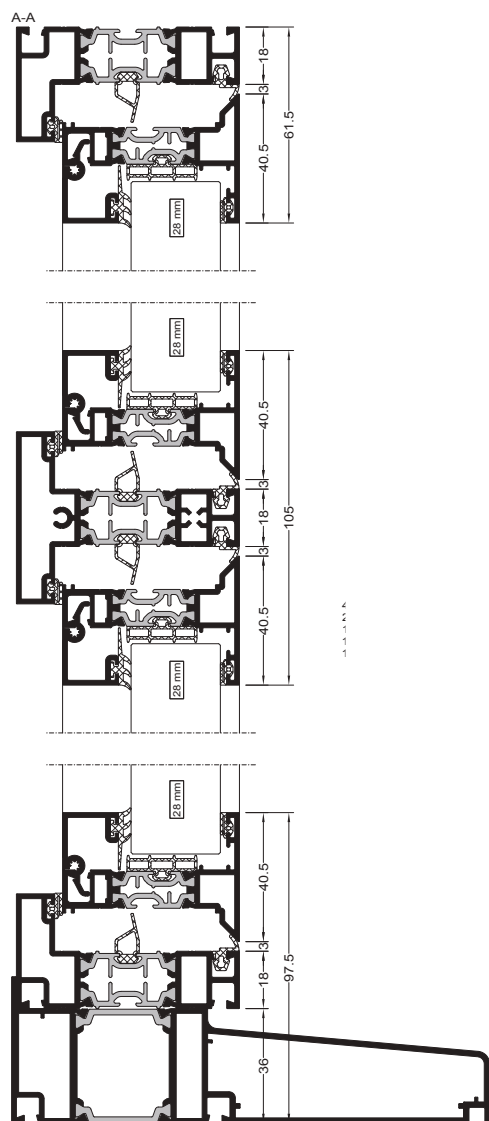

**External Flush**

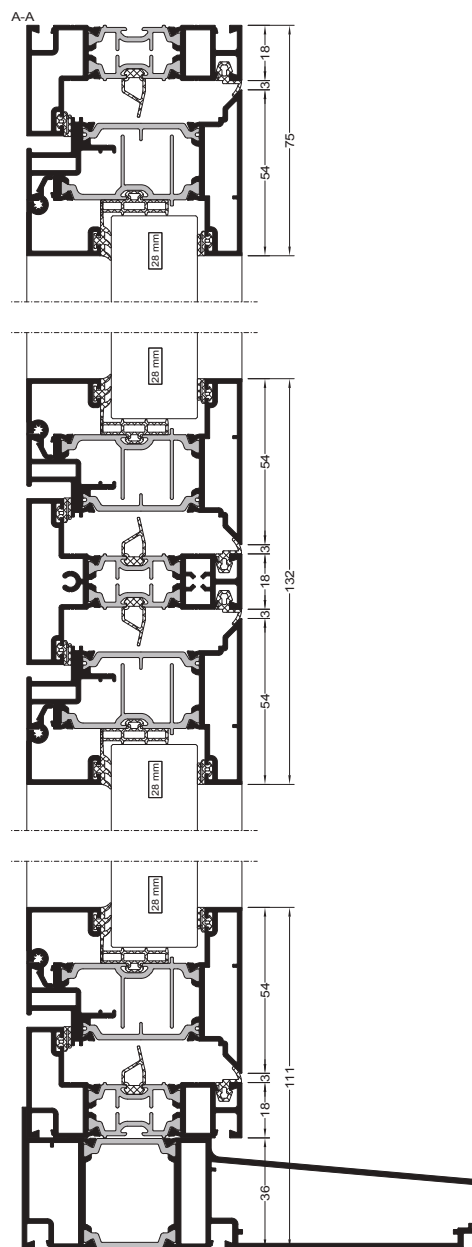

**Fully Flush**

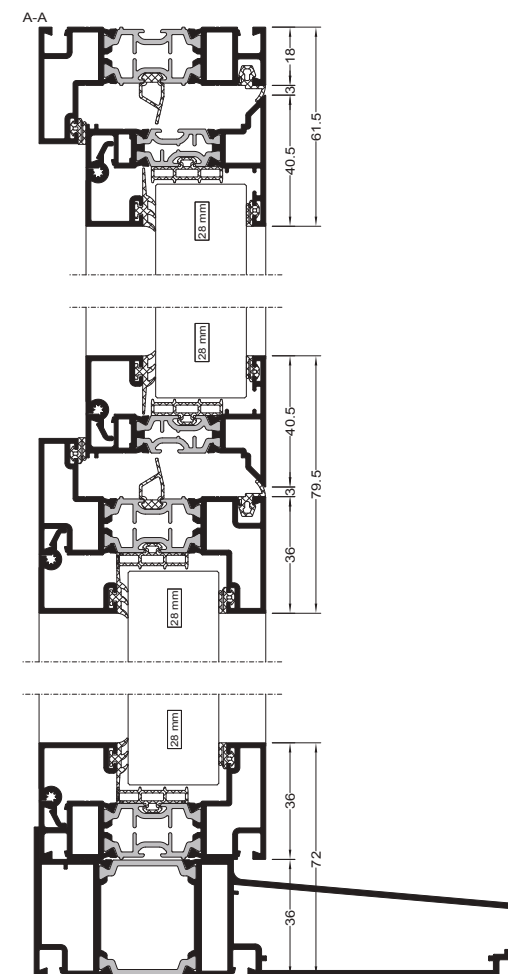

**Reversed Butt**

All cross section drawings shown are when using the WQ01 slim outerframe. Other frames are available as shown on page 18.





## Bay window

Bay and bow windows, like every other part of the Evoke Flush range, can be customised to your project needs. The styling can be kept plain and simple, but it's also possible to incorporate decorative features like glazing bars and stained glass.

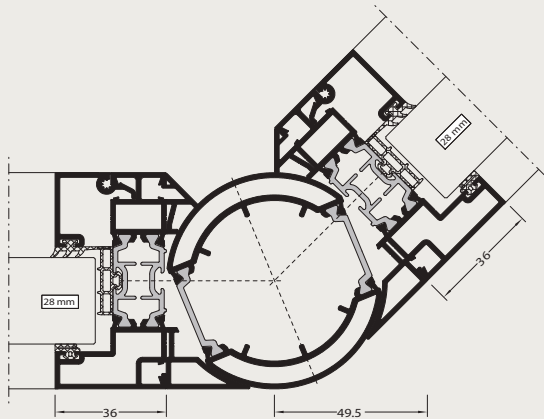

Variable Baypole

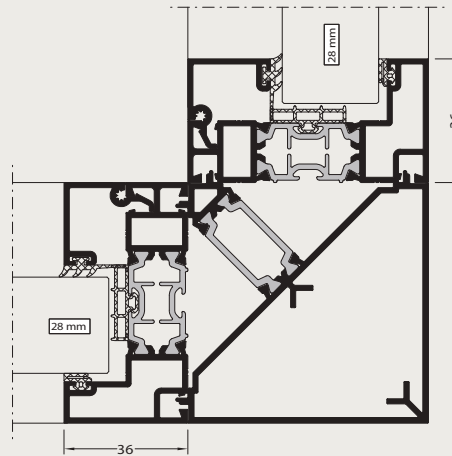

90 degree Baypole

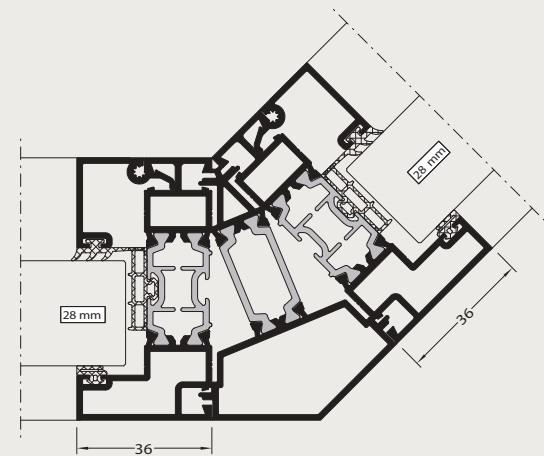

135 degree Baypole

# Aluminium flush casement window and doors main components

## Main profiles

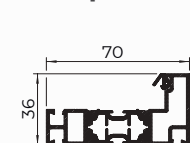

WQ01  
SLIM OUTER FRAME

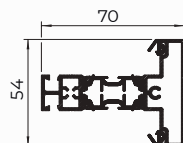

WQ10  
SLIM 'T' MULLION  
WITH SCREW PORTS

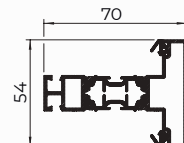

WQ12  
SLIM 'T' MULLION

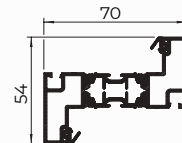

WQ13  
SLIM 'Z' MULLION

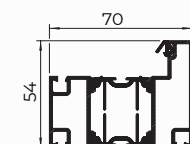

WQ02  
MEDIUM OUTER FRAME

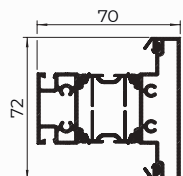

WQ16  
WIDE 'T' MULLION  
WITH SCREW PORTS

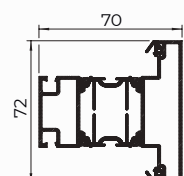

WQ18  
WIDE 'T' MULLION

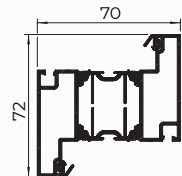

WQ19  
WIDE 'Z' MULLION

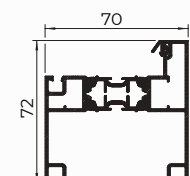

WQ03  
DEEP OUTER FRAME

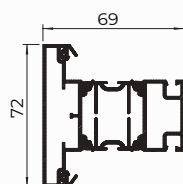

WQ20  
DOOR MIDRAIL

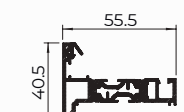

WQ30  
FLUSH SASH

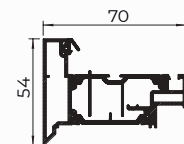

WQ32  
FULLY FLUSH SASH

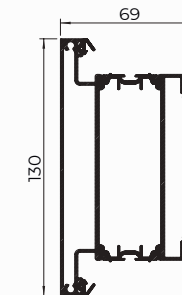

WQ14  
DOOR MIDRAIL

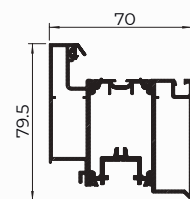

WQ40  
DOOR 'Z' SASH

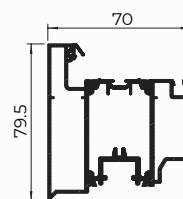

WQ41  
DOOR 'T' SASH

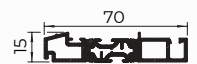

WT01  
OPEN IN LOW  
THRESHOLD



WT02  
OPEN OUT LOW  
THRESHOLD

## Glazing beads



WQ50  
28mm BEAD



WQ51  
32mm BEAD



WQ52  
36mm BEAD



WQ54  
44mm BEAD



WQ55  
28mm BEAD  
FLUSH SASH



WQ56  
32mm BEAD  
FLUSH SASH



WQ57  
36mm BEAD  
FLUSH SASH



## Aluminium flush casement window and doors **70mm accessories**

### Ancillaries

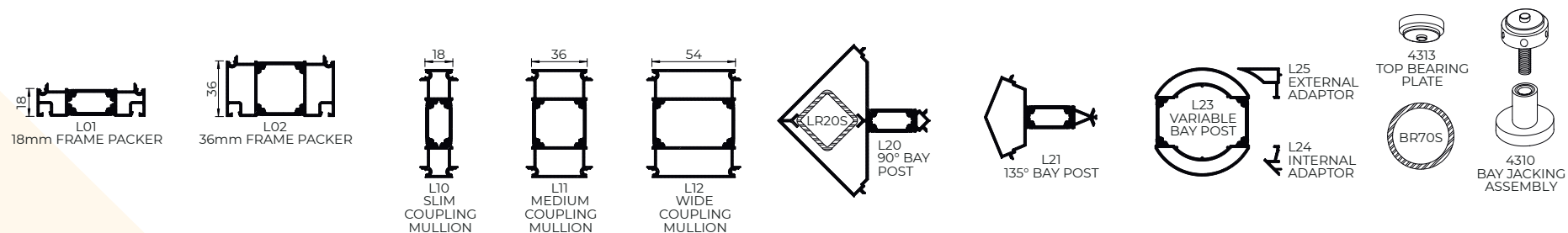

### Cills

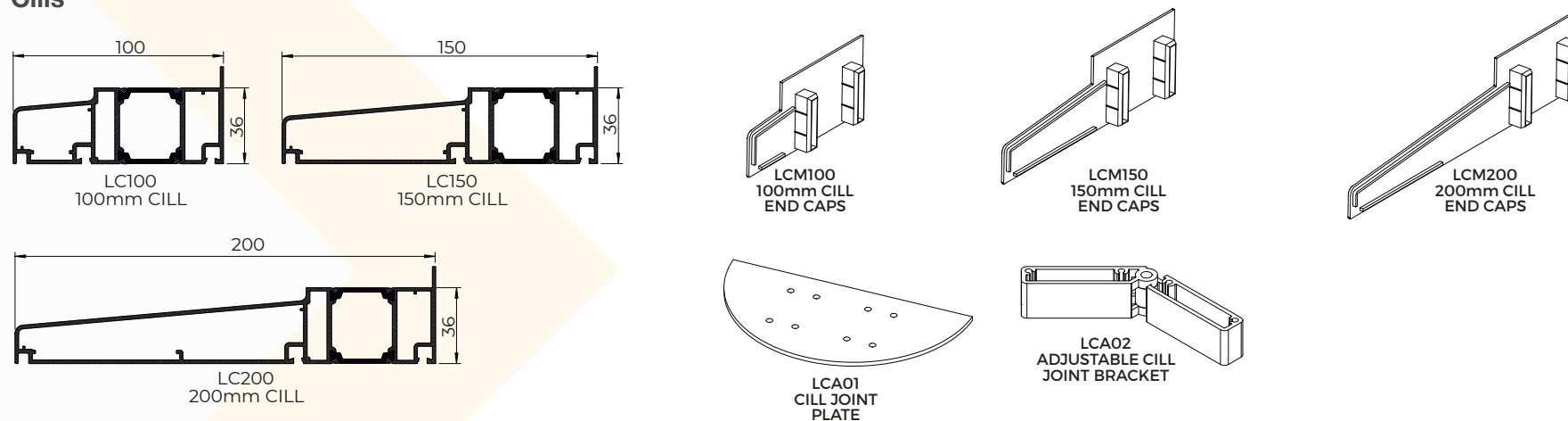

# Evolve flush handles

We have selected products known for their reliability, ease of use and durability, and every item in the range has undergone rigorous testing. The range includes styles and finishes to suit all projects.

## Casement window

Evolve's Flush and Fully Flush windows utilise high-quality hardware throughout. Friction stays are robust and reliable. Espags have been selected for ease of fitting, PAS24 compliance and corrosion resistance. Handles are proven, stylish and benefit from key locking and easy operation. Hinge protectors and cavity locking blocks are simple to adjust and easy to work with. For extra piece of mind all PAS24 compliant casement windows come with Yale's Lifetime Security Guarantee.

## Flush door

Security, weather protection and ease of use were paramount in the selection of hardware for both Evolve's flush residential door and the French doors, but style hasn't been forgotten – handles suite perfectly with window handles and letterplates have clean modern styling and an immaculate finish. Doors fitted with the Yale 3-star cylinder and conforming to PAS24 carry the Yale Lifetime Security Guarantee. All door hardware is easy to fit, quick to adjust and proven for long-term



## Evoke flush finishes

Colour can make a huge difference to the overall success of a glazing project, and in architectural terms, it can be a fundamental part of the whole project. That's why Evoke's colour palette isn't limited.

Different eras and building materials demand different finishes, sometimes subtle, sometimes bold. We can supply profiles finished with any gloss level, in any RAL colour, or any dual colour combinations. There really is no limit to the colours you can choose, enabling you to satisfy more customers and fulfil the aesthetic requirements of more construction projects.

All Evoke's aluminium sections are finished with a tough, durable polyester powder coat, certified to the Qualicoat standard, which surpasses European requirements. In addition, we can supply special marine-grade finishes for more challenging environments.



### Standard Stock

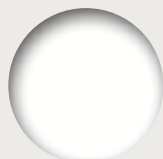

**Signal White**  
Flat/Matt  
RAL 9003



**Anthracite Grey**  
Flat/Matt  
RAL 7016

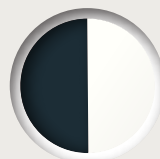

**Anthracite Grey/  
Signal White**  
Flat/Matt  
RAL 7016 / 9003



**Jet Black**  
Flat/Matt  
RAL 9005

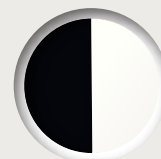

**Jet Black/  
Signal White**  
Flat/Matt  
RAL 9005 / 9003

### Made to order



**Cream**  
Flat/Matt  
RAL 9001

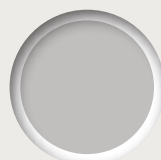

**Agate Grey**  
Flat/Matt  
RAL 7038



**Slate Grey**  
Flat/Matt  
RAL 7015



**Chocolate Brown**  
Flat/Matt  
RAL 8017



**Anthracite Grey**  
Textured  
RAL 7016

All above colours are Evoke standard stock and non stock finishes. All other RAL colours or any dual colour combinations, gloss levels are available on request.