



PERFORMANCE FEATURES

UL Listing

Suitable for damp locations

LEDs:

Long-life, high-efficacy, micro-power LEDs

Lifespan:

Lumen Maintenance, L70 > 54,000 hours
 Rated Life: 100,000 hours

Housing and lens

Sheet metal stamping
 Frosted polystyrene lens

Optional Accessories

- Surface mount kit
- Cable suspending mounting kit

Finish

Long lasting white finish with high durability

Ambient Operating Temp.

-20°C (-4°F) to 50°C (122°F)

Dimming Driver:

Driver includes dimming control wiring for 0-10V dimming systems. The dim-to-off voltage threshold of optional 12V AUX integrated driver ranges from 0.1V to 0.5V.

Flickers

Produce no greater than 30 percent flicker at 200 Hz or below when paired with control devices per CEC Title 24 JA10

Mounting

Recessed ceiling mounting ready
 Suspended installation with optional accessories

IESNA LM-79 & IESNA LM-80 Testing:

LED luminaires have been tested based on IESNA LM-79 and LM-80 by a third-party laboratory

SKU GUIDE

Model Section		DPS-24-U-P-ET-4						
DPS-24				U	P	ET	4	
BODY TYPE PREFIX	MODEL NAME	WATTAGE	CCT (if selectable = CCT)	DRIVER	VOLTAGE	DLC		Qty Per Carton
DPS	14 - 1x4 FT	30/25/20	3500/	D - 0-10V Dimming	U - 120-277V (Universal Voltage)	P - Premium	NA	4-Pack
	22 - 2x2 FT	30/25/20	4000/					
	24 - 2x4 FT	40/35/30	5000K					

Available Options	
Emergency Backup	Controls
EM1400 1400lm EM2000 2000lm	OS Occupancy Sensor OSDL Occ. Sensor w/ Daylight OSDL/BT Wireless Bluetooth Occupancy Sensor OSDL/IR Multi-Level Occ Sensor w/ wireless config. OSDL/BTEZ-B Simple Occupancy Sensor

SKU SPECIFICATION

SKU #	Nominal Wattage	CCT	Lumens	Efficacy (LPW)	CRI	Input Voltage	Operating Temp.	Certifications	Avail Options
DPS-14-U-P-ET-4	30/25/20	3500/ 4000/ 5000K	3750/ 3125/ 2500	125	>80	120-277V	-4(Degree) F/ -20(Degree)C to 122(Degree) F/-50(Degree) C	UL listed DLC listed	EM battery backup
DPS-14-U-P-S-ET-4	30/25/20	3500/ 4000/ 5000K	3750/ 3125/ 2500	125	>80	120-277V	-4(Degree) F/ -20(Degree)C to 122(Degree) F/-50(Degree) C	UL listed DLC listed	Sensor EM battery backup
DPS-22-U-P-ET-4	30/25/20	3500/ 4000/ 5000K	3750/ 3125/ 2500	125	>80	120-277V	-4(Degree) F/ -20(Degree)C to 122(Degree) F/-50(Degree) C	UL listed DLC listed	EM battery backup
DPS-22-U-P-S-ET-4	30/25/20	3500/ 4000/ 5000K	3750/ 3125/ 2500	125	>80	120-277V	-4(Degree) F/ -20(Degree)C to 122(Degree) F/-50(Degree) C	UL listed DLC listed	Sensor EM battery backup
DPS-24-U-P-ET-4	40/35/30	3500/ 4000/ 5000K	5000/ 4375/ 3750	125	>80	120-277V	-4(Degree) F/ -20(Degree)C to 122(Degree) F/-50(Degree) C	UL listed DLC listed	EM battery backup
DPS-24-U-P-S-ET-4	40/35/30	3500/ 4000/ 5000K	5000/ 4375/ 3750	125	>80	120-277V	-4(Degree) F/ -20(Degree)C to 122(Degree) F/-50(Degree) C	UL listed DLC listed	Sensor EM battery backup

PRODUCT DIMENSIONS

2x4 FT

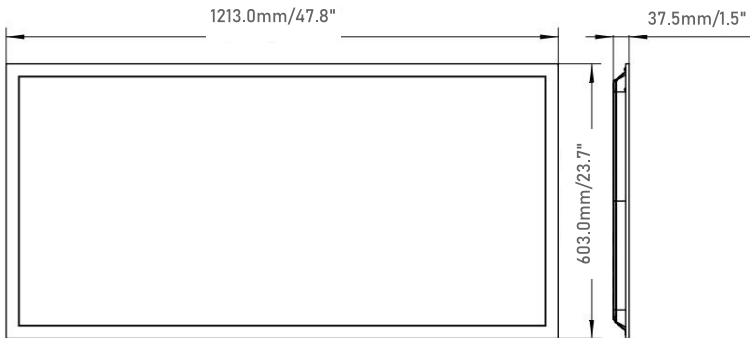

Product Weight : 4.18Kg/9.22lb

2x2 FT

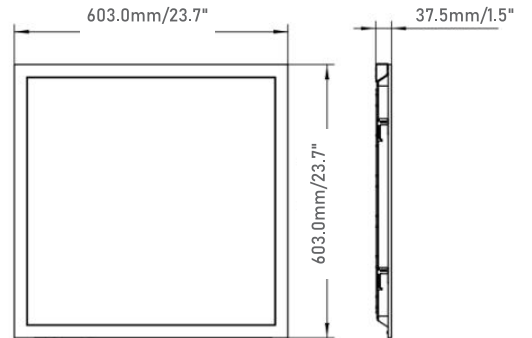

Product Weight : 2.62Kg/5.78lb

1x4 FT

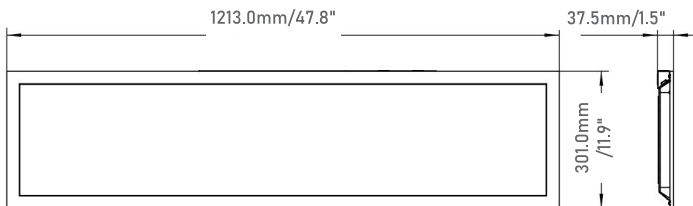

Product Weight : 2.01Kg/4.43lb

PACKAGING DIMENSIONS

SKU #	Standard Pack	Dimension
DPS-14-U-P-1	2 Pack	L 49.2 in x W 13.3in x H 7.3in
DPS-22-U-P-1	2 Pack	L 25.2in x W 25.2in x H 7.3in
DPS-24-U-P	2 Pack	L 49.2in x W 25.2in x H 7.3in

ACCESSORIES



Surface mounting
kit for panel

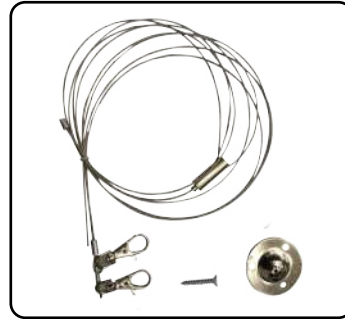

Cable kit
for panel

PHOTOMETRICS

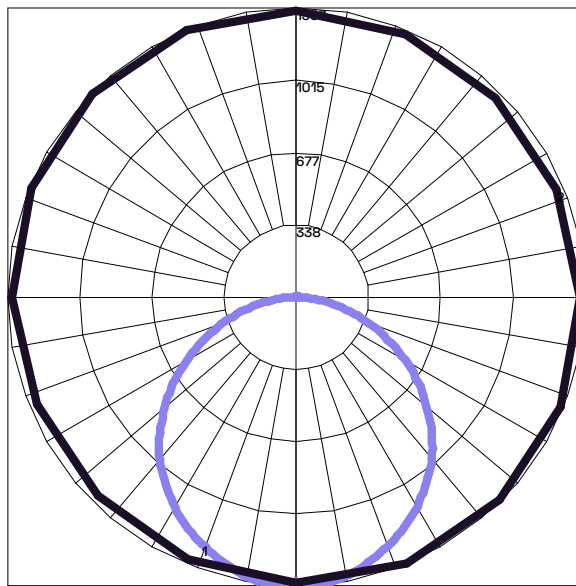

Maximum Candela = 1353.2 Located At Horizontal Angle = 112.5, Vertical Angle = 5
 # 1 - Vertical Plane Through Horizontal Angles (112.5 - 292.5) (Through Max. Cd.)
 # 2 - Horizontal Cone Through Vertical Angle (5) (Through Max. Cd.)