

8 PREPARATION AND MAINTENANCE OF THE PROBES FOR THE MEASUREMENT OF MICROCLIMATIC INDICES

Probes necessary for **WBGT** index measurement:



Probes necessary for **PMV/PPD** indices measurement:



The probes are already factory calibrated. The calibration data are stored in the SICRAM module memory.

TP3575 and TP3276.2 globe thermometer probes

Screw the globe to probe stem.



HP3201.2 and HP3201 natural ventilation wet bulb probes

- Remove the sensor cap (the cap is not screwed).
- Insert the cotton wick, previously dipped with distilled water, into the temperature probe. The cotton wick must protrude from the probe for about 20 mm.
- Fill the reservoir up till $\frac{3}{4}$ with **distilled water**.
- Replace the cap.
- **Warning:** keep the probe vertical to prevent water from leaking.



Note: over time the cotton wick tends to calcify (harden): it must be replaced periodically.

TP3204S natural ventilation wet bulb probe

- Remove the sensor cap (the cap is not screwed).
- Insert the cotton wick, previously dipped with distilled water, into the temperature probe. The cotton wick must protrude from the probe for about 20 mm.
- Replace the cap.
- Fill the bottle with 500 cc of **distilled water**.
- Turn the probe over and firmly screw the bottle to the probe reservoir.
- Turn the probe quickly (to avoid water spillage).
- Secure the probe to the **SP32TC** support.

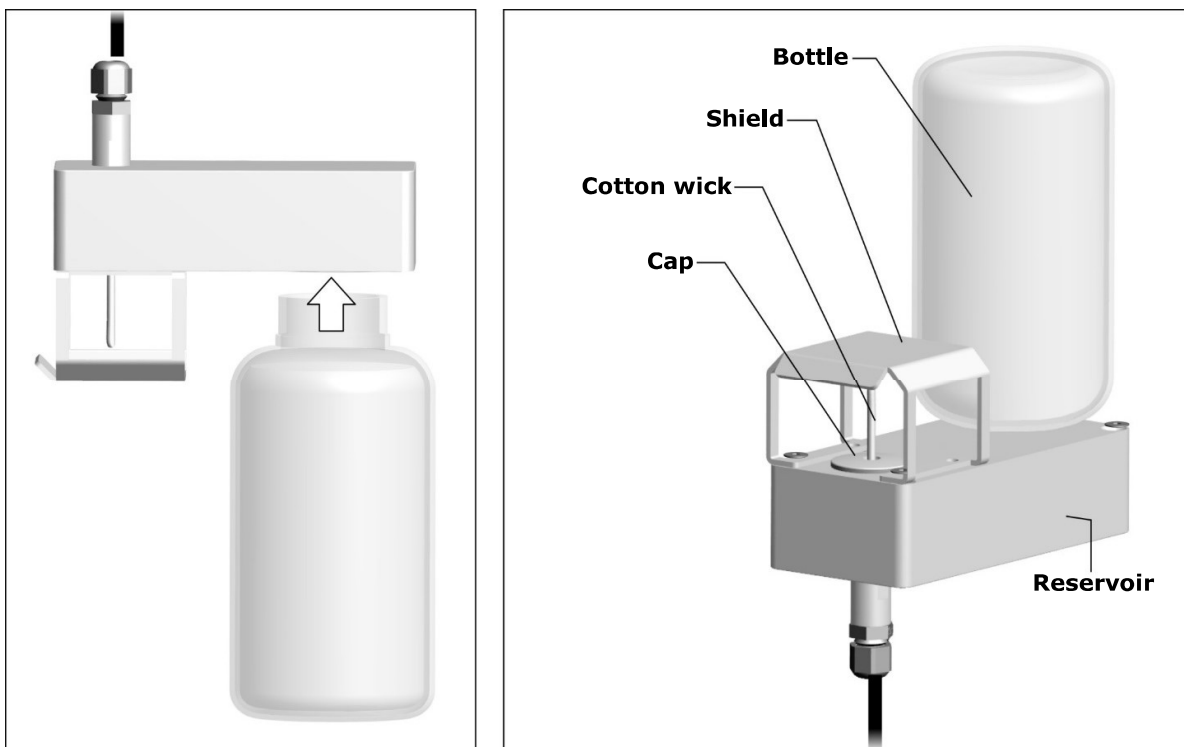

For measurements in presence of solar irradiation, use the protection shield from solar radiations.

Note: over time the cotton wick tends to calcify (harden): it must be replaced periodically.

HP3217R and HP3217.2R combined relative humidity and temperature probes

- Do not touch the sensors with the hands; avoid dirtying them with oils, greases or resins.
- The sensors can be cleaned by the dust and pollution by using a very soft brush (e.g. badger) soaked in distilled water.
- To **check** the appropriateness of the relative humidity measurement, the saturated salt solutions **HD75** (75 %RH) and **HD33** (33 %RH) can be used.
- If the measurements are not appropriate, check that the sensors are not dirty, corroded, chipped or broken.

AP3203 and AP3203.2 omnidirectional hot wire air speed probes

Unscrew the sensor protection cylinder and screw the spherical metal grid.

