

NOTES:

1. TANK IS MANUFACTURED FROM HDPE OR XLPE. (1.5, 1.9, OR 2.2 SG)
2. TANK IS MANUFACTURED TO ASTM-D-1998 STANDARD.
3. ALL TANK DIMENSIONS ARE SUBJECT TO A +/-3% TOLERANCE.
4. FLEXIBLE COUPLINGS ARE REQUIRED FOR ALL EXTERNAL PIPING.
5. ALL FITTING GASKETS ARE EPDM OR VITON.
6. ACO RECOMMENDS ALL FLANGE GASKETS TO BE MIN. 1/4" THICK.
7. ON LARGER SIZED TANKS SOME MECHANICAL FITTINGS MAY NEED TO BE REMOVED IN ORDER TO AVOID WIDE OR OVERSIZED LOADS.
8. HDPE ALIGNMENT WEDGES ARE REQUIRED ON SOME TOP FITTINGS TO KEEP THEM PERPENDICULAR TO THE GROUND.
9. TANK MUST BE PROPERLY VENTED TO PREVENT PRESSURE OR VACUUM FROM DEVELOPING AS THE TANK IS FILLING OR EMPTYING.
10. ONLY ONE BOTTOM OUTLET FITTING MAY BE INSTALLED.
11. BOTTOM OUTLET FITTING MAY ONLY BE INSTALLED ON A FITTING FLAT LOCATED AT 0°, 90°, 180° OR 270°.
12. CONTAINMENT TANK IS 1.5SG AS STANDARD.

MATERIALS LIST		
ITEMS	DESCRIPTION	NOTES
A	DMT-2205 PRIMARY TANK	
B	DMT-2205 CONTAINMENT TANK	
C	16" LID WITH LOCKING STRAP	

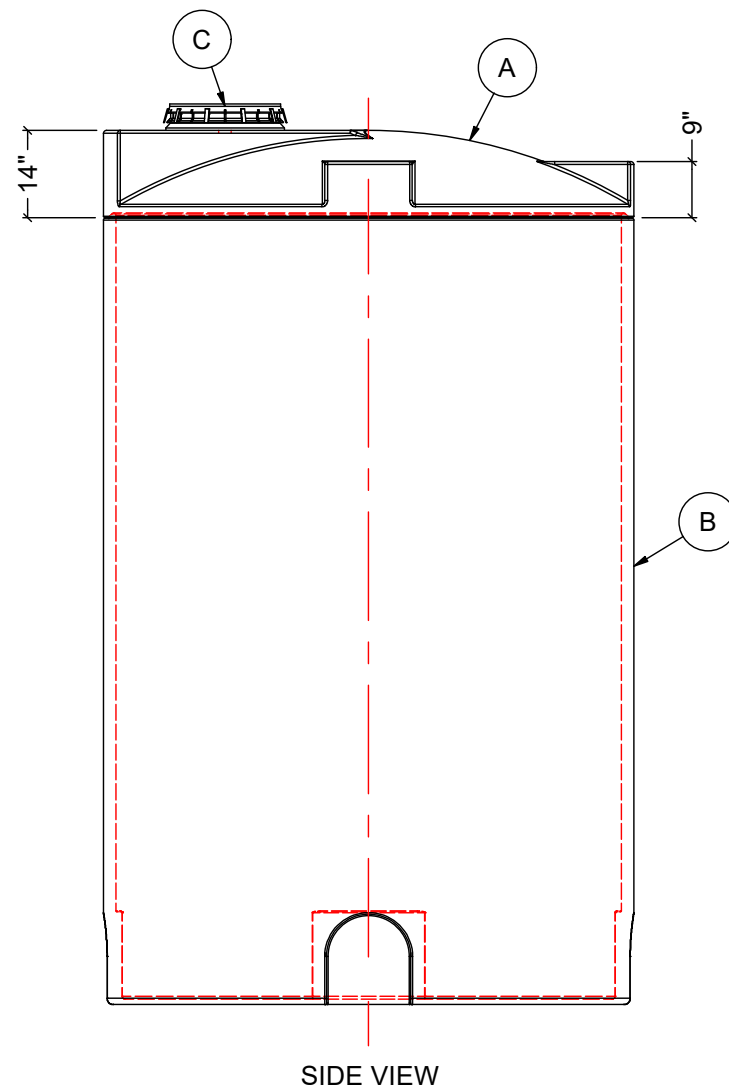
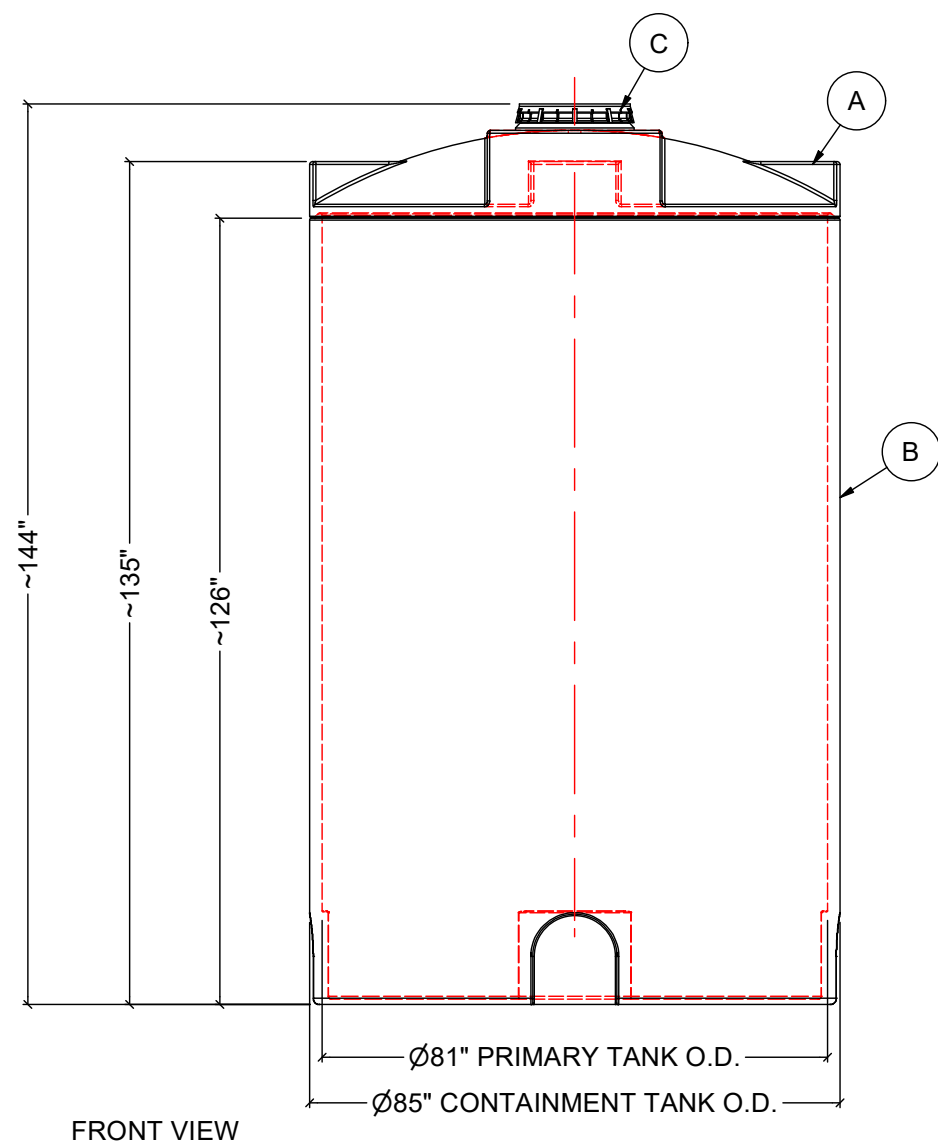
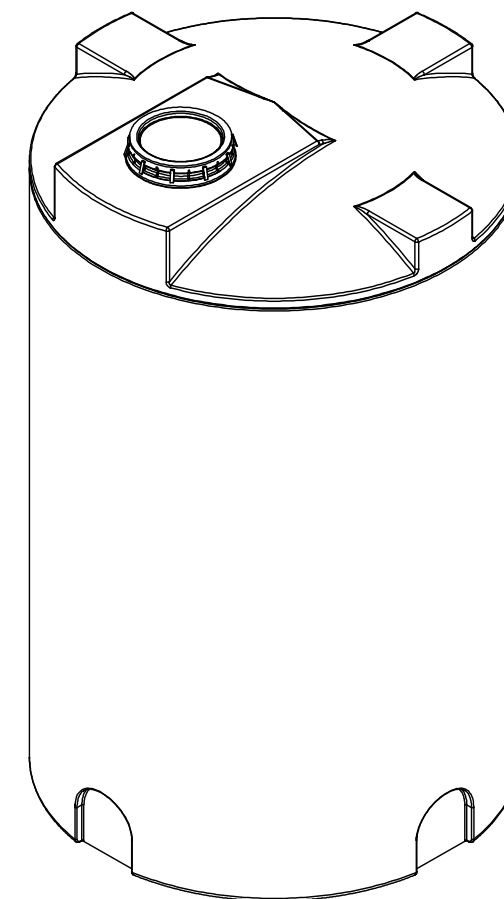

D-10000 | Volume: 10,000 Litres / 2650 US Gals



PERCHERON
PLASTIC INC.

Percheron Plastic Inc. | 789 O'Brien Drive, Peterborough, ON, K9J 6X7 Canada
www.percheronplastic.com | T: 800.780.3609 | E: sales@percheronplastic.com