

CERTIFICATION

CWCT TN66:  
Safety and fragility of glazed roofing: guidance on specification.  
CWCT TN67:  
Safety and fragility of glazed roofing: testing and assessment.



NBS SPECIFICATION

CAWS  
L10 /45 Rooflights  
L10/460 Rooflights

Uniclass category  
Pr\_30\_59\_72

84mm Painted border shown as standard to cover  
glazing frame.

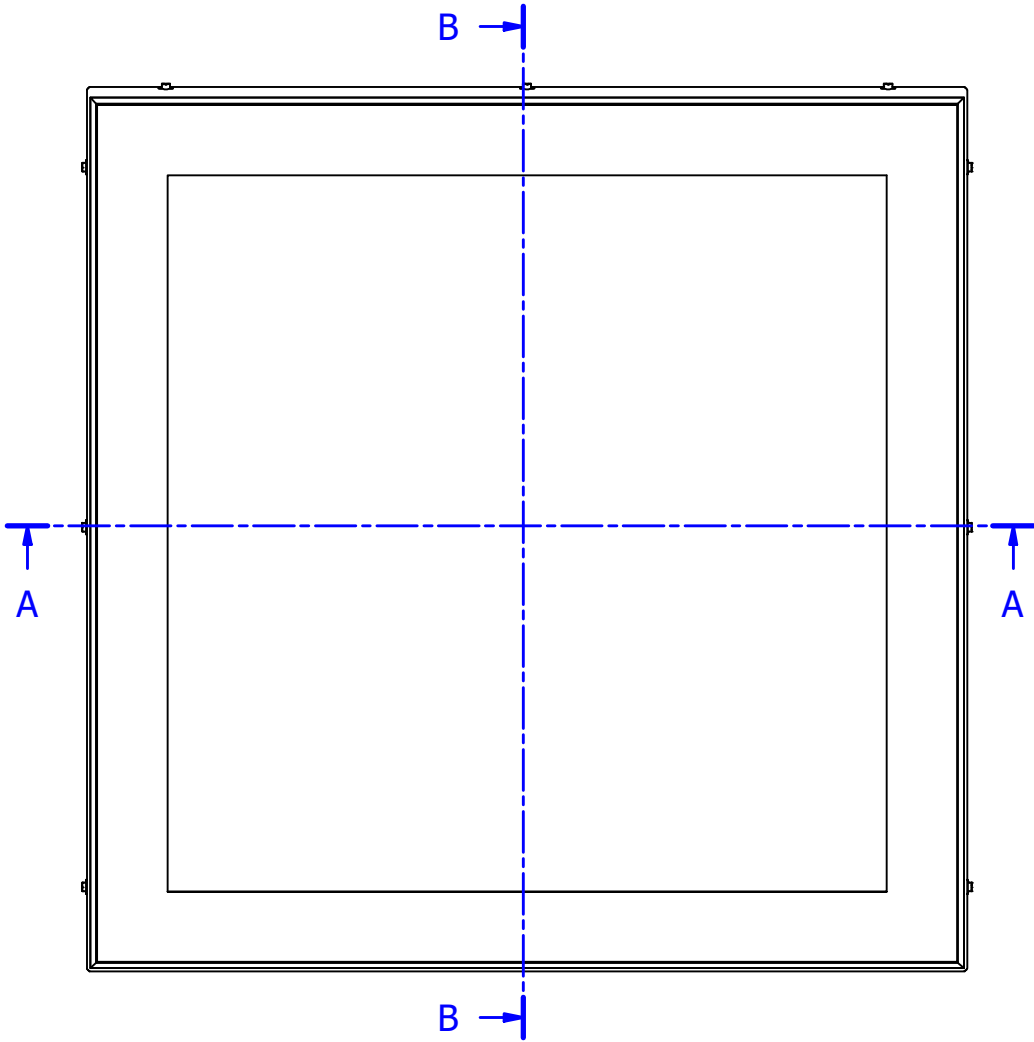

Section A-A

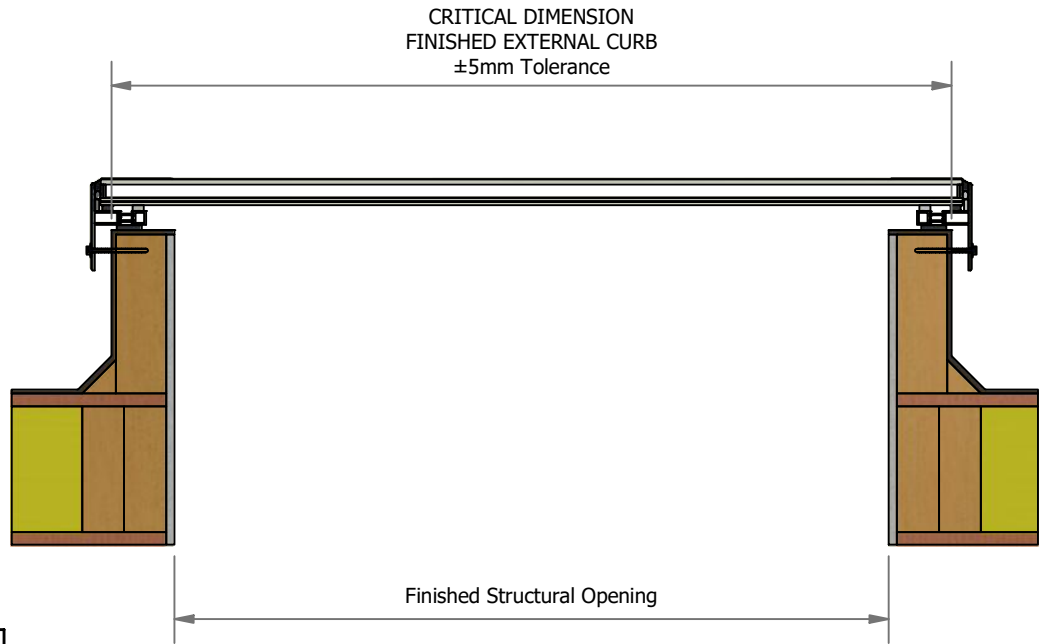

This drawing is for visual purposes only,  
for exact specifications of the glazing and sizes,  
please refer to the specific line(s) on your quote.

Thermal Stress Note

To provide the highest performance of non fragility and security, the unit incorporates laminated internal panes.  
For standard (annealed) laminate inner panes, guidance regarding thermal stress fracture risk is available on Whitesales website or by contacting Whitesales technical team.  
To reduce risk it is recommended to keep curb widths under 120mm, avoid partial shading or rapid internal heating or cooling direct or close to the glass.  
If higher risks cannot be mitigated then alternative heat strengthened or toughened glass inner panes should be considered.



Curb details shown are indicative only. Detail is designed by others.  
It is the responsibility of the curb designer to ensure that the curb is structurally adequate to support the rooflight product.

Whitesales advise an installation with a minimum pitch of 5° for Rooflight units to minimise water pooling. Whilst the product can be installed flat without detriment to the warrantee. Whitesales cannot be held responsible for any excessive pooling of water to the surface of the Rooflight post installation.

**CAUTION CDM: Hazard Identification - Handling materials**  
Manual Handling Operations Regulations (MHOR 1992) sets out a clear ranking of measures for dealing with risks from manual handling. Ensure measures are considered at all times. Other measures:



- Hand protection (mandatory) to: BS EN 388:1994.
- Wear appropriate PPE required for the task.
- Refer to applicable risk assessment for further details.

THIS DRAWING MUST  
NOT BE COPIED OR  
PASSED TO A THIRD  
PARTY WITHOUT  
WRITTEN CONSENT  
FROM THE  
MANUFACTURER

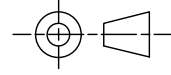

Section B-B

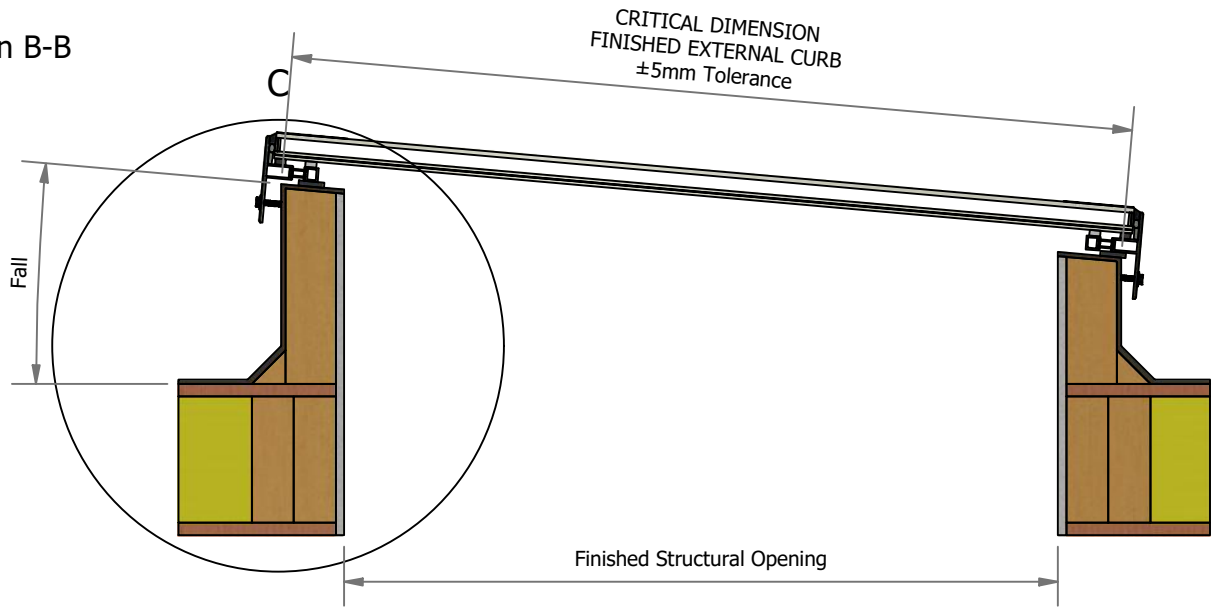

Thermally Broken  
Aluminium Ring Frame  
Finished to RAL7016

Frame Fixings  
Finished to RAL7016

Detail C

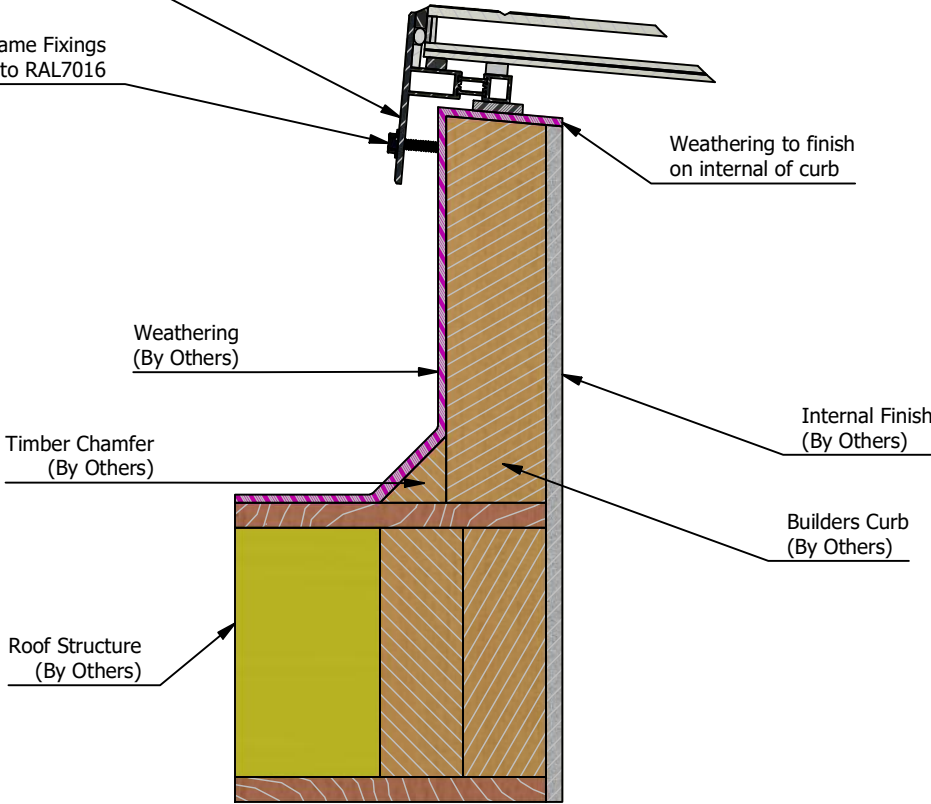

CERTIFICATION

CWCT TN66:  
Safety and fragility of glazed roofing: guidance on specification.  
CWCT TN67:  
Safety and fragility of glazed roofing: testing and assessment.



NBS SPECIFICATION

CAWS  
L10 /45 Rooflights  
L10/460 Rooflights

Uniclass category  
Pr\_30\_59\_72

84mm Painted border shown as standard to cover glazing frame.

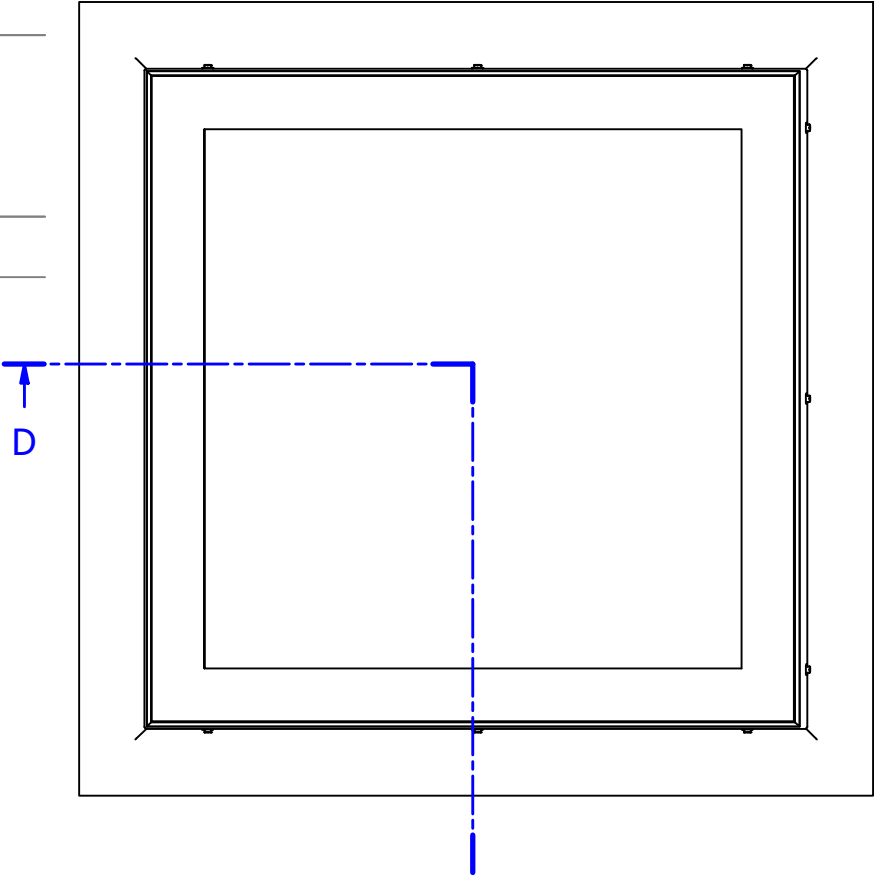

Section D-D

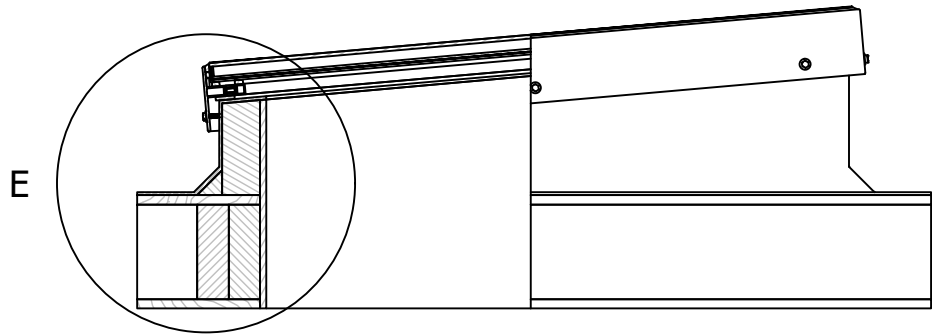

Detail F

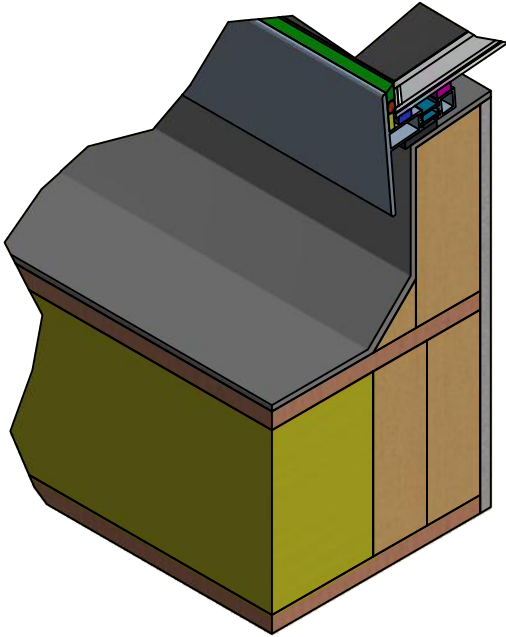

Detail G

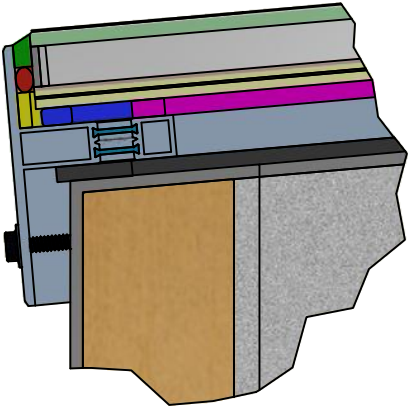

Detail E

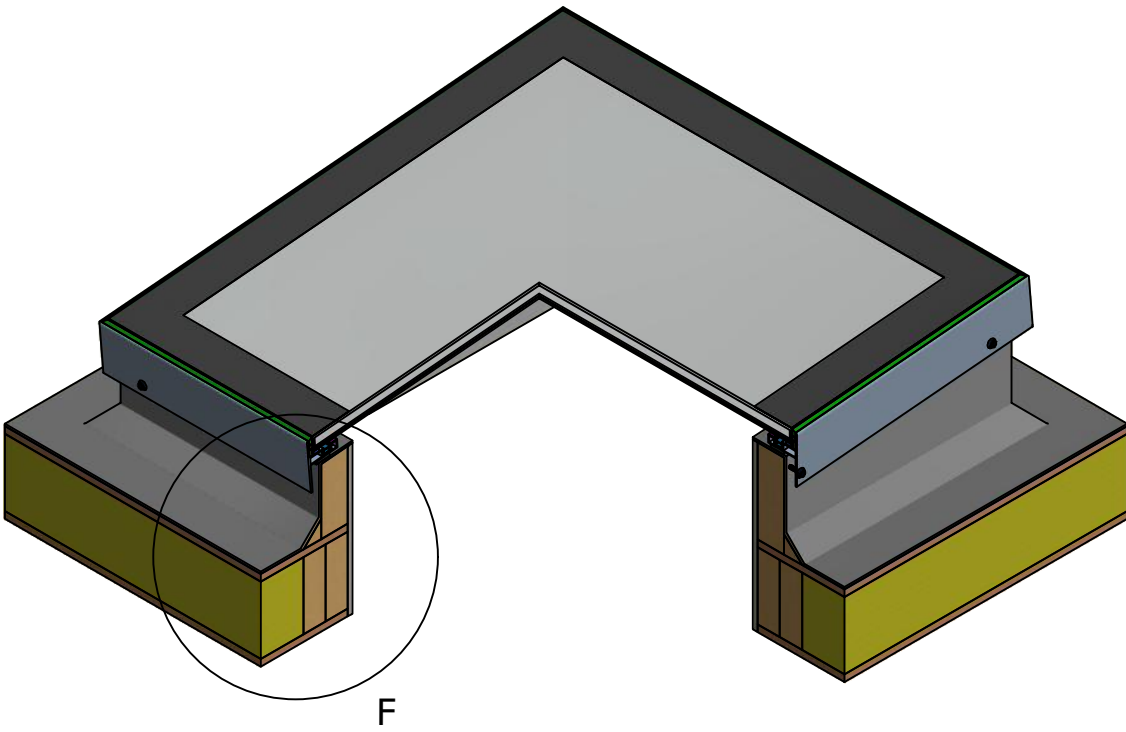
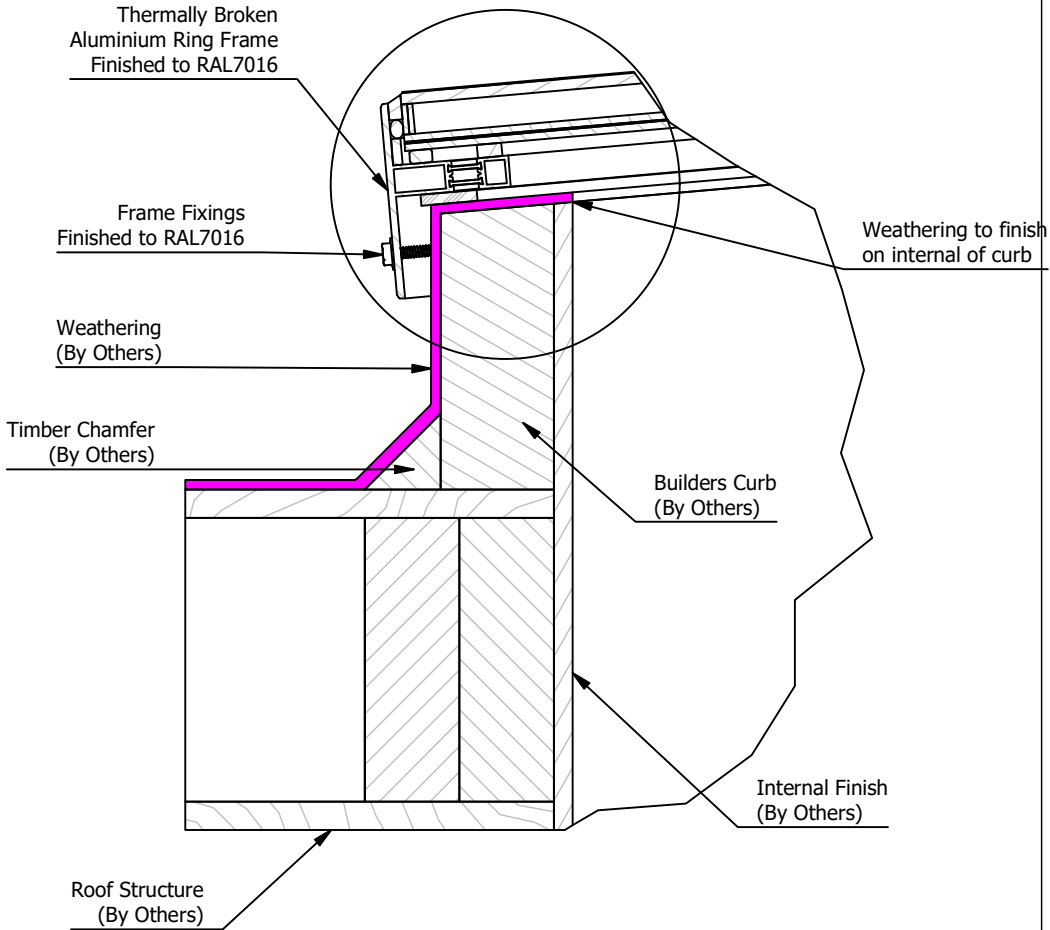

This drawing is for visual purposes only,  
for exact specifications of the glazing and sizes,  
please refer to the specific line(s) on your quote.

Thermal Stress Note

To provide the highest performance of non fragility and security, the unit incorporates laminated internal panes.  
For standard (annealed) laminate inner panes, guidance regarding thermal stress fracture risk is available on Whitesales website or by contacting Whitesales technical team.  
To reduce risk it is recommended to keep curb widths under 120mm, avoid partial shading or rapid internal heating or cooling direct or close to the glass.  
If higher risks cannot be mitigated then alternative heat strengthened or toughened glass inner panes should be considered.



Curb details shown are indicative only. Detail is designed by others.  
It is the responsibility of the curb designer to ensure that the curb is structurally adequate to support the rooflight product.

Whitesales advise an installation with a minimum pitch of 5° for Rooflight units to minimise water pooling. Whilst the product can be installed flat without detriment to the warrantee. Whitesales cannot be held responsible for any excessive pooling of water to the surface of the Rooflight post installation.

**CAUTION CDM: Hazard Identification - Handling materials**  
Manual Handling Operations Regulations (MHOR 1992) sets out a clear ranking of measures for dealing with risks from manual handling. Ensure measures are considered at all times. Other measures:



- Hand protection (mandatory) to: BS EN 388:1994.
- Wear appropriate PPE required for the task.
- Refer to applicable risk assessment for further details.

THIS DRAWING MUST  
NOT BE COPIED OR  
PASSED TO A THIRD  
PARTY WITHOUT  
WRITTEN CONSENT  
FROM THE  
MANUFACTURER

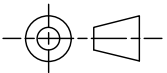

Title:

Assembly Drawing

Project No

x

Project

x

Customer Name

x

Project Address

xxx

Description

Double Glazed Unit

Ref No

x

Part Number

em.glaze

Material

Varies

Finish

RAL7016

Quantity

x

Name

L.Crawford

iLogic Auto

Approved

Checked

Date

10/07/2020

12/03/2021

Drawing No.

ADS10KA00BA1AA.1.CD.2

Sheet number 2 of 3

Scale DNS

Size: A3

Revision: 1

Units: mm



whitesales  
experience.brighter

Whitesales Ltd  
Europa House  
Cranleigh  
GU6 8NQ

T: +44(0)1483 917580  
E: sales@whitesales.co.uk  
W: whitesales.co.uk

**CERTIFICATION**

CWCT TN66:  
Safety and fragility of glazed roofing: guidance on specification.  
CWCT TN67:  
Safety and fragility of glazed roofing: testing and assessment.



**NBS SPECIFICATION**

CAWS  
L10 /45 Rooflights  
L10/460 Rooflights

Uniclass category  
Pr\_30\_59\_72

**84mm Painted border shown as standard to cover glazing frame.**

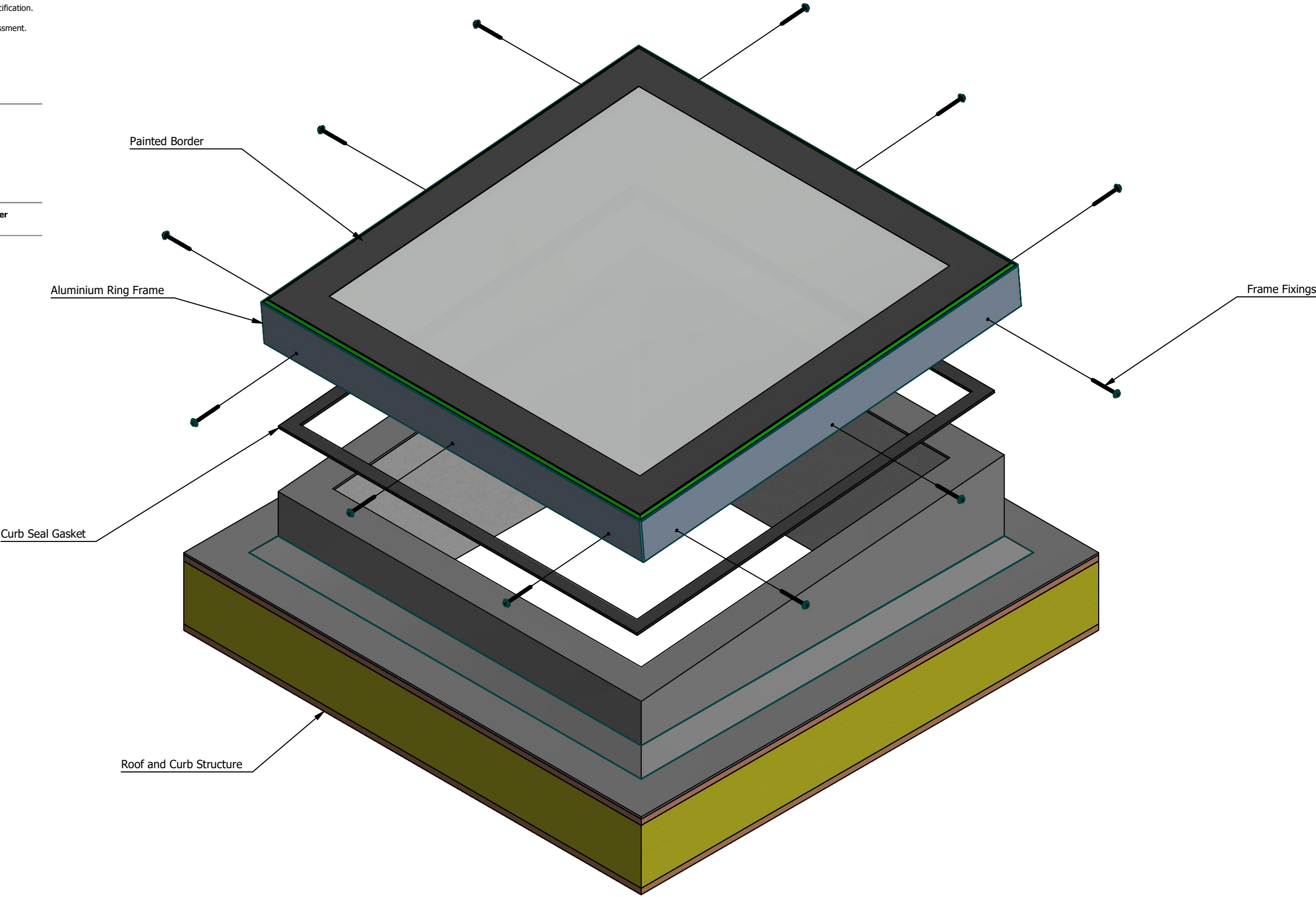

**Thermal Stress Note**

To provide the highest performance of non fragility and security, the unit incorporates laminated internal panes.

For standard (annealed) laminate inner panes, guidance regarding thermal stress fracture risk is available on Whitesales website or by contacting Whitesales technical team.

To reduce risk it is recommended to keep curb widths under 120mm, avoid partial shading or rapid internal heating or cooling direct or close to the glass.

If higher risks cannot be mitigated then alternative heat strengthened or toughened glass inner panes should be considered.

 Curb details shown are indicative only. Detail is designed by others.

It is the responsibility of the curb designer to ensure that the curb is structurally adequate to support the rooflight product.

Whitesales advise an installation with a minimum pitch of 5° for Rooflight units to minimise water pooling. Whilst the product can be installed flat without detriment to the warrantee. Whitesales cannot be held responsible for any excessive pooling of water to the surface of the Rooflight post installation.

**CAUTION CDM: Hazard Identification - Handling materials**

Manual Handling Operations Regulations (MHOR 1992) sets out a clear ranking of measures for dealing with risks from manual handling. Ensure measures are considered at all times. Other measures:

- Hand protection (mandatory) to: BS EN 388:1994.
- Wear appropriate PPE required for the task.
- Refer to applicable risk assessment for further details.



THIS DRAWING MUST  
NOT BE COPIED OR  
PASSED TO A THIRD  
PARTY WITHOUT  
WRITTEN CONSENT  
FROM THE  
MANUFACTURER

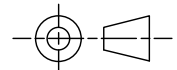

Title: Assembly Drawing		Description Double Glazed Unit			Name	Date
Project No	x	Ref No	x	Created	L.Crawford	10/07/2020
Project	x	Part Number	em.glaze	Drawn	iLogic Auto	12/03/2021
Customer Name	x	Material	Varies	Approved		
Project Address	xxx	Finish	RAL7016	Checked		
		Quantity	x	Drawing No. ADS10KA00BA1AA.1.CD.3		
				Revision: 1		
				Sheet number 3 of 3		
		Scale	DNS	Size:	A3	Units: mm



Whitesales Ltd  
Europa House  
Cranleigh  
GU6 8NQ

T: +44(0)1483 917580  
E: sales@whitesales.co.uk  
W: whitesales.co.uk