

em.tubeTM

INSTALLATION GUIDE | 06.04.21 | V 1.0

These installation instructions should be used for:

Contents

- 2 Contents of Pack
- 2 Preparation & Advice
- 3 Installation
- 4 Installation of the Pipe Assembly

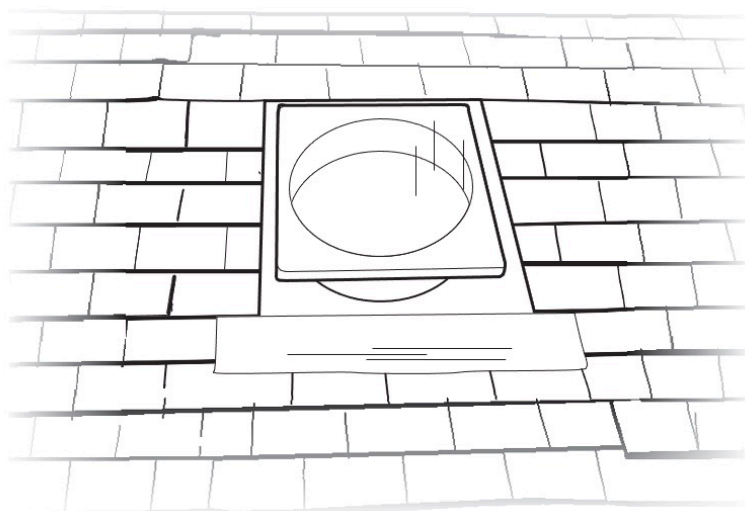

Rigid version

Contents of Pack

Rigid System:

- 1 Roof Dome
- 2 Breather Frame
- 3 Roof Flashing
- 4 Upper Rigid Ring
- 5 Adjustable Elbow
- 6 Rigid Pipe
- 7 Lower Rigid Ring
- 8 White Ceiling Frame
- 9 PVC Retainer Ring
- 10 Double Glaze Diffuser

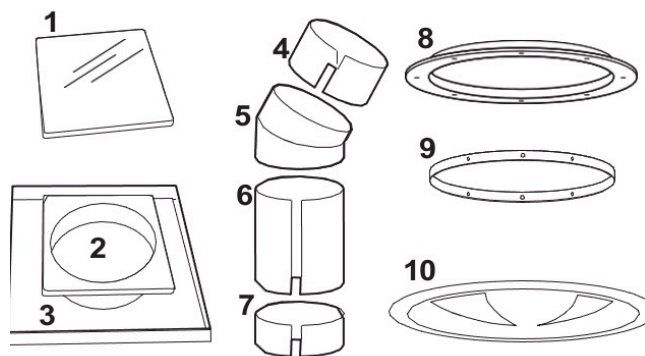

em.tube is designed to efficiently pipe natural daylight into a windowless or low light room. Please note, installing the em.tube to provide additional daylight in a room that has large windows or patio doors, may have little effect on overall illumination.

Please read this installation guide carefully before beginning your installation.

Contact your supplier if you are unsure about anything involved.

Preparation & Advice

Carefully remove the em.tube and the pipes from their respective packages and confirm that the correct model and any optional components ordered have been delivered.

In the event of any damage or short delivery please contact your supplier immediately.

Ensure that the position you are fitting the roof unit is directly above where you want light diffuser inside room, The tubing should be as straight as possible, avoid angles and bending the Tube as this will impair the light transmission.

Other factors should be considered i.e. the direction in which the Roof dome is facing. North facing roof surface is not recommended, south facing surface is optimal.

If your roof is facing west or east you will have more light in the morning or in the afternoon. Avoid overshadowing of tall buildings, trees etc.

We suggest you fit the largest size unit as possible even if this means trimming out one of your rafters and ceiling joists, in the long term you will have the benefit of a brighter area inside.

em.tube Size (Nominal mm)	Minimum Hole Dia (mm)
350	353
450	467
550	545

Installation

1. Remove roof tiles approx. 1m² and cut hole in roof to suit size of em.tube.
2. Cut hole in felt to match the diameter of tube you are fitting.

Cut tile baton also to Tube size

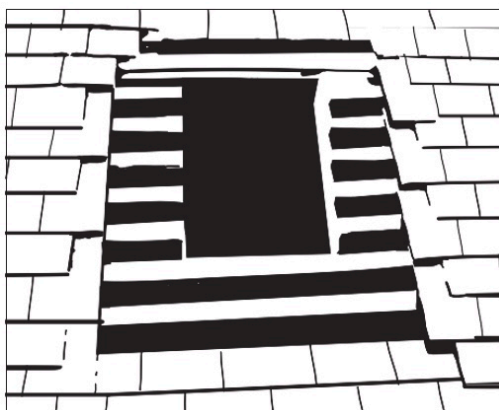

3. Join the two ends of the top reflector ring together with aluminium rivets or stitch screws provided. Remove protective plastic from the tube.

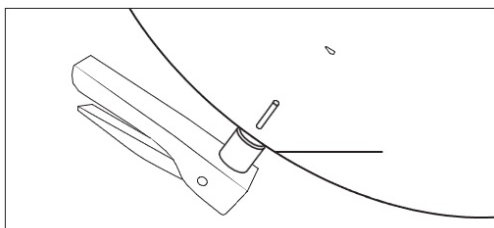

4. Fit the upper rigid section into the bayonet fitting of the Roof unit, from the underside, ensure that you rotate the tube into position.

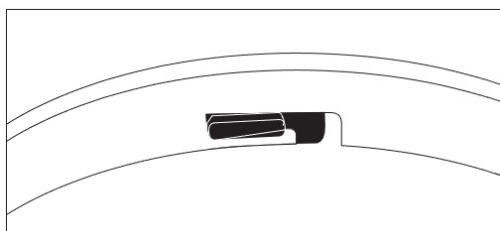

5. Where passive ventilation is required, replace the blank tabs on the underside of the dome with the perforated tabs provided.

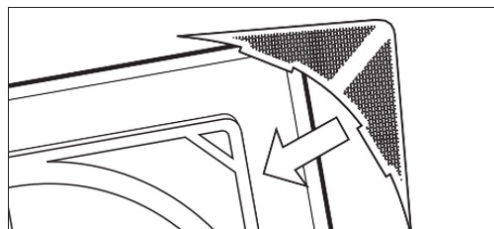

6. Place the roof assembly onto the roof tile batons. The upper end of the flashing unit should be under the roof tiles above. The bottom of the unit with the lead attached should be on top of the tile below.

Secure the roof unit to the batons by placing 25mm galvanised nail into roof batons and bending them over edge of the flashing unit. Do not puncture the em.tube tray.

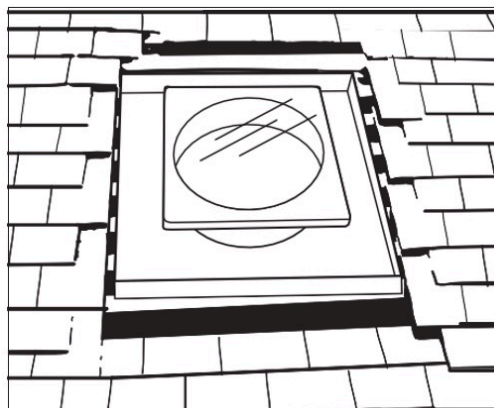

7. Replace roof tiles over the roof flashing plate ensuring that the foam weathering strip is covered with the tiles, it may be necessary to cut the roof tiles to suit.

It is good practice to render the edge of the roof tiles that are sitting on the em.tube flashing with sand and cement.

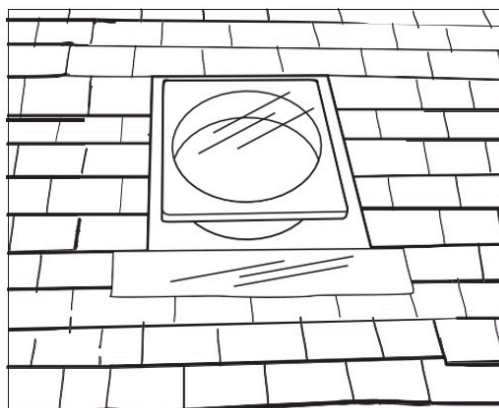

Installation of the Pipe Assembly

Ensure that you are cutting the hole in the correct position and that there are no obstructions in the attic, such as pipe work or electric cables.

1. To adjust the angle of the elbow adaptor rotate the two sections in opposing directions until the required angle is achieved.

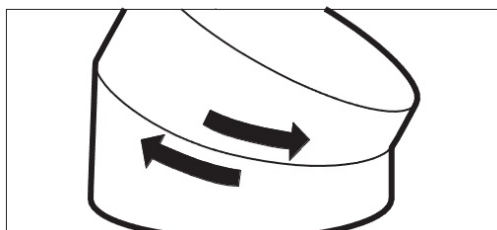

2. Depending on the location of the roof part in relation to the ceiling diffuser position, you may have to fit lengths of pipe onto the top ring using the 45° angle adaptor to bring the run into the vertical, just above the ceiling diffuser.
3. Fit lengths of 625mm or 1250mm lengths of pipe sections as required, Trim to required length then join two ends together with rivets provided.

! – As each length of pipe is completed, remember to remove the protective film from the inside of the pipe, but keep the open end of the pipe protected against dust and fingerprints.

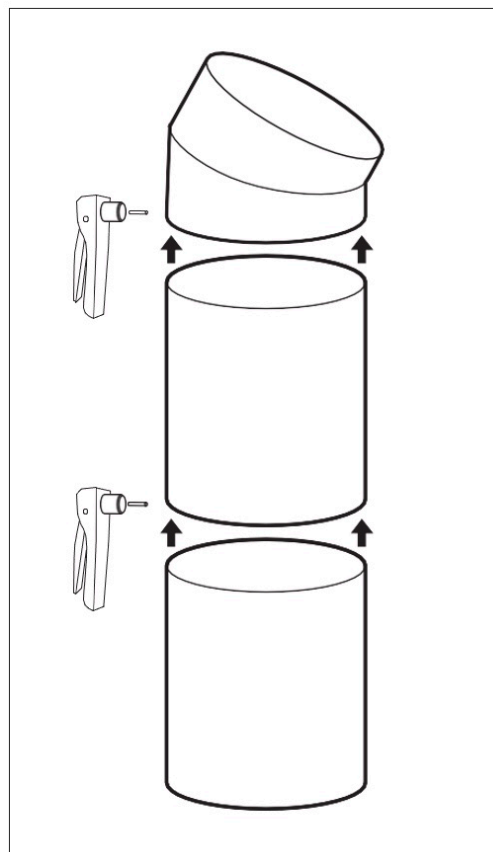

4. Wrap all joints with aluminium tape provided, this will further strengthen the system and prevent flies entering into the pipe through light leakages.

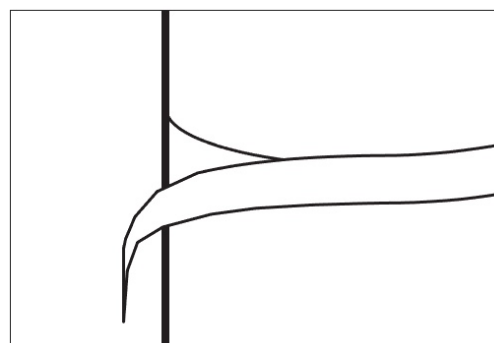

5. Cut an appropriately sized hole in the ceiling using the template provided. Fit the ceiling frame into the ceiling.

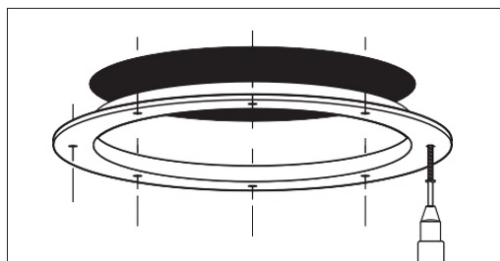

6. Secure the ceiling frame with the long screws, place the plastic retainers to the screws from the other side of the ceiling.

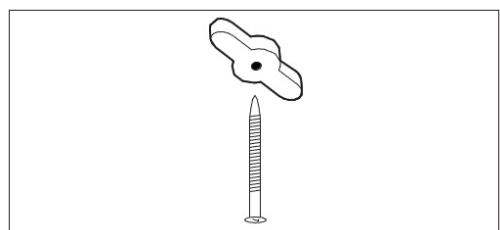

7. Discard the inner white plastic retainer ring as this is not required on the rigid version. From inside the room push the aluminium ring through the ceiling opening and sit it on the ceiling frame. The aluminium ring then needs to be fitted inside the lower rigid section, (which may need cutting as necessary) and riveted. This is then attached to the ceiling frame up stand with the bright zinc 20mm self tapping screws and spacer brackets.

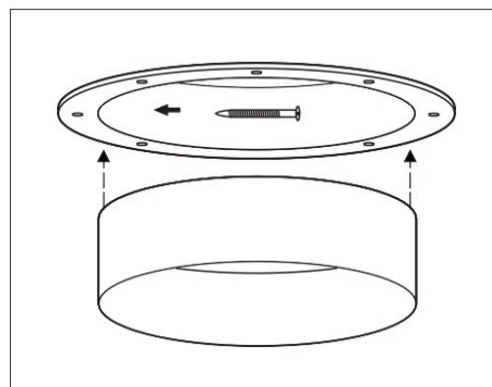

8. Offer the ceiling diffuser up to the ceiling frame, align the magnets in the ceiling diffuser with the connectors in the ceiling frame. It may be necessary to rotate the diffuser to the right or left to achieve a good connection.

Where passive ventilation is desired, via the Tunnel, fit the 10 mm spacer magnets to the ceiling frame before attaching it to the ceiling.

Ensure the diffuser panel is smooth side up i.e., prismatic side facing downwards to throw the light.

