

Tigard Promenade

15410 – 15600 SW Pacific Highway
Tigard, OR 97124



Leasing Contact

John Wynton | 510.368.5465 | 888.888.ROIC (7642) | jwynton@roireit.net | roireit.net

Note: This site plan indicates the general layout of the shopping center and is not a warranty, representation or agreement on the part of the landlord that the shopping center will be exactly as depicted

Tigard Promenade

15410 – 15600 SW Pacific Highway
Tigard, OR 97124



Property Description

Tigard Promenade is an 88,043 square foot community shopping center anchored by Safeway Supermarket. The five-mile demographics supporting the property are strong with a population of 246,634 and an average household income of \$132,397.

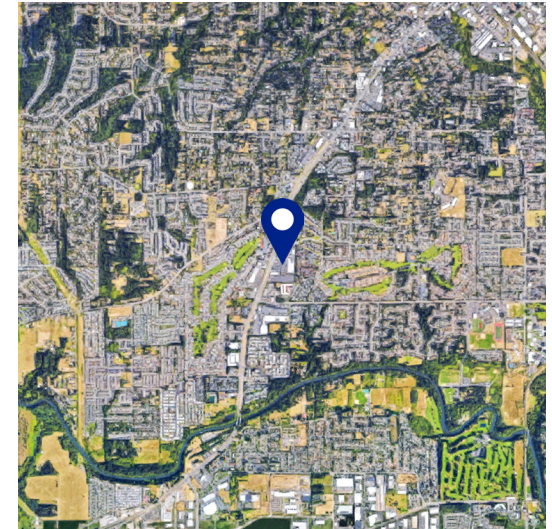

Property Overview

Total Number of Units: 20
Total Square Footage: 88,043

Major Tenants

Safeway Supermarket

Current Availability

100% Leased

2022 Demographics

	3-mile	5-mile
Population	108,586	246,634
Housing Units	47,468	104,228
Average Household Income	\$116,805	\$132,397

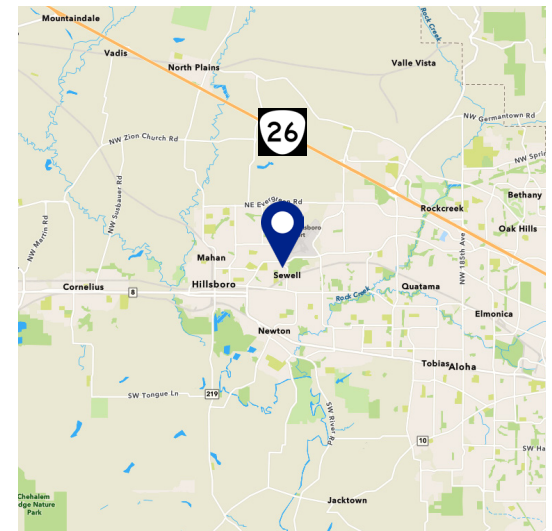

Leasing Contact

John Wynton 510.368.5465 | 888.888.ROIC (7642) | jwynton@roireit.net | roireit.net

All information contained herein was obtained from sources deemed reliable. No guarantee is made with respect to accuracy. Specifications subject to change without notice.