



## TRASH RECEPTACLES

ANNEX SERIES



AURORA SERIES



CITY SERIES



COAST SERIES



CONTOUR SERIES



DUAL ESTATE SERIES



DUAL URBAN SERIES



ECLIPSE SERIES



ESTATE SERIES



METROPOLITAN SERIES



MIRAGE SERIES



PALM SERIES



PLAZA SERIES



SUNSET SERIES



URBAN SERIES



VENTURE SERIES





## ANNEX TRASH RECEPTACLE



### THE ANNEX TRASH RECEPTACLE

is perfect for municipalities, office complexes, universities and apartment buildings. The all metal construction is fully fabricated in California and is BUYAMERICA compliant.



### FEATURES AND SPECIFICATIONS

#### FEATURES

- 32 Gallon Capacity
- 1 1/2" x 3/16" Steel Flat Bar
- Rain Bonnet lid (pictured)

#### FINISH

- Powder Coat (3-5mil)
- \*Specify RAL #\*

#### MOUNTING

- Surface Mounted



FLAT LID OPTION

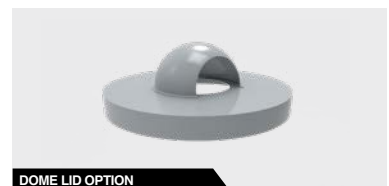

DOME LID OPTION



RAIN COVER OPTION

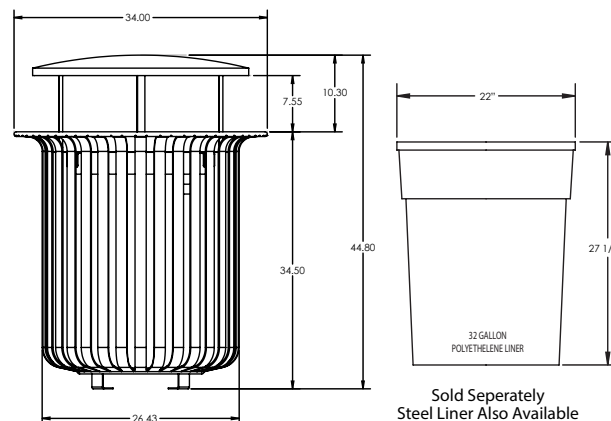



## AURORA TRASH RECEPTACLE



### THE AURORA TRASH RECEPTACLE

is perfect for municipalities, office complexes, universities and apartment buildings. The all metal construction is fully fabricated in California and is BUYAMERICA compliant.



### FEATURES AND SPECIFICATIONS

#### FEATURES

- 32 Gallon Capacity
- 1/4" x 1.5" Steel Flat Bar
- 3/16" x 2" Steel Flat Bar
- Dome lid (pictured)
- Elevated 2" from ground

#### FINISH

- Powder Coat (3-5mil)
- \*Specify RAL #\*

#### MOUNTING

- Surface Mounted

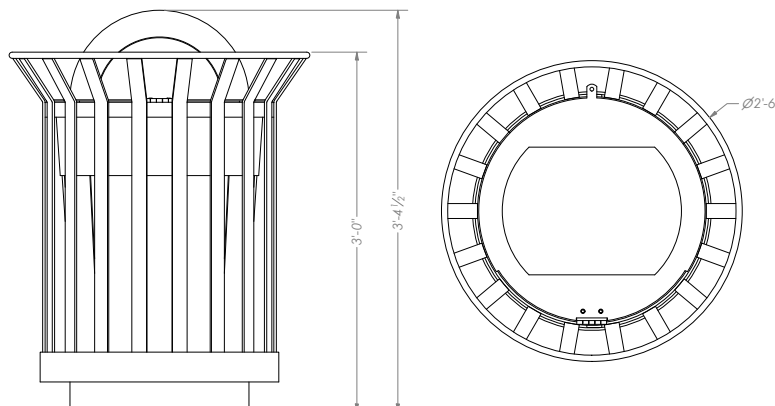



## CITY TRASH RECEPTACLE



### THE CITY SERIES TRASH RECEPTACLE

is a new take on a classic look. This receptacle has the look and feel of a classic city trash receptacle, with the addition of a separate recycling bin on top. The City Series' all steel construction is fabricated in house and is BUY AMERICA compliant.



### FEATURES AND SPECIFICATIONS

#### SPECIFICATIONS

- 32 Gal. Trash and Recycle Receptacle
- 1" SQ x 1/8" Steel Tube
- 16 GA Metal Skin
- 12 GA Metal Dome
- Available in Carbon or Stainless Steel
- \*50 grit non-directional finish on stainless steel
- Dome attached with steel cable
- Hinged side opening door
- Powder coated
- Plastic or Galvanized Steel Liners available

#### FINISH

- Powder Coat (3-5 mil) \*Specify RAL #\*

#### MOUNTING

- Surface Mounted

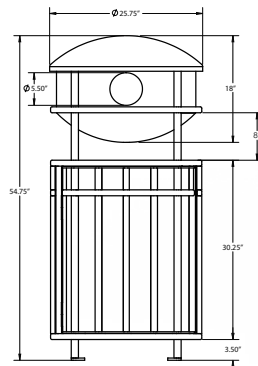



## COAST TRASH RECEPTACLE



### THE COAST TRASH RECEPTACLE

is perfect for municipalities, office complexes, universities and apartment buildings. The sll metal construction is fully fabricated in California and is BUYAMERICA compliant.



### FEATURES AND SPECIFICATIONS

#### SPECIFICATIONS

- 32 Gallon Capacity
- 1/8" Laser Cut Aluminum Exterior
- 1/8" Perforated Aluminum Interior
- Hinged Lid

#### FINISH

- Powder Coat (3-5 mil) \*Specify RAL #\*

#### MOUNTING

- Surface Mounted

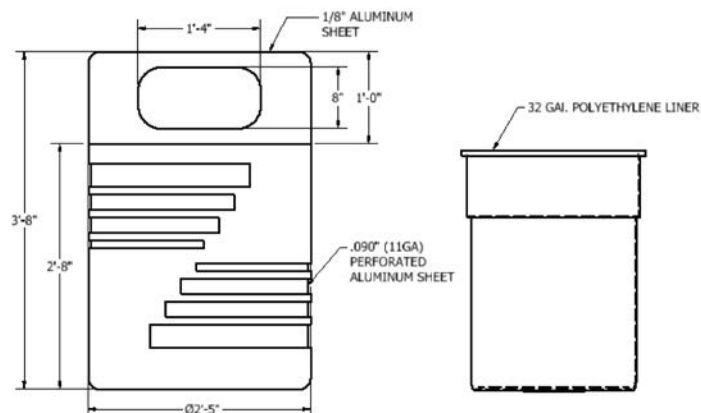





## CONTOUR TRASH RECEPTACLE

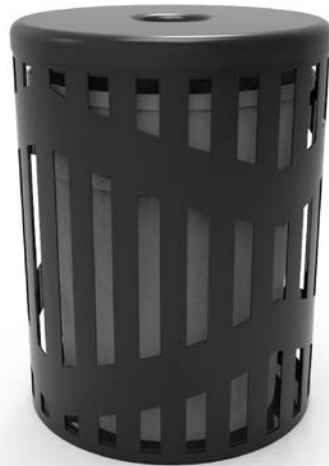

### THE CONTOUR TRASH RECEPTACLE

is perfect for municipalities, office complexes, universities and apartment buildings. The all metal construction is fully fabricated in California and is BUYAMERICA compliant.



### FEATURES AND SPECIFICATIONS

#### FEATURES

- 32 Gallon Capacity
- 18 Gauge Laser Cut Body
- 1/8" Steel Structure
- 3/16" Steel Base
- Standard round lid (pictured)

#### FINISH

- Powder Coat (3-5mil) \*Specify RAL #\*

#### MOUNTING

- Surface Mounted



HINGED LID OPTION



DOME LID OPTION



RAIN COVER OPTION

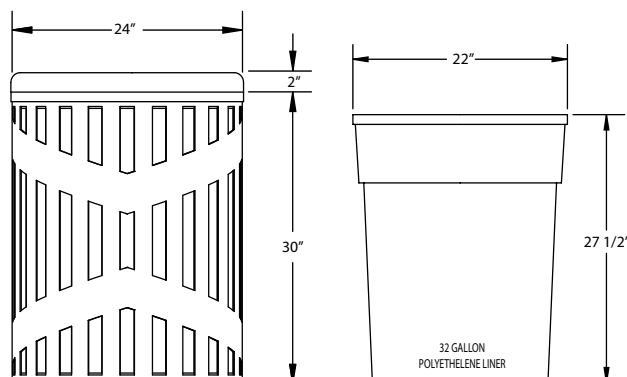



## DUAL ESTATE TRASH RECEPTACLE



### THE DUAL ESTATE TRASH RECEPTACLE

is perfect for municipalities, office complexes, universities and apartment buildings. Equipped with both trash and recycling compartments, the receptacle keeps the trash and recycling separated for proper disposal. The all metal construction is fully fabricated in California and is BUYAMERICA compliant.



### FEATURES AND SPECIFICATIONS

#### SPECIFICATIONS

- 32 Gallon x2 Capacity
- Side Opening Door w/ Push/Pull lever & Key Cam Lock (optional)
- 1/4" x 1.5" Steel Flat Bar
- 3/16" x 2" Flat Steel Bar

#### FINISH

- Powder Coat (3-5 mil) \*Specify RAL #\*

#### MOUNTING

- Surface Mounted

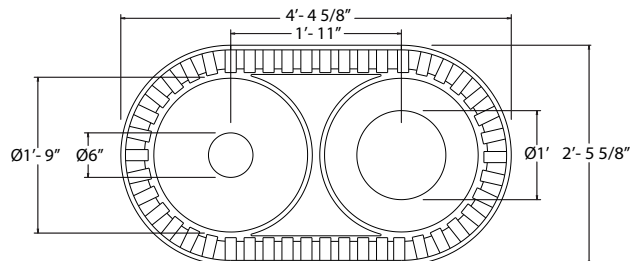
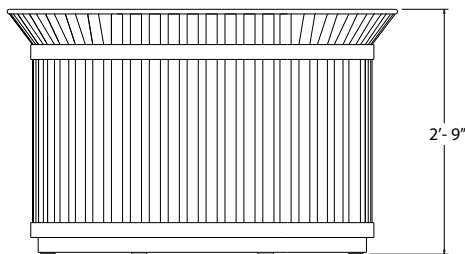



## DUAL URBAN TRASH RECEPTACLE



### THE DUAL URBAN TRASH RECEPTACLE

is an ideal solution for sorting waste in high-traffic areas such as municipalities, offices, and universities. With top and side placard options, the all-steel construction is fully fabricated in California and is BUYAMERICA compliant.



### FEATURES AND SPECIFICATIONS

#### SPECIFICATIONS

- Dual Trash Receptacles for recycling and other trash
- 15 1/2" x 5 1/2" Top Placards
- 10" x 10" Side Placards
- Choice of liners
- 16 Gauge Galvanized Steel (Outer Shell)
- 1" Square Steel Tubing (Frame)
- 1" x 2" Steel Tubing (Frame)

#### FINISH

- Powder Coat (3-5 mil) \*Specify RAL #\*

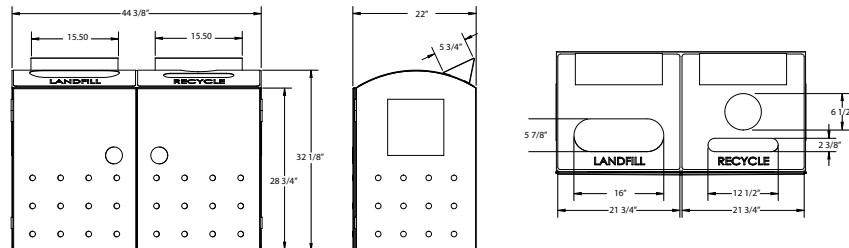





## ECLIPSE TRASH RECEPTACLE



### THE ECLIPSE TRASH RECEPTACLE

is defined by a simple, unobtrusive design that features a modern precision cut pattern. Perfect for municipalities, offices complexes, universities and apartment buildings, its all metal construction is fully fabricated in California and is BUYAMERICA compliant.



### FEATURES AND SPECIFICATIONS

#### SPECIFICATIONS

- 36 Gallon capacity
- 1/8" laser cut aluminum exterior
- Hinged lid
- Integrated ash receptacle

#### FINISH

- Powder Coat (3-5 mil)

#### MOUNTING

- Surface mounted

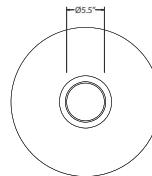
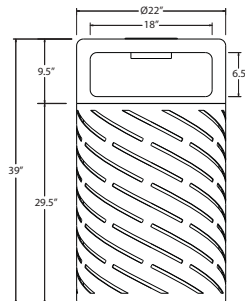



## ESTATE TRASH RECEPTACLE



### THE ESTATE TRASH RECEPTACLE

is perfect for municipalities, office complexes, universities and apartment buildings. The all metal construction is fully fabricated in California and is BUYAMERICA compliant.



### FEATURES AND SPECIFICATIONS

#### FEATURES

- 32 Gallon Capacity
- Side opening door with push/pull lever & key cam lock
- 1/4" x 1.5" Steel Flat Bar
- Dome lid (pictured)
- Elevated 2" from ground

#### FINISH

- Powder Coat (3-5mil)
- \*Specify RAL #\*

#### MOUNTING

- Surface Mounted



FLAT LID OPTION

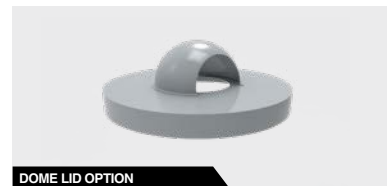

DOME LID OPTION



RAIN COVER OPTION

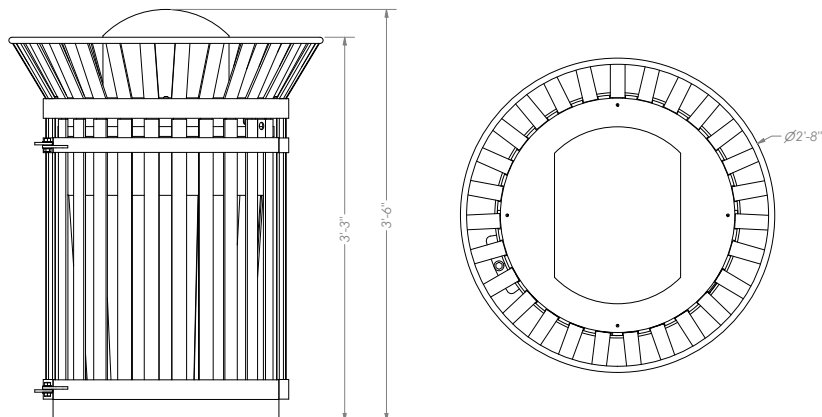



## METROPOLITAN TRASH RECEPTACLE



### THE ESTATE TRASH RECEPTACLE

is perfect for municipalities, office complexes, universities and apartment buildings. The all steel construction is fully fabricated in California and is BUYAMERICA compliant.

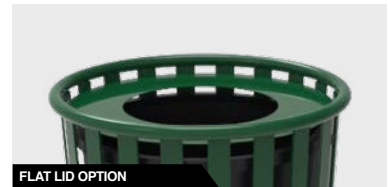

### FEATURES AND SPECIFICATIONS

#### FEATURES

- Available in 32, 44 or 55 Gallon Capacity
- Convex Lid (pictured)
- 16 Gauge Spun Steel Lid
- 1/4" x 2" Steel Flat Bar
- 1" Rolled Steel Tube
- Plastic Liner (sold separately)

#### FINISH

- Powder Coat (3-5mil)
- \*Specify RAL #\*

#### MOUNTING

- Surface Mounted

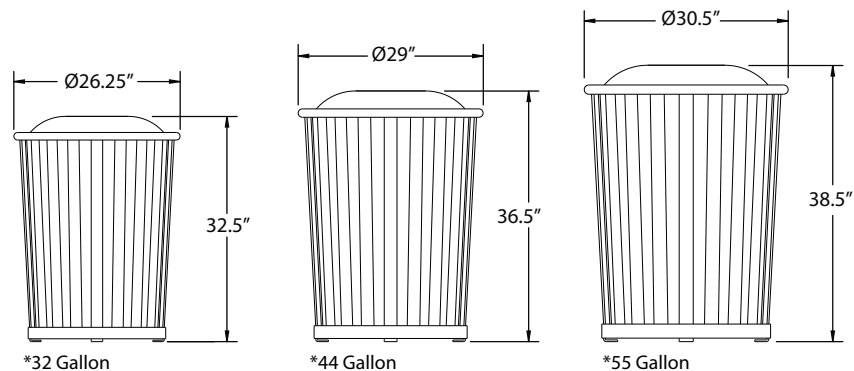



## MIRAGE TRASH RECEPTACLE



### THE MIRAGE TRASH RECEPTACLE

is perfect for municipalities, office complexes, universities and apartment buildings. The all metal construction is fully fabricated in California and is BUYAMERICA compliant.



### FEATURES AND SPECIFICATIONS

#### SPECIFICATIONS

- 32 Gallon Capacity
- 18 Gauge Laser Cut Body
- 1/8" Steel Flat Bar
- 1/8" Steel Plate
- 1 1/2" Steel Pipe

#### FINISH

- Powder Coat (3-5 mm) \*Specify RAL #\*

#### MOUNTING

- Surface mounted

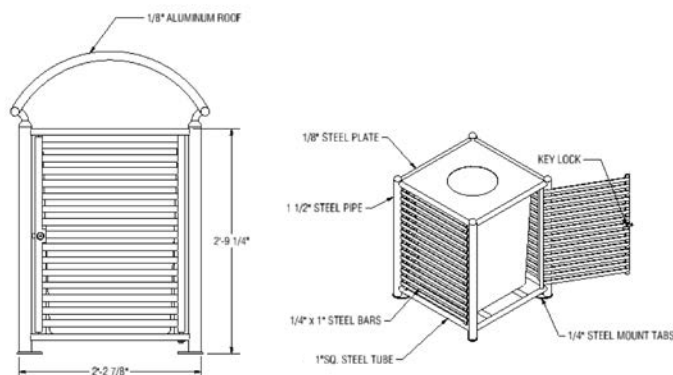





## PALM TRASH RECEPTACLE



### THE PALM TRASH RECEPTACLE

is perfect for municipalities, office complexes, universities and apartment buildings. The all metal construction is fully fabricated in California and is BUYAMERICA compliant.



### FEATURES AND SPECIFICATIONS

#### FEATURES

- 32 Gallon Capacity (10 - 20 Gallon Pole Mount available)
- Perforated or solid drum with multiple lid options (Dome Lid pictured)
- All Aluminum or Steel Construction
- Elevated 6"/18" from ground
- Polyethylene plastic liner (optional)
- UV Protected Hardware

#### FINISH

- Powder Coat (3-5mil)
- \*Specify RAL #\*

#### MOUNTING

- Surface Mounted or Direct Burial
- Pole Mounted (10-20 Gallon)



FLAT LID OPTION



DOME LID OPTION



RAIN COVER OPTION

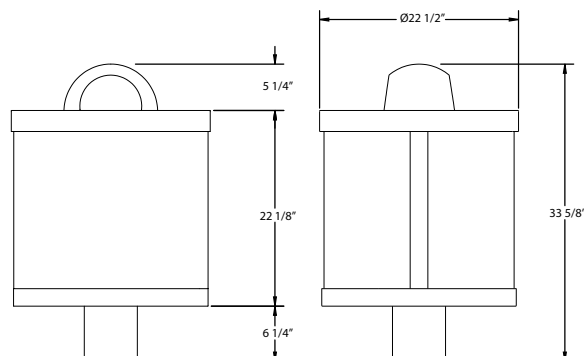





## PLAZA TRASH RECEPTACLE



### THE PLAZA TRASH RECEPTACLE

is perfect for municipalities, office complexes, universities and apartment buildings. The all metal construction is fully fabricated in California and is BUYAMERICA compliant.



### FEATURES AND SPECIFICATIONS

#### FEATURES

- 32 Gallon Capacity (10 - 20 Gallon Pole Mount available)
- Perforated or solid drum with multiple lid options (Dome Lid pictured)
- All Aluminum or Steel Construction
- Elevated 6"/18" from ground
- Polyethylene plastic liner (optional)
- UV Protected Hardware

#### FINISH

- Powder Coat (3-5mil)
- \*Specify RAL #\*

#### MOUNTING

- Surface Mounted or Direct Burial
- Pole Mounted (10-20 Gallon)



FLAT LID OPTION



DOME LID OPTION



RAIN COVER OPTION

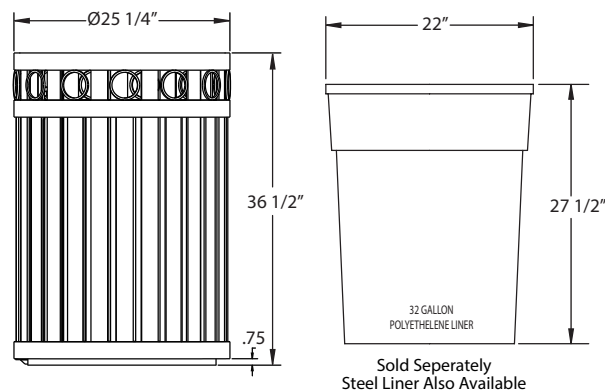



## SUNSET TRASH RECEPTACLE



### THE SUNSET TRASH RECEPTACLE

is perfect for municipalities, office complexes, universities and apartment buildings. The all metal construction is fully fabricated in California and is BUYAMERICA compliant.



### FEATURES AND SPECIFICATIONS

#### FEATURES

- 32 Gallon Capacity (10 - 20 Gallon Pole Mount available)
- Perforated or solid drum with multiple lid options (Dome Lid pictured)
- All Aluminum or Steel Construction
- Elevated 6"/18" from ground
- Polyethylene plastic liner (optional)
- UV Protected Hardware

#### FINISH

- Powder Coat (3-5mil)
- \*Specify RAL #\*

#### MOUNTING

- Surface Mounted or Direct Burial
- Pole Mounted (10-20 Gallon)



FLAT LID OPTION



DOME LID OPTION



RAIN COVER OPTION

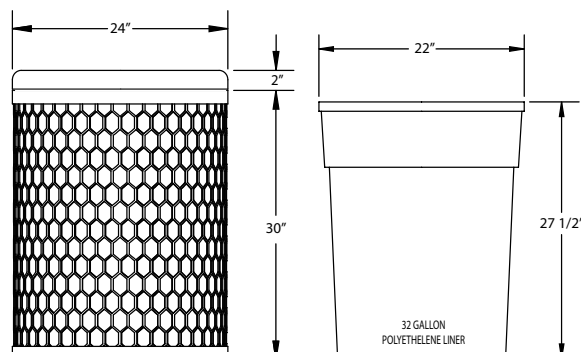



## URBAN TRASH RECEPTACLE



### THE URBAN TRASH RECEPTACLE

is perfect for municipalities, office complexes, universities and apartment buildings. The all metal construction is fully fabricated in California and is BUYAMERICA compliant.



### FEATURES AND SPECIFICATIONS

#### SPECIFICATIONS

- 32 or 55 Gallon Capacity
- 1/8" Laser Cut Aluminum Exterior
- 1/8" Perforated Aluminum Interior
- Tethered Lid

#### FINISH

- Powder Coat (3-5 mil) \*Specify RAL #\*

#### MOUNTING

- Surface mounted

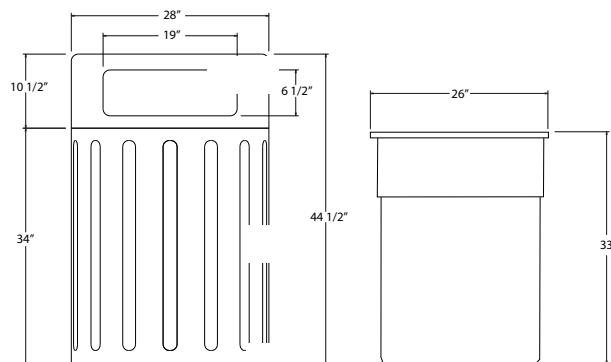



## VENTURE TRASH RECEPTACLE



### THE VENTURE TRASH RECEPTACLE

is perfect for municipalities, office complexes, universities and apartment buildings. The all metal construction is fully fabricated in California and is BUYAMERICA compliant.



### FEATURES AND SPECIFICATIONS

#### FEATURES

- 32/36 Gallon Capacity
- Side Opening Door
- 3/8" x 1" Steel Flat Bar
- 1/4" x 2 1/2" Steel Flat Bar
- Standard flat lid (pictured)

#### FINISH

- Powder Coat (3-5mil) \*Specify RAL #\*

#### MOUNTING

- Surface mounted  
4x, 1/2" x 4"-8" anchor bolts



FLAT LID OPTION



DOMED LID OPTION



RAIN COVER OPTION

