

### 2' X 2' Plastic Lay-In 3 Cone Supply

- PREMIX ABS POLYMER
- WON'T RUST, CORRODE, DISCOLOR, OR FADE
- 4 WAY DEFLECTION
- QUICK CONNECT™ EASY ATTACH CENTER KNOB FOR SIMPLE INSTALL AND REMOVAL
- 3 CONE STEP-DOWN DIFFUSION
- FAST & EFFICIENT CLEANABILITY
- 6", 8", 10" OR 12" PRE-MOLDED INLET BOOT OPTIONS
- STANDARD WHITE OR BLACK

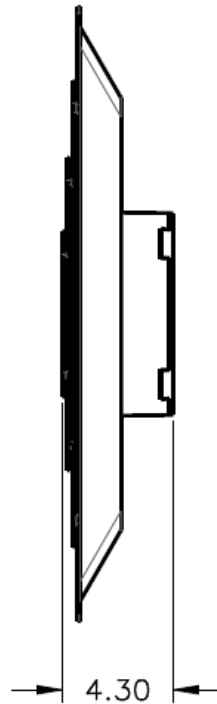

#### COLOR

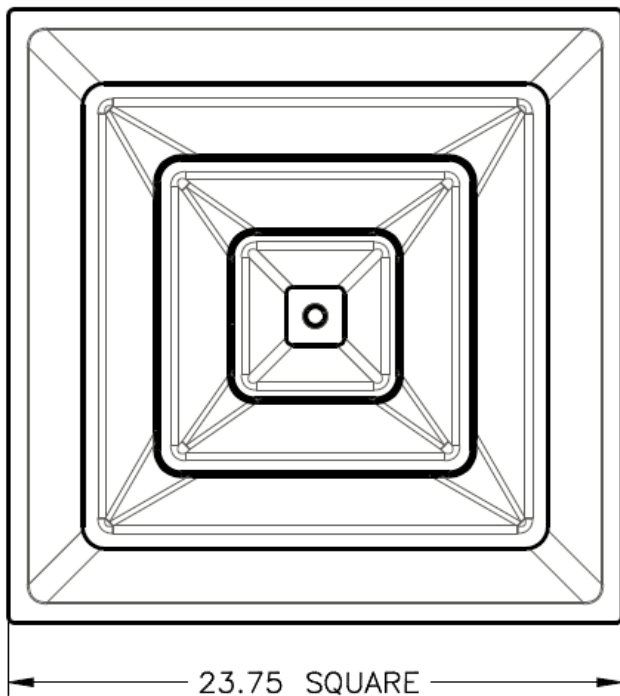
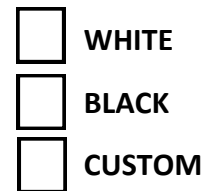

UL 94HB RATED ABS PLASTIC

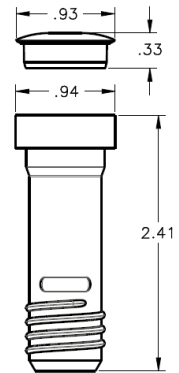

6" HT-2X2-SPL6

8" HT-2X2-SPL8

10" HT-2X2-SPL10

12" HT-2X2-SPL12

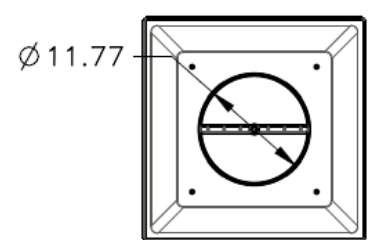
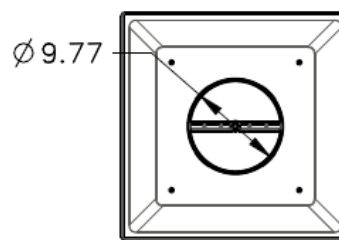
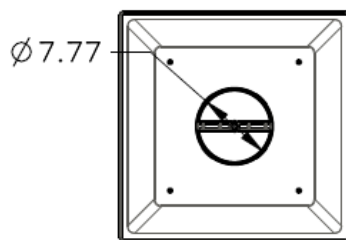
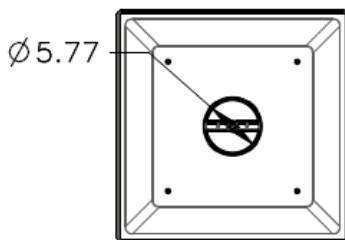

JOB NAME \_\_\_\_\_  
 LOCATION \_\_\_\_\_  
 ARCHITECT \_\_\_\_\_  
 ENGINEER \_\_\_\_\_  
 CONTRACTOR \_\_\_\_\_

SUBMITTED BY

DATE

### 2' X 2' Plastic Lay-In Plaque Supply

- PREMIX ABS POLYMER
- WON'T RUST, CORRODE, DISCOLOR, OR FADE
- 4 WAY DEFLECTION
- QUICK CONNECT MAGNETIC ENGAGEMENT SYSTEM WITH OVER 24 LBS OF PULL FOR SIMPLE INSTALL AND REMOVAL OF DIFFUSER—PATENT PENDING
- FAST & EFFICIENT CLEANABILITY
- 6", 8", 10", 12" PRE-MOLDED INLET BOOT OR BULLS EYE BACK OPTIONS
- STANDARD WHITE OR BLACK

#### COLOR

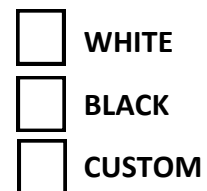

UL 94HB RATED ABS PLASTIC

BULLSEYE  
HT-2X2-PSPLBE

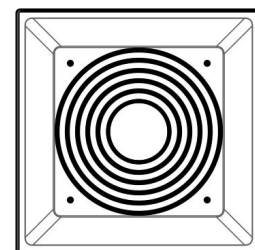
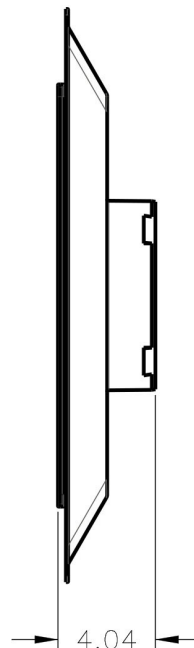
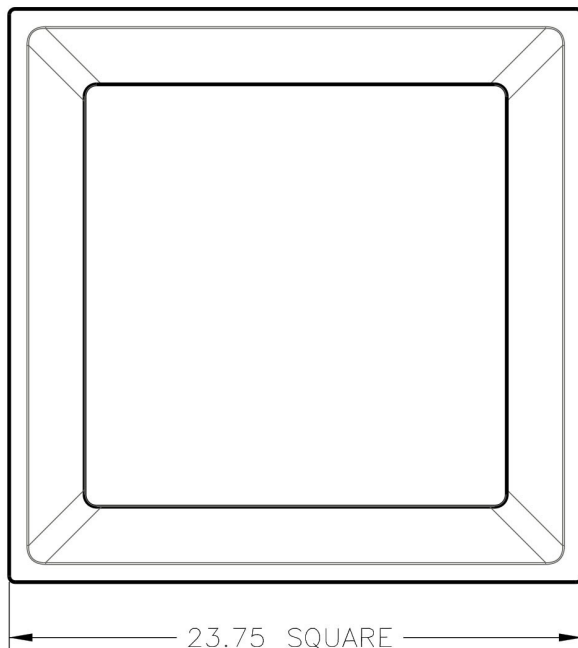

6" HT-2X2-PSPL6

8" HT-2X2-PSPL8

10" HT-2X2-PSPL10

12" HT-2X2-PSPL12

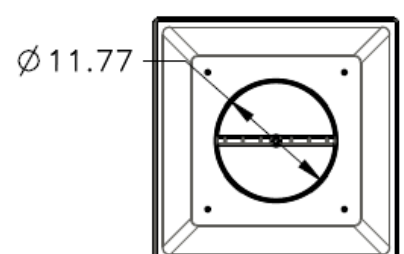
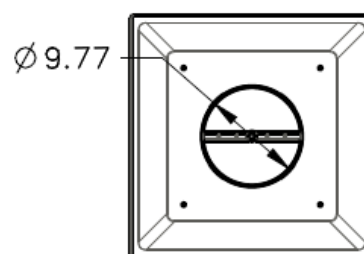
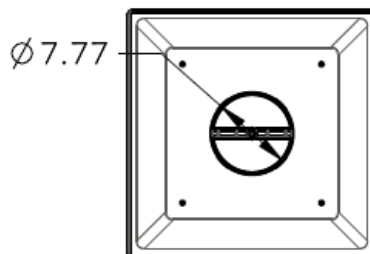
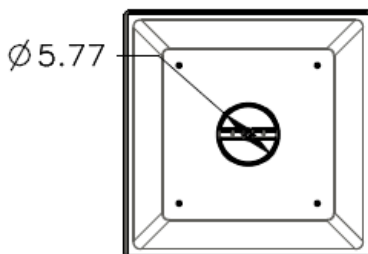

JOB NAME \_\_\_\_\_

LOCATION \_\_\_\_\_

ARCHITECT \_\_\_\_\_

ENGINEER \_\_\_\_\_

CONTRACTOR \_\_\_\_\_

SUBMITTED BY

DATE

### 2' X 2' Plastic Lay-In Bordered Supply

- PREMIX ABS POLYMER
- WON'T RUST, CORRODE, DISCOLOR, OR FADE
- QUICK CONNECT™ EASY ATTACH CENTER KNOB FOR SIMPLE INSTALL AND REMOVAL OF DIFFUSER—PATENT PENDING

- FAST & EFFICIENT CLEANABILITY
- 4 WAY , 3 WAY AND 2 WAY DEFLECTION DIFFUSERS AVAILABLE
- 6", 8", 10", 12" OR 14" PRE-MOLDED INLET BOOT OPTIONS
- STANDARD WHITE OR BLACK

#### COLOR

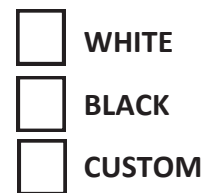

UL 94HB RATED ABS PLASTIC

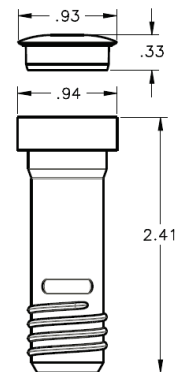
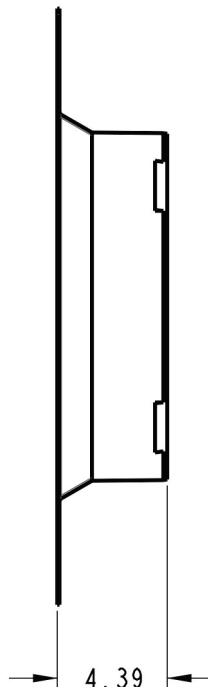
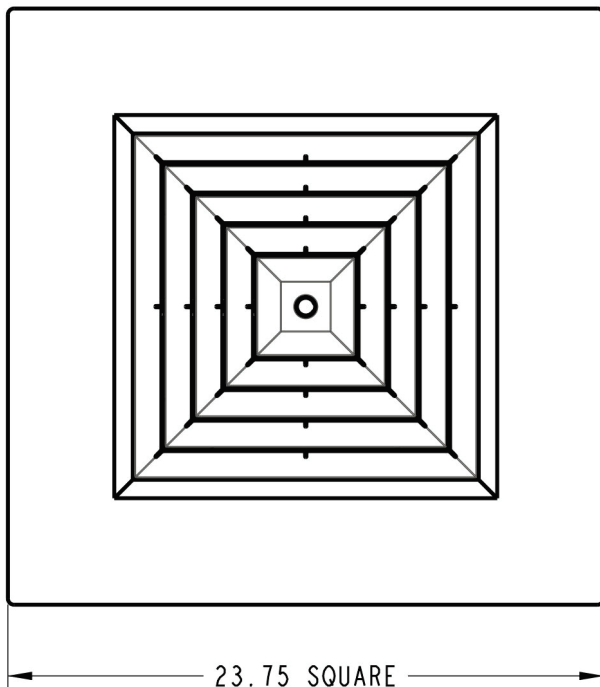

6" HT-2X2-BSPL6

8" HT-2X2-BSPL8

10" HT-2X2-BSPL10

12" HT-2X2-BSPL12

14" HT-2X2-BSPL14

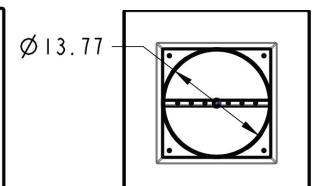
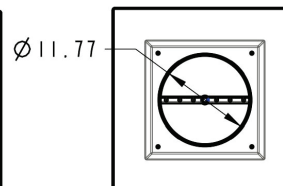
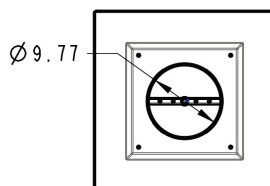
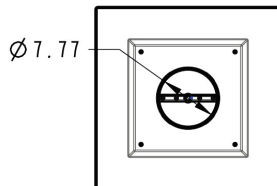
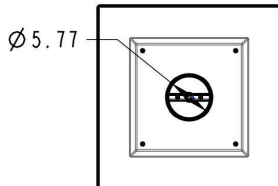

JOB NAME \_\_\_\_\_

LOCATION \_\_\_\_\_

ARCHITECT \_\_\_\_\_

ENGINEER \_\_\_\_\_

CONTRACTOR \_\_\_\_\_

SUBMITTED BY

DATE

### 2' X 2' Plastic Lay-In Louver Return

- PREMIX ABS POLYMER
- WON'T RUST, CORRODE, DISCOLOR, OR FADE
- EASY ATTACH CLIP/HINGE FOR SIMPLE INSTALL AND REMOVABLE OF THE GRILLE FACE
- 13/16" SPACED FINS AT 55°
- FITS BOTH 20" X 20" X 1" OR 2" FILTERS
- FAST & EFFICIENT CLEANABILITY
- BULLS EYE INLET 6"-16" TO CUSTOMIZE IN THE FIELD
- STANDARD WHITE OR BLACK

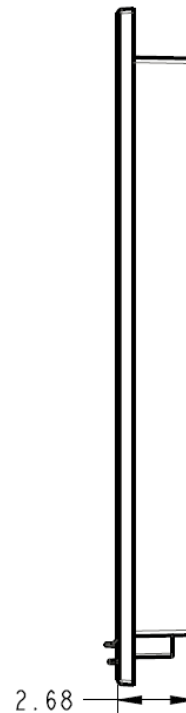
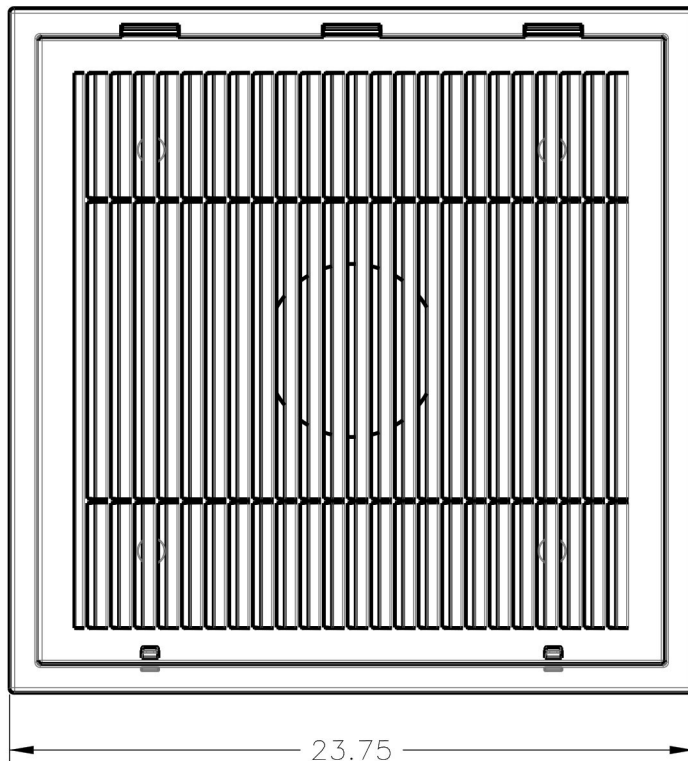

#### COLOR

- ☐ WHITE
- ☐ BLACK
- ☐ CUSTOM

UL 94HB RATED ABS PLASTIC

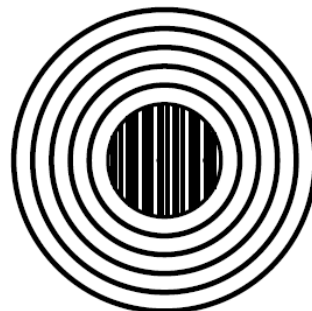

BULLS EYE BACK  
ACCEPTS 6"-16"  
STANDARD AND  
TRADITIONAL COLLARS

JOB NAME \_\_\_\_\_

LOCATION \_\_\_\_\_

ARCHITECT \_\_\_\_\_

ENGINEER \_\_\_\_\_

CONTRACTOR \_\_\_\_\_

SUBMITTED BY

DATE

### 2' X 2' Plastic Lay-In Egg Crate Return

- PREMIX ABS POLYMER
- WONT RUST, CORRODE, DISCOLOR, OR FADE
- EASY ATTACH CLIP/HINGE FOR SIMPLE INSTALL AND REMOVABLE OF THE GRILLE FACE
- FITS BOTH 20" X 20" X 1" OR 2" FILTERS
- FAST & EFFICIENT CLEANABILITY
- BULLS EYE INLET 6"-16" TO CUSTOMIZE IN THE FIELD
- STANDARD WHITE OR BLACK

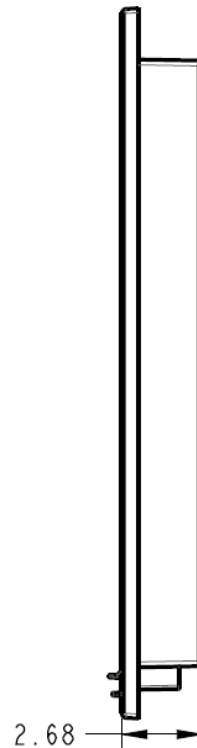
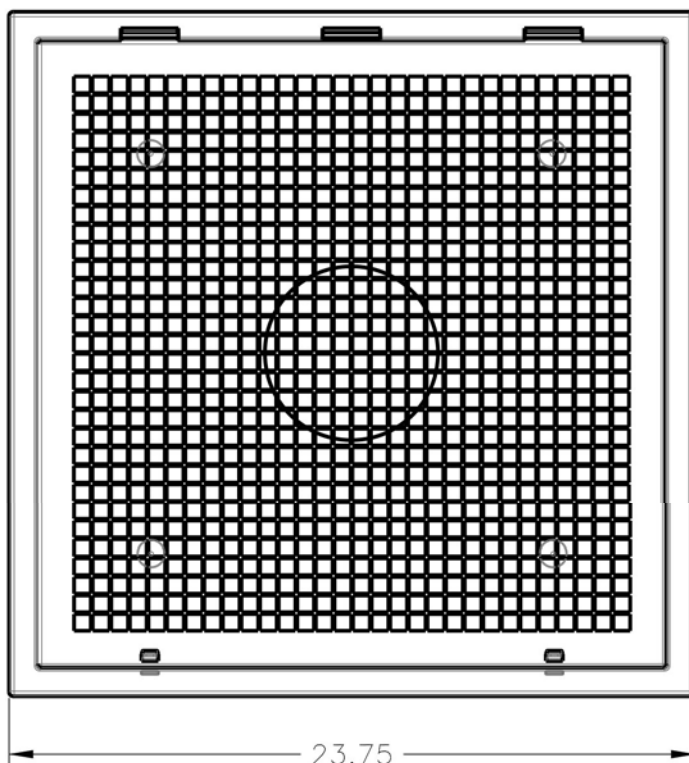

#### COLOR

- ☐ WHITE
- ☐ BLACK
- ☐ CUSTOM

UL 94HB RATED ABS PLASTIC



BULLS EYE BACK  
ACCEPTS 6"-16"  
STANDARD AND  
TRADITIONAL COLLARS

JOB NAME \_\_\_\_\_

LOCATION \_\_\_\_\_

ARCHITECT \_\_\_\_\_

ENGINEER \_\_\_\_\_

CONTRACTOR \_\_\_\_\_

SUBMITTED BY

DATE