

COMBI BOILER



THE ALL NEW COMBI BOILER

Noritz is excited to offer a new level of excellence to consumers with hydronic heating who wish to install one appliance to meet both domestic hot water and space heating needs. The CB Combination (Combi) Boiler from Noritz utilizes high-efficiency condensing technology to deliver hot water to both plumbing and hydronic heating applications for homes of all sizes.

The CB Combi delivers up to 9.2 gallons per minute of domestic hot water and can be used on a wide variety of hydronic applications such as radiators, baseboards, in-floor radiant, and snow melts, as well as forced-air applications such as air handlers.

OTHER CB COMBI FEATURES

Weighing only 90 pounds, the wall-hung CB Combi is also significantly lighter than a traditional boiler, requiring only one installer to do the job instead of two. In fact, its compact size allows it to take up as much as 80 percent less space than a traditional floor-standing boiler and water heater. Utilizing three high quality, non-magnetic, stainless steel heat exchangers, the new CB boiler is able to safely and accurately heat both your DHW and heating applications, while maintaining the separation of the two water systems.



Features



Safety First. We include factory installed safety devices that control the DHW spiking (scalding), a water pressure sensor that ensures the heating side is pressurized properly, high exhaust temperature cutoff to prevent damage to the venting system, a water leak detection device, and gas leak detection/alarm.

Whole Home Domestic Water Heating Capability: Full 199.9k BTU/h input provides whole home domestic water heating capability. Capable of producing up to 4.5 GPM @ 77°F temperature rise, the Noritz CB is able to provide ample hot water for 2 showers plus simultaneously.

Flow Control. The CB utilizes a motorized flow control device to maintain proper DHW temp at a high flow in both winter and the summer. That allows us to have much higher DHW flow rates during the summer and prevents cold or lukewarm water during the winter.

Built-in Outdoor Reset Control: Easily integrate energy saving outdoor reset control with the included outdoor temperature sensor. Built-in or fully customizable control points. This component qualifies our combi for additional rebates.

Integrated Grundfos® Pump: High efficiency Grundfos® pump to maximize flow rate of the primary heating loop.

External Pump Terminal. Secondary pump can be run without the need of additional relay.

Gas Valve. Our revolutionary negative pressure gas valve allows for greater flexibility in gas line sizing which means you are less likely to need costly upgrades to your gas line.

Warranty

Residential Single Family Use Only	
Labor	1 Year
Parts	5 years labor
Heat exchanger	10 year

How It Works

A combination (combi) boiler is a space saving all-in-one product that allows users to satisfy all the home’s heating needs in one package. Within one easy to install package, the combi is both a high efficiency tankless water heater, and a hydronic heating boiler capable of providing heat for the entire home. By combining both features in one compact, wall hanging appliance, the complexity of installation and space requirement is significantly reduced.



Applications

Base Board Heater

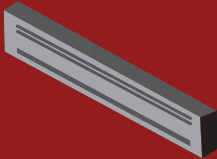

Air Handler



Radiant Heating

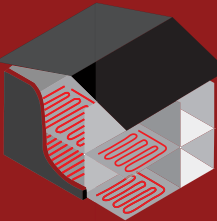

Cast Iron Heater



DHW
up to 199k BTU/H
(gas input)

HEATING
up to 120k BTU/H
(gas input)

Parts Diagram

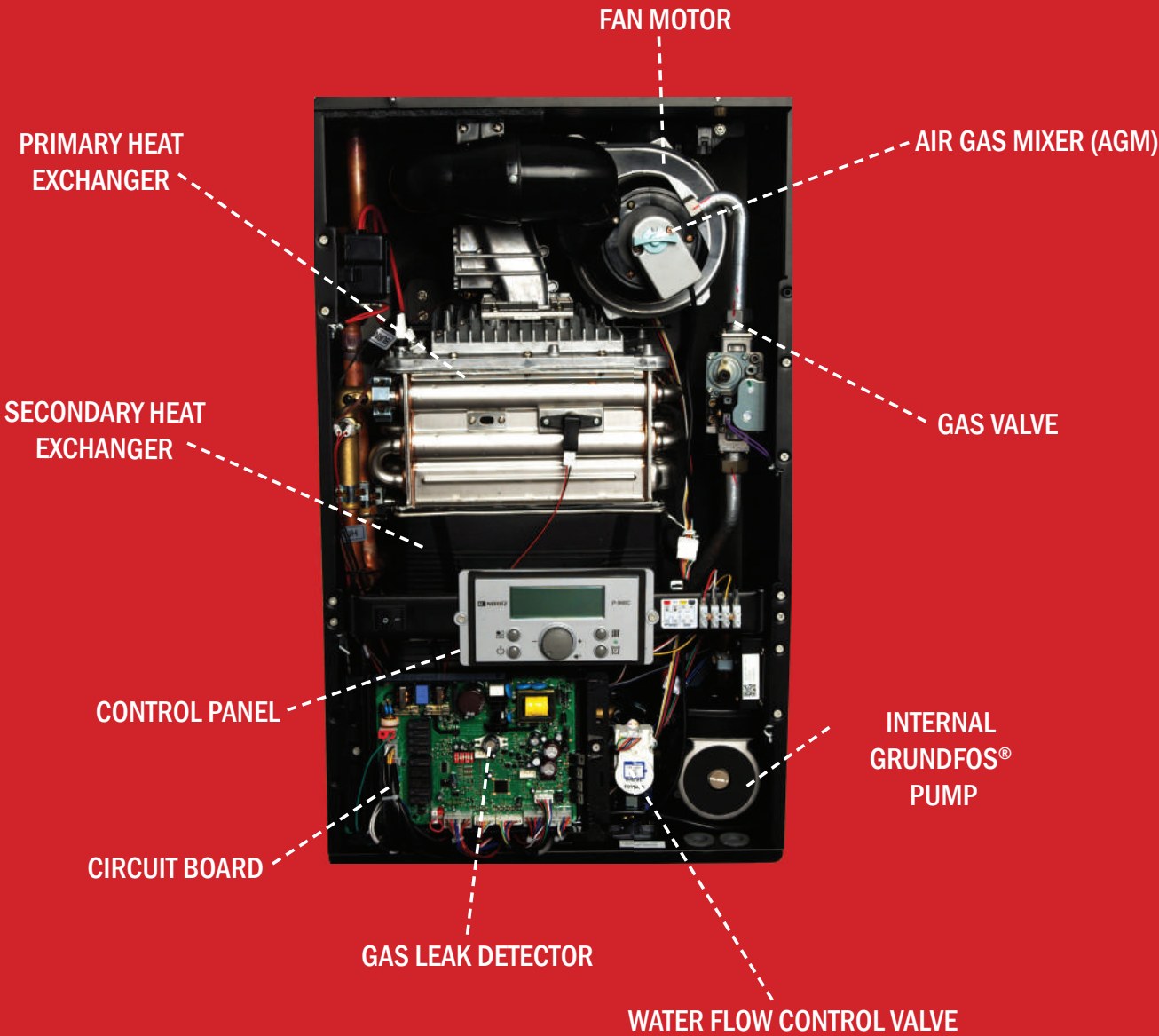

Accessories



Plastic Rain Cap
PRC-1



Vertical Contentric Adapter
VK3-PVC-VAS



Plastic Horizontal Termination
PVT-HL



Single Vent Conversion Kit
SV-CK-3



Horizontal Concentric Termination
VK3-H-PVC



Isolator Valve Kit
IK-WV

Specifications

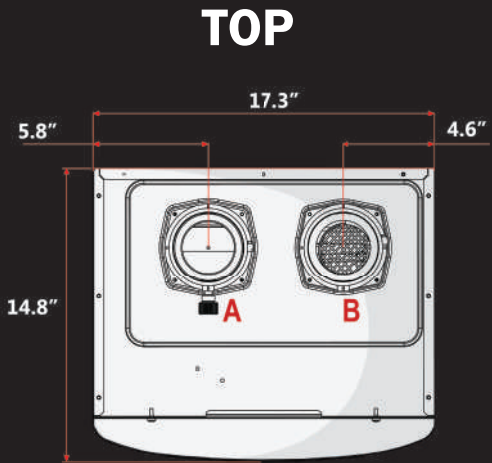
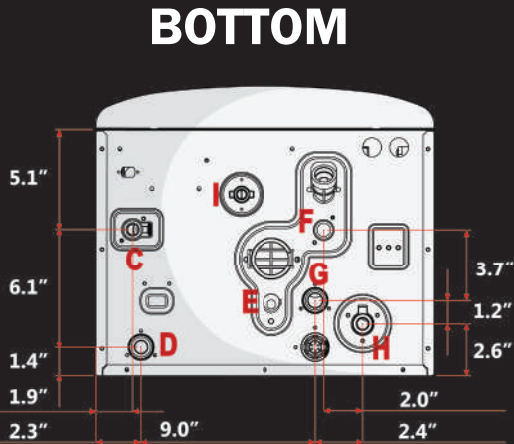
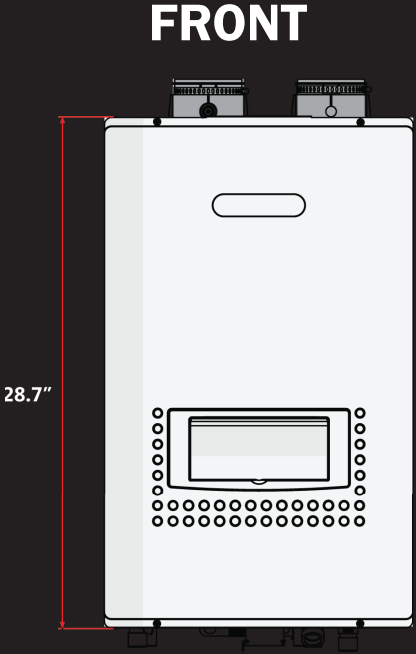

		CB180-DV	CB199-DV
Gas Input Rate (Domestic Hot Water Mode)	Max	180,000 BTUH	199,000 BTUH
	Min	18,000 BTUH	18,000 BTUH
Gas Input (Heating Mode)	Max	100,000 BTUH	120,000 BTUH
	Min	18,000 BTUH	18,000 BTUH
Hot Water Capacity Flow Rate	35° F Rise	9.2 GPM	9.2 GPM
	45° F Rise	7.2 GPM	7.7 GPM
	77° F Rise	4.2 GPM	4.5 GPM
Installation	Indoor Wall Hung		
Flue Sytem	Sealed Combustion Direct Vent, Single Vent		
Max Vent Run	2"(50ft)/3"(100ft) Schedule 40 PVC, CPVC, PP		
Gas Pressure	NG	3.5" WC to 10.5" WC	
	LP	8.0" WC to 14.0" WC	
Combustion System	Combustion System	AFR Controlled	
	Burner	Pre-mix Metal Knit	
	Gas Value	Negative Pressure	
	Minimum BTUH Control	AGM	
	Direction	Downward	
Heat Exchanger	Primary	SS304 (Austenite)	
	Secondary	SS304 (Austenite)	
	Plate Type Heat Exchanger	SS304 (Austenite)	
DHW Heating Priority		DHW Priority	

	Description	Size
A	Exhaust	3"
B	Air Intake	3"
C	Hot Water	3/4"
D	Space Heating Supply	1"
E	Condensate	1/2"
F	Cold Water	3/4"
G	Space Heating Return	1"
H	Auto Feeder Valve	1/2"
H	Gas	3/4"





HEADQUARTERS
11160 Grace Avenue
Fountain Valley, CA 92708
www.noritz.com/combi

