

BeatBox Quick Start Manual 96x

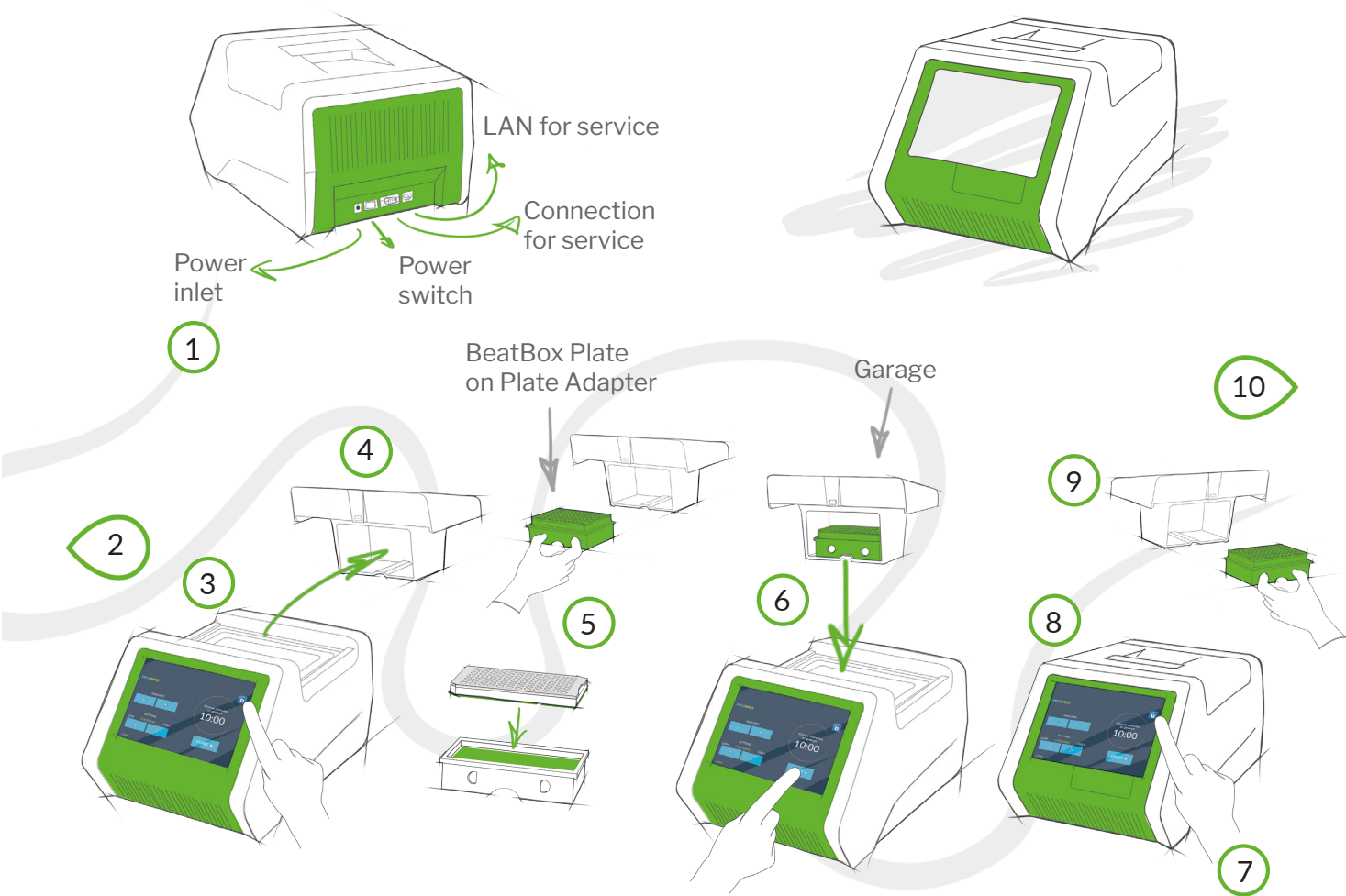

- 1 Connect the power cable and switch on

2 Perform sample preparation “before a BeatBox run” (see reverse)

3 Unlock and open the BeatBox

4 Remove the Garage from the BeatBox

5 Place the BeatBox Plate on the Plate Adapter then insert into the Garage
- 6 Insert the Garage then select preferred settings for your samples and press START

7 Unlock and open the BeatBox when homogenization run is complete

8 Take the Garage out of the BeatBox

9 Remove the Adapter and the BeatBox plate from the Garage

10 Continue with your sample preparation and remove the Gyuto beads “after a BeatBox run” (see reverse)



Before a BeatBox Run

BeatBox Plate sealed with Silicone Mat

Metal Sheet

Gyuto Bead

Silicone Mat

1 Keep the Metal Sheet in the base of the BeatBox Plate

2 Carefully remove the Silicone Mat

3 Add the samples to the wells

4 Replace the Silicone Mat on top of the BeatBox Plate

5 Use the Roller to ensure the Silicone Mat is firmly in place

6 Remove the BeatBox Plate from the Metal Sheet

7 Move over to the BeatBox and start process

After a BeatBox Run

1 Remove the BeatBox Plate from the instrument and from the Garage, then briefly centrifuge

2 Place the BeatBox Plate on the Gyuto Bead Collection Rack

3 Carefully remove the Silicone Mat

4 Transfer the samples into new reaction vessel and continue your sample preparation process

5 Place the Metal Sheet on top of the BeatBox Plate and use the Rod Magnet to stick the Gyuto Beads to the Metal Sheet ready for disposal. Remove the Rod Magnet before lifting the Metal Sheet

6 Place the Metal Sheet with the Gyuto Bead into the Autoclavable Plastic Bag

7 Recycle where possible