

# BLUEPRINT

Advanced Manufacturing

---

PRODUCT  
MANUFACTURING,  
SIMPLIFIED

---



" We are the interface between the ideas of our technology-driven customers and the solutions for economically viable manufacturing."

**Jens Harmeling**  
*Co-Founder*



" We support and enable our partners' sustainability goals through better use of raw materials, low carbon footprint, and new product morphologies."

**Jordan Kopping**  
*Co-Founder*

Starting with your idea, we define and deliver optimal technological product solutions to support your market success as a **development and manufacturing partner.**

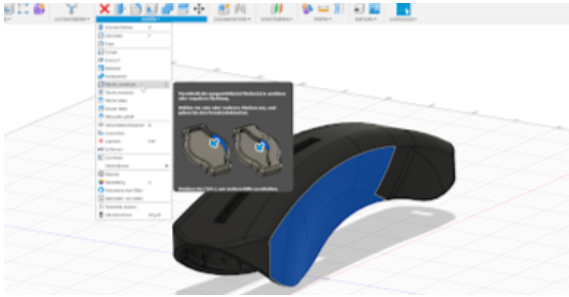

## Project Preparation

- CAD design and engineering
- Material pre-validation
- Process development
- Generative Design
- Part simulation

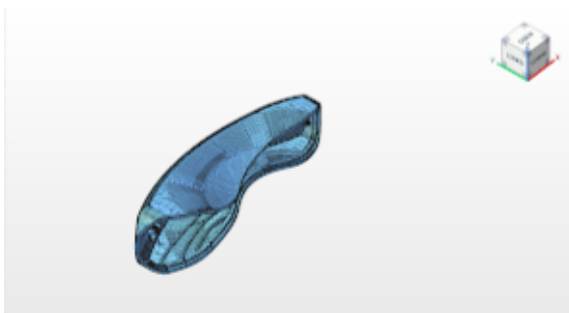

## Part Production

- Additive Manufacturing of:
  - Performance Thermoplastics
  - Metals
- Hybrid Manufacturing combining:
  - CNC milling
  - Casting technologies
- Rapid Tooling

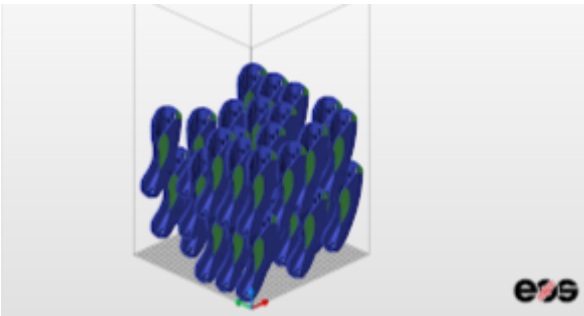

## Quality/ Validation

- In-process monitoring
- Tolerance verification
- Surface finish analysis

## Finishing

- Decorative coatings
- Metallic effect laquers
- Functional polymeric surfaces
- Technical coatings
- Electro plating
- Anodizing
- Powder coating





## What is Advanced Manufacturing?

Advanced Manufacturing utilizes innovative technologies for production to generate added product value and function. Additive manufacturing (3D Printing) linked with industrial surface finishings, for example, enables cost efficient production of complex parts in small series.

## What this means for you:

We incorporate all aspects of the value chain from concept to delivery into our analysis, relying on interactive communications with our customers to integrate manufacturing and final part finishing into a seamless, efficient operation.

# WHAT WE DO

## Our Mission

We manufacture your products. Our range of service covers all aspects of product development - from design to delivery - enabling a reliable and efficient means of production meeting the highest quality standards.



## How We Work

We are a harmonized ecosystem with extensive in-house knowledge and capabilities in manufacturing. We solve the technological and economic challenges for you, utilizing the best technology for the job.



## Our Motivation

Flexible and accessible state-of-the-art manufacturing technologies are the key to driving innovation in product development. By lowering cost barriers and reducing sourcing complexity you can achieve market launch faster.





# BENEFITS AT A GLANCE

## Small and Middle Series Manufacturing



Economically viable from part volume of 1

## Reduced Investment Costs



No investments in expansive tooling

## Complex Product Design



Get complexity for Free

## Fast Time to Market



Don't just prototype, start producing immediately

## On Demand



Production when needed

## Industrial Quality



Perfect Surface Finish

Powder bed fusion (PBF) bonds a powdered material precursor using an energy source to form a solid 3D structure. With PBF the manufacturing of parts in a wide array of materials in both plastic and metal is possible.

Blueprint Advanced Manufacturing houses the most state-of-the-art equipment to facilitate the production of high-performance and high-quality parts. Included in our machine park is for example the latest from HP and EOS.

## Technical Facts



### HP MultiJet 5200

Build Volume: 370 x 274 x 380 mm (XYZ)  
Minimal Wall Thickness: 1.0 mm  
Accuracy:  $\pm 0.3$  mm  
Layer Thickness: 0.08 mm  
Tolerances: 0.4 mm between assemblies



### EOS P396

Build Volume: 340 x 340 x 600 mm (XYZ)  
Minimal Wall Thickness: 0.6 mm  
Accuracy:  $\pm 0.2$  mm  
Layer Thickness: 0.1 mm  
Tolerances: 0.4 mm between assemblies



# IT'S ALL ABOUT THE FINISHING

Our customers' have high quality requirements. In order for their components to withstand practical application, they often require industry-adapted surface finishes.



At Blueprint, our goal is to deliver additively manufactured products with a perfectly matched surface.

## Decorative Coatings

### Effect Lacquers

Metallic effect, pearlescent, deep gloss

### Color

Color, high gloss, matt and soft touch finishes

### Printing and Engraving

Pad printing, silk screening, laser engraving

## Functional Surface Coatings

### Metallized Surface

Electroplating and PVD

### Powder Coating

Durability and surface protection

### Anodizing

Corrosion resistance and passivation



# BLUEPRINT IN REVIEW

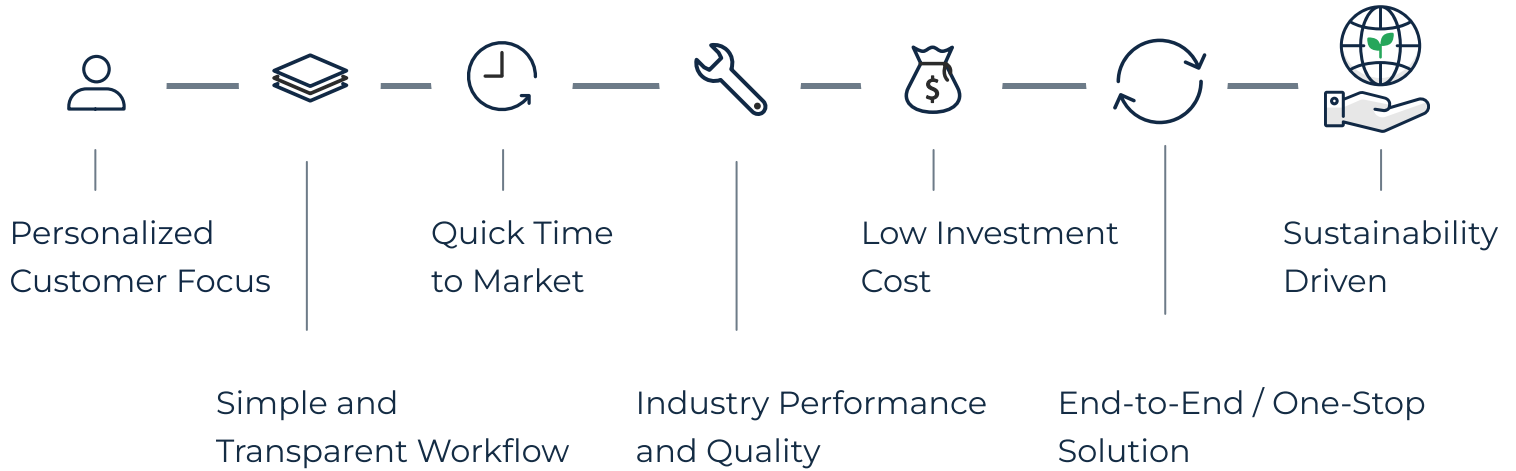

Before

After

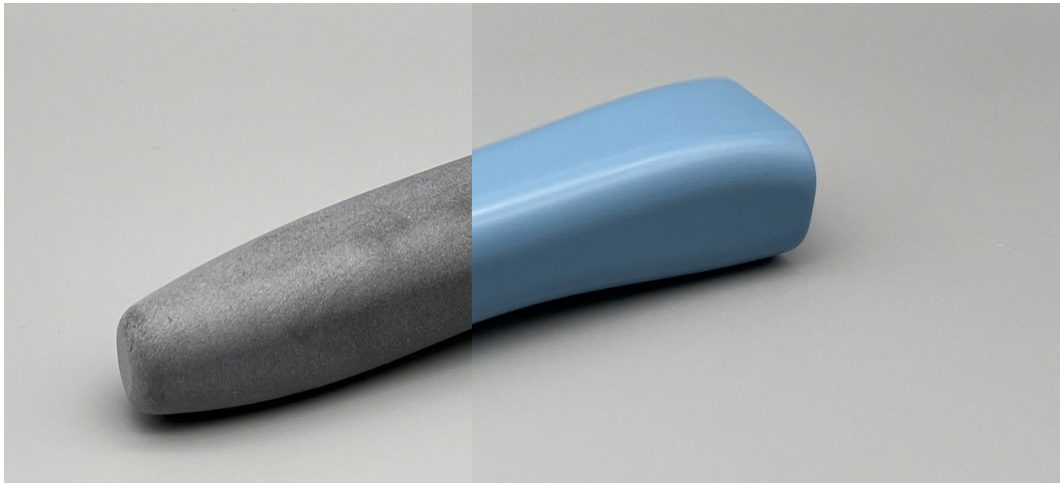

## BUILD BETTER PARTS, WITH US.



<https://www.blueprint-am.com>



08331 9259331



[info@blueprint-am.com](mailto:info@blueprint-am.com)



Algäuerstr. 10  
87766 Memmingerberg

