

BEFORE YOU SWAB

1. Verify that the kit number on your vials match.
2. Please be sure to wait at least one hour after eating or drinking.
3. Follow the swab instructions below.

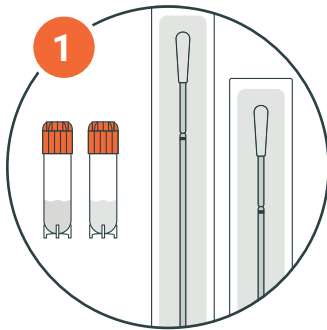

Place the unopened swabs and vials on a clean, level surface.

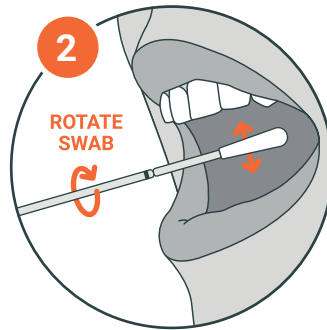

Remove 1 swab from its package, and firmly scrape the inside of 1 cheek, while rotating the swab, for 45 seconds.

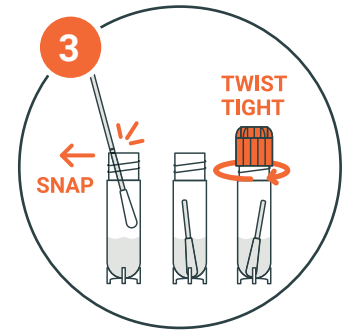

Open 1 vial, insert the swab (swab tip down), align the black line on the swab with the edge of the vial, and **SNAP** it off with the swab tip remaining in the vial's liquid.

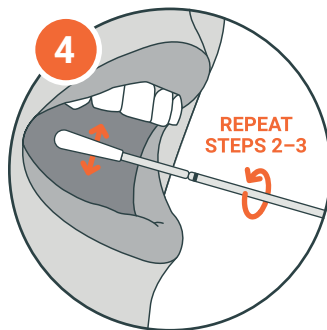

On the opposite cheek, repeat steps 2 through 3 using the 2nd swab and vial.

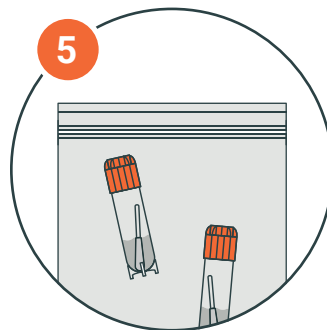

Ensure the orange cap is securely fastened on both vials. Insert both vials into the clear plastic bag, and then seal the bag.

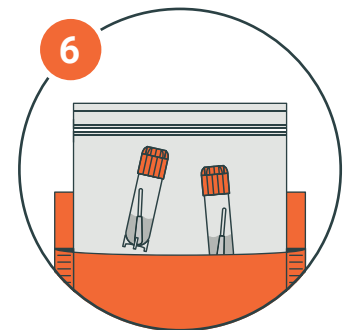

Place sealed plastic bag in the return envelope we provided. Seal the envelope.