

Perch Height Adjustable Bench System

PROPR

USER GUIDE



DESKTOP DIMENSIONS

- L48 W24
- L48 W30
- L60 W24
- L60 W30
- L72 W24
- L72 W30

CLEANING + CARE

Clean surfaces with a dry or damp soft cloth. Do not use abrasive, oil or chemical based cleaners. It is recommended to use coasters to protect surface from heat and water. Do not leave spills unattended.

WARNING

Serious or fatal crushing injuries can occur from furniture tip-over. To help prevent tip-over, read this entire warning.

To further reduce the risk of serious injury and death from tip-overs:

- Never stand on furniture
- Furniture intended for placement on floor
- Do not place items over 200lb on furniture

CONTENTS

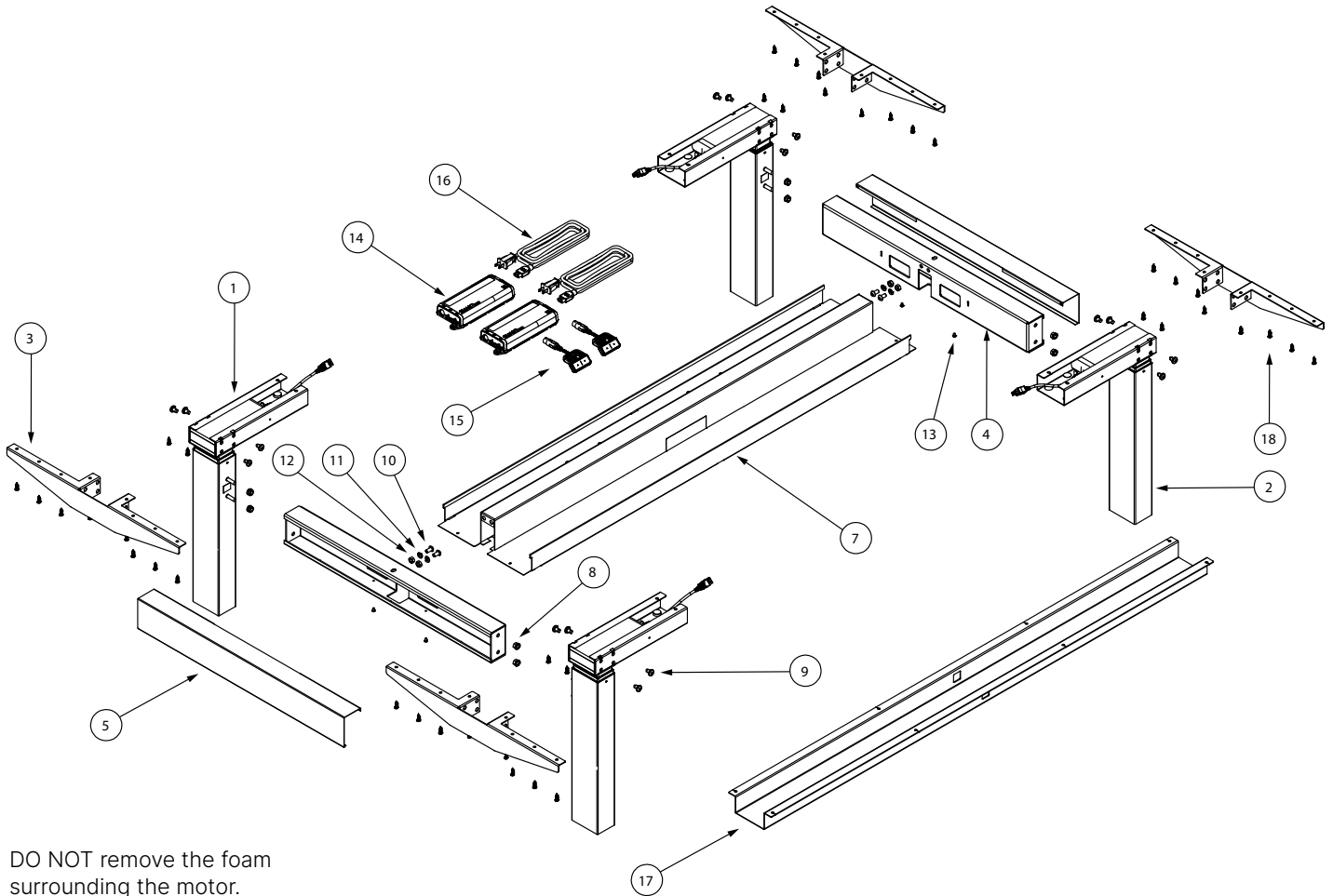

DO NOT remove the foam surrounding the motor.

PARTS	Qty/Package	PARTS	Qty/Package
1. Independent Beam	4	11. M8 Split Washer	4
2. Column	4	12. M8 Nut	4
3. Top Support	4	13. M4-0.7×6mm Screw	4
4. Ganging Bracket	2	14. Control Box	2
5. Cover	2	15. Hand switch	2
6. U-Channel	1	16. Power Cord	2
7. Cable Tray	1	17. HAT Channel	2
8. M8-1.25 Keps Nut	4		
9. M8-1.25×12mm Self Threading Screw	16	(For tables equal or greater than 72")	
10. M8-1.25×16mm Screw	4	18. #10 x ¾" Screw	48

ASSEMBLY INSTRUCTIONS

- Attach top supports and rails to columns.** Ensure the mounting holes in the column remain aligned with the corresponding holes in the beam or independent beam.

Align the beam or independent beam to the top support. Assemble using the M8×1.25 × 12mm length screws (4 per column) and a T40 Torx driver. Be aware that the mounting holes may not be tapped. As they are inserted, the provided M8×1.25 × 12mm length screws will form their own fastening threads if none are already present. An average fastening torque of 8Nm (6 lbs-ft) will be required to initially engage the screw in the hole. The maximum tightening torque for these screws is 20Nm (15 lbs-ft). Repeat as necessary for remaining columns.

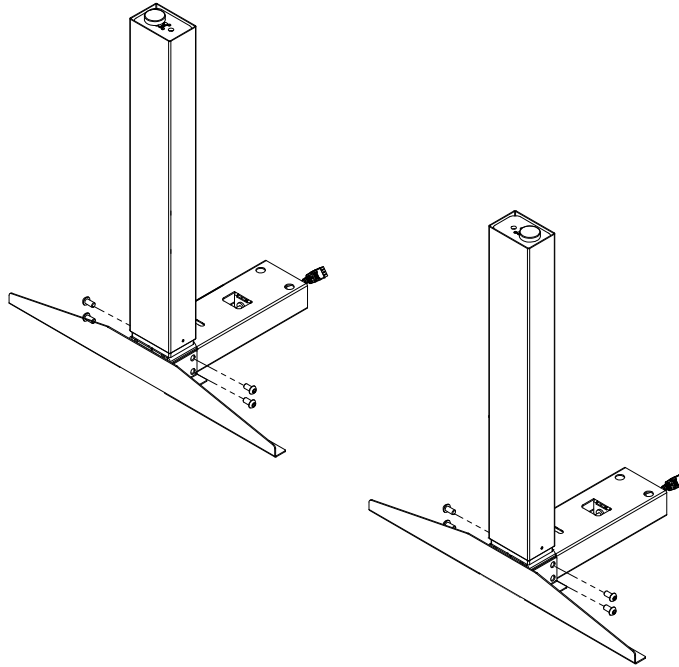

- Attach ganging tube to columns.** Assemble using the M8-1.25 Tooth Lock Washer Nut (2 per column). The maximum tightening torque for these nuts is 15.8Nm (10 ft-lbs). Repeat steps 1 and 2 for second set of columns, top supports and ganging tube.

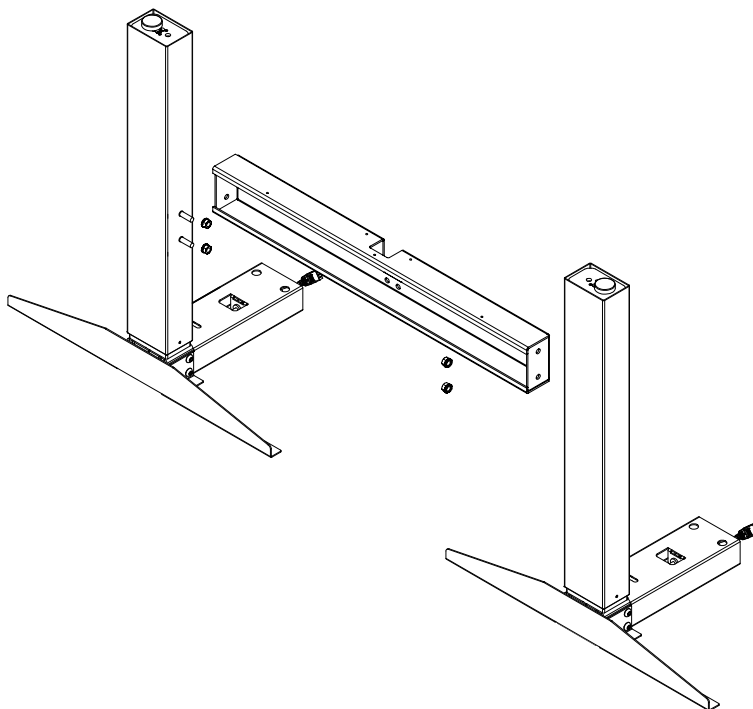

ASSEMBLY INSTRUCTIONS

3. For Electrical System Upgrade Only: Assemble Electrical. See page 8.

4. **Assemble the cable tray.** Align and insert the tabs on the u-channel into the tray. Squeeze the u-channel so that all tabs are secured into the tray.

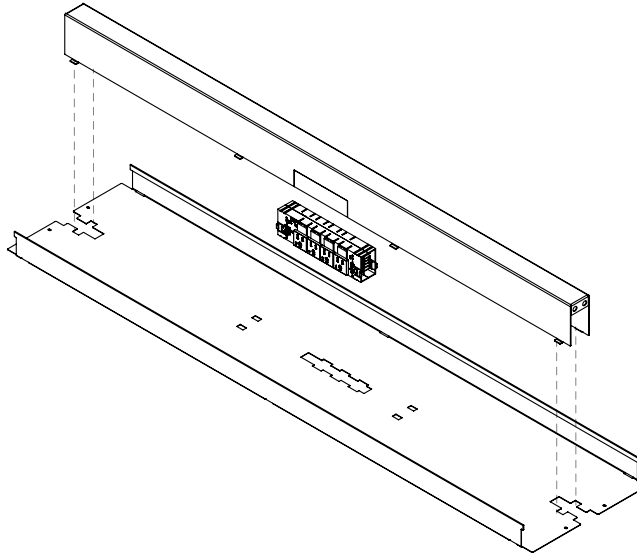

5. **Attach work surface to column assemblies.** Flip table into upright position. Top supports should be mounted 1.5" from edge of work surface. Be sure to use approved screws per the table top supplier.

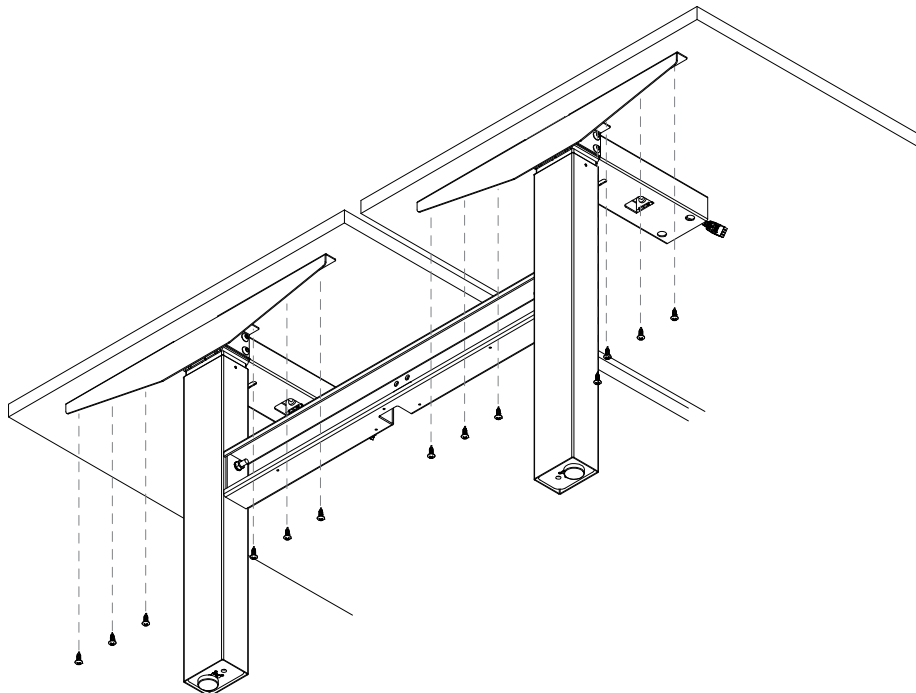

ASSEMBLY INSTRUCTIONS

6. **Fasten the cable tray assembly onto the ganging brackets.** Attach the tray to the ganging brackets using the M4-0.7×6mm length screws. The maximum tightening torque for these screws is 4Nm (35 in-lbs). Attach the u-channel to the ganging bracket using the M8 1.25×16mm length screws, M8-1.25 nut, and M8 lock washer (2 per ganging bracket). The maximum tightening torque for these screws is 20Nm (14.8 ft-lbs). A socket wrench is recommended for this step to hold the nut in place. Repeat for both sides.

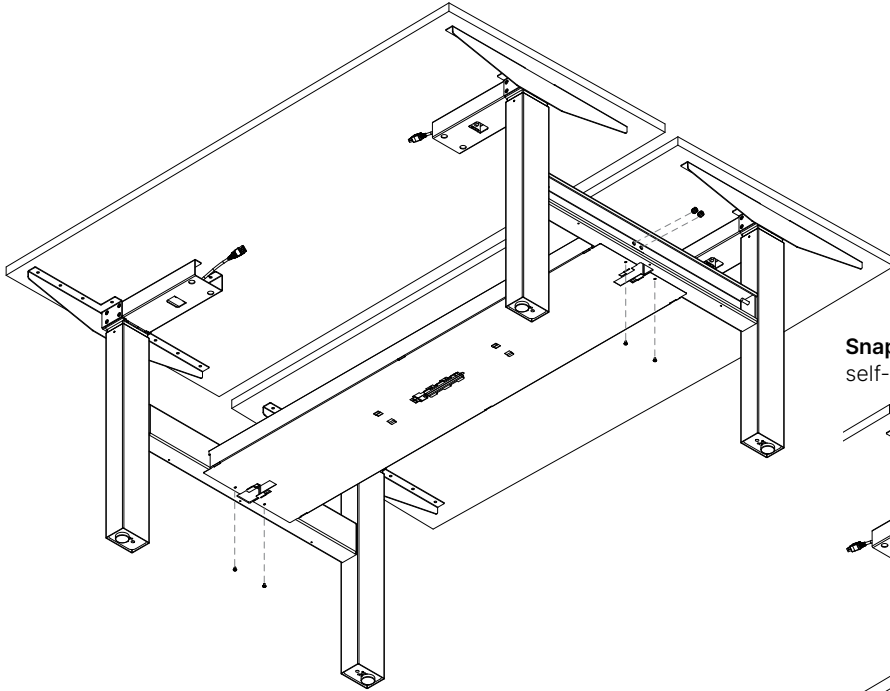

Snap on the ganging bracket covers. The covers will self-secure when snapped on to the ganging brackets.

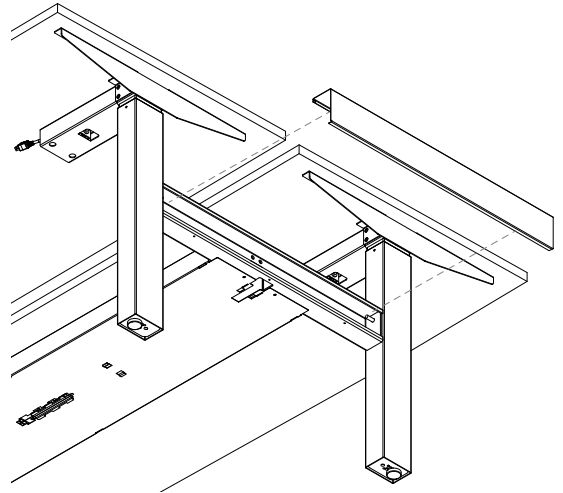

7. **(For tables equal to or greater than 66"). Attach the HAT channel.** Feed the motor cables through the HAT channel cut out.

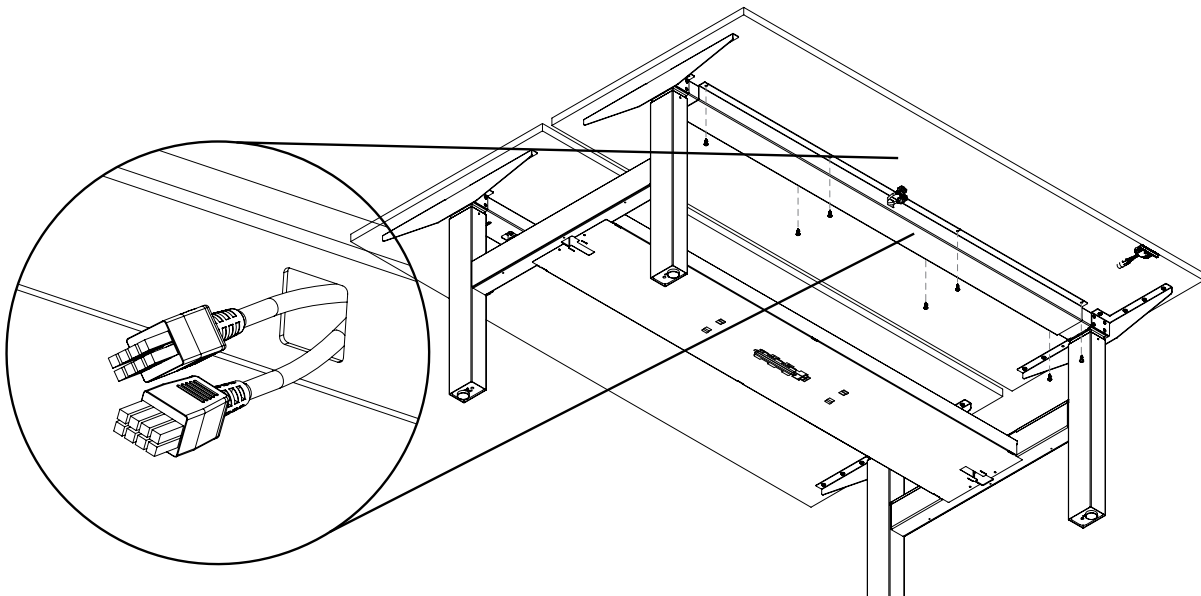

ASSEMBLY INSTRUCTIONS

8. **Fasten the control box and hand switch to the table top.** Make sure the control box and hand switch are fastened in a location where all the cables will connect without being in tension. Be sure to use approved screws per the table top supplier.

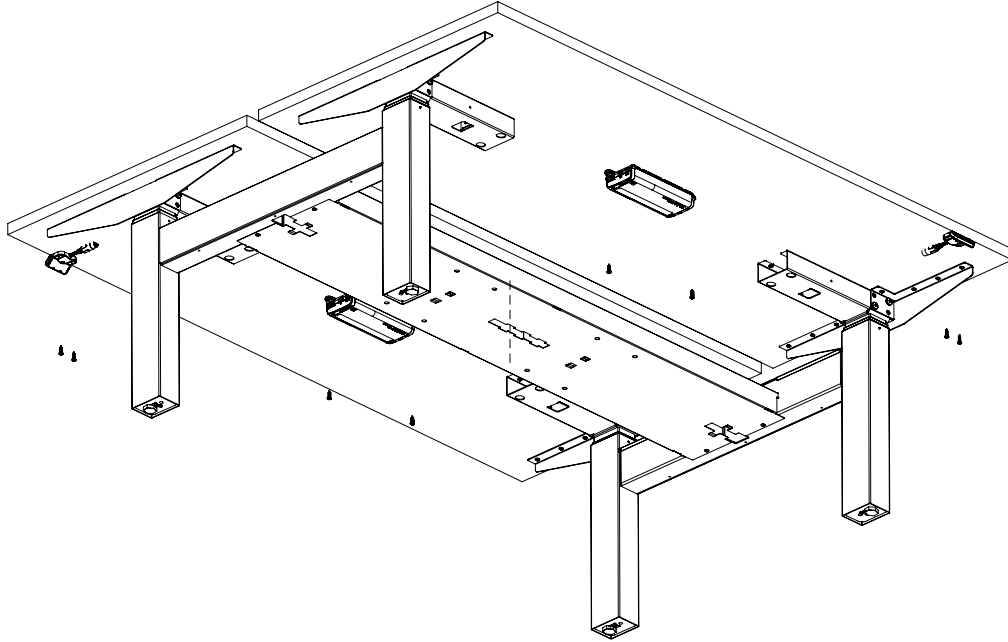

9. **Connect the motor cables to the control box.** The motor cable plug-connection has to click into place.

Connections to the control box:
M1-M2 = Connectors for the columns.
HS = Connectors for the handset.
AC = Connector for the power cord (3-pin).

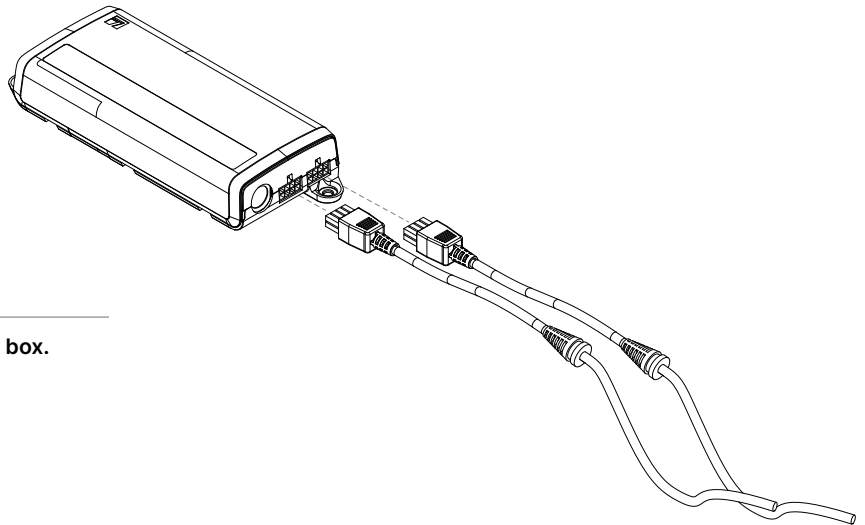

10. **Connect the hand switch (HS) cable to the control box.**

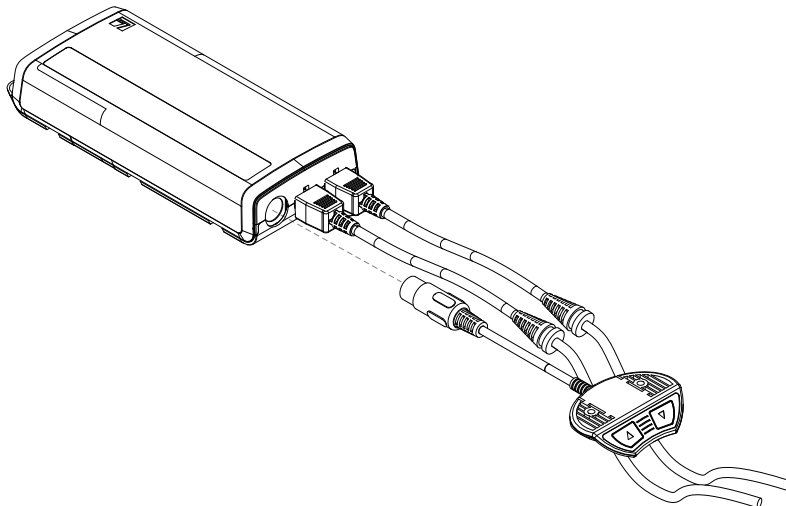

ASSEMBLY INSTRUCTIONS

11. Connect the supplied power cord (AC) to the control box.

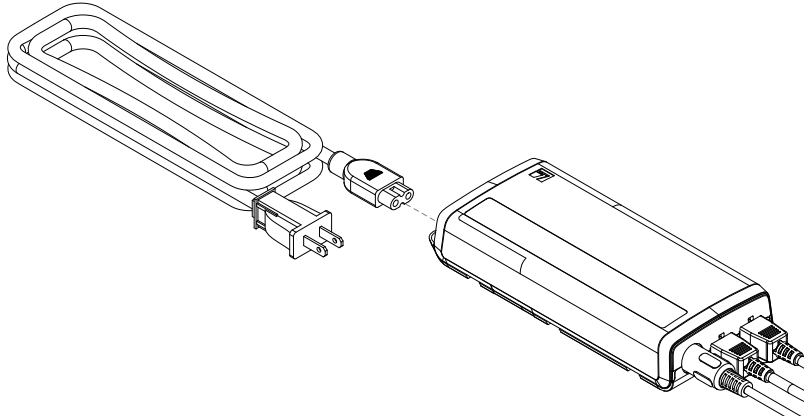

12. **Attach all cables to the table top.** Attach cables in order to avoid any damage during operation. Be sure to leave enough slack in the cables to allow for the table to move into its highest position. **Never wrap cables and/or cords around the columns.**

13. **Connect side by side tables.***

*For units specified to use a side-to-side connector, attach lower tray to the bottom of the ganging bracket of each bench using the M4-0.7×6mm length screws. The maximum tightening torque for these screws is 4Nm (35in-lbs). Once installed, the upper tray can be slid on to fit.

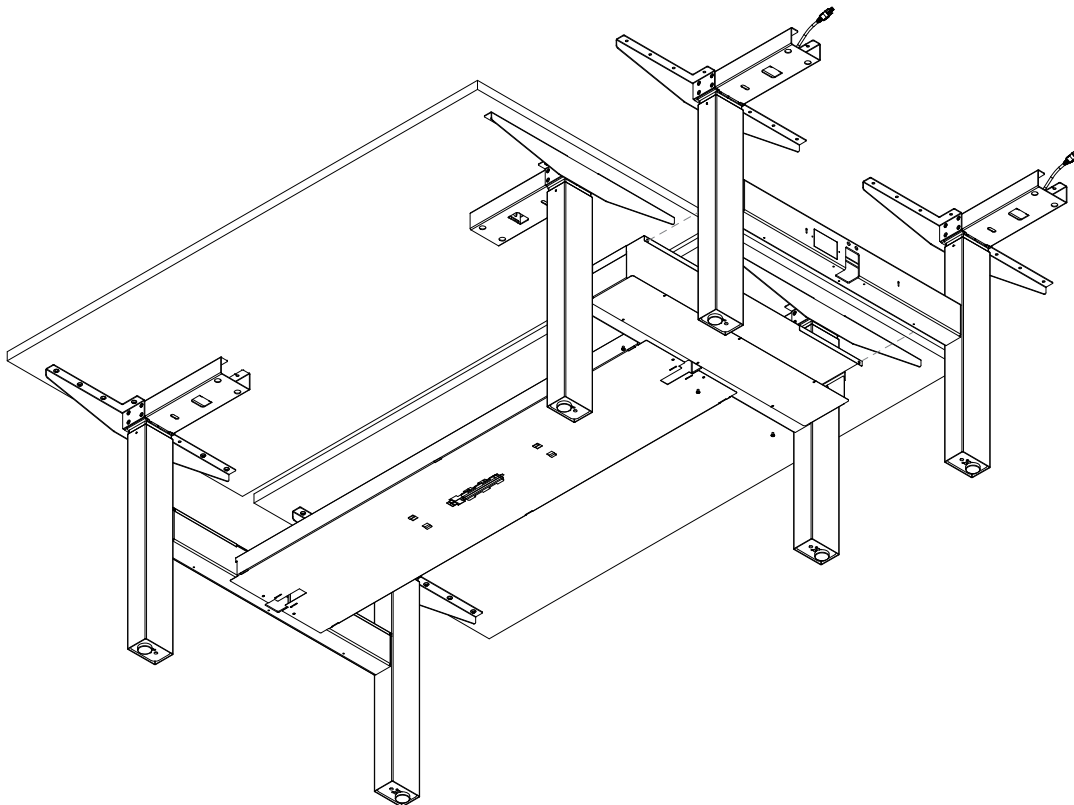

ELECTRICAL INSTALLATION

(for tables ordered with the electrical system upgrade)

Install simplex receptacles into power block.

Insert terminals into corresponding slots in block and seating receptacle until catches engage on both sides of receptacles. Note: a noticeable "snap" will be heard when receptacle is fully engaged into block. Ensure terminals go directly into slots and do not get inserted into an adjacent slot.

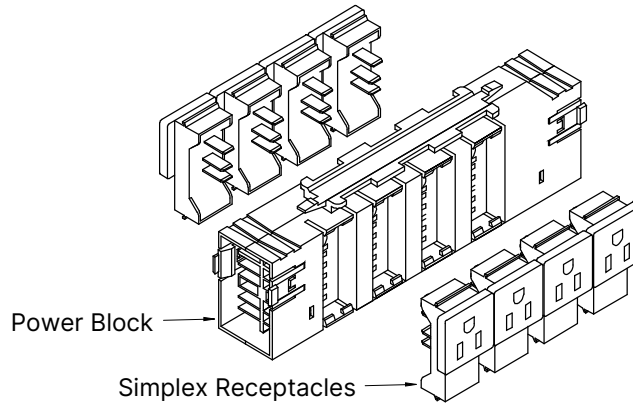

Connect cables to block.

Connect as required (not shown). Ensure cables are completely seated under cable latches and into block. Power disruption may occur if cables are not fully seated into block.

Install power block into tray.

Place the power block into the provided cut-out in the tray and slide the block to lock it into place.

Install U-channel to tray.

Remove the punch-out features from both sides of the u-channel. Power block will wedge into the channel between the punch out features, secure by squeezing the u-channel and locking the tabs into the tray.

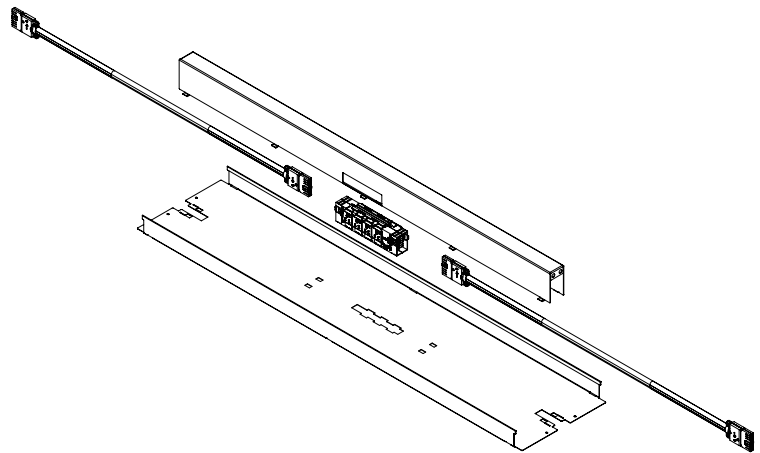

For simplex receptacle removal.

Insert ends of Simplex removal tool into slots above and below receptacle (shown) and push firmly into block until it catches on tool, snap over receptacle edges. Pull receptacle tool and receptacle straight out of the block. Note: Simplex removal tool sold separately.

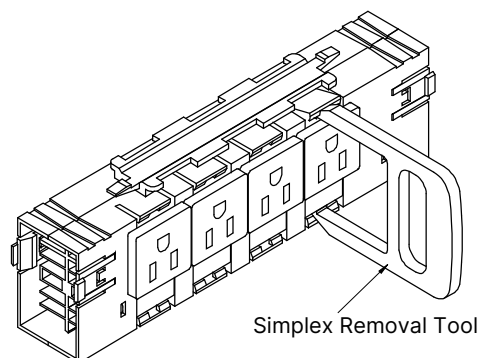

SAFETY INFORMATION

DANGER:

To reduce the risk of electric shock: Always unplug this furnishing from the electrical outlet before cleaning or servicing.

WARNING:

To reduce the risk of death, serious injury, or property damage, read and follow this safety information and the provided instructions when assembling this product. Do not change or replace components and accessories provided by Propr Office.

INSTALL ONLY APPROVED WORK SURFACES

Work surface must be at least 3/4" thick and weigh no more than 5 lb. per square foot (For example, a 2'x6' desktop should weigh no more than 60 lb). Do not exceed a maximum weight for the desktop of 75 lb. To prevent table from tipping or collapsing, make sure the desk frame is not overloaded by the weight of tabletop and objects you plan to put on the table. If you are unsure, contact customer service.

KEEP AWAY FROM CHILDREN

This table system is not designed for use in homes or other areas accessible by small children. For indoor commercial office use only.

BE CAREFUL WHEN ADJUSTING DESK HEIGHT

Body parts and property can be caught between the moving work surface and an immobile obstacle (such as shelves, furniture, window sills, or walls). Keep at least one inch of clearance around desk and make sure nothing is in table's path for its entire range of motion.

Before raising or lowering:

- Check surroundings on all sides of desk are clear
- Make sure corded objects will not be pulled off table or cause other objects to fall
- Make sure desk power cord moves freely as desk moves up and down

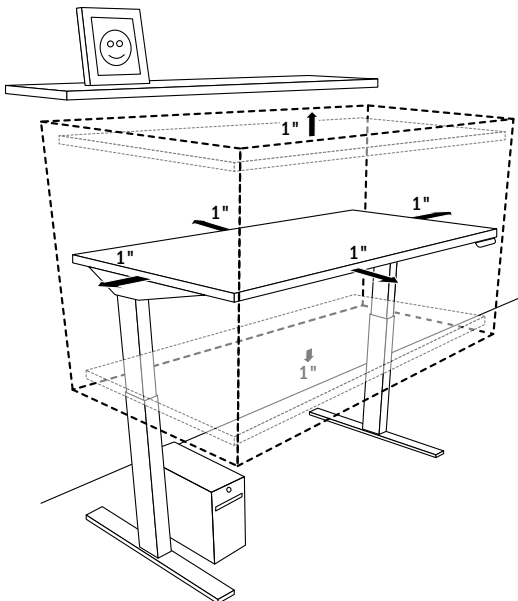

DO NOT OVERLOAD DESK

To prevent table from tipping or collapsing, make sure the desk frame is not overloaded by the weight of tabletop and objects on table. Evenly distribute load; excess loads near edges can reduce stability and lead to tip over.

- Do not exceed maximum load (including weight of desktop) of 200 lb. (91Kg) for two-leg configuration.
- Do not exceed edge load of 25 lb. when positioning monitors or mounting accessories.
- Do not sit or stand on table.

USE CARE WHEN MOVING DESK

- Clear objects and equipment from table before moving to reduce the risk of tipping over.
- Adjust the desk to its lowest height before moving.
- To disconnect, remove plug from outlet.
- Do not move a loaded desk.

DO NOT OPEN ELECTRICAL COMPONENTS

Do not attempt to service table components. There are no user-serviceable parts inside the motor control units or table legs. If your table needs service, contact customer service. Never operate this table if it has a damaged cord or plug.

KEEP TABLE FRAME DRY

Keep all electrical components away from water and high humidity. Clean only with a dry or slightly damp cloth. Do not spray cleaning solutions directly onto table system.

GROUNDING INSTRUCTIONS

This product is equipped with a cord having an equipment-grounding conductor and a grounding plug. Use only the cord provided. Make sure that the product is connected to an outlet having the same configuration as the plug (as shown in Illustration A) that is properly installed and grounded in accordance with all local codes and ordinances.

Do not modify the plug provided with the product – if it will not fit the outlet, have a proper outlet installed by a qualified electrician.

- No adapters are to be used with this product.
- Keep cord away from heated surfaces.

ILLUSTRATION A

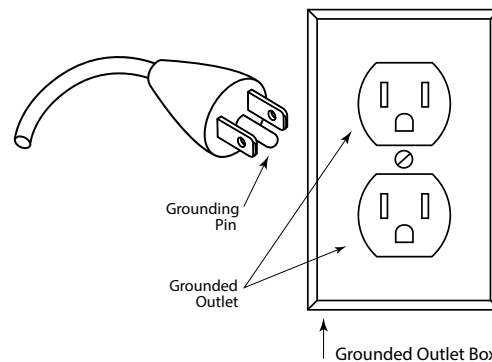

OPERATION INSTRUCTIONS

INITIALIZATION/RESET

The desk must be initialized/reset after any of the following:

- After assembly
- After disconnection from the power supply
- After any impact on the table top

To initialize/reset, move the table to the lowest position by pressing the DOWN button on the hand switch until the columns reach the lowest position. Press the DOWN button again until the table moves slightly down to the machine zero point and back up to the operation zero point. Release the DOWN button. If the button is released too soon, the table legs will not move up. Repeat the reset process.

The control box is programmed with a parameter file which controls the table legs' lower and upper travel limits. Under no circumstance should a control box from one table be moved to another.

NORMAL HAND SWITCH OPERATION (for all hand switch types)

By pressing the UP or DOWN buttons, the table will move up or down to the desired position. Once the desired position is reached, let go of the UP or DOWN button. The table legs will stop once they reach the lower or upper height limits.

TROUBLESHOOTING

ISSUE	SOURCE	SOLUTION
Desktop does not move	No power supply	Plug in power cord. If necessary check connections on control unit.
	Loose or no connection to legs	Verify table leg motor power cords are connected to control box.
	Loose or no connection to the hand switch	Verify hand switch power cord is connected to control box.
	Max lifting capacity is exceeded	Reduce weight or load on desktop.
	Max time limit exceeded	Control is deactivated automatically for about 9 minutes.
	Defective or damaged motor	Contact customer service.
	Defective or damaged control box	Contact customer service.
	Defective or damaged hand switch	Contact customer service, replace hand switch.
Desktop moves down at a slow rate	Control box expects new reset	Reset control box. See "Operation Instructions" above.
Desktop moves up at a slow rate	Max lift capacity may have been exceeded	Reduce weight on desktop.
Desktop moves on one side only briefly and then stops	Loose or no connection between legs and control box	Verify the plug connections of the motor cable to the control box and reset the control box.
	Defective drive	Contact customer service. Check motor cord for damages.

TECHNICAL DATA

GENERAL CONTROL BOX	
Power supply	120 VAC ±10% / 60 Hz
Standby power consumption, primarily	< 0.3 W
Operating temperature	0-35°C
Protection class	IP20
Maximum power output	216VA/24V

TWO-COLUMN FRAME WITH CONTROL BOX	
Maximum lift capacity	200 lb (≈ 90 kg / 890N)
Adjustable range, depending on version	View Illustration B
Maximum input current	5 A
Maximum duty cycle	10% (2 min. on / 18 min. off)

ILLUSTRATION B
Single Stage Dual Stage

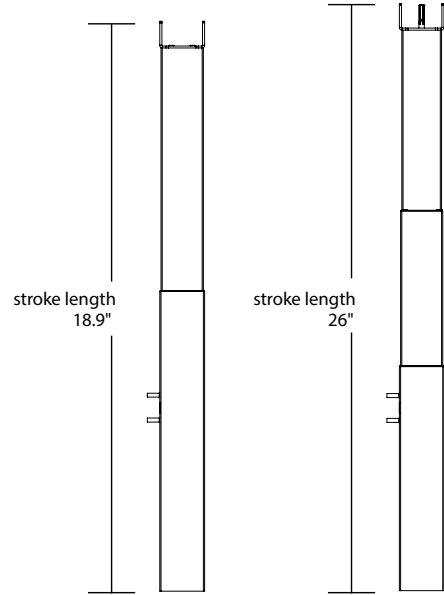

STANDARDS + CERTIFICATIONS

The drive system is tested according to the following standards:

- UL 962
Issued: 2014/11/07 Ed: 4 Household and Commercial Furnishings
- CSA C22.2#68
Issued: 2009/09/01 Ed: 7 (R2014)
Motor-Operated Appliances (Household and Commercial)
- Meets BIFMA x5.5 2014