

Vinylit

BY ELTHERINGTON



The future is recycled.

Vinylit, a 100% recycled holiday home cladding solution by Eltherington.



eltherington
leisure products



Vinylit - innovative and individual.

The sustainability of the material, the lasting, appealing effect and the ecological benefit of Vinylit façade systems delight holiday home owners and craftsmen alike. The systems can be combined and enables you to create imaginative and aesthetically pleasing holiday home façades.

vinylPlus Shadow

Round profile Wood texture foiled

Spotlights on! All eyes on the shadow joint. The vinylPlus Shadow profiles are made from 100% recycled plastic filmed with a UV-resistant textured foil. The high-quality foils impress with their variety of colours. This results in a modern, traditional appearance of a high-contrast, open cladding.

AVAILABLE COLOURS

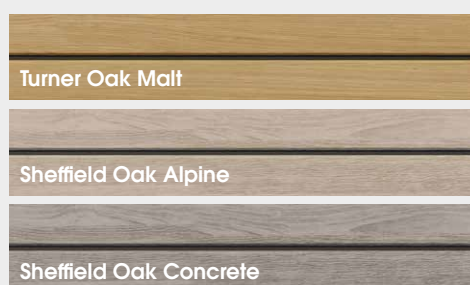

REDUCING CO² EMISSIONS

- ✓ Made from recycled/recyclable PVC
- ✓ Durable and free of pollutants
- ✓ Extremely robust and maintenance free
- ✓ Insulating and energy-efficient
- ✓ Easy-care and environmentally-friendly
- ✓ Noise and sound-insulating properties



10 YEAR WARRANTY



ENERGY EFFICIENCY



RECYCLED PLASTIC



EASY TO CLEAN

vinylPlus

Shiplap profile Wood texture foiled

vinylPlus profiles are made of 100% recycled plastic filmed with a UV-resistant textured foil. vinylPlus is available in a shiplap profile version and as a round profile, offering all the design possibilities of natural wood.

AVAILABLE COLOUR

Artisan Oak



vinylTherm

Render / Natural Stone Texture

The vinylTherm profiles bonded with high-quality natural stone granules are weatherproof, easy-care and extremely durable.

Profiles with bevel edge convey the appearance of a closed render surface. Furthermore, profiles with bevel edge laid horizontally or vertically, allow highlighting of gables and entrance areas.

AVAILABLE COLOUR

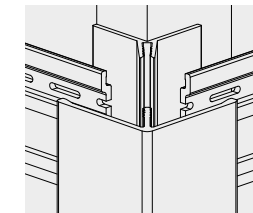

Corner profile

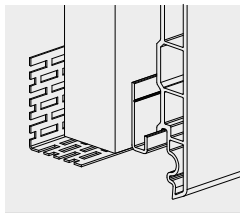

Vent profile & starter profile

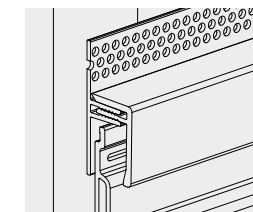

Top vent profile

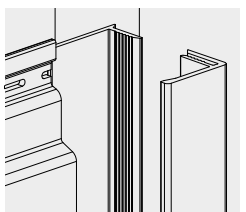

Universal trim

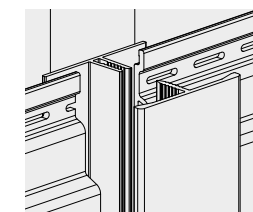

H-Profile

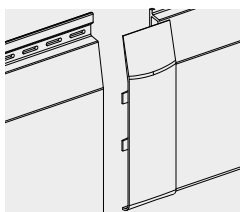

Joint

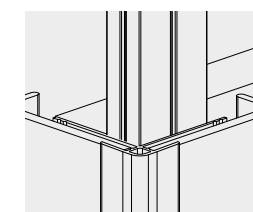

Corner profile

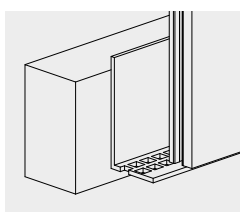

Vent profile & starter profile

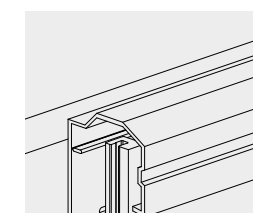

Top vent profile

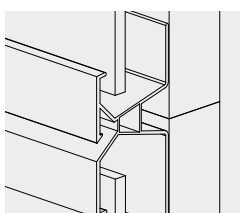

Universal trim

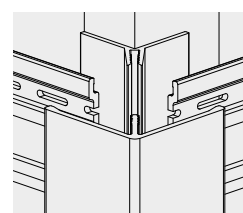

Corner profile

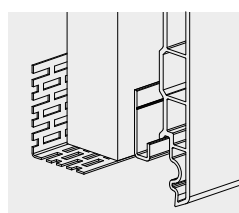

Vent profile & starter profile

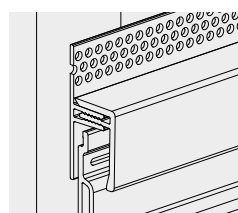

Top vent profile

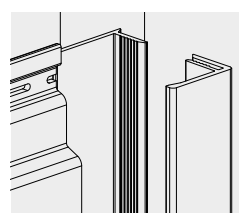

Universal trim

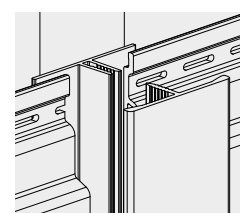

H-Profile



Vinylit

BY ELTHERINGTON

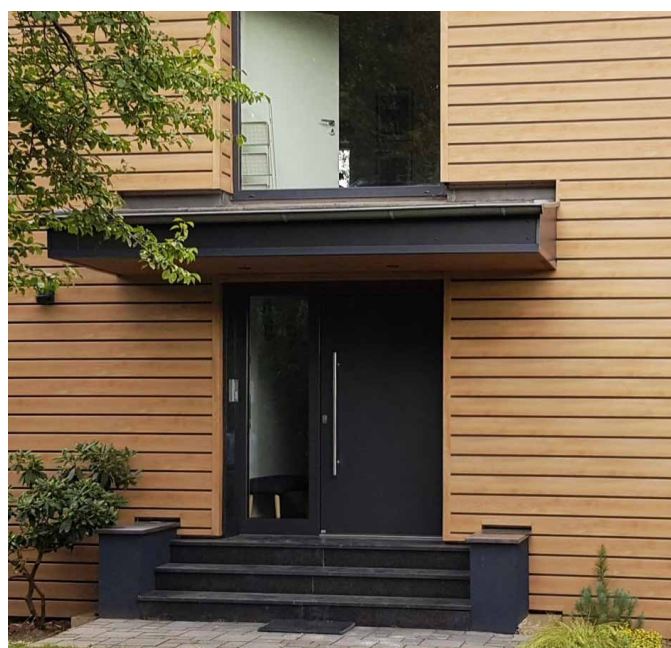

Leaders in the Leisure sector

We've supplied the leisure home and caravan industry for over 60 years.

Throughout this time we have been focussed on supplying reliable, innovative and high quality solutions, which has earned us a place as the Partner of Choice for leading companies in the sector.

We offer a range of standard and bespoke products including exterior cladding, windows, doors and ancillary products for touring caravans, motor homes and holiday homes.



eltherington
leisure products

Eltherington Group Ltd

Eltherington Business Park,
1305 Hedon Road,
Hull, HU9 5QD
East Yorkshire, UK

T: 01482 320336

E: info@eltherington.co.uk

eltherington.co.uk