

# 3537 Osler Street

Shaughnessy, Vancouver

## Main

Main	4,098 Sq Ft
Upper	3,089 Sq Ft
Lower	3,693 Sq Ft
<b>Total</b>	<b>10,880 Sq Ft</b>

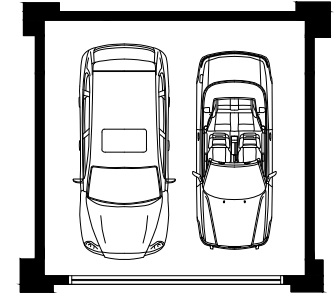
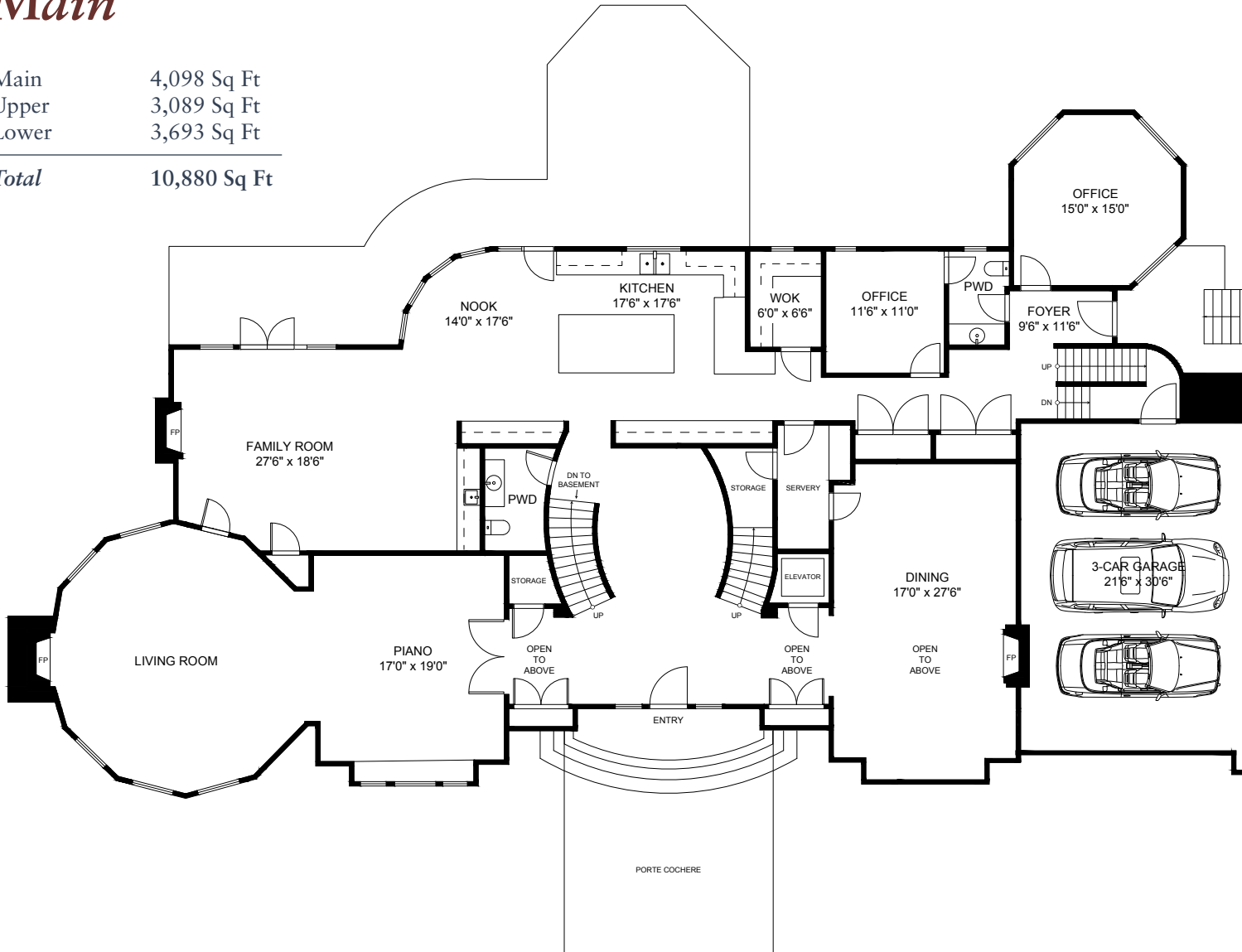

The above information is provided from sources believed reliable but should not be relied upon without verification. Square footage is approximate, please verify independently if deemed important.



Crystal Hung PREC

(778) 893-2422

iconco.ca/osler

# 3537 Osler Street

Shaughnessy, Vancouver

## Upper

Main	4,098 Sq Ft
Upper	3,089 Sq Ft
Lower	3,693 Sq Ft

**Total** 10,880 Sq Ft

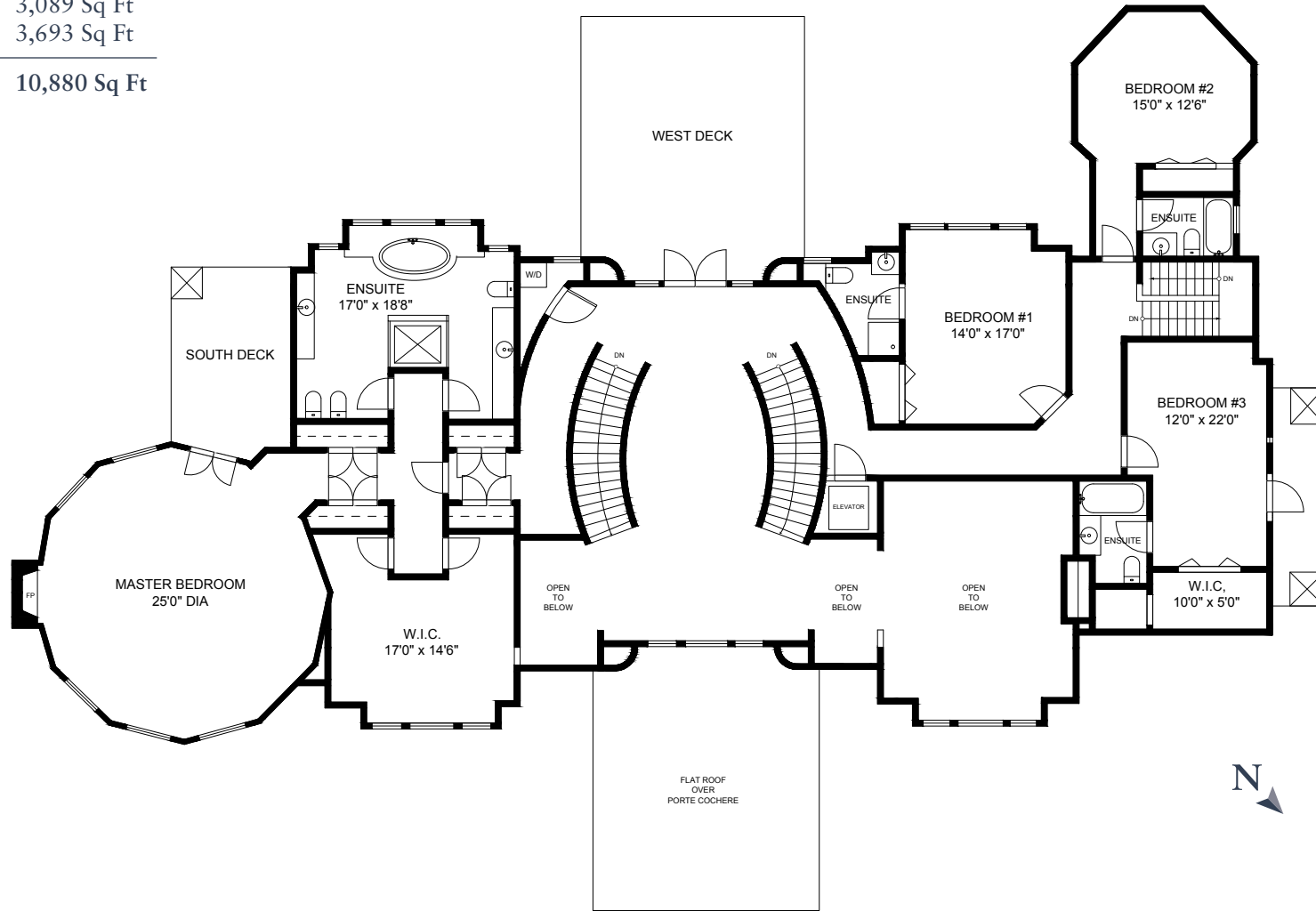

# 3537 Osler Street

Shaughnessy, Vancouver

## Lower

Main	4,098 Sq Ft
Upper	3,089 Sq Ft
Lower	3,693 Sq Ft

**Total** 10,880 Sq Ft

