

7 NIGHT REMOTE NORTH DISCOVERY CRUISE



OUR CRUISES INCLUDE:



All meals



Daily snorkel,
kayak, SUP



Local food
& culture



Island tours
& hikes



Entertainment



24/7 coffee &
tea facilities



Kids Club inc
early dinner
(5-9yrs)



Boat & bus
transfers

**Captain Cook
Cruises™**
FIJI'S CRUISE LINE

Departing 2022 - Saturday 23 Apr, 20 Aug, 20 Dec
2023 - 18 Feb, 22 Apr, 23 Dec & 2024 - 17 Feb

The beauty of Fiji lies in its diversity over 330 islands waiting to be explored. Discovery cruises are designed to offer you an authentic & personal experience of the South Pacific.

Cruise beyond the Yasawa Islands to Levuka on the island of Ovalau. This quiet historic town with its stately backdrop of 19th Century colonial architecture and waterfront promenades is a time capsule of colonial rule.

Swim in the Tavoro Waterfall lagoon, or hike to the top of the falls in the Bouma National Park on the garden island of Taveuni and stand on the 180th Meridian – the arbitrary Dateline between today and tomorrow.

Our journey takes you to Savusavu's extinct volcanic crater, hot springs and thriving markets. Explore picture perfect coral cays for snorkeling, glass bottom boat and scuba diving opportunities and discover the remote Northern islands of Fiji.

Early Booking Discounts are available on adult fares!

ADDITIONAL FEATURES:

- Most twice daily excursions included
- Freshwater swimming pool & sundeck spa
- Choice of 4 recently renovated accommodation levels
 - Day Spa (massage & beauty) optional
 - Scuba Diving (Padi 5 star) daily—optional
 - Mini-gym & audio visual room/library
 - Easy access small boat launching platform
- Interconnecting family staterooms and family quad cabins
- Resident marine biologist cultural & marine presentations

FARES EXCLUDE: Transfers to the ship, drinks, optional tours, scuba diving & services.

For bookings please contact your travel agent or
Phone: +61 9126 8160 OR +679 670 1823
Email: fiji@captaincookcruisesfiji.com
Website: www.captaincookcruisesfiji.com

CONDITIONS: Valid for sale & travel from 1Apr21 to 31Mar24 excl special events. Prices are AUD twin share & are inclusive of Value Added Tax (VAT) of 9% and 5% Environmental and Climate Adaptation levy (ECAL) (as at Aug20). Early Booking discounts available on adult fares only. Prices may be subject to change due to fuel price & currency fluctuations. Limited Availability – a select number of seats/rooms have been set aside for this promotion. Once these rooms have been sold prices revert to normal Brochure Fares. Valid on new bookings only. Infants under 5yrs are not accepted. Conditions apply.

AUD\$	"D" Porthole Cabin Twin/Dbl/Bunk	"C" Ocean Stateroom Twin/Double	"B" Ocean Stateroom Twin/Double	"A" Tabua Suites Twin/Double
Twin Share pp	3301	3899	4298	5165
Sole Occupancy	4127	4874	5370	7741
Bunk Triple/Quad Share pp	2640	N/A	N/A	N/A
Child 5-17yrs sharing with adult	1026	1226	1277	5165
Separate Children's room (max 4 in Cabin or 2 in Stateroom)	4127	2452	2554	

7 NIGHT REMOTE NORTH DISCOVERY CRUISE ITINERARY

SATURDAY: Tivua Island

Welcome aboard with a complimentary fruit punch and welcome salusalu (lei) as we set sail for our Fiji Island adventure. This afternoon visit Captain Cook Cruises own exclusive island "Tivua" where you can enjoy a twilight swim, snorkel or relax on the beach. A great place to refresh your scuba and snorkel skills. Tonight, enjoy our special Welcome Dinner and Crew Introduction.

SUNDAY: Levuka – UNESCO listed old Capital of Fiji

This morning we arrive at the port of Levuka on the island Ovalau, situated off the northeast coast of the main island. Passengers are invited to attend a special choral church service with the amazing harmonies of the congregation. Levuka was the first European settlement in Fiji and became the centre of British colonial administration and trade. At its peak over 50 hotels catered to the thirst of sailors in port and the town gained a wild reputation. In 1888 the capital was moved to Suva on the main island, and Levuka's notoriety gradually waned. Passengers are invited to join an optional tour of this now quiet historic town. In the afternoon we have snorkelling and a shipwreck tour or just explore the town.

MONDAY: Makogai, Clam research & Old Leper colony

Start your day at Makogai Island with a snorkel or glass bottom boat tour. In the afternoon join the 1 hour walking tour of Makogai leper colony and clam research station. The local primary school children will then entertain you with their song and dance.

TUESDAY: Savusavu, Pearl Farm & Hot Springs

This morning we arrive at Savusavu, the second largest town on the second biggest island in Fiji, Vanua Levu. Savusavu is positioned on an extinct volcanic crater. Explore the town and its hot-springs or visit the world-famous Justin Hunter pearl farm. Later this afternoon you will have the opportunity to further explore the town & markets or snorkel with our marine biologist.

WEDNESDAY: Tavoro Waterfall in the Bouma National Park/Naselesele

This morning we disembark on the western side of Taveuni Island - the "Garden Island" of Fiji. The optional bus tour takes you to the beautiful Tavoro Waterfall in the Bouma National Park where you can swim and relax in the beautiful setting or hike to the top of the falls. After a picnic lunch at the national park, we return to the ship or snorkel & swim off the beach. This evening we will be visiting Naselesele Village to enjoy the tastes of Fiji with a traditional 'lovo' (earth oven) feast where we share fresh local seafood, meat succulent tropical fruits. Then dance to the drum of the meke(dance) and kava ceremony.

THURSDAY: Dateline & Whispering Tide

Taveuni Island lies on the 180th Meridian, the arbitrary line between today and tomorrow. Our crew will take you to the famous natural Dateline where you can literally stand with one foot in the past and one foot in the future. This afternoon we visit Whispering Tide for swimming and snorkelling before our scenic cruise along the south west coast of Vanua Levu navigating Bligh Water. This evening we have a white theme so join in by dressing in white for an amazing atmosphere plus don't forget to don your dancing shoes on for the famous Captain Cook Cruises Music Quiz.

FRIDAY: Nananu-I-ra, Viti Levu Bay, North Coast of Viti Levu

Cruising south west from Vanua Levu we arrive at Nananu-i-ra on the northern coast of Viti Levu for our customary swim, snorkel and beachcombing or just a lazy morning to enjoy our beach visit. After lunch there is our last opportunity ashore before we begin our homeward journey. Don your favourite island attire and join all the celebrations of our Pacific Island Night Finale.

SATURDAY: Nadi

Enjoy breakfast before we disembark at Port Denarau Marina with farewell Isa Lei, at 9.00am

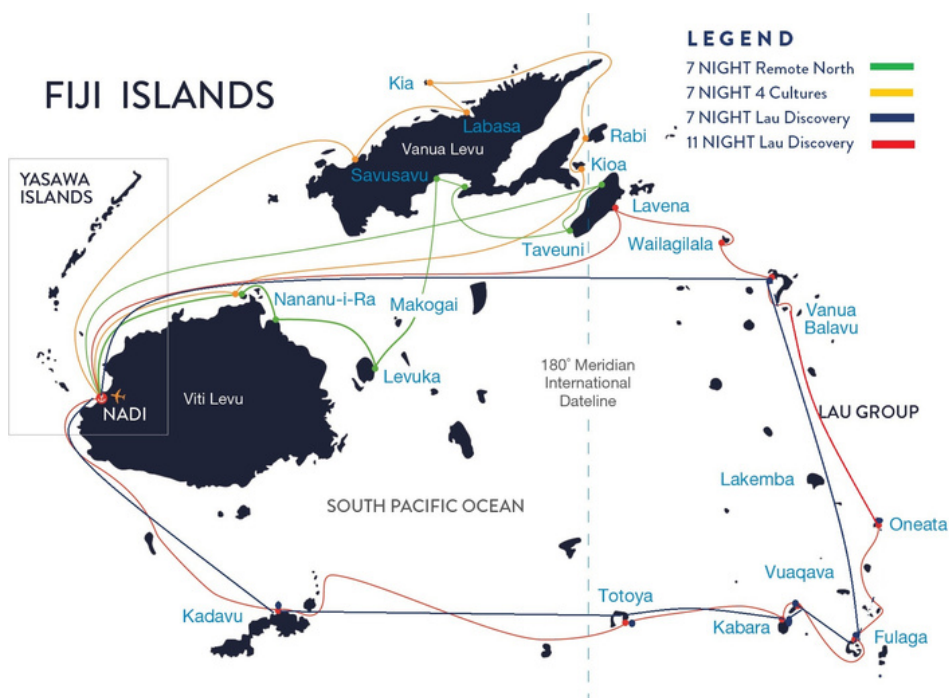

REEF ENDEAVOUR SHIP LAYOUT

Accommodation: MV Reef Endeavour has 63 recently refurbished Tabua Suites, Staterooms and Cabins.

Every cabin type features a private bathroom ensuite, on/off air-conditioning, hair dryer, 240 volt power, international shaver point, Pure Fiji soaps, shampoo & towels serviced daily. Each cabin is approximately 14sqm. Tabua Suites are approximately 28sqm. Staterooms and Suites open onto the outside deck and have two windows.

Tabua Suites (4) feature a bedroom (twin/double) with ensuite bathroom, plus a separate day room with, chair, settee, desk, TV & DVD player, refrigerator, tea & coffee facilities and second bathroom.

Connecting Family Staterooms (6) located on A & C decks (twin/double)

"B" Ocean Stateroom (33) located on A and B deck

"C" Ocean Staterooms (16) located on C deck

"D" Porthole Cabins (10) open onto an inside passageway (twin/double/buk triple/bunk quad).

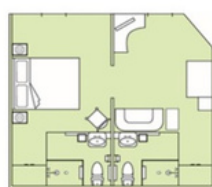
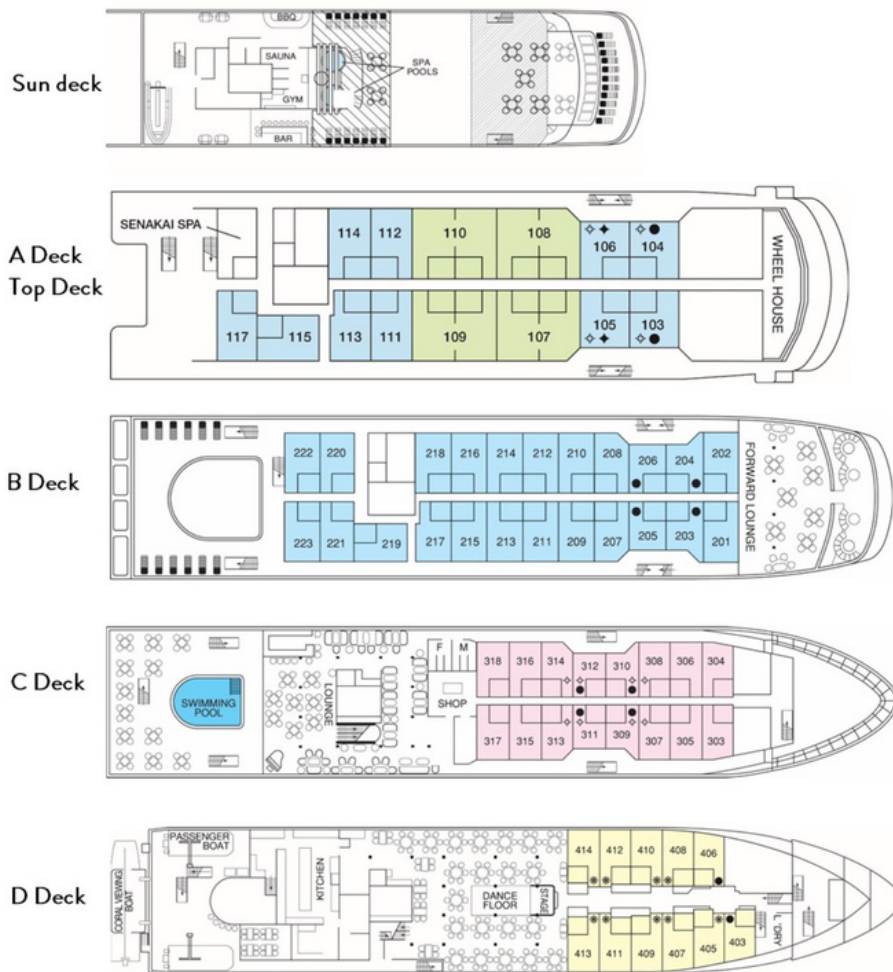

TABUA SUITE



FAMILY OCEAN STATEROOM
A & C DECK



C OCEAN
STATEROOM

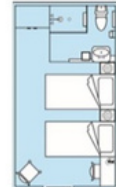

B OCEAN
STATEROOM



PORTHOLE
CABIN



Tabua Suite



Connecting Family
Ocean Stateroom



C & B Ocean Stateroom

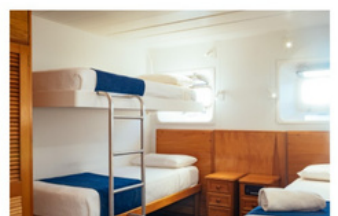

Porthole Cabin