

# 3 Light Square Farmhouse Pendant Fixture

Installation Instructions for item AL10006P3

# AMBIATE

**CAUTION: To prevent electrical shock, ensure electricity has been turned off at the circuit breaker before beginning.**

- Read all instructions before installing.
- Ensure all electrical connections must be made in accordance with the National Electric Code and local codes and ordinances. If you are uncertain of the methods of installing electrical wiring and lighting fixtures, secure the services of a qualified licensed electrician.
- Retain installation instructions for future maintenance reference.

## INCLUDED HARDWARE

1

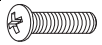

Mounting Screw  
Qty: 2pcs

2



Wire Connector  
Qty: 3pcs

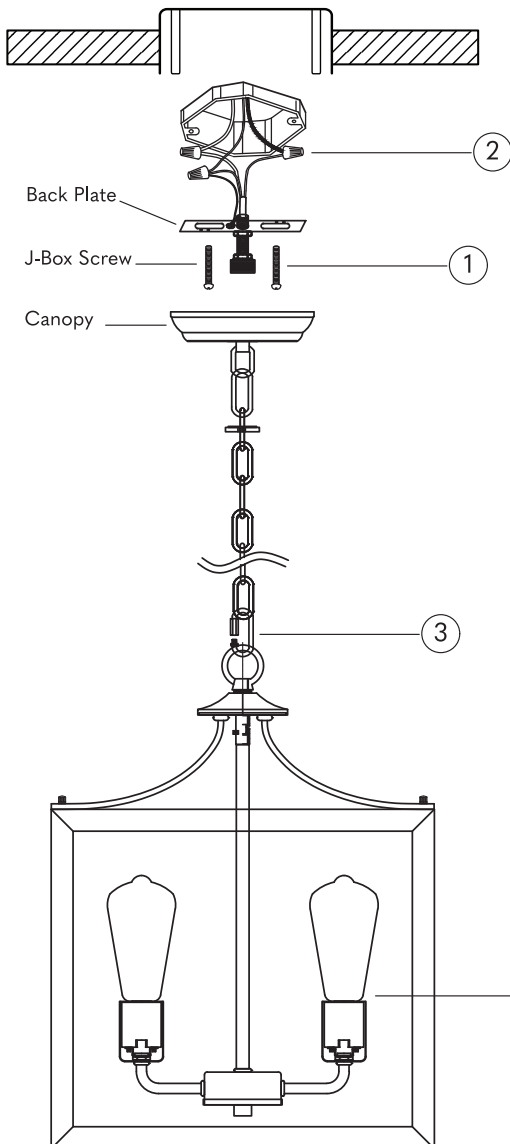
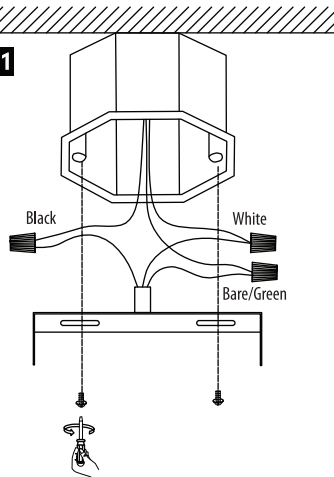

Fig. 1



## PREPARATION

1. Shut off the power at the circuit breaker and remove existing fixture, including the crossbar.
2. Carefully unpack your new fixture and lay out all the parts on a clear area. Be careful not to lose any small parts necessary for installation.

## MOUNTING THE FIXTURE

3. Remove the mounting bracket from fixture canopy and install onto junction box using mounting screws (1).
4. Connect the fixture wires to junction box wires as shown (Fig. 1). Black to black, white to white, and bare/green to bare/green. Make sure that all wire connectors (2) are secure. If your outlet box has a green or bare copper ground wire, connect the bare copper wire from the fixture to it. Otherwise, connect the fixture's ground wire directly to the back plate using the green screw. After wires are connected, tuck them carefully inside the junction box.
5. Attach canopy to mounting bracket using the included canopy screws (1).
6. Install bulbs, not to exceed max rated wattage (4). Turn on power at the circuit breaker.