

THE INGLETON

Steal away to a true marvel

With a fabulous, fresh layout and designer detailing, The Ingleton lets you enjoy a space that's chic and quite unique. With an inviting entrance that opens up into the breakfast bar, while touches of floral fabric add oodles of cosy charm.

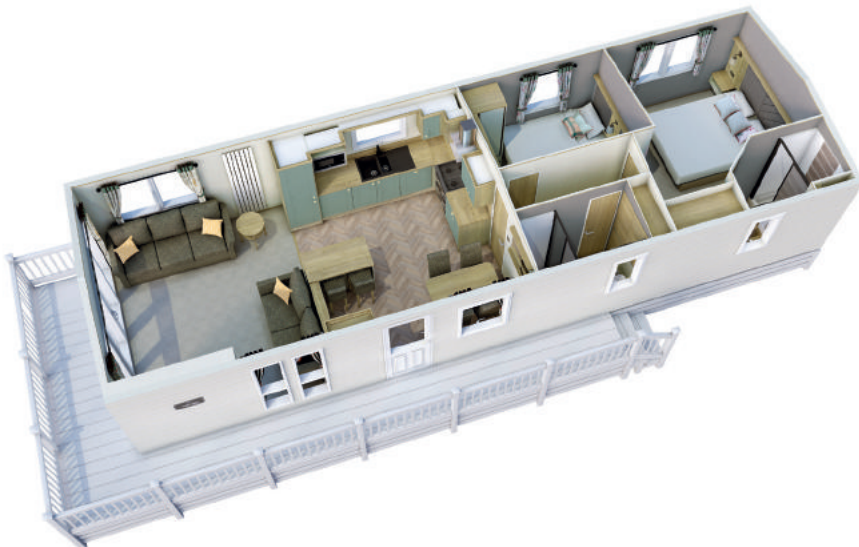



Highlights

- Updated colour scheme for 2023
- Stylish holiday home in 12ft and 13ft models
- Open-plan family home with breakfast bar
- Option to upgrade to BS3632 residential specification



To take an interactive virtual tour
visit www.abiuk.co.uk



Shows optional sliding doors







The Ingleton

If you love the look and feel of this holiday home, there's only one thing you need to decide now – which of our four fantastic layouts will you choose?



FACTORY
Approved

All this included

- ✓ Matt finish Champagne aluminium cladding
- ✓ Pre-galvanised twin axle chassis
- ✓ White 'Low E' PVCu Thermaglass double glazing
- ✓ Fully condensing boiler gas central heating
- ✓ Satellite co-ax
- ✓ Soft-close drawers throughout
- ✓ Entrance seat and coat storage area
- ✓ Voiles throughout
- ✓ Externally vented powered cooker hood
- ✓ 40mm worktops
- ✓ Composite kitchen sink
- ✓ Free-standing dining table and 4 chairs (2 bedroom model) & 6 chairs (3 bedroom model)
- ✓ Breakfast bar
- ✓ Integrated fridge freezer
- ✓ USB socket in lounge
- ✓ Additional sockets next to TV point in lounge
- ✓ Scatter cushions in lounge
- ✓ King size bed in master bedroom (2 bedroom models only)
- ✓ Lift-up bed in master bedroom

- ✓ TV point in all bedrooms
- ✓ USB sockets in all bedrooms
- ✓ Feature wallboards on bed walls in all bedrooms
- ✓ En suite toilet
- ✓ Bathroom extractor fans
- ✓ Shaver socket
- ✓ Coat hooks in all bathrooms
- ✓ En suite shower (2 bedroom model only)

Add any of these

- ☐ Fully galvanised chassis
- ☐ Upgrade to 13ft wide with BS3632 residential specification
- ☐ CanExel™ exterior cladding
- ☐ Deluxe Bluetooth sound system
- ☐ Front sliding doors
- ☐ Integrated microwave
- ☐ Integrated washing machine
- ☐ Integrated dishwasher
- ☐ 'Exclusive' pocket sprung mattresses
- ☐ Space saver bed for twin room



For further information and to take an interactive virtual tour of The Ingleton visit www.abiuk.co.uk

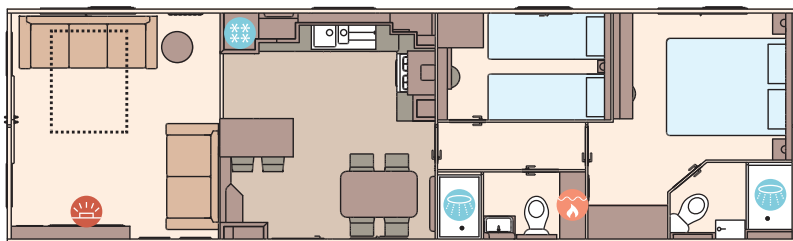

The Ingleton 40ft x 12ft x 2 bedroom

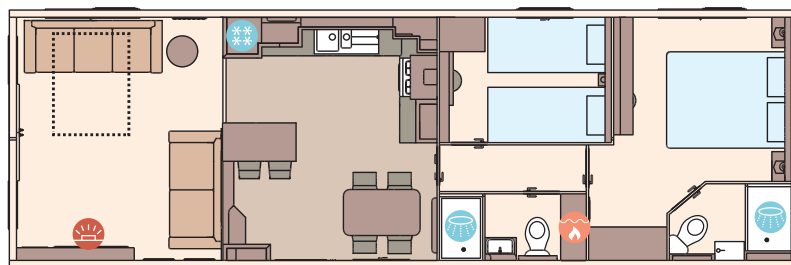

The Ingleton 40ft x 13ft x 2 bedroom

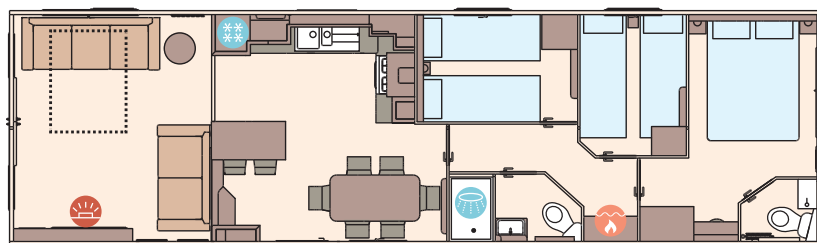

The Ingleton 41ft x 12ft x 3 bedroom

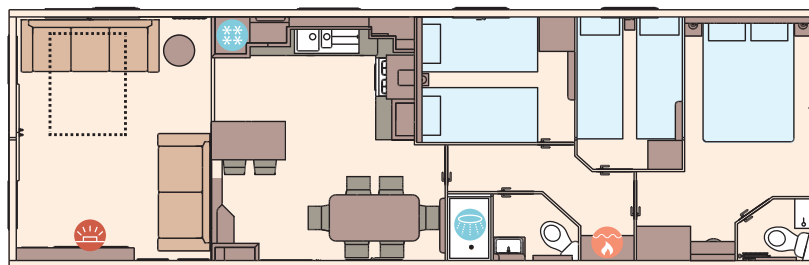

The Ingleton 41ft x 13ft x 3 bedroom

KEY: Fire Water heater Shower Fridge/Freezer Front pull out bed

OPTIONAL
Residential
specification
BS3632
See Page 83