



# Violett M

User Manual

Visit Us

---

[violettuv.com](http://violettuv.com)

Customer Support

---

[support@violett.com](mailto:support@violett.com)

# Welcome

Thank you for purchasing a Violet unit. We are excited to help you provide clean, safe air to those you care about most.

We strive to make sure every customer has a seamless setup and usage experience so we've prepared this guide to familiarize you with your new system.

## Getting to know your Violet

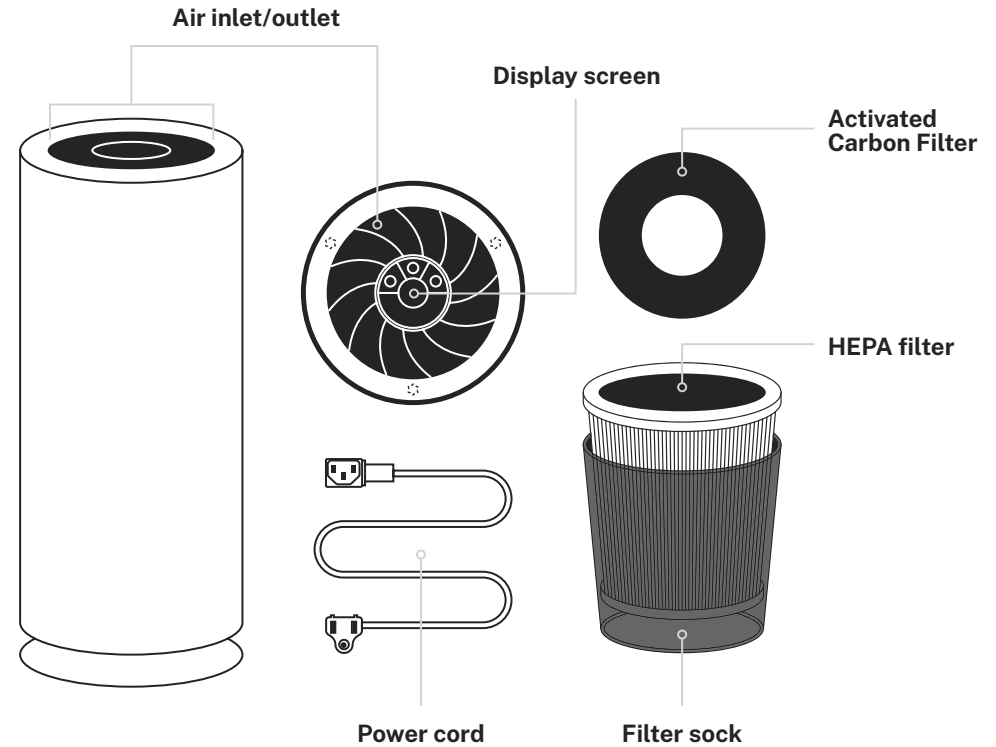

### UNIT SPECIFICATIONS

**Size/Dimensions:** 37.75" Height x 10.5" Diameter

**Weight:** 36 lbs

**UVC light:** High intensity LEDs

**Room size coverage:** 800 sq ft in 30 minutes

**Length of power cord:** 3 ft

#### Filters:

Pleated H13 HEPA filter

Activated carbon pre-filter (VOC removal)

Nanotechnology odor removing filter

**On 'high' fan speed:**

**Cubic feet/minute:** 225 CFM

**Noise level:** 65 dB

**Power consumption:** 150 W

## Top Panel Layout

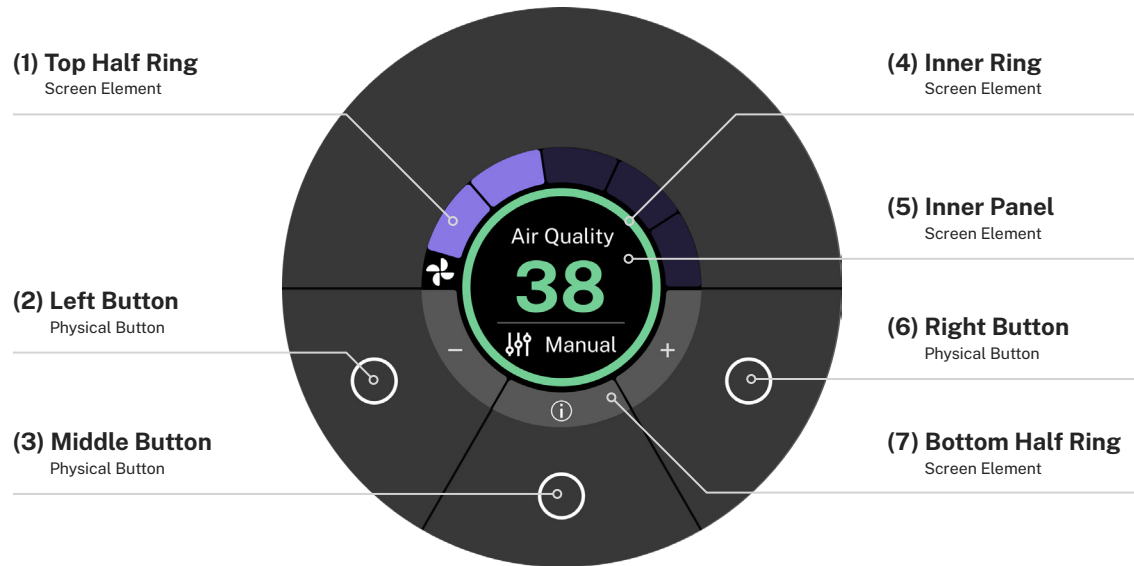

## Color Indicator

The usage of color is consistent throughout the experience.



Green represents good air quality.



Orange represents moderate air quality.



Red represents unhealthy air quality.

## How to operate Violet

There are two ways of interacting with the buttons, tap and hold.



Tap



Hold

## SCREEN ELEMENTS

### (1) Top Half Ring

This area will always indicate fan speed.

### (4) Inner Ring

This area will always indicate current air quality. Please refer to color indicator chapter for further information.

### (7) Bottom Half Ring

This area shows the functions of the 3 physical buttons, as the function of the button will change based on context.

### (5) Inner Panel

This area shows the functions of the 3 physical buttons, as the function of the button will change based on context.

## PHYSICAL BUTTONS

### (2) Left Button

The physical button on the left.

### (3) Middle Button

The physical button in the middle.

### (6) Right Button

The physical button on the right.

## Adjust Fan Speed

Violett's fan can be adjusted to suit your needs, maximum speed quickly cleans a room while minimum speed emits pleasant white noise.

1. When you first power on the Violett unit, the fan speed will automatically be set to Level 3, which is the default fan speed.
2. To change the fan speed, use the plus and minus buttons on the left and right of the display.
3. Current fan speed is indicated by a purple bar at the top of the display.



Tap right button to increase fan speed

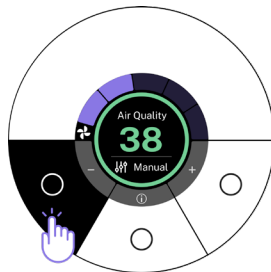

Tap left button to increase fan speed

## Lock & Unlock

Your Violett device comes with a locking feature that prevents users from changing the fan speed or entering/exiting Auto mode accidentally.

Simultaneously press and hold the left and right buttons on your unit for **5 seconds** to lock and unlock your unit.



Hold left and right button to lock the device

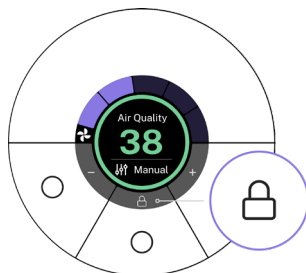

Lock Device Screen

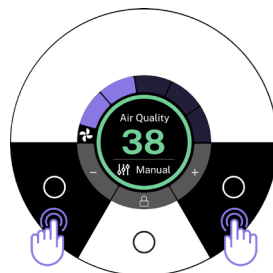

Hold left and right button to unlock the device

## Notifications

You'll get notified when your filter needs to be changed, when you go to operate the device but the screen is locked, or when you're adjusting fan speed while in auto mode.

Some notifications will go away in seconds but some will stay until you dismiss them. To dismiss notifications, tap the middle button.

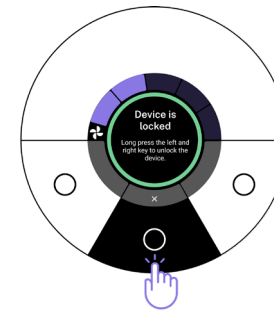
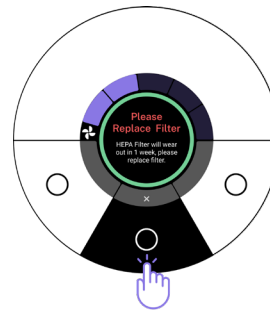

Tap the middle key to quickly dismiss any notification

## Auto Mode

Your Violett unit has an integrated air quality sensor that automatically adjusts the fan speed to respond to changes in particulate matter (PM) levels, reducing potential airborne risks. Follow the steps below to enable auto mode:

1. To enter auto mode long press the left button.
2. To exit auto mode and return to manual mode long press the left button.

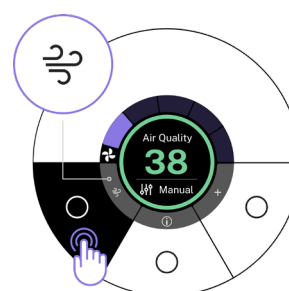

Long press the left button to activate auto mode

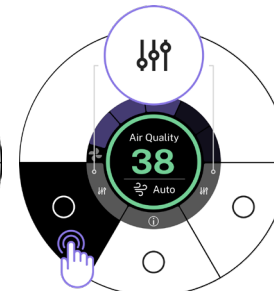

Long press the left button to exit auto mode

## ■ Set up your device

The integrated sensors in your Violet unit ambly gather data about the environment including airborne particulate count, temperature, and humidity. By connecting your unit to Wi-Fi and adding it to your Violet Dashboard you can analyze trends in data gathered from your space and remotely control your device.

### SET UP YOUR DASHBOARD

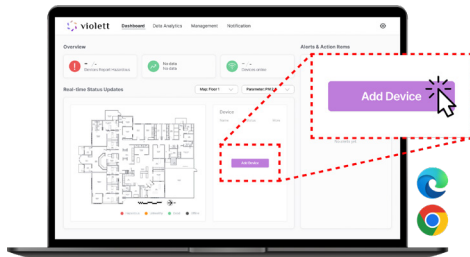

Step 1:

#### Click “Add Device” button in Violet Dashboard

- Using Microsoft Edge or Chrome navigate to **dashboard.violett.com**.
- Create a new user account or log in to your existing account.
- For first time users, click the “Add device” button in the dashboard homepage.
- Add additional devices via the management page.

### SET UP YOUR DEVICE

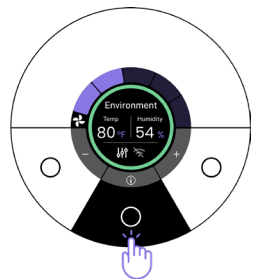

Step 3:

#### Use the middle button to enter Wi-Fi pairing screen

Tap the middle info button on the device to cycle through unit status displays until you see the Wi-Fi status screen.

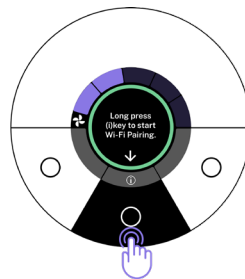

Step 4:

#### Start Wi-Fi Pairing from your Violet Unit (1/2)

Once the Wi-Fi screen is displayed hold the center button for 5 seconds to place the device into pairing mode.

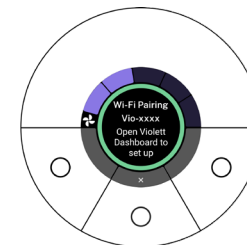

Step 5:

#### Start Wi-Fi Pairing from your Violet Unit (2/2)

When the above screen is shown, you can move to your PC for next step.

**Please move within 10 feet of your device before following the setup steps below.**

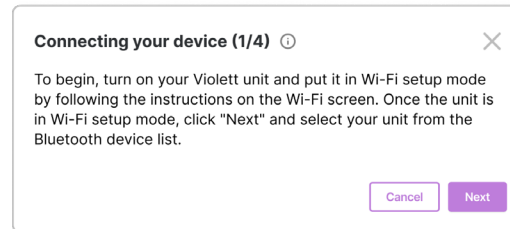

Step 2:

#### Follow the set up wizard

The setup wizard will prompt you to put your device into Wi-Fi pairing mode.

## CONTINUE THE SET UP DEVICE ON YOUR DASHBOARD

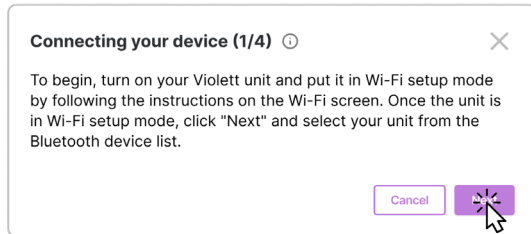

Step 5:

### Start Wi-Fi Pairing from your PC

Once the device is set up, click “next” on the online wizard.

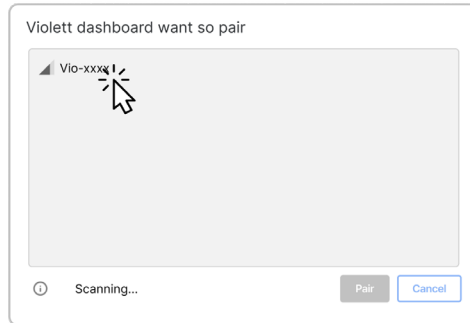

Step 6:

### Select your Violet unit to pair

Your computer’s Bluetooth will scan for nearby devices to connect to. Once your device appears in the pairing window select it and push pair.

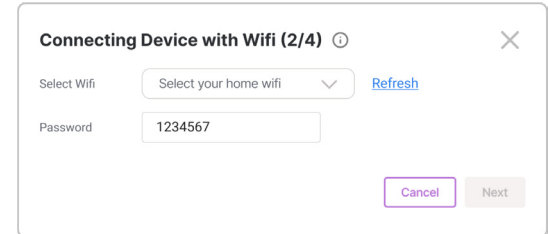

Step 7:

### Input your Wi-Fi information

- You will be prompted to select your Wi-Fi network and enter its password.
- Select “OK” to continue. The device is now paired to the Wi-Fi network and claimed in your Violet Dashboard.

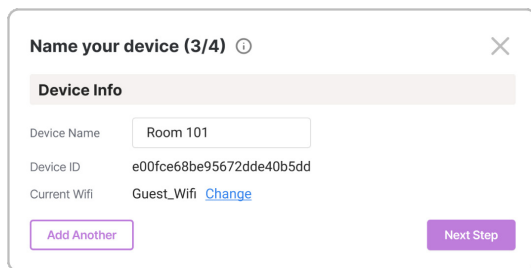

Step 8:

### Name your device

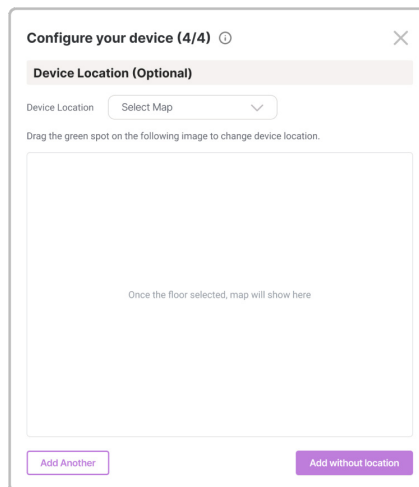

Step 9:

### Set up a location for your device (optional)

You can name the device, assign it to a physical location on an uploaded map, or save it without a location.

## Delete your device

Before connecting your Violet device with a new account, you need to fully delete your device from the current account. To do that, you need to both delete your device from the management page, and disconnect the device's Wi-Fi.

After delete your device from the current account, you can connect it with a new account by following the "Set up your device" instructions.

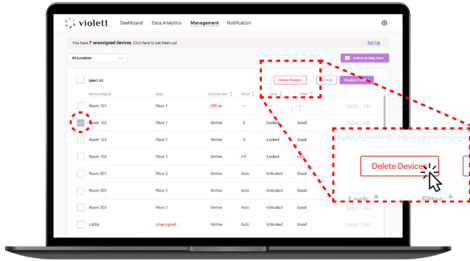

Step 1:

**Delete device from your account from the device management page of the Violet dashboard**

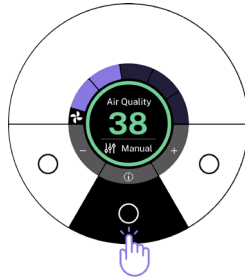

Step 2:

**Disconnect Wi-Fi on your Violet Device(1/2)**

Tap the middle info button on the device to cycle through unit status displays until you see the Wi-Fi status screen.

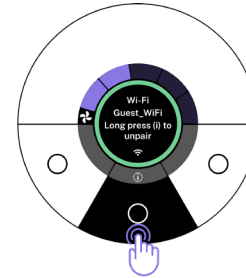

Step 3:

**Disconnect Wi-Fi on your Violet Device(2/2)**

Once the Wi-Fi screen is displayed, hold the center button for 5 seconds to disconnect your device with Wi-Fi.

## Change Device Wi-Fi

If you want to connect your device to a new Wi-Fi network, disconnect the device from its current Wi-Fi network and then connect the device to the new Wi-Fi network via the Violet Dashboard.

### DISCONNECT THE DEVICE'S WI-FI

---

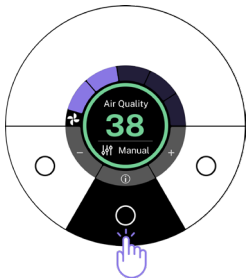

Step 1:

**Unpair Wi-Fi on your Violet Device (1/2)**

Tap the middle info button on the device to cycle through unit status displays until you see the Wi-Fi status screen.

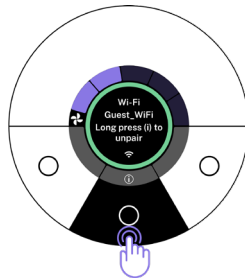

Step 2:

**Unpair Wi-Fi on your Violet Device (2/2)**

Once the Wi-Fi screen is displayed, hold the center button for 5 seconds to unpair your device.

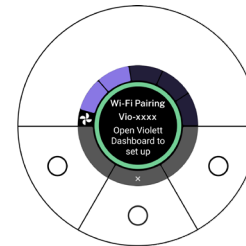

Step 3:

**Start Wi-Fi Pairing to new Wi-Fi**

When the above screen is shown, you can move to your Violet Dashboard for the next step.

## CONNECT THE DEVICE TO THE NEW WI-FI VIA VIOLETT DASHBOARD

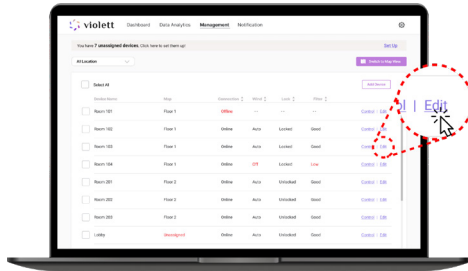

### Step 4: Locate your device on the Management Page

Locate your device on the management page list and click “edit” on the right.

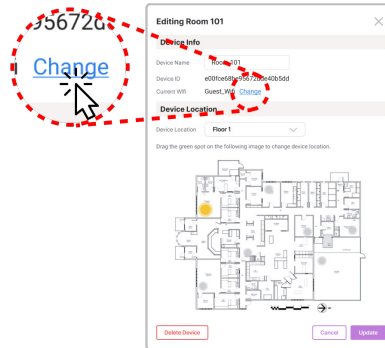

### Step 5: Start pairing new Wi-Fi (1/2)

In the “edit device” pop up, locate “current Wi-Fi” and click “change” on the right.

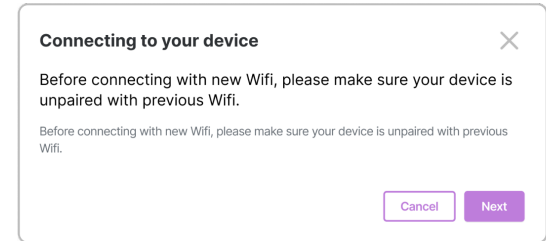

### Step 6: Start pairing new Wi-Fi (2/2)

Click “next” to start pairing your device.

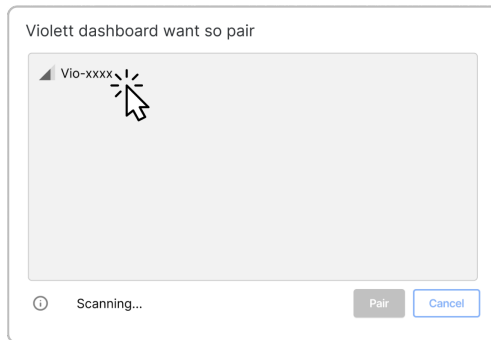

### Step 7: Select your Violet unit to pair

Your computer’s Bluetooth will scan for nearby devices to connect to. Once your device appears in the pairing window select it and click “pair”.

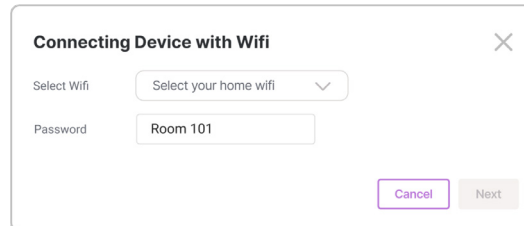

### Step 8: Input your new Wi-Fi information

When prompted, select your Wi-Fi network and enter the corresponding password. Select “OK” to continue. The device is now paired to your Wi-Fi network and visible in your Violet Dashboard.



## Maintaining your Violet

### CHANGING THE ACTIVATED CARBON FILTER

1. Ensure the Violet unit is unplugged.
2. Grasp the top grate and firmly pull straight up, away from the unit housing (Fig.1).
3. Remove the activated carbon filter and discard.
4. Lightly place the activated carbon filter on top of the HEPA filter (Fig.2). If the HEPA filter pleats are visible remove the activated carbon filter and reset its position.
5. Replace the top grate, pushing firmly to ensure a tight fit (Fig.3).  
**\*Note:** There is a safety switch that will not allow the unit to power up if the top grate is removed. Ensure the component is fully seated into its original position.

### CHANGING THE LED ARRAY

1. Ensure the Violet unit is unplugged.
2. Grasp the top grate and firmly pull straight up, away from the unit housing (Fig.1).
3. Remove the activated carbon filter and set aside.
4. Lift the HEPA filter straight up out of the body of the unit and set aside (Fig.4).
5. Grasp the black cup that contains the display screen and slightly rotate clockwise to release it. Allow the cup containing the display to hang freely.
6. Lift the metal LED array complex straight up and off the locking pins.
7. Disconnect the jacketed wire assembly from the LED array complex by depressing the locking pin on the black connector.
8. Place the expired LED array complex aside.
9. Attach a new LED array complex using the black connector to the jacketed wire assembly.
10. Flip the LED array complex onto the locking pins.
11. Replace the cup containing the display screen making sure to align all three pins. Rotate counterclockwise to lock in place.
12. Replace the HEPA filter.
13. Lightly place the activated carbon filter on top of the HEPA filter (Fig.2). If the HEPA filter pleats are visible, remove the activated carbon filter and reset its position so the pleats are no longer visible.
14. Replace the top grate, pushing firmly to ensure a tight fit (Fig.3).  
**\*Note:** There is a safety switch that will not allow the unit to power up if the top grate is removed. Ensure the component is fully seated into its original position.

### CHANGING THE HEPA FILTER AND OPTIONAL POST FILTER

1. Ensure the Violet unit is unplugged.
2. Grasp the top grate and firmly pull straight up, away from the unit housing (Fig.1).
3. Remove the activated carbon filter and set aside.
4. Lift the HEPA filter straight up out of the body of the unit (Fig.4). You may need to shift the filter from side to side to not dislodge the black jacketed wire assembly during removal.
  - a. If only replacing the post filter slip the sock off the HEPA filter and discard. Slip the new post filter over the HEPA filter and replace in the same orientation in the unit.
  - b. If replacing post filter and HEPA filter, discard the entire assembly. Slip post filter over new the HEPA filter and reseal in the same orientation.
5. Lightly place the activated carbon filter on top of the HEPA filter (Fig.2). If the HEPA filter pleats are visible remove the activated carbon filter and reset its position so the pleats are no longer visible. Replace the top grate, pushing firmly to ensure a tight fit (Fig.3).  
**\*Note:** the HEPA filter assembly depresses a safety switch on the bottom of the unit. Please make sure the HEPA filter is properly installed or the unit will not turn on.



Figure 1.



Figure 2.



Figure 3.



Figure 4.

## ■ Warning & Safety

- Violet M should be powered with a grounded 120 volt domestic power outlet.
- Violet M should be turned off and unplugged before it is picked up or moved.
- Violet M will not power on without a HEPA filter installed.
- Violet M will not power on without the top grate in place.
- Remove power from unit before servicing.
- To protect against fire, electric shock and personal injury do not immerse cord, plugs, or appliance in water or other liquids.
- Do not operate any appliance with a damaged cord or plug.
- Skin or eye damage may result from directly viewing the light produced by the LED emitters in this device. Always disconnect from power before servicing.



## Contact Us

---

If you have any questions about your Violet M unit contact us at:

**[support@violett.com](mailto:support@violett.com)**

For more information about Violet visit our website at:

**[violettuv.com](http://violettuv.com)**

