

HMW

30.0 PHT

EN 14492-1

- New 30,000kg high efficiency 2 stage planetary winch
- Internal 100% holding, fail-safe braking system-spring applied hydraulic release
- compact envelope, saving weight and installation space
- Heat treated reinforced cast steel body
- Large capacity drum with cable tensioner as standard
- reinforced mounting rails for ease of installation.
- Pneumatic actuator for easy clutch operation.
- EN14492-1 Power driven winches and CE machinery directive 2006/42/EC

Applications

Towing & Recovery
Specialty Vehicle
Mining & Construction
Machinery and House Movers
Power Companies and Tree Arborists
General Industrial and Commercial

Rope Winding Layer	Pulling Capacity kg/lbs	Rope Speed m/min – ft/min	Rope Length m / ft
1	30000 kg/66120 lbs	3.5/11	12/42
2	25955kg /57206 lbs	4/13	26/87
EN 3	22781 kg/50409 lbs	4.5/15	43/142
4	20442 kg/45056 lbs	5/17	61/200
5	18480 kg/40731 lbs	5.8/19	81/268

Warning !

- A-B lines must be open to tank with the control valve in centre position.
- This winch is designed and manufactured for pulling, don't lift person or material.
- Always keep last 5 wraps of cable on the drum.
- The technical details given above are just for information.
- HAMMER WINCH reserves the right to change the technical details.
- Pneumatic working pressure: Min 9 bar – Max 12 bar (Min 30psi – Max174 psi)

Specifications

Max.pulling capacity (kg / lbs) : 30,000kg (66120lbs)
Max.rope length (m) : 81m
Recommended wire rope (mm) : 26 mm (1") 2160 Mpa Compact
Hydraulic motor (cc / in³) : 160 cc
Max. pump flow (L/min) : 75 L/min
Gear ration : 114:1
Oil type and capacity : 85W 140 – 2,75 L
Max. working pressure (bar / psi) : 210 bar (3045 psi)

Equipment

Cable tensioner
Air Clutch

DIMENSIONS

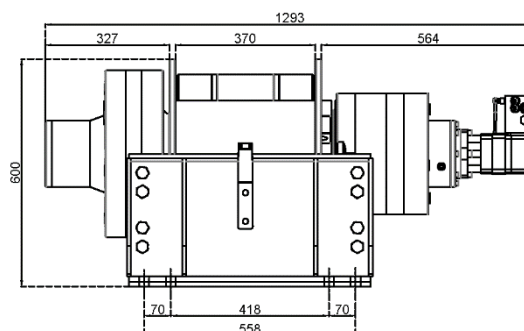
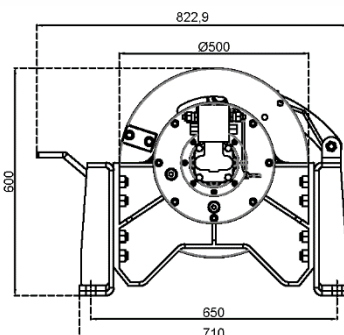

Physical

Winch : 592kg
Cable Tensioner : 9kg
Mounting Bolts : 8 x M24 8.8
Hydraulic Inlets : G 3/4"