

GTD-2800

2800 LB Heavy-Duty Hoist



PN 753022 12V
PN 753033 24V

Features Include

- Designed, built and rated as a heavy duty lifting winch.
- High efficient low amp. draw and sealed permanent magnet motor.
- Compact design is ideal for small crane and davit applications.
- Mechanical spring applied and dynamic motor brake provide for precise load control.
- Waterproof industrial remote control with 5 m lead.
- Full metal 3-stage planetary gear train: quiet, smooth and efficient.
- Submersible sealed contactor handles high amps and allows higher duty cycle.
- In compliance with standard of ANSI B30.5 for $D/d \geq 18$ and rope safety factor ≥ 3.5

Specifications

• Rated load:	2800 lb
• Line speed (1st layer):	12 v 4.6 mpm 25 A. @ no load 3.0 mpm 120 A. @ full load 24 v 6.0 mpm 22 A. @ no load 4.4 mpm 100 A. @ full load
• Motor:	12 v 2 830 w / 3.8 hp permanent magnet 24 v 1 940 w / 2.6 hp permanent magnet
• Gear ratio:	3-stage planetary 261:1
• Brake (outside the drum):	Mechanical cone brake and dynamic motor
• Winch construction:	Aluminum die-cast housings and steel drum
• Drum size:	135 x 114.6 mm
• Control:	Remote control with 5 m lead
• Recommended Wire Rope:	Galvanized aircraft A7 x 19
• Size:	7.9 mm x 28 m A7 x 19
• Mounting bolts pattern:	114.3 x 171 mm; 165.1 x 171 mm
• Standard Compliance:	CE Machinery Directive 2006/42/EC CE EMC Directive 2004/108/EC ANSI B30.5

Line Pull and Rope Capacity

ROPE LAYER	PULL BY LAYER (KG / LB)	TOTAL ROPE ON DRUM (M)
1	1 270 / 2 800	6.3
2	1 144 / 2 522	13.3
3	1 040 / 2 292	21.0
4	954 / 2 103	28.0

LINE SPEED & AMP DRAW (1st Layer of Wire Rope on the Drum)						
LINE PULL	LINE SPEED (MPM)		AMP DRAW		% DUTY CYCLE	
	KG / LB	12V	24V	12V	24V	MIN / 10 MIN
NO LOAD		4.6	6.0	25	22	cont. cont.
227 / 500		4.2	5.7	40	30	9.0 7.0
454 / 1 000		3.9	5.5	65	45	7.0 4.5
680 / 1 500		3.6	5.3	85	60	5.0 3.0
907 / 2 000		3.3	4.6	100	80	3.5 2.5
1 270 / 2 800		3.0	4.4	140	100	2.5 2.0

Dimensions mm/inch

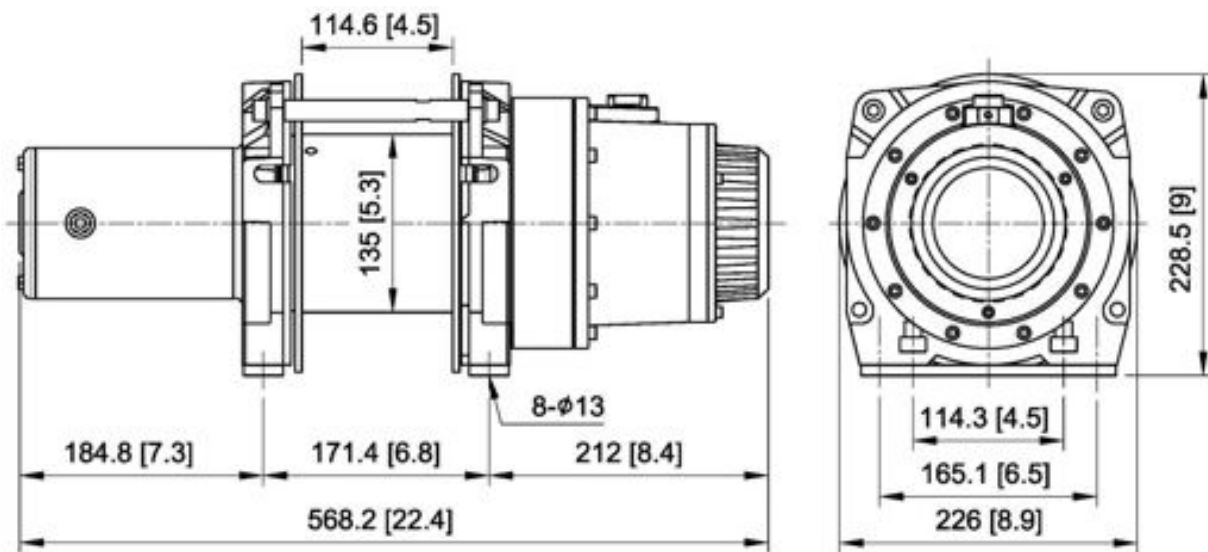

Packaging

- Hoist Weight (includes rope and hook): 48.1 kg
- Gross Weight: 54.8 kg
- Box Dimensions: 620 x 360 x 260 mm

Accessories

- Wire rope 7.9 mm x 28 m w/safety hook
- Remote control 5m cord
- Control

WARNING!

- Do not use hoist to transport, lift or otherwise move personnel.
- The rated line pull shown is based on the first layer of rope on the drum.
- The wire rope must remain on the drum at all times with at least 5 wraps.

Warranty

Each new hoist is guaranteed against defects in workmanship and material defects for a period of 12 months from date of purchase. Rope is not included under warranty.