

GTD-2200

2200 LB Heavy-Duty Hoist



PN 752103 12V
PN 752104 24V

Features Include

- Designed, built and rated as a heavy duty small lifting winch.
- High efficient low amp. draw and sealed permanent magnet motor.
- Lightweight and compact design is ideal for small crane and davit applications.
- Mechanical spring applied and dynamic motor brake provide for precise load control.
- Waterproof industrial remote control with 5 m lead.
- Full metal 3 stage planetary gear train, quiet, smooth and efficient.
- Submersible sealed contactor handles high amps and allows higher duty cycle.
- In compliance with standard of ANSI B30.5 for $D/d \geq 18$ and rope safety factor ≥ 3.5

Specifications

- Rated load: 2200 lb
- 2000 lb ANSI B30.5 Rating
- Line speed (1st layer):
 - 12 V 4.5 mpm 25 A. @ no load
 - 3.5 mpm 120 A. @ full load
 - 24 V 5.8 mpm 18 A. @ no load
 - 5.0 mpm 90 A. @ full load
- Motor:
 - 12 V 2 830 w / 3.8 hp permanent magnet
 - 24 V 1 940 w / 2.6 hp permanent magnet
- Gear ratio: 3-stage planetary 211:1
- Brake (outside the drum): Mechanical cone brake and dynamic motor
- Winch construction: Aluminum die-cast housings with steel drum.
- Drum size: 108 x 105 mm
- Control: Remote control with 5 m lead
- Recommended Wire Rope: Galvanized aircraft A7 x 19
- Size: 6.4 mm x 30 m A7 x 19
- Mounting bolts pattern: 114.3 x 152mm; 165.1 x 152mm
- Standard Compliance: CE Machinery Directive 2006/42/EC
CE EMC Directive 2004/108/EC
ANSI B30.5

Line Pull and Rope Capacity

ROPE LAYER	PULL BY LAYER (KG / LB)	LINE SPEED (MPM)		TOTAL ROPE ON DRUM (M)
		12V	24V	
1	998 / 2,200	3.5	5.0	5.6
2	898 / 1,980	3.8	5.5	11.8
3	816 / 1,799	4.2	6.1	18.7
4	747 / 1,647	4.6	6.6	26.2
5	689 / 1 519	5.0	7.2	30.0

LINE SPEED & AMP DRAW (1st Layer of Wire Rope on the Drum)									
LINE PULL	LINE SPEED (MPM)				AMP DRAW		% DUTY CYCLE		MIN / 10 MIN
	KG / LB	12V	24V	12V	24V	12V	24V	12V	
NO LOAD		4.5	5.8	14.8	19.0	25	18	cont.	cont.
181 / 400		4.2	5.7	13.8	18.7	40	25	cont.	8
362 / 800		4.0	5.6	13.1	18.4	60	35	8	6
544 / 1 200		3.8	5.5	12.5	18.0	75	55	6	4
771 / 1 700		3.6	5.3	11.8	17.4	90	70	4.5	3
998 / 2 200		3.5	5.0	11.5	16.4	120	90	3	2

Dimensions mm/inch

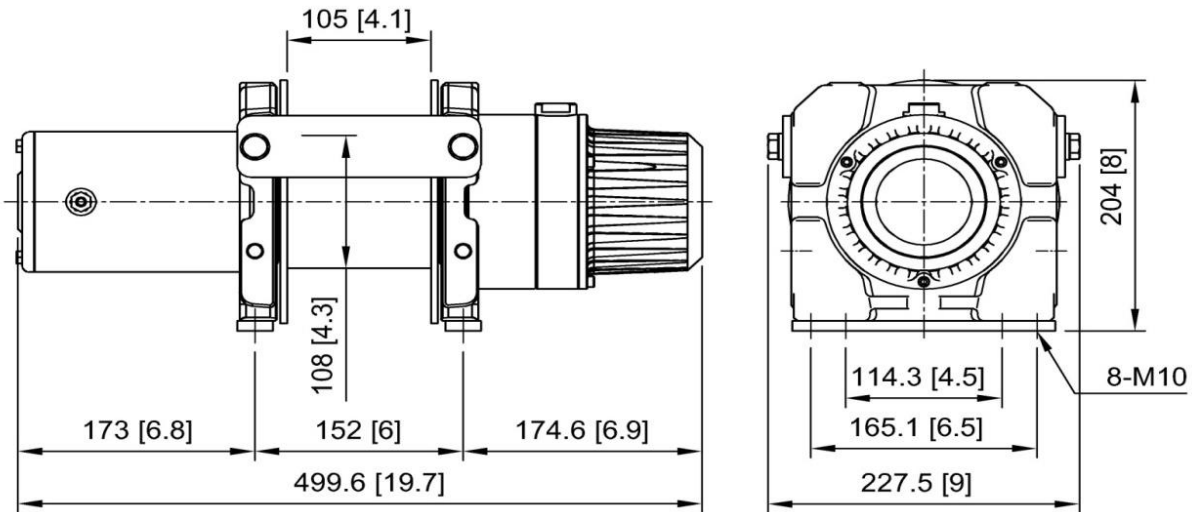

Packaging

- Hoist Weight (includes rope and hook): 33.9 kg
- Gross Weight: 39.5 kg
- Box Dimensions: 518 x 341 x 240 mm

Accessories

- Wire rope 6.4 mm x 30 m w/safety hook
- Remote control 5m cord
- Control

WARNING!

- **Do not use hoist to transport, lift or otherwise move personnel.**
- **The rated line pull shown is based on the first layer of rope on the drum.**
- **The wire rope must remain on the drum at all times with at least 5 wraps.**

Warranty

Each new hoist is guaranteed against defects in workmanship and material defects for a period of 12 months from date of purchase. Rope is not included under warranty.