

# E2 Pedestal

evnex

## Physical

Material	Aluminium
Height	1250mm
Finish	Matt black powdercoat

## Model Numbers

Single	10509
Dual (left & right access)	10510
Dual (front access)	10492

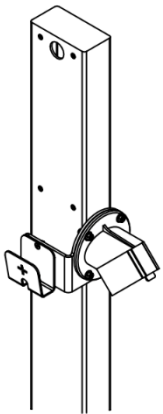

10509 - Single  
with type 2  
holster

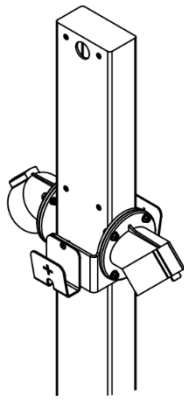

10510 - Dual with  
type 2 holsters (left  
& right access)

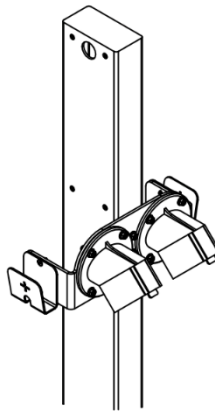

10492 - Dual with  
type 2 holsters  
(front access)

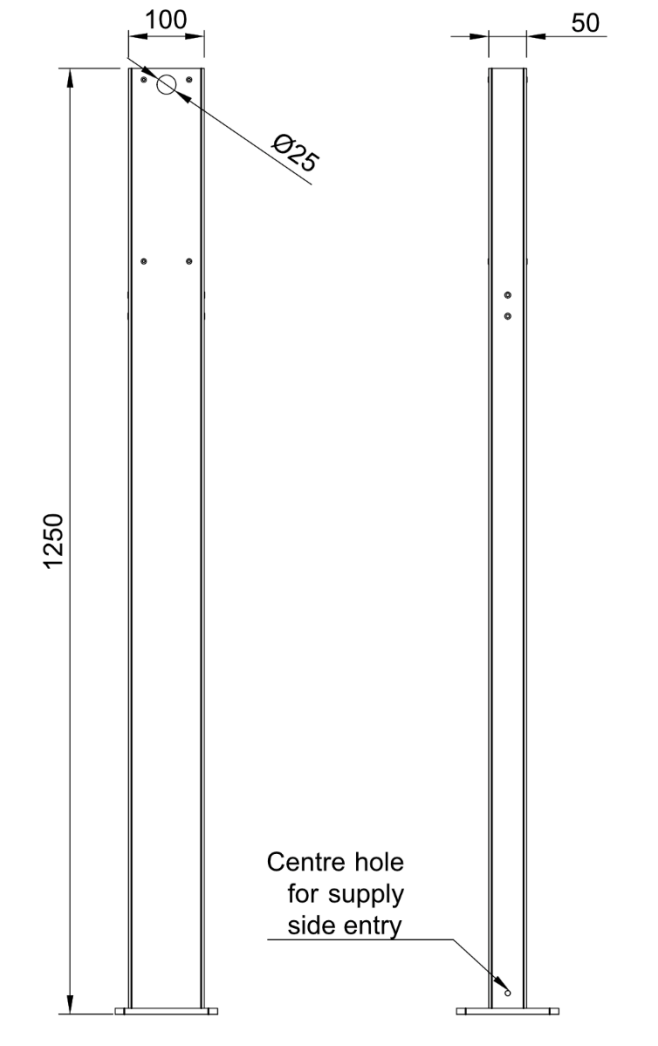

## Optional Extras

Ground Anchor Kit*	10426
--------------------	-------

## Notes

1. Evnex E2 chargers are shipped as standard with cable hooks which are attached to Single or Dual pedestal plug holder plates during installation
2. \*Ground Anchor Kit is a galvanised steel foot with fixing bolts which is designed to be concreted in before pedestal installation
3. Type 1 plug holsters are available on request

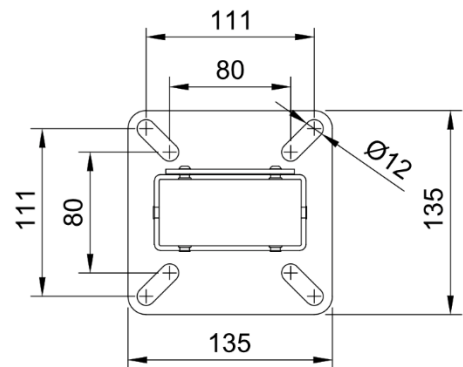

Minimum stud spacing: 80mm square  
Maximum stud spacing: 111mm square  
Recommended stud size: M10

