

# Preparing to Scale

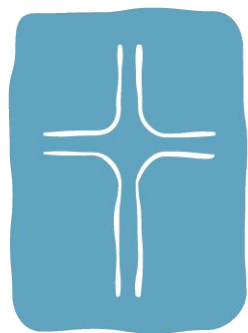

central  
commons

**Annual Report June 2023**

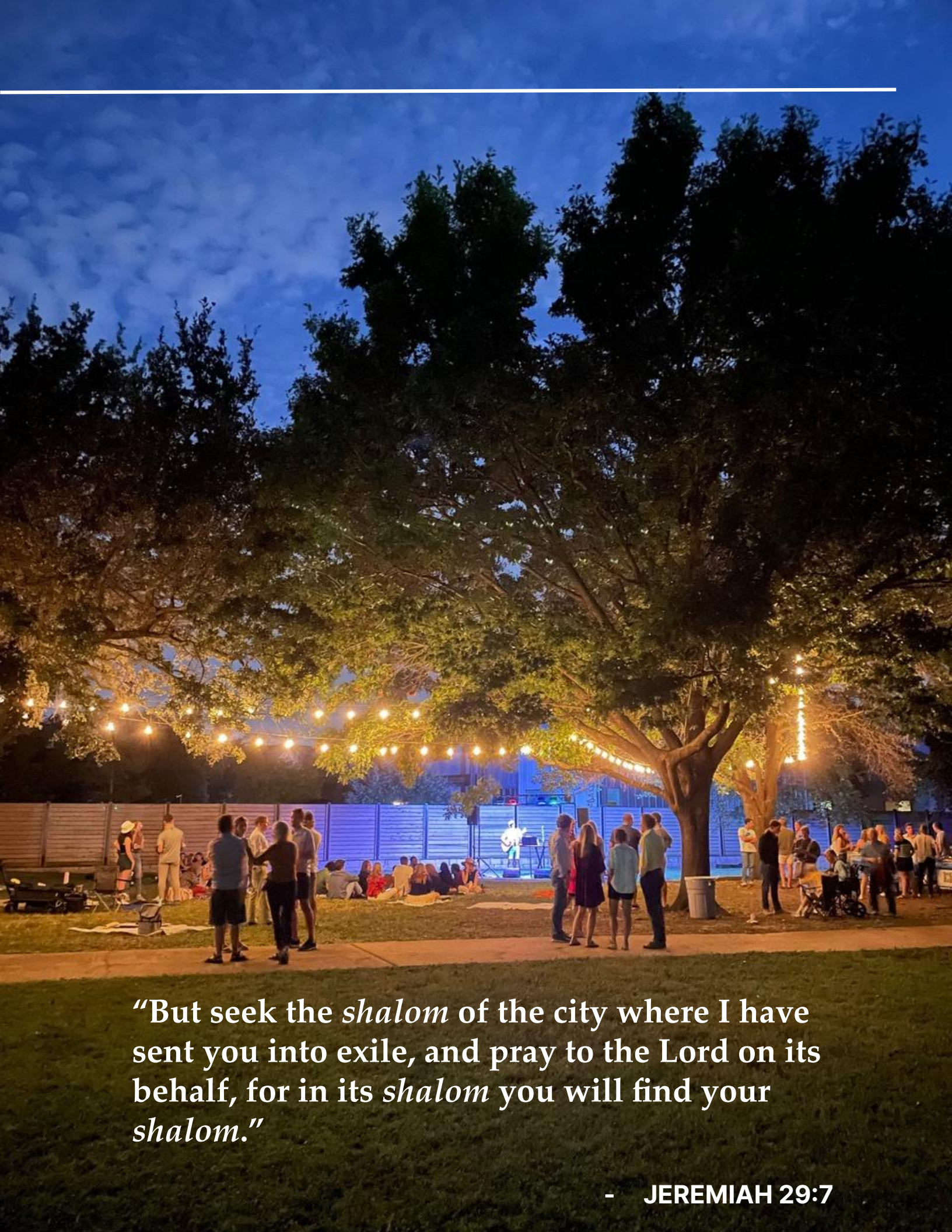

“But seek the *shalom* of the city where I have sent you into exile, and pray to the Lord on its behalf, for in its *shalom* you will find your *shalom*.”

- JEREMIAH 29:7



## MISSION & VISION

**Central Commons exists to revitalize a historic church building for the surrounding community.**

We also help make other church buildings financially sustainable and accessible to new churches while serving the local community.

# THE PROBLEM

We long for shalom, but we see alienation and fragmentation.

We believe the church is the primary means of bringing shalom to the world, but the church faces serious headwinds:

- 3,700 churches are closing annually in the United States
- 80% of American churches are in plateau or decline

Furthermore, church planting is near an all time low.

harmony  
wholeness  
tranquility  
peace  
Shalom  
completeness  
welfare  
prosperity

## Churches Started per 1 Million US Residents

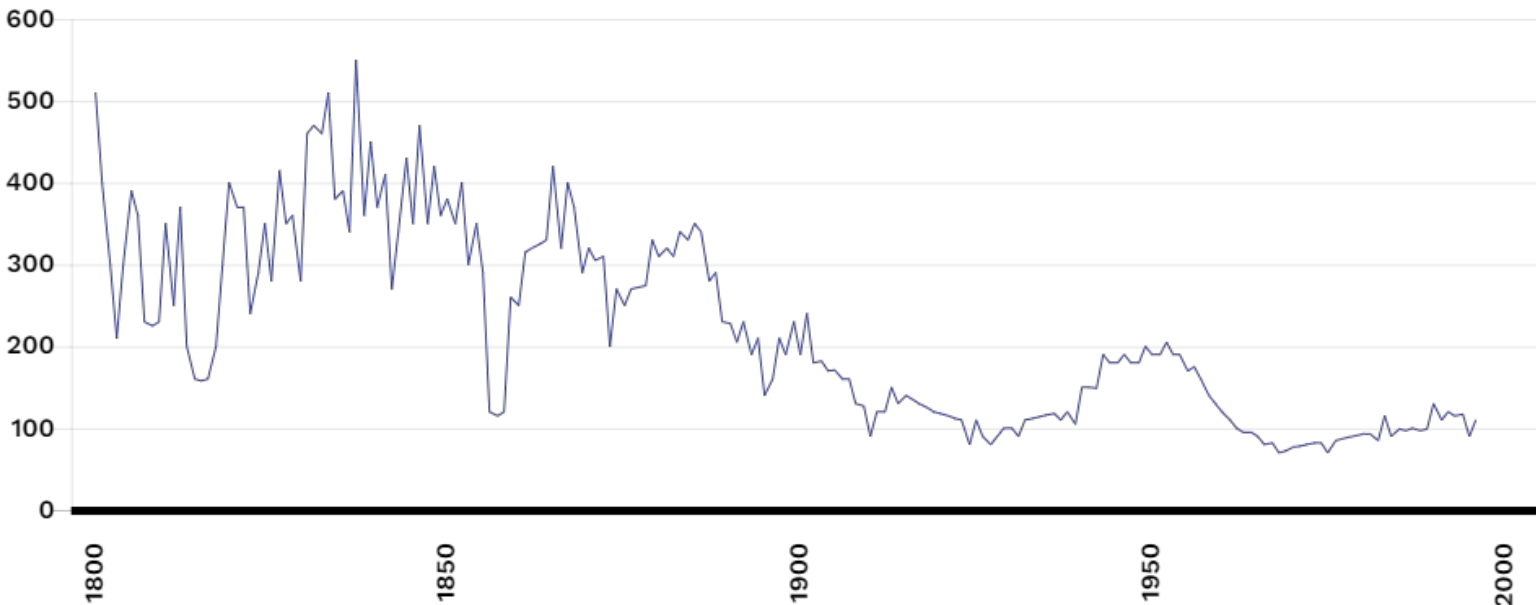



## OUR SOLUTION

The good news is that God's kingdom is advancing. New churches are starting all over the country, and we want to support them.

However, churches cannot find a place to meet, which complicates and distracts from mission.

**Therefore, we help make church buildings financially sustainable and accessible to new churches while serving the local community.**

This frees up resources and time for new churches to be on mission and serve their communities in new ways.



---

We measure our impact in three ways:

- Reach: Opportunities for the Gospel
- Results: Stories of Rescue
- Revenue: Sustainability through Programs

## REACH

Our team and the pastors on our campus have regular contact (daily - weekly) with 500 non-churchgoers who come to Central Commons for community or care (the dog park, a recovery group, or one of the preschools). This is accelerating as the coffee shop has just opened and is gathering followers. If we include events, elections, concerts, etc., the number doubles.

Our approach on this campus has attracted global attention as we meet with churches from Dallas to Denver and Washington, D.C. to Paris, France. It is time to prepare to scale our efforts.



## RESULTS

One 12-step attendee became a key volunteer before suffering a stroke. The community led by one of our staff has rallied to care for him and be his family, which has opened an opportunity to share the gospel with other members of that recovery group.

One employee comes from a recovery ministry that supports the formerly incarcerated. He is not only preaching the gospel but breaking racial and social barriers on campus.

One tenant, church attendee, and parent of a preschooler on campus recently took his own life. The whole campus has come together to care for the family. Believers and nonbelievers alike attended the memorial service in January.

This historic church building has become a gathering place where the surrounding community can come for friendship and care in the name of Jesus.

Over the past 24 months, we have sought to build a sustainable ministry model that is able to offer worship space to churches at well below the market rate while at the same time creating meaningful interactions with our neighbors. This past year have we more than doubled our program revenue.

## PROGRAM REVENUE

Program Revenue in 000's

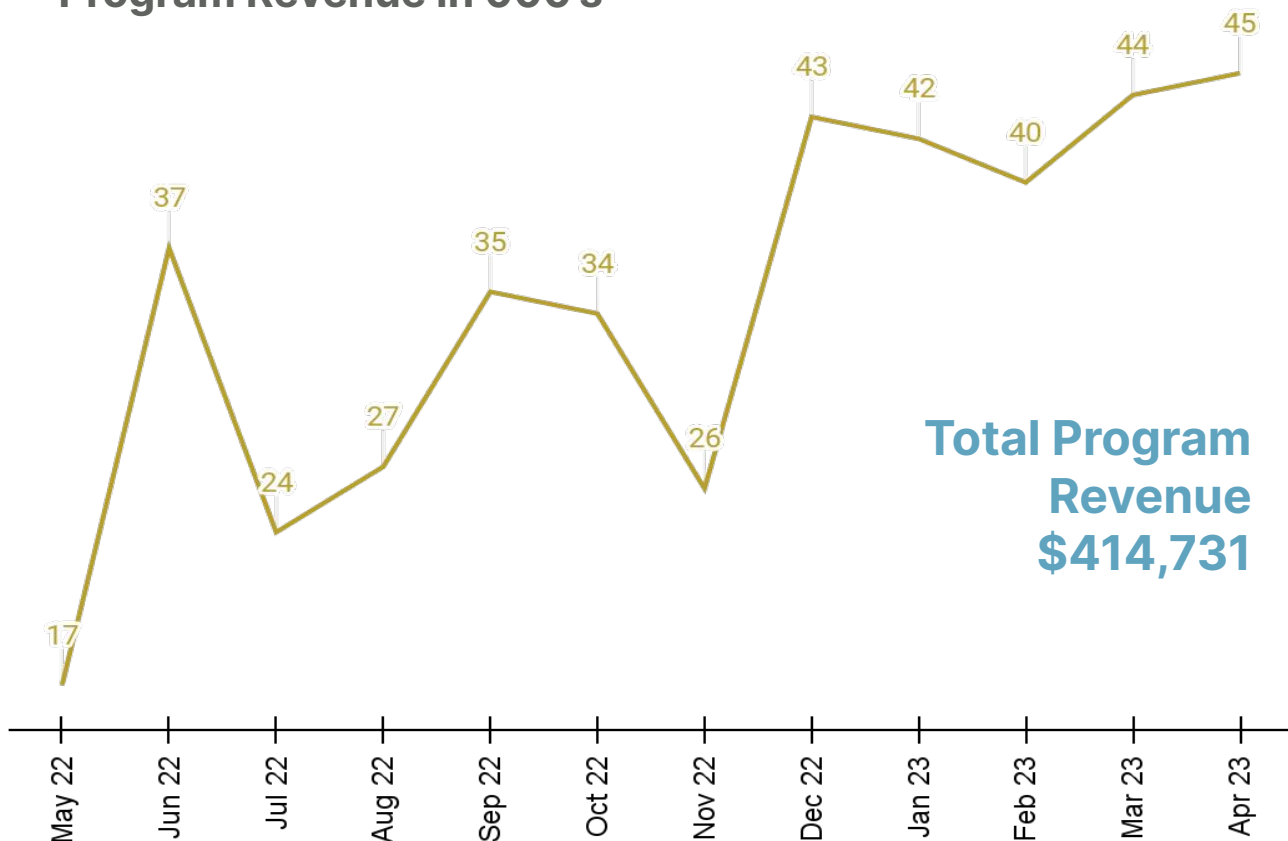





## OPERATING REVENUE

Over the past 12 months, we have continued to cover our operations with revenue from renting our space, hosting events, and other programs.

<b>Program Revenue</b>	<b>\$34,560</b>
------------------------	-----------------

(excluding grants & donations)

<b>Personnel Expense</b>	<b>-\$13,861</b>
--------------------------	------------------

<b>Operating Expense</b>	<b>-\$15,686</b>
--------------------------	------------------

---

<b>Monthly Operating Net</b>	<b>\$5,013</b>
------------------------------	----------------

<b>Building Repairs</b>	<b>-\$9,822</b>
-------------------------	-----------------

<b>Interest to Service Debt</b>	<b>-\$2,634</b>
---------------------------------	-----------------

---

<b>Net (prior to donations)</b>	<b>-\$7,443</b>
---------------------------------	-----------------

---

# PROGRAM USE

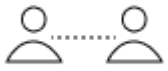

## **Entrepreneurs, Artists and Nonprofits**

18 rent space to work and create together



## **Dog Park & Coffee Shop**

Hundreds of neighbors visit the campus each week



## **Schools**

3 preschools rent the campus during the week



## **Recovery Groups**

Multiple 12-step groups rent the campus for various meetings and events



## **Community Events**

We host everything from elections and mahjong tournaments to weddings and concerts



## **Churches**

4 churches host worship services on campus



**SECOND STORY**

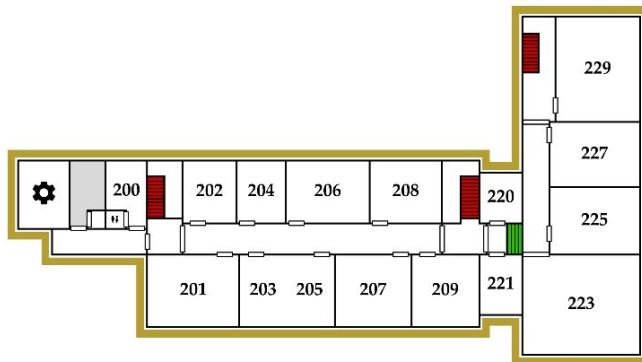

**GROUND FLOOR**

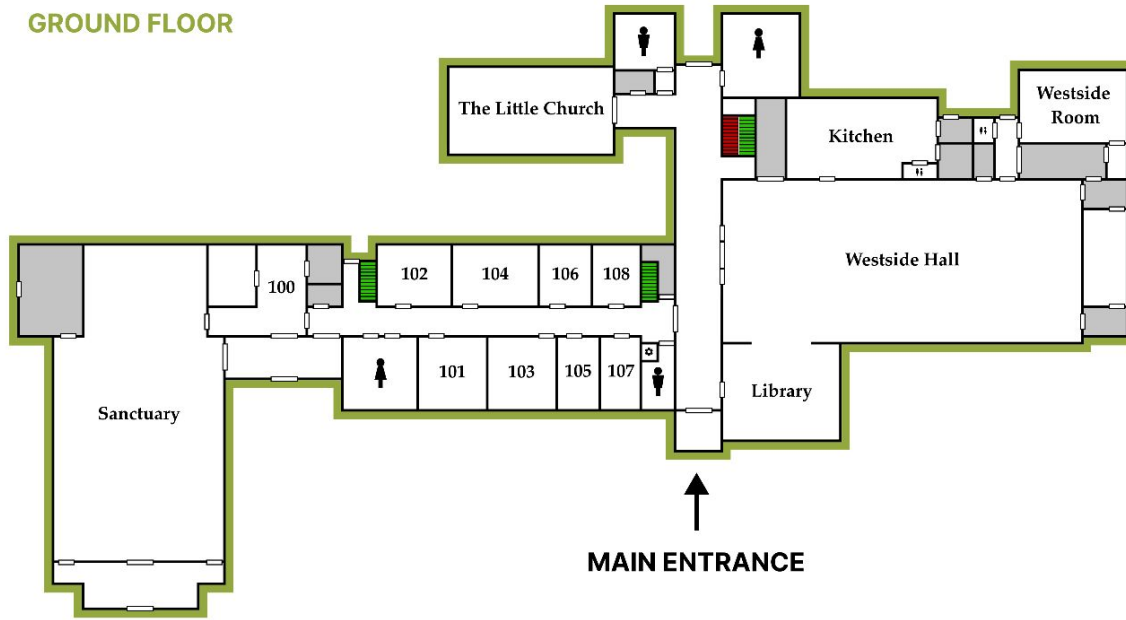

**BASEMENT**

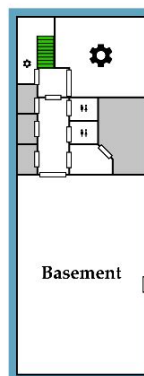

---

## OUR TEAM

**Blake Schwarz**

President

blake@centralcommons.org

**Jenna Tenpenny**

Campus Director

jenna@centralcommons.org

**Donat Murray**

Sexton

**Zach Winterrowd**

Director of Westside Coffee

**Jayne Hawley**

Bookkeeper & Campus  
Historian

## OUR BOARD

**Pete Flowers**

**Shannon Cagnina**

**Dennis Roossien**



## RESOURCES

### ***Better Together* by Jim Tomberlin**

Making Church Mergers Work

### ***Closing Costs* by Dominic Dutra**

Reimagining Church Real Estate for Missional Purposes

### ***The Coming Revolution in Church Economics* by Mark Deymaz**

Why Tithes and Offerings Are No Longer Enough, and What You Can Do about It

### **“The Great Opportunity” by Pinetops Foundation**

<https://www.greatopportunity.org/>

### **“Reimagining the Future of Church Real Estate” by Nick Bonner**

<https://www.faithdriveninvestor.org/blog/reimagining-the-future-of-church-real-estate>

# Thank you for supporting us!

As we look toward the future, we are preparing to scale what we started at Central Commons by supporting other churches who want to be more missional and more sustainable. Please consider continuing to support our efforts.

We are prayerfully seeking \$500,000 a year over the next 4 years to continue to clean up the campus, replace aging infrastructure, pay down some of the debt on the property, increase our program offerings, and prepare to replicate.

We must get our campus fully operational and fully functional first, so that we then can help other churches coming to us from all over the world.

We anticipate being able to bring you opportunities for other church campuses soon.

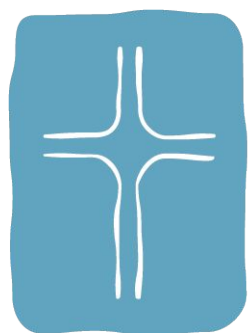

central  
commons

[www.centralcommons.org](http://www.centralcommons.org)