



OsecoElfab



- Installation (GB)
- Installation (F)
- Einbauleitung (D)
- Instalazione (I)
- Installatie (NL)
- Instalação (P)
- Instalación (E)
- Installation (S)
- Установка (RU)

### Pure-Gard™

Elfab Limited  
 Alder Road, North Shields, Tyne and Wear, NE29 8SD  
 UNITED KINGDOM  
 e-mail: [sales@osecoelfab.com](mailto:sales@osecoelfab.com), [www.osecoelfab.com](http://www.osecoelfab.com)  
 Tel: +44(0)191 293 1234

Elfab Singapore [Singaporesales@osecoelfab.com](mailto:Singaporesales@osecoelfab.com)  
 Elfab Germany [Vertrieb@osecoelfab.com](mailto:Vertrieb@osecoelfab.com)  
 Elfab India [Indiasales@osecoelfab.com](mailto:Indiasales@osecoelfab.com)

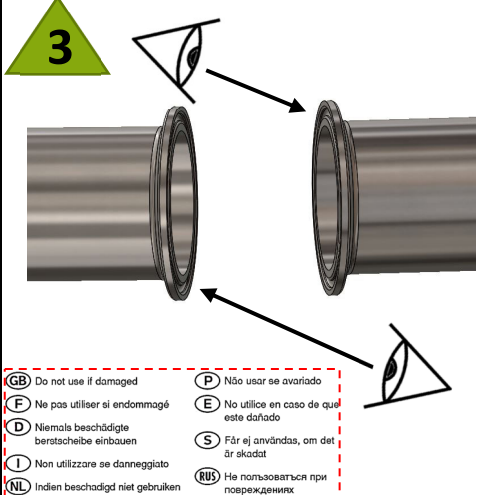
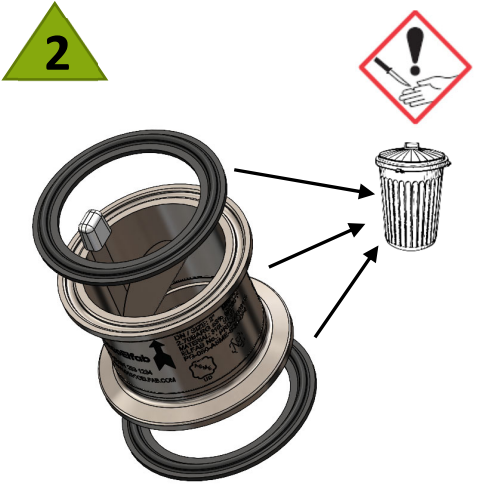
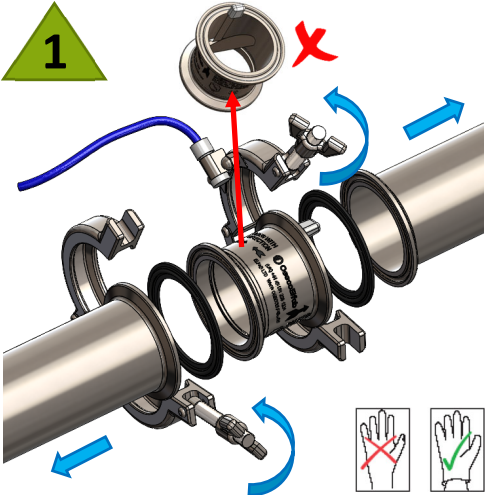

- |   |   |
|---|---|
| (GB) Do not use if damaged                    | (P) Não usar se avariado                  |
| (F) Ne pas utiliser si endommagé              | (E) No utilice en caso de que este dañado |
| (D) Niemals beschädigte berstscheibe einbauen | (S) Får ej användas, om det är skadat     |
| (I) Non utilizzare se danneggiato             | (RU) Не пользоваться при повреждениях     |
| (NL) Indien beschadigd niet gebruiken         |   |

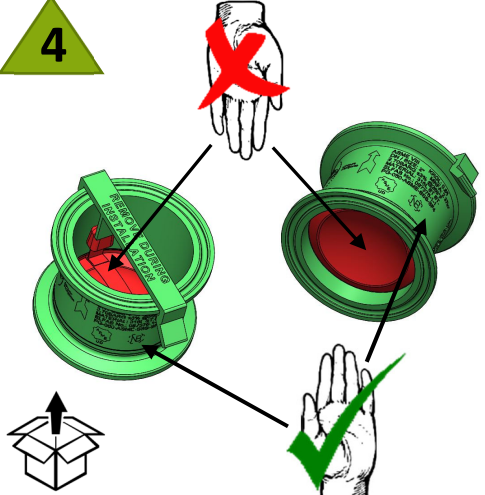

- |   |   |
|---|---|
| (GB) Do not use if damaged                    | (P) Não usar se avariado                  |
| (F) Ne pas utiliser si endommagé              | (E) No utilice en caso de que este dañado |
| (D) Niemals beschädigte berstscheibe einbauen | (S) Får ej användas, om det är skadat     |
| (I) Non utilizzare se danneggiato             | (RU) Не пользоваться при повреждениях     |
| (NL) Indien beschadigd niet gebruiken         |   |

