

BOLTED

BOLTED RUPTURE DISC HOLDER

OsecoElfab's Bolted Holder is available with any combination of weld-neck or threaded inlet and outlet connections.

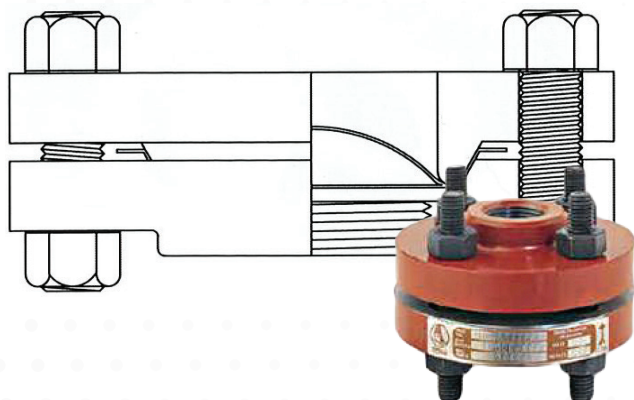

The OsecoElfab Bolted Rupture Disc Holder is designed to be used with or in place of ANSI B16.5 flanges with Sch 40 pipe.

The Bolted Holder assembly is available with weld-neck, threaded, flat or combination connections. Full diameter flat-faced inlet and outlet flanges are available and designed to be used between ANSI companion flanges.

Sizes

1" - 8" (Larger sizes available on request)

Seating Arrangements:

- FRDH (flat seat) - for use with the FAS, CO and STD
- PRDH (flat seat) - for use with the PRO+KRGL

Common Applications

- Skids
- Railcars
- Intermodal Containers

**Let us help you with all
your pressure relief questions.**

US office | Broken Arrow

+1 (918) 258 5626 | info@osecoelfab.com

UK office | North Shields

+44 (0)191 293 1234 | uksales@osecoelfab.com

osecoelfab.com



TECHNICAL SPECIFICATIONS



Size range	1"-8" (25-200mm) (Larger sizes available on request)
Standard materials	316 Series Stainless Steel, Carbon Steel (others available on request)
Seating arrangements*	FRDH, PRDH
Design options	Available with any combination of either weld-neck or threaded inlet and outlet connections
Design Standards	Designed to meet ASME standards

**The type of rupture disc to be used determines which seating arrangement to specify*

Certifications

ASME UD

Related Products

Rupture Discs

FAS
PRO+KRGL
STD
CO

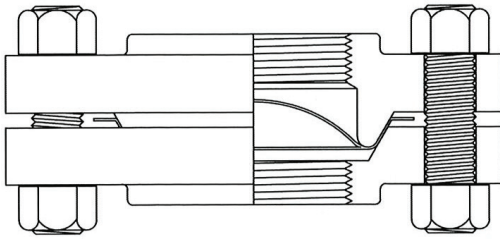

RDH-2 (Threaded Inlet/Threaded Outlet)

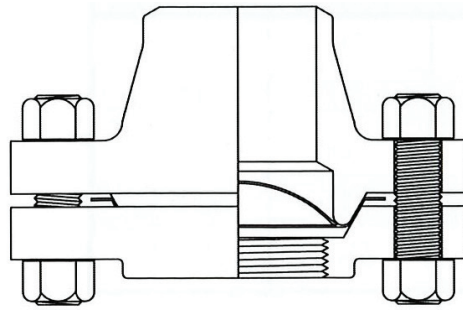

RDH-3 (Threaded Inlet/Welded Outlet)

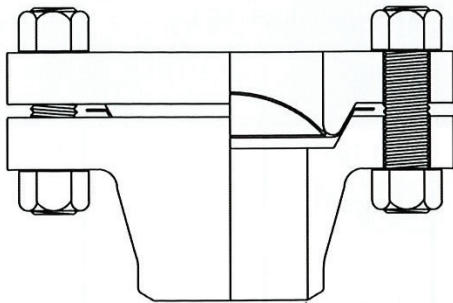

RDH-4 (Welded Inlet/Flat Outlet)

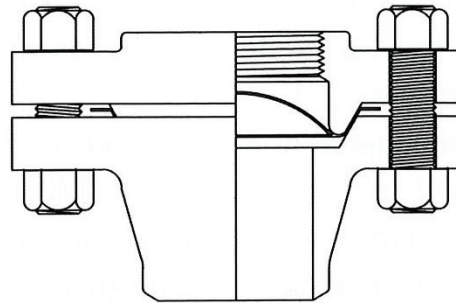

RDH-5 (Welded Inlet/Threaded Outlet)

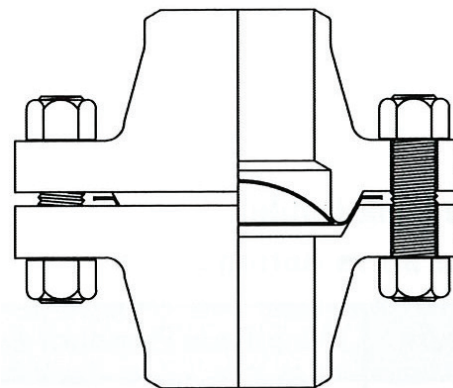

RDH-6 (Welded Inlet/Welded Outlet)

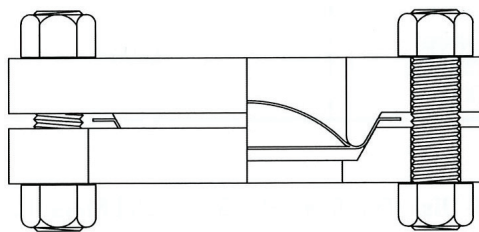

RDH-7 (Flat Inlet/Flat Outlet)

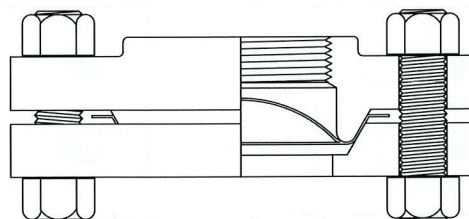

RDH-8 (Flat Inlet/Threaded Outlet)

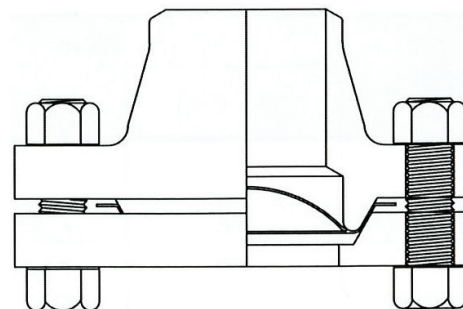

RDH-9 (Flat Inlet/Welded Outlet)