

TRAX CENTIPEDE CABLE

TRAX ARRAY LED BAR CONNECTION ACCESSORY

COMPATIBLE WITH:

TX1-24-SCW, TX1-24-SCWL, TX1-24-TW, TX1-24-RGBW

evo-life
ADVANCED LUMINOUS SOLUTIONS

INSTRUCTION MANUAL

BACKLIGHTING // RETICULAR LED SYSTEMS // TRAX // ACCESSORIES

ABOUT THE TRAX CENTIPEDE CABLE

The TRAX Centipede Cable makes it possible to connect and power floating LED bar pieces. Use it to help navigate around mounting surface obstacles or to create an array section with left over LED bar pieces.

CONTENTS

The TRAX Centipede Cable is available for all TRAX color temperatures. These are sold in custom lengths (per clip) and full TRAX Array lengths of 96" (2,439mm). Includes screws for securing the Centipede Cable to TRAX LED bars.

SINGLE COLOR CENTIPEDE CABLE

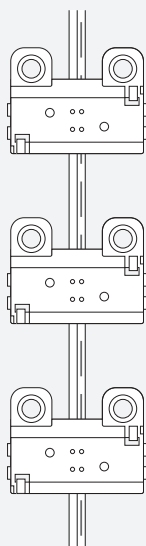

TUNABLE WHITE CENTIPEDE CABLE

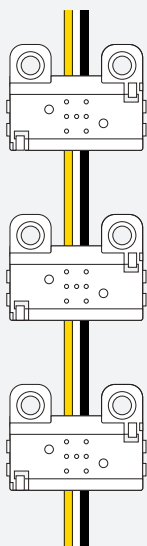

RGB+WHITE CENTIPEDE CABLE

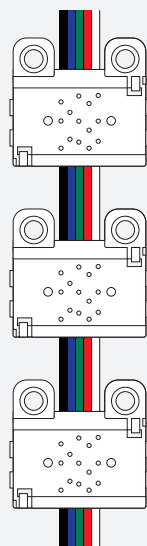

SINGLE COLOR WITH LENS CENTIPEDE CABLE

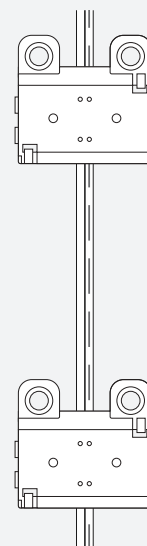

⚠ PRECAUTIONS – BEFORE YOU BEGIN

Read all instructions before installing this accessory.

Turn off power at the source before any wiring or installation work takes place. Do not attempt to install product if there is any visible damage to it. Ensure that the total connected wattage load does not exceed power supply or Class 2 guidelines. Maintain 10% headroom of power supply maximum load to ensure driver longevity.

HOW TO USE THE CENTIPEDE CABLE

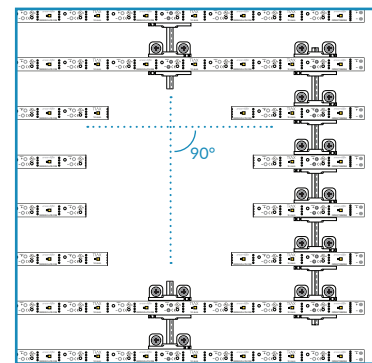
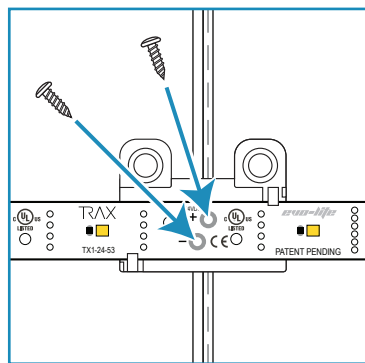
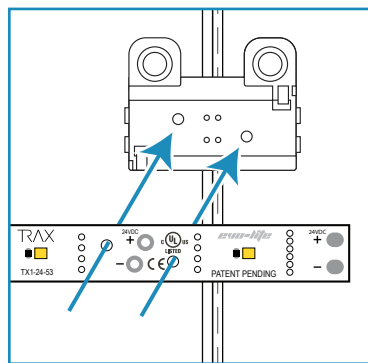
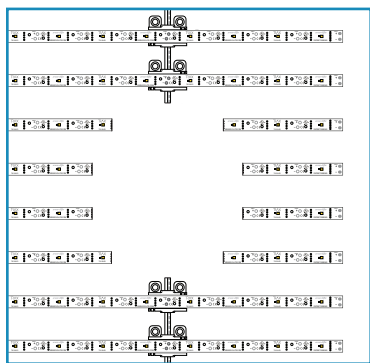

Make all necessary snaps and cuts to the TRAX Array. Lay out the floating LED bar pieces that need to be connected.

Locate the nearest LED bar attached to the rest of the Array. Line up the Centipede Cable wire clip to the mounting hole slots of this LED bar and snap together. Repeat this process with the floating LED bar pieces and end on the next bar receiving power.

Insert the included screws through the LED bar's conductor points and tighten until they penetrate the Centipede Clip's wires.

Repeat this process to connect the floating LED bars to the Centipede Cable wire clips.

Insert screws through the clip's mounting holes to attach them to the mounting surface. Use an angle square to ensure all LED bars are lined up evenly and straight.