



Selling Now!

Rambling, Featured
Executive Living

You'll be living the dream,
just an hour from Sydney.

Discover the natural beauty of the
Central Coast, with charming seaside
villages, renowned surfing beaches,
and scenic National Parks.

Schools, stations and more at your door.

Narara Valley High School is almost at your door,
for those who regularly visit Sydney, it's a level
1km walk to the nearest train station.

Gosford is the main business and learning center
of the region, located only 5km away. This center
is home to the region's main learning hospital,
TAFE campus and Gosford High, a selective
school for high-achieving students.

Find it on Maps!

enclave



On over a hectare of land, this home offers boundless lifestyle opportunities. Enjoy farm-to-table dining from your own home grown vegetables, or take your time in establishing beautiful landscaped gardens, even think about installing and enjoying a game of tennis on your own court.

The home encourages family interaction and togetherness. A home that is fully featured, it's perfect for the larger family who love to socialise and entertain their friends and guests.

See contract for full property details including any easements over your property.

enclave

North

Artist Impression

enclave



Your home is built for a lifetime!

Appliances chosen on performance.

Your home features appliances from leading brands who's products are known for their high performance and longevity of service.

Fisher & Paykel

90cm built-in oven, professional grade rotisserie and cool touch door. Stylishly finished in brushed stainless steel and black glass.

Fisher & Paykel

90cm easy clean gas cooktop with durable cast iron trivets. This cooktop features a total of 5 burners including a dual wok burner.

Fisher & Paykel

A functional and stylish built in microwave oven, with a choice of stainless steel or black surround.

Fisher & Paykel

You have the option of a whisper quiet concealed or canopy styled performance range hoods.

Fisher & Paykel

EZKleen Stainless Steel Dual Drawer dishwasher that is functional, energy and water efficient.

Actron Air

Remote controlled, inverter ducted air conditioning to ensure your internal comfort.

Everything is chosen to last!

The finishes of your home are chosen on their serviceability, ease of cleaning and their fitting to a more modern home finish.

Floor Tiles your entire living space and traffic areas are finished with beautiful ceramic tiles.

Carpet to ensure your comfort, the floors of most bedrooms in your home are carpet finished.

Timber Floors feature throughout the mezzanine, pool deck, sunken BBQ area and poolside bar.

Benchtops your kitchen benches and bathroom vanities are with serviceable stoneware tops.

Hume Illusion contemporary and secure featured entry door with glass inserts and sidelights.

Gainsborough Omni Allure Trilock: Dead bolt, privacy and passage functions combined into one.

Slimline Colorbond sectional panel lift garage door, provides easy access with remote opener.

Your Choice you have a choice of six stunning designer finish ranges from Versatile's collection.

What's included in your home?

Your Home Details

Lot 9

| | |
|----------------------------------|---------------------------|
| Site Area | 1.276Ha |
| Ground Floor Living Area | 252.7m ² |
| Mezzanine Living Area | 85.0m ² |
| Total Living Area | 337.7m² |
| Covered Alfresco Living | 50.8m ² |
| Northern Garden Terrace | 51.3m ² |
| Mezzanine Balcony | 20.5m ² |
| Elevated Plunge Pool | 18.0m ² |
| Pool Deck & Sunken BBQ Area | 105.5m ² |
| Total Outdoor Living Area | 228.1m² |
| Garage, Storage & Carport | 114.7m ² |
| Featured Entry Portico | 12.9m ² |

With a grand pool deck, elevated plunge pool, sunken BBQ area and bar, it's going to be hard to find a home that offers anything near to such true lifestyle living!



This home has been enlarged
and fully renewed for lifestyle!



Your Room Sizes

| | Depth | Width |
|--------------------------------|-------|---------|
| 1. Grand Living & Dining | 5.3m | x 8.0m |
| 2. Kitchen & Butlers Pantry | 5.5m | x 4.2m |
| 3. Light Filled Rumpus | 6.9m | x 4.7m |
| 4. Private Guest Suite | 6.9m | x 7.0m |
| 5. Large Parental Suite | 6.1m | x 5.7m |
| 6. Spacious Bedroom Suite | 5.6m | x 4.6m |
| 7. Large Bedroom & Robe | 3.5m | x 5.7m |
| 8. Handy Home Office | 3.4m | x 4.3m |
| 9. Northern Garden Terrace | 3.7m | x 9.2m |
| 10. Covered Alfresco Living | 6.8m | x 8.0m |
| 11. Generous Pool Deck | 10.0m | x 12.3m |
| 12. Shaded & Sunken BBQ | 4.5m | x 4.1m |
| 13. Elevated Plunge Pool | 6.0m | x 3.0m |
| 14. Featured Entry Portico | 4.2m | x 3.3m |
| 15. Multi Car Garage & Storage | 11.8m | x 6.2m |
| 16. Screened Carport | 6.0m | x 4.5m |

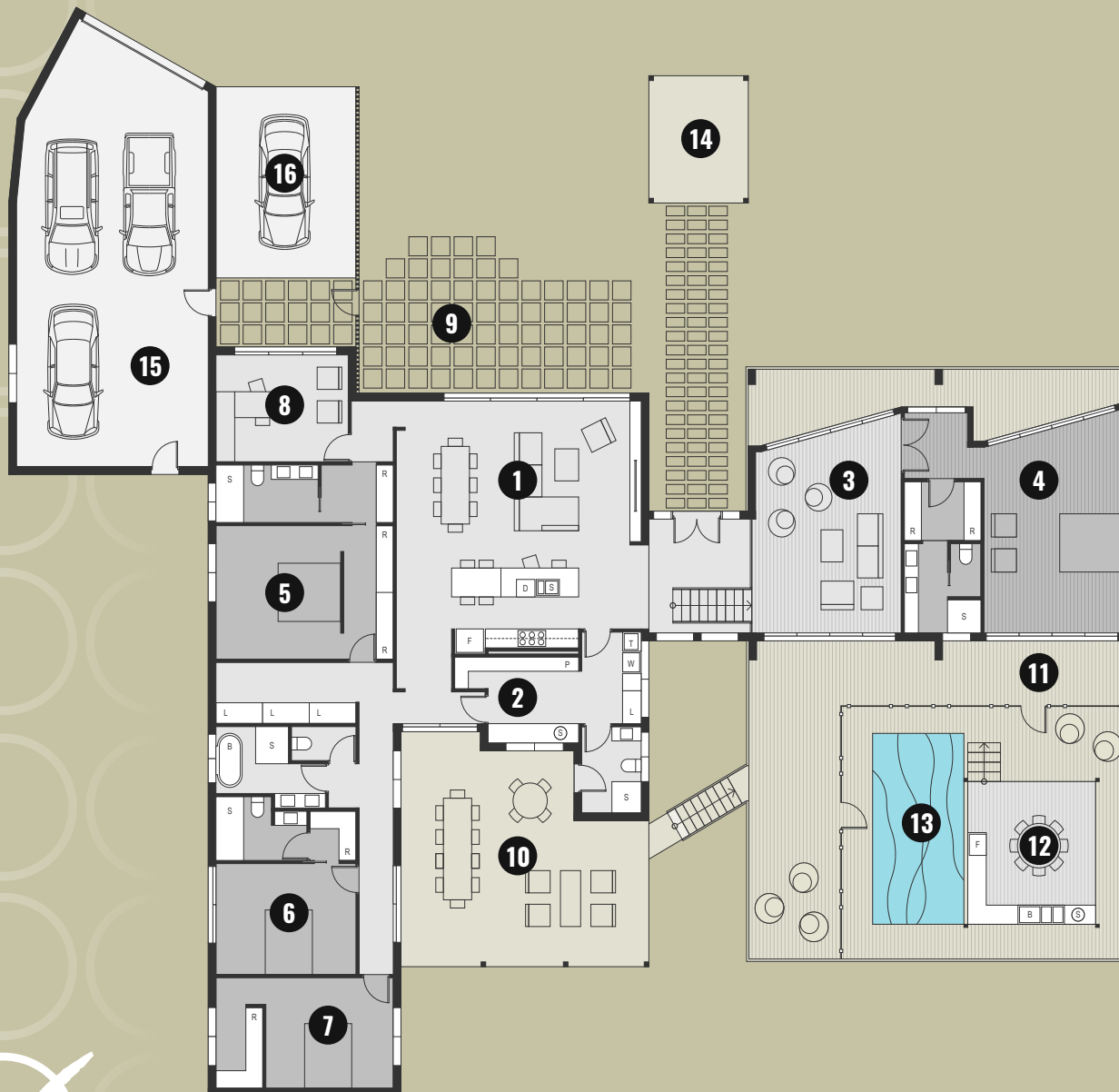

Floor Plan



The Central Coast is a waterway paradise.

With one of the nation's largest coastlines this region is deservedly renown with those having a love for watersports, fishing and boating.

You have access to vast safe waterways stretching all the way across to Sydney's Pittwater and via the Hawkesbury to Windsor. For the surfer, beaches abound, while well established coastal walks meet the demand of even the most ardent bush walker.

This is a chance to make it Your Home!

Disclaimer:

Photographs, renders and illustrations are provided as a visual aid only. All details herewith are provided for information purposes only and may be subject to change without notice.

Versatile Homes Pty. Ltd. give(s) no warranty and make(s) no representation as to the accuracy or sufficiency of any content within this brochure or statement contained on the website or downloadable brochure from the website and accepts no liability for any loss which may be suffered by any person who relies either wholly or in part upon the information presented.

Proudly developed by:

VersatileHomes



© VersatileHomes 2023

Presentation: **Built**Brand.com.au

For more information on any of these available house and land packages, please reach out!

By getting in early you may have the option to choose the full colour storey of your new home.

 0414 297 769

 home@versatilehomes.com.au

 versatilehomes.com.au

Project Address:

17-25 Fountains Road, Narara

Find it on Maps!

enclave