

NOTE:
PANELS CAN BE ATTACHED ON THREE OR FOUR SIDES.
FOR FOUR SIDE ATTACHMENT THE SPAN IS IN THE SHORT
DIMENSION BETWEEN FASTENERS

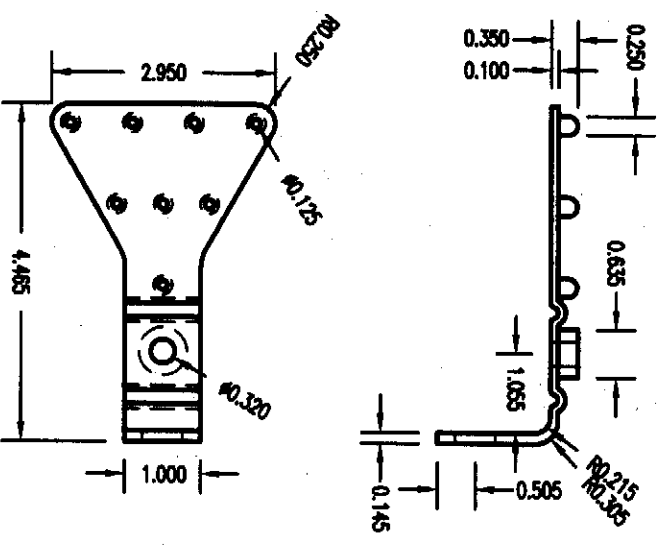

BOTTOM MOUNTING CLIP DETAILS
INSIDE OR OUTSIDE MOUNT INSTALLATION - N.T.S.

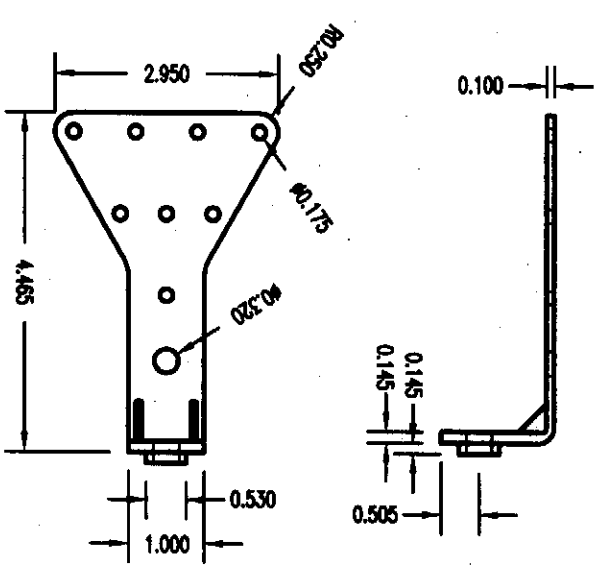

TOP MOUNTING CLIP DETAILS
INSIDE OR OUTSIDE MOUNT INSTALLATION - N.T.S.

LOADS ON EXISTING STRUCTURE FROM SCREEN SYSTEM
T_x = PARALLEL LOADS (PLF)

SCREEN SPAN	80	60	50	40
4'-0"	240	270	190	180
6'-0"	510	400	320	270
8'-0"	630	510	430	330
10'-0"	750	600	520	430
12'-0"	870	620	600	510
14'-0"	930	765	680	580
16'-0"	1030	870	750	630
18'-0"	1067	907	808	694

LOADS ON EXISTING STRUCTURE FROM SCREEN SYSTEM
T_y = PERPENDICULAR LOADS (PLF)

SCREEN SPAN	80	60	50	40
4'-0"	160	120	100	80
6'-0"	240	180	150	120
8'-0"	320	240	200	160
10'-0"	400	300	250	200
12'-0"	480	360	300	240
14'-0"	560	420	350	280
16'-0"	640	480	400	320
18'-0"	713	535	446	357

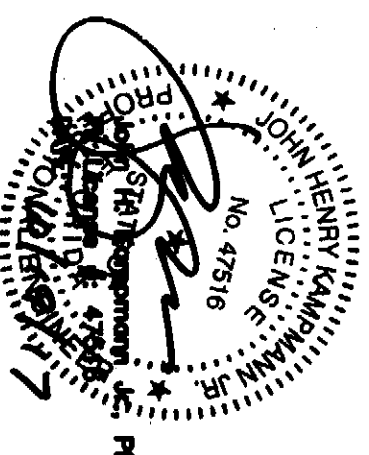
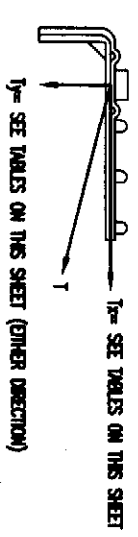

2017 FBC (NON-HIGH VELOCITY HURRICANE ZONE) 5TH EDITION

Description: ASTRO FLEX Wind Abatement System	Project Name: HURRICANE FABRIC.COM LLC PO BOX 80153 CLAYTON, MO 63108 PHONE: (238)888-0088 WWW.HURRICANEFABRIC.COM	REV. 1 DESCRIPTION XX/XX/XX - XXXXXXXXXXXX	MEASUREMENTS ENGINEERS, INC. 5858 Louisa Drive Orlando, Florida 32835 (407) 822-3224 CA-0072
		Project No.: JK Project #: 17-045 Date: 10/19/17	