

20

% MASS

Test Fit

SINGLE TENANT
OPEN OFFICE

Stacking Plan:
FLOORS 07-10

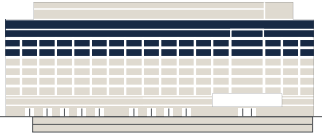

For office leasing:

AMY BOWSER
Amy.Bowser@cbre.com
+1 202 423 2196

BROOKS BROWN
Brooks.Brown@cbre.com
+1 202 423 2193

WILL DONOHUE
Will.Donohue@cbre.com
+1 202 423 2194



CBRE

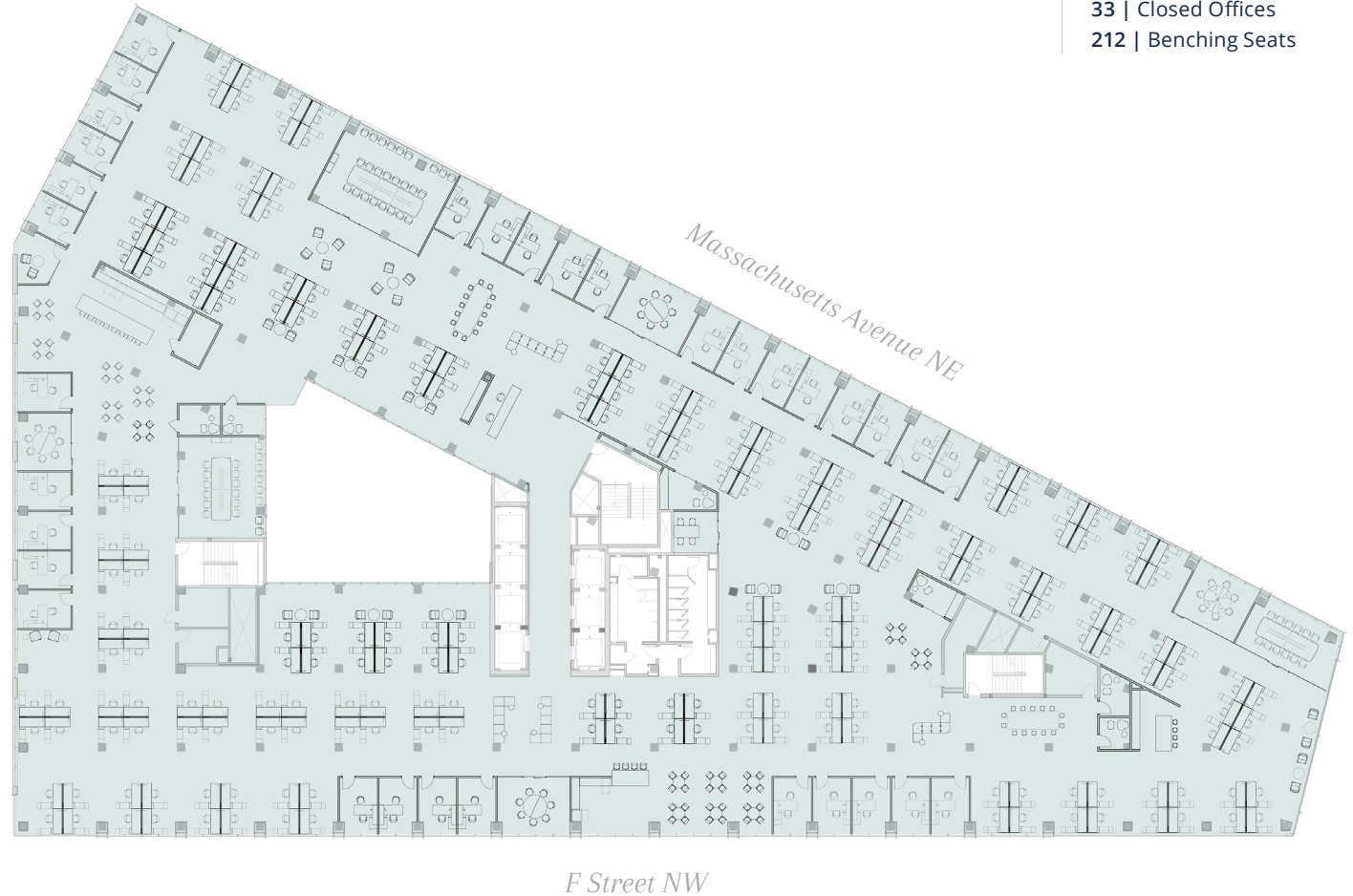

Note: Drawing not to scale

Information and data contained herein, including projections, have been obtained from sources believed to be reliable, but we have not independently verified it and make no guarantee, warranty or representation about it. All information is presented exclusively for use by CBRE or JLL clients and professionals and all rights to the material are reserved and cannot be reproduced without prior written permission. CBRE and the CBRE logo are service marks of CBRE, Inc. All other marks displayed on this document are the property of their respective owners, and the use of such logos does not imply any affiliation with or endorsement of CBRE. Photos herein are the property of their respective owners and use of these images without the express written consent of the owner is prohibited.

CBRE, Inc. | +1 202 783 8200 | 1900 N St NW Suite 700 | Washington, DC 20036

Office Breakdown:

33 | Closed Offices
212 | Benching Seats



20

7/8 MASS

Test Fit

SINGLE TENANT
OFFICE INTENSIVE

Stacking Plan:
FLOORS 07-10

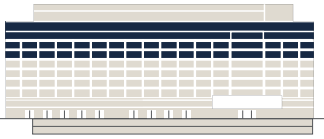

For office leasing:

AMY BOWSER
Amy.Bowser@cbre.com
+1 202 423 2196

BROOKS BROWN
Brooks.Brown@cbre.com
+1 202 423 2193

WILL DONOHUE
Will.Donohue@cbre.com
+1 202 423 2194



CBRE



Office Breakdown:

67 | Closed Offices

94 | Benching Seats

Note: Drawing not to scale

Information and data contained herein, including projections, have been obtained from sources believed to be reliable, but we have not independently verified it and make no guarantee, warranty or representation about it. All information is presented exclusively for use by CBRE or JLL clients and professionals and all rights to the material are reserved and cannot be reproduced without prior written permission. CBRE and the CBRE logo are service marks of CBRE, Inc. All other marks displayed on this document are the property of their respective owners, and the use of such logos does not imply any affiliation with or endorsement of CBRE. Photos herein are the property of their respective owners and use of these images without the express written consent of the owner is prohibited.

CBRE, Inc. | +1 202 783 8200 | 1900 N St NW Suite 700 | Washington, DC 20036

20

1/3 MASS

Test Fit

TWO TENANTS

Stacking Plan:

FLOORS 07-10

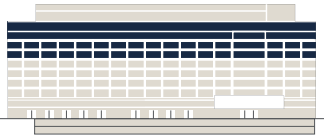

For office leasing:

AMY BOWSER

Amy.Bowser@cbre.com

+1 202 423 2196

BROOKS BROWN

Brooks.Brown@cbre.com

+1 202 423 2193

WILL DONOHUE

Will.Donohue@cbre.com

+1 202 423 2194



CBRE



Office Breakdown:

SUITE A

16 | Closed Offices

116 | Benching Seats

SUITE B

5 | Closed Offices

100 | Benching Seats

Note: Drawing not to scale

Information and data contained herein, including projections, have been obtained from sources believed to be reliable, but we have not independently verified it and make no guarantee, warranty or representation about it. All information is presented exclusively for use by CBRE or JLL clients and professionals and all rights to the material are reserved and cannot be reproduced without prior written permission. CBRE and the CBRE logo are service marks of CBRE, Inc. All other marks displayed on this document are the property of their respective owners, and the use of such logos does not imply any affiliation with or endorsement of CBRE. Photos herein are the property of their respective owners and use of these images without the express written consent of the owner is prohibited.

CBRE, Inc. | +1 202 783 8200 | 1900 N St NW Suite 700 | Washington, DC 20036

