



COLUMBIA MFG

UTILITIES PRODUCT CATALOG

ELECTRIC PEDESTALS, VAULTS,
POLELINE PARTS, HARDWARE &
MORE



Smak
Plastics, Inc.

CATALOG GUIDE

TABLE OF CONTENTS

ABOUT US

PG 3

UNDERGROUND MATERIALS

COLUMBIA MFG PEDESTAL FEATURES	PG 4
PEDESTAL PART NUMBER SYSTEM	PG 5
PA200 ELECTRIC PEDESTALS	PG 6
PA240 ELECTRIC PEDESTALS	PG 7
PF300 ELECTRIC PEDESTALS	PG 8
CF600 ELECTRIC PEDESTALS	PG 9
VAULTS	PG 10

OVERHEAD MATERIALS

POLE LINE PARTS - BRACKET ARMS	PG 11
POLE LINE PARTS - ADAPTORS	PG 12
POLE LINE PARTS - MORE	PG 13

HARDWARE

HARDWARE - CUP LOCKS, CONNECTOR BLOCKS, COVERS	PG 14
TEMPORARY SERVICE MODUALS (TSM)	PG 15



ABOUT US

COLUMBIA MFG BY SMAK PLASTICS



COLUMBIA MFG

COLUMBIA MFG, IS PROUD TO LEAD THE WAY WITH ELECTRIC PEDESTAL AND POLE LINE PRODUCTS AND HAS BEEN SERVING THE NEEDS OF OUR MAJOR ELECTRIC PARTNERS FOR OVER 40 YEARS.



SMAK PLASTICS, INC.

FOUNDED IN 2007, COLUMBIA MFG PARENT COMPANY, SMAK PLASTICS INC. IS AN INTERNATIONAL MARKET LEADER FOR ROTATIONALLY MOLDED PLASTICS. HEADQUARTERED IN VANCOUVER, WA, SMAK PLASTICS IS ABLE TO CUSTOM MANUFACTURE SECONDARY PEDESTALS HERE IN THE USA TO YOUR SPECIFICATIONS.

COLUMBIA MFG PRODUCT WARRANTY

3 YEAR MATERIALS & WORKMANSHIP WARRANTY: WARRANTED FREE OF DEFECTS IN MATERIALS AND WORKMANSHIP WHEN USED UNDER NORMAL CONDITIONS AND FOR THE PURPOSE FOR WHICH THE PRODUCT WAS DESIGNED.

30 YEAR ROTOMOLD WARRANTY: ROTOMOLDED PRODUCTS WARRANTED AGAINST FAILURE DUE TO LOSS OF STRENGTH THROUGH DEGRADATION WHEN USED UNDER NORMAL ENVIRONMENTAL CONDITIONS. ACTS OF GOD ARE EXCLUDED.



*PURCHASER'S SOLE REMEDY FOR ANY DEFECT SHALL BE THE REPAIR OR REPLACEMENT OF THE PRODUCT AT THE DECISION OF COLUMBIA MFG. ALL EXPENSES RELATED TO REMOVAL AND TRANSPORTATION INCURRED BY THE OWNER OF THE PRODUCT IN DELIVERING THE PRODUCT TO COLUMBIA MFG FOR REPAIR OR REINSTALLATION OF THE REPAIRED OR REPLACED PRODUCT SHALL BE THE RESPONSIBILITY OF THE PRODUCT OWNER. THIS WARRANTY IS EXPRESSLY IN LIEU OF ANY OTHER EXPRESS OR IMPLIED WARRANTIES AND COLUMBIA MFG MAKES NO OTHER EXPRESS OR IMPLIED WARRANTY, INCLUDING ANY IMPLIED WARRANTY OF FITNESS OR MERCHANT ABILITY. IN NO CASE SHALL COLUMBIA MFG BE LIABLE FOR CONSEQUENTIAL, SPECIAL OR INDIRECT DAMAGES RESULTING FROM BREACH OF THIS WARRANTY.

UNDERGROUND

MATERIALS FEATURES & OPTIONS

PEDESTAL FEATURES

- ROTOMOLDED LINEAR LOW-DENSITY POLYETHYLENE.
- UV STABILIZED FOR WEATHERING PERFORMANCE 1700PPM CTEC 3346.
- MECHANICAL PROPERTIES PROVIDE EXCELLENT FIELD PERFORMANCE WITH HIGH STRENGTH VALUES.
- STAINLESS STEEL PENTA BOLT AND PADLOCK PROVISION INCLUDED.
- DOUBLE LOCKING FEATURES PREVENTS UNWANTED ACCESS.
- RIBBED BASES PROVIDE SUPERIOR RIGIDITY AND FLEXURAL STRENGTH.
- MINIMUM DIELECTRIC STRENGTH OF 450 VOLTS PER MIL. (MIN. REQUIRED)

OPTIONS AVAILABLE

- ALTERNATE COLORS FOR SPECIAL APPLICATIONS.
- WARNING AND IDENTIFICATION VINYL GRAPHICS.



UNDERGROUND

MATERIALS PART NUMBER SYSTEM

PEDESTAL PART NUMBER SYSTEM EXPLAINED

SYSTEM: PART # – LAY IN CONNECTORS | GRAPHICS | COLOR

EXAMPLE: PF300-C1GMG

- PF300 = PEDESTAL PART NUMBER AS SHOWN IN CATALOG
- C1 = LAY IN CONNECTORS (SEE PHOTO A BELOW)
- G = CUSTOMER SUPPLIED GRAPHICS (SEE PHOTO B BELOW)
- MG = MUNSELL GREEN
(OTHER COLORS AVAILABLE: WG = WILLOW GREEN, OR = ORANGE,
TA = TAN, GY = GRAY)



A



B



PA200

SECONDARY PEDESTALS



PA200

*Shown with 6061-T6 aluminium lay in connectors: 350-kcmil-12, available with anodized and non-anodized 5/16" hex drive set screws.

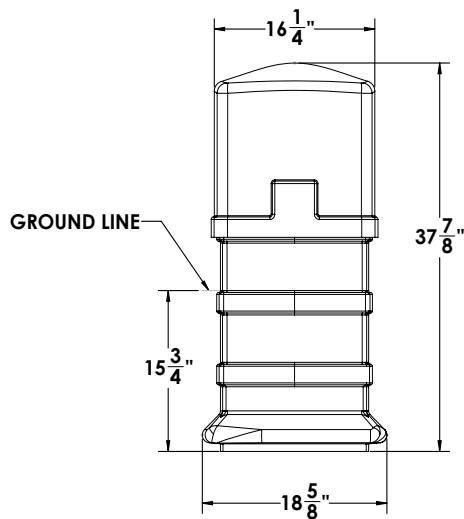

PA120

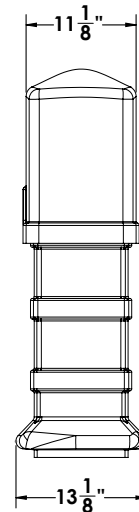

PA140

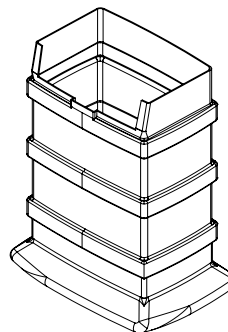
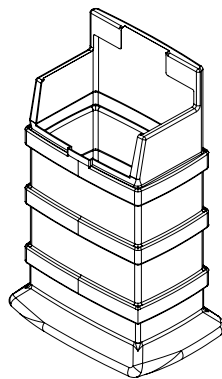
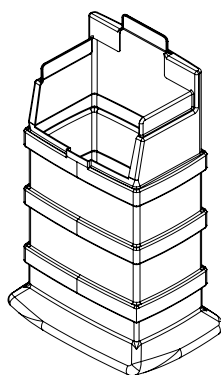
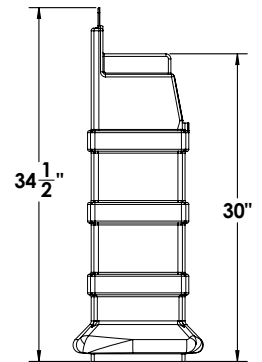

Part No.	Product	Trim Style	Unit Weight	Per Pallet	Pallet Dims	Pallet Weight
PA200-MG188	PA200	PA200	18 lbs	12	48"x40"x72"	256 lbs
PA120-MG188	PA120	PA120	18 lbs	12	48"x40"x72"	256 lbs
PA140-MG188	PA140	PA140	18 lbs	12	48"x40"x72"	256 lbs

PA240

SECONDARY PEDESTAL



GROUND LINE

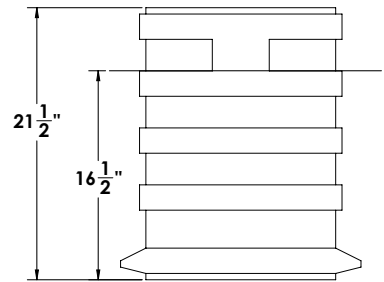
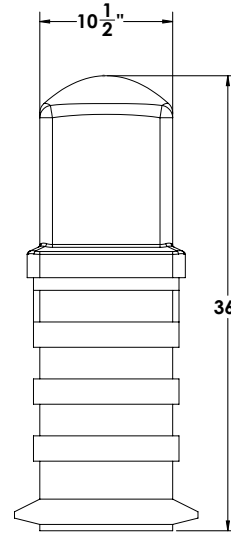
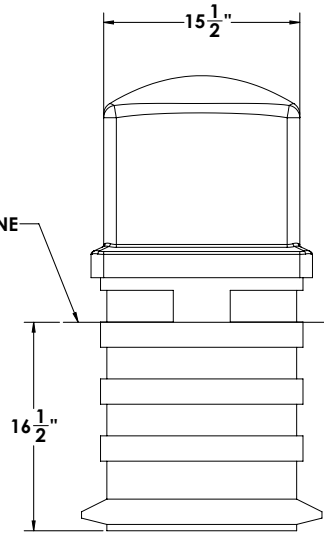

Part No.	Product	Trim Style	Unit Weight	Per Pallet	Pallet Dims	Pallet Weight
PA240G-MG188	PA240	PA240	15 lbs	18	48"x40"x72"	310 lbs



PF300

SECONDARY PEDESTAL

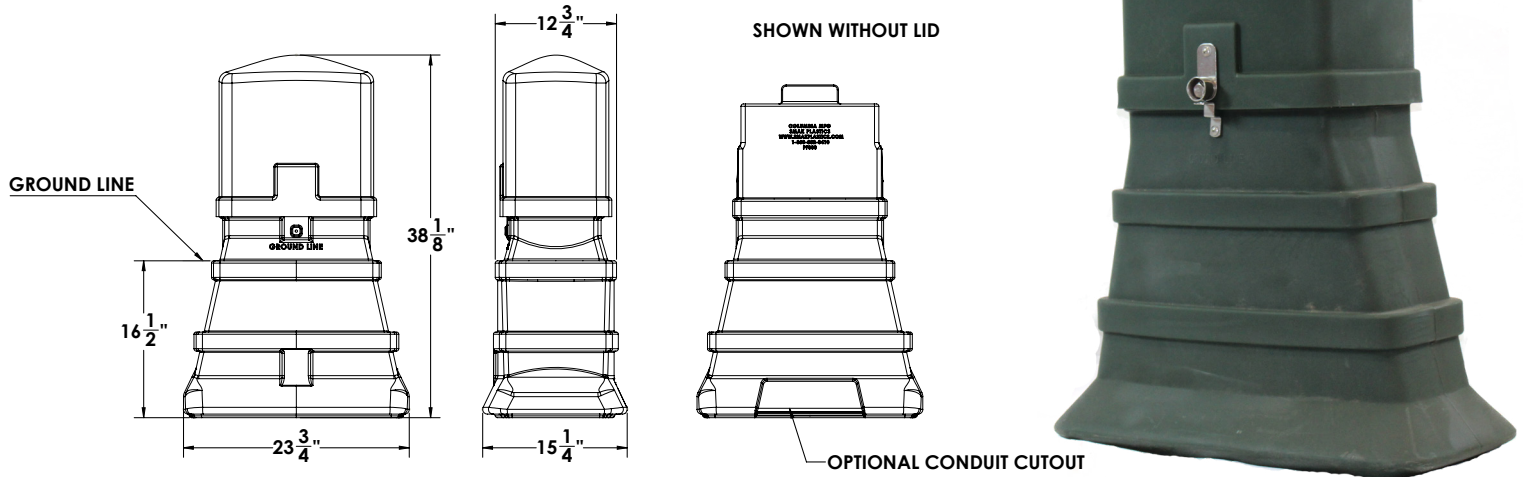

*Shown with 6061-T6 aluminum lay in connectors: 350-kc-mil-12, available with anodized and non-anodized 5/16" hex drive set screws.



PF 300

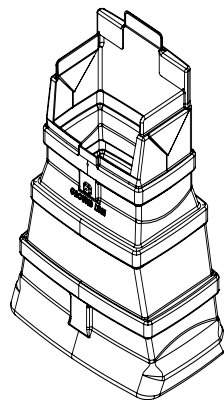

PF 320

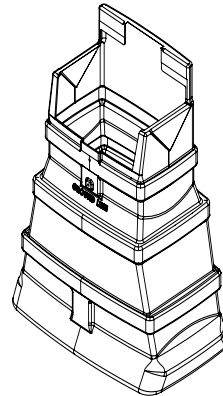

PF 340

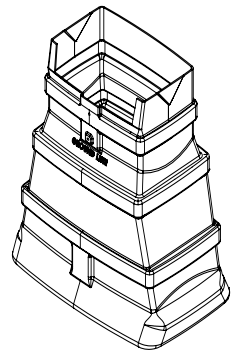

Part No.	Product	Trim Style	Unit Weight	Per Pallet	Pallet Dims	Pallet Weight
PF300C1AG-MG188	PF300 Wide Base	PF300	20 lbs	18	48"x48"x72"	400 lbs
PF320C1AG-MG188	PF320	PF320	20 lbs	18	48"x48"x72"	400 lbs
PF340C1AG-MG188	PF340	PF340	20 lbs	18	48"x48"x72"	400 lbs

CF600

SECONDARY PEDESTAL

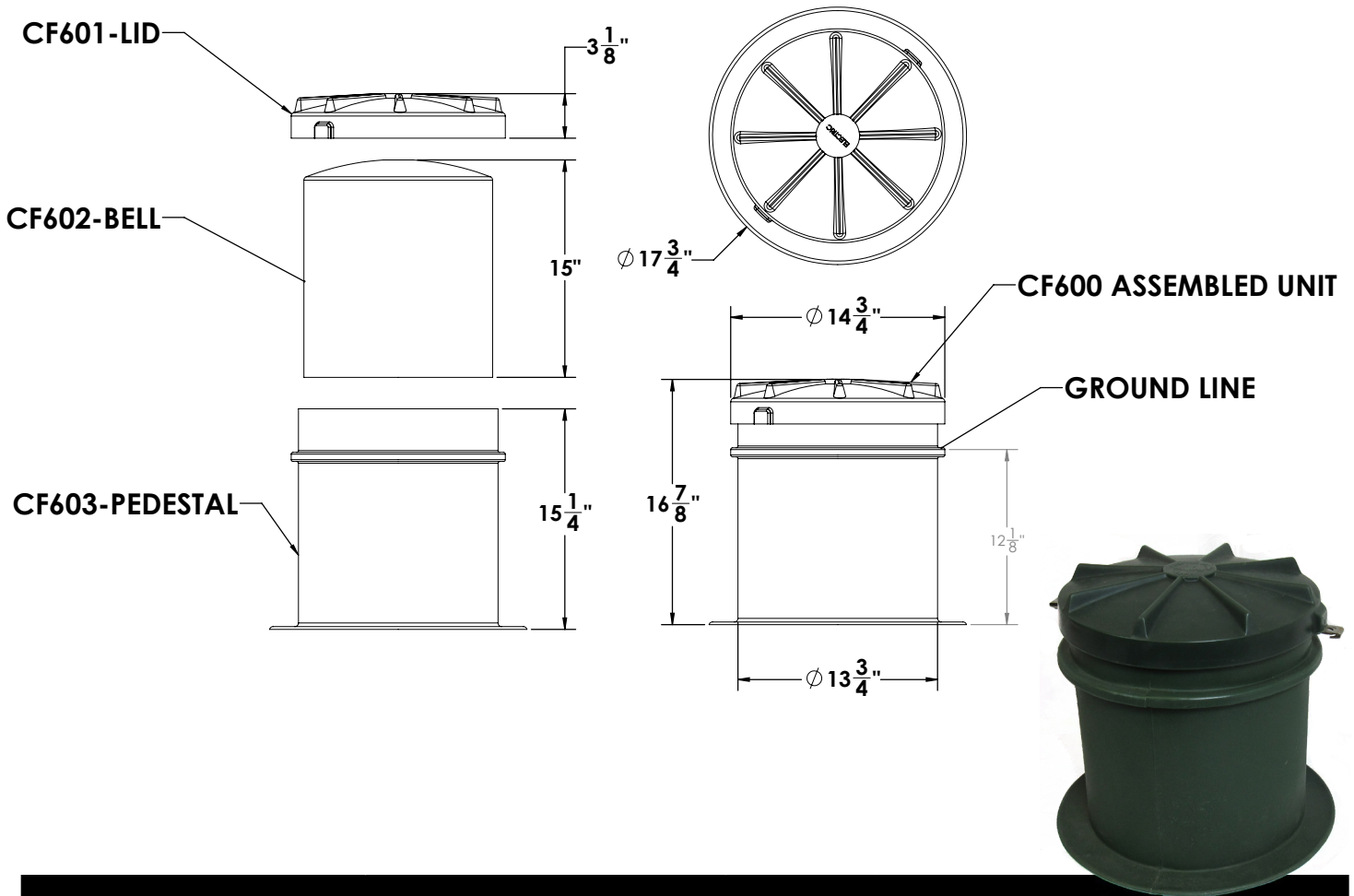

Part No.	Product	Unit Weight	Per Pallet	Pallet Dims	Pallet Weight
CF600AG-MG188	CF600 Secondary Pedestal	10 lbs	30	48"x40"x54"	166 lbs
CF603-MG-PED	CF603 Pedestal Only	5.5 lbs	-	-	-
CF602-BK-BELL	CF602 Bell Only	3.5 lbs	-	-	-
CF601-MG-LID	CF601 Lid Only	2.2 lbs	-	-	-



TPV20

VAULTS

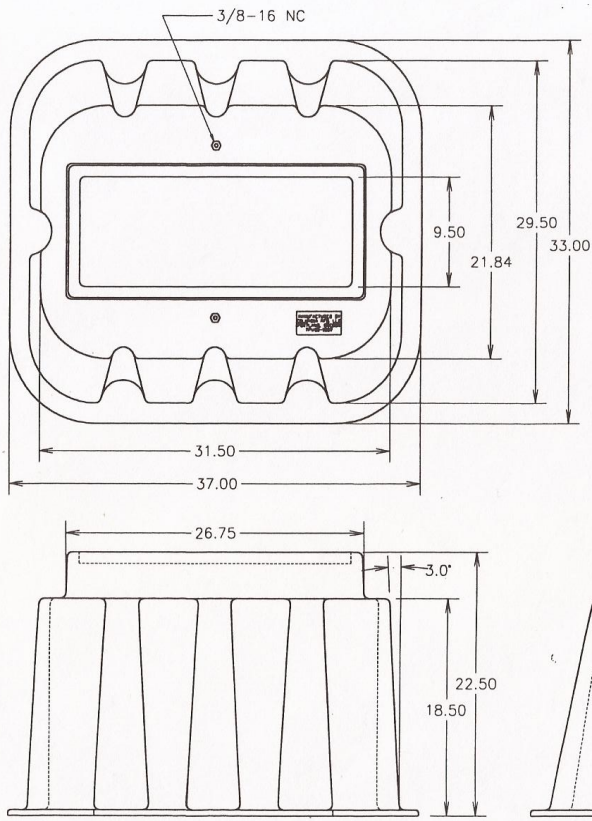

*Vault Cover is one-size fits all

Part No.	Product	Unit Weight	Top Opening Dims	Per Pallet	Pallet Dims	Pallet Weight
01-10282-001	TPV20-1225 Vault	18 lbs	24.75"x11.75"	20	48"x40"x86"	395 lbs
01-10325-002	TPV20-1220 Vault	18 lbs	19.75"x11.75"	20	48"x40"x86"	395 lbs
01-10675-001	TPV20-1227 Vault	18 lbs	26.75"x11.75"	20	48"x40"x86"	395 lbs
01-10574-001	TPV-VC Vault Cover	4 lbs	(Overall Dims) 28.5"x 14.88"x4.25"	50	48"x40"x50"	240 lbs

POLE LINE

BRACKET ARMS

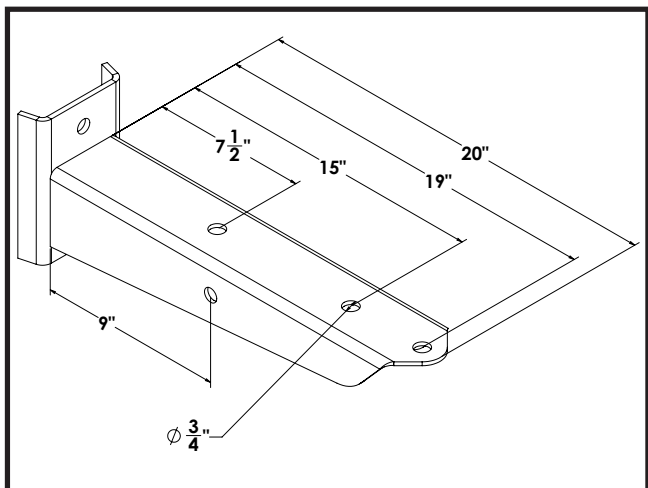

HDB 200
BRACKET ARM FOR
WOOD POLES

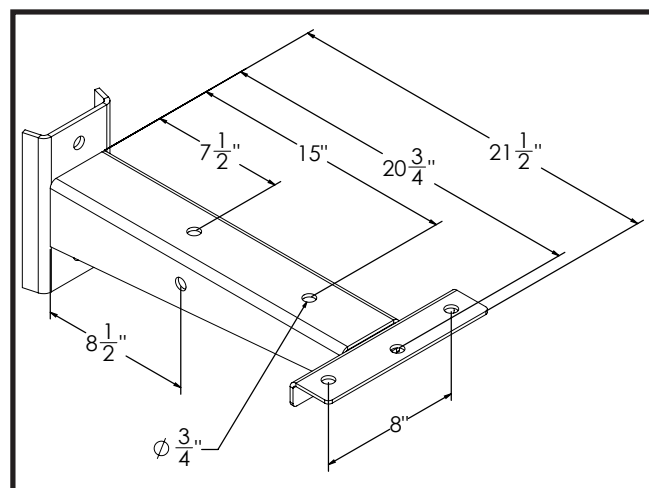

HDB 200.4
BRACKET ARM FOR
WOOD POLES

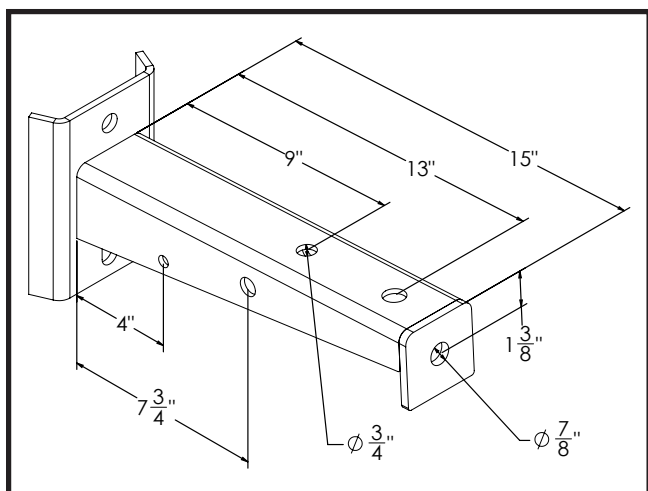

HDB 400
BRACKET ARM FOR
WOOD POLES

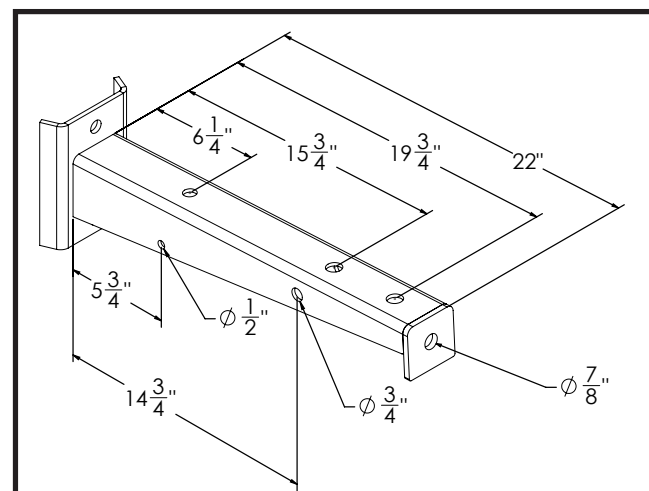

HDB 800
BRACKET ARM FOR
WOOD POLES

Part No.	Product	Dimensions	Arm Width	Unit Weight	Per Package
07-00045	HDB-200	(see drawing)	3.75"	12 lbs	(sold by pallet)
07-00077	HDB-200-4	(see drawing)	3.75"	14.75 lbs	(sold by pallet)
07-00078	HDB-400	(see drawing)	3"	9.75 lbs	(sold by pallet)
07-00046	HDB-800	(see drawing)	3"	12.75 lbs	(sold by pallet)



Smak
Plastics Inc.

POLE LINE

ADAPTERS

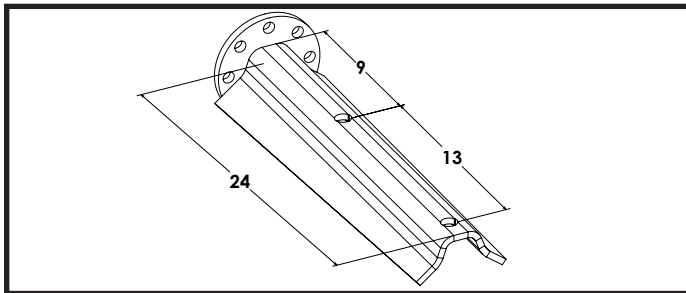

PTB 120

POLE TOP INSULATOR MOUNTING BRACKET

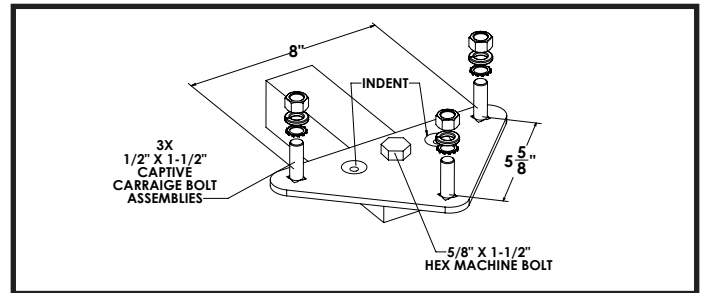

CBA 221

MULTI-MOUNT ADAPTER

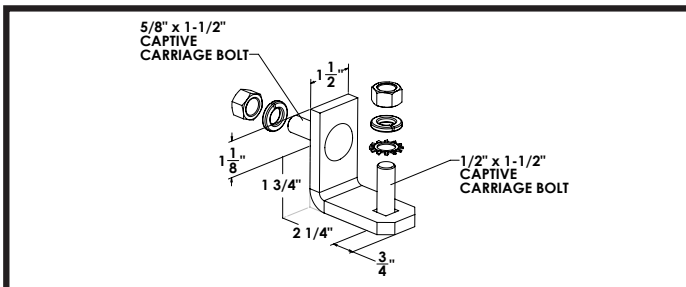

CBA 231

GALVANIZED ANGLE ADAPTER

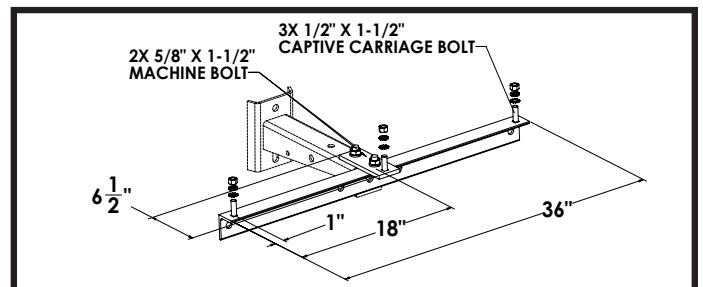

CBA 331

MULTI-MOUNT ADAPTER

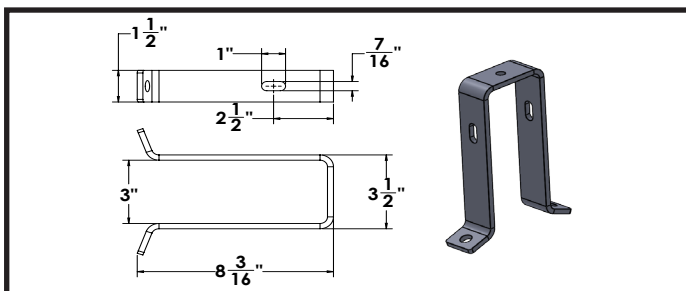

B18 STANDOFF
SUPPORT BRACKET

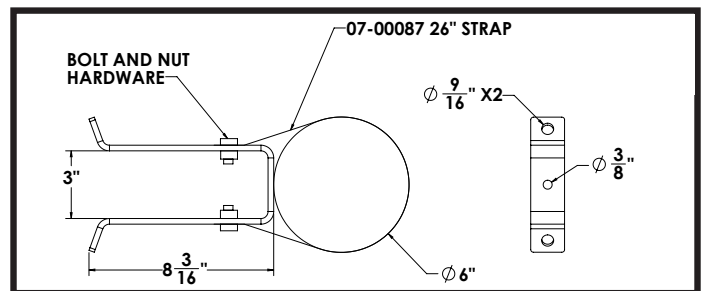

B18 STANDOFF
(SHOWN WITH 26\"/>

Part No.	Product	Dimensions	Unit Weight	Per Package	Specifications
07-01011	PTB-120-8	24"x7"x7"	25 lbs	(sold by pallet)	6-Bolt Mounting Flange
07-01004	CBA-221 Multi Mount Adapter	9.5"x7"	2.67 lbs	25	1/4" Triangular Plate 8" x 5 5/8"
07-01002	CBA-231 Clip Angle Adapter	2"x2"	1 lb	25	1 1/2" x 3/8" x 3" Clip Angle
07-01007	CBA-231.2 Clip Angle Adapter	2"x2"	1.25 lbs	25	2" Bolts, Not 1 1/2"
07-01005	CBA-331 Multiple Mount Adapter	2"x2.5"	14.5 lbs	(sold by pallet)	2" x 2 1/2" x 36" Angle
07-01008	B18 Standoff Bracket - 26" Strap	(see drawing)	3 lbs	N/A	Attaches with two 7/16 lag screws
07-01009	B18 Standoff Bracket - 21.5" Strap	(see drawing)	3 lbs	N/A	Attaches with two 7/16 lag screw
07-00072	B-18 Standoff Bracket - No Strap	(see drawing)	3 lbs	N/A	Attaches with two 7/16 lag screw

POLE LINE

MORE

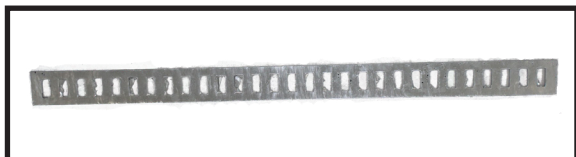

STEEL STRAP
PERFORATED, 21.5"



EXTENTION LINKS
3136-BNC

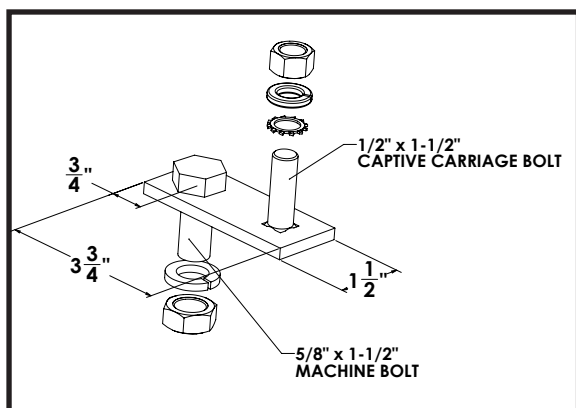

CBA 235
BAR ADAPTER



TRUNNION CLAMP
ALPS-150

Part No.	Product	Dimensions	Unit Weight	Per Package
07-00050	Perforated Steel Strap	21.5"	0.32 lb	(sold by pallet)
07-00074	3124-BNC Extension Links	20"	8 lbs	(sold by pallet)
07-01003	CBA - 188 Insulator Mount	1"	0.23 lb	25
07-01010	CBA-235 Bar Adapter	1"	0.75 lb	25
07-01001	ALPS-150 Trunnion Clamp	7"x4"	1 lb	20



HARDWARE

CUP LOCKS, CONNECTOR BLOCKS, COVERS

PENTA BOLT KIT



CONNECTORS ANODIZED SCREWS

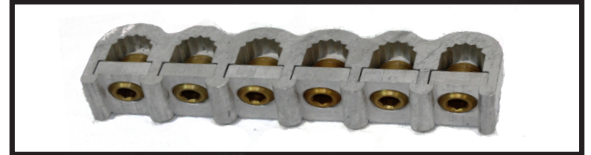

CONNECTORS NON-ANODIZED SCREWS

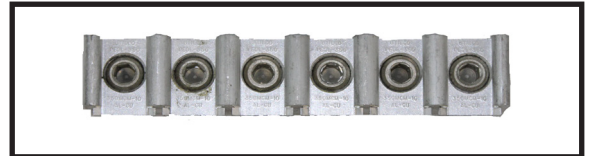

CONNECTOR COVER



CUP LOCKS



Part No.	Product	Dimensions	Unit Weight	Per Package
07-01003	Penta Bolt Kit	1"	0.23 lb	25
07-00064	C1 Connectors - Anodized	9"x2"x2"	2.5 lbs	25
07-00065	C1 Connectors - Non - Anodized	9"x2"x2"	2.5 lbs	25
07-00066	Connector Cover - Clear	7.7"x2.75"x3.25"	2 lb	25
07-01006	Cup Lock - Assembly (PL-101)	2.5"x1.38"x1"	0.26 lb	25

*Connectors shown with 6061-T6 aluminium lay: 350-kcmil-12, available with anodized and non-anodized 5/16" hex drive set screws.



HARDWARE

TEMPORARY SERVICE MODULES (TSM)



TSM FEATURES

- FOR USE IN UNMETERED TEMPORARY SERVICE, TEMPORARY SERVICE MODULES (TSMS) CAN BE EASILY INSTALLED ON A PEDESTAL BASE DURING CONSTRUCTION.
- TSMS ARE ROTOMOLDED IN HIGH-VISIBILITY ORANGE, THICK HDPE FOR EXTREME DURABILITY IN ANY WEATHER
- OTHER COLORS AVAILABLE WITH MINIMUM ORDER
- STANDARD NON-GFI AS WELL AS GFI OPTIONS AVAILABLE, RATED FOR 20 AMPS
- COMPATIBLE WITH COLUMBIA MFG AND NORDIC PSPF & PSPS PEDESTALS
- AFTER PROJECT COMPLETION, THE LID IS EASILY REMOVED AND REPLACED WITH A PERMANENT PEDESTAL LID.

Part No.	Product	Product Dims	Unit Weight
07-10101	TSM 17"	15"x15"x17"	20 lbs
07-10102	TSM 28"	15"x15"x28"	28 lbs





COLUMBIA MFG

TO ORDER

360-882-0410

SALES@SMAKPLASTICS.COM

Smak
Plastics, Inc.