

Town Highway Superintendent Dave Gunner contacted a Village Trustee about the bridge replacement on East Fillmore, currently a one-lane bridge. The Town applied for, and received, grant funding to replace the one-lane bridge with a two-lane bridge. Mr. Gunner also spoke to the Village Board at their meeting on October 3rd. The Town will be replacing this bridge next year.

Mr. Gunner has suggested that the best way to do this project, in addition to the bridge replacement done by the Town, is for the Village to include additional work in the Town bid. The additional Village work involves reconstructing the turn down the hill, so as not to make an 'S' curve headed over the bridge. This would be an estimated \$100,000 cost paid by the Village.

Additionally, Mr. Gunner proposed that a sidewalk may be added along the south and east side of E. Fillmore, connecting from the existing sidewalk on E. Fillmore and running to the existing sidewalk on Martin, with an estimated added cost of \$35,000, paid by the Village.

The Village will need to decide among the following options:

- 1) Do nothing and the Town replaces the one-lane bridge with the two-lane bridge and the road remains as is, with an 'S' curve to cross the new bridge, with no cost to the Village.
- 2) The Village agrees to reconstruct the road included in the Town bid and the Village pays for that portion, an estimated cost of \$100,000.
- 3) The Village agrees to reconstruct the road and add sidewalks along the south and east side of Fillmore, included in the Town bid and the Village pays for that portion, an estimated cost of \$135,000.

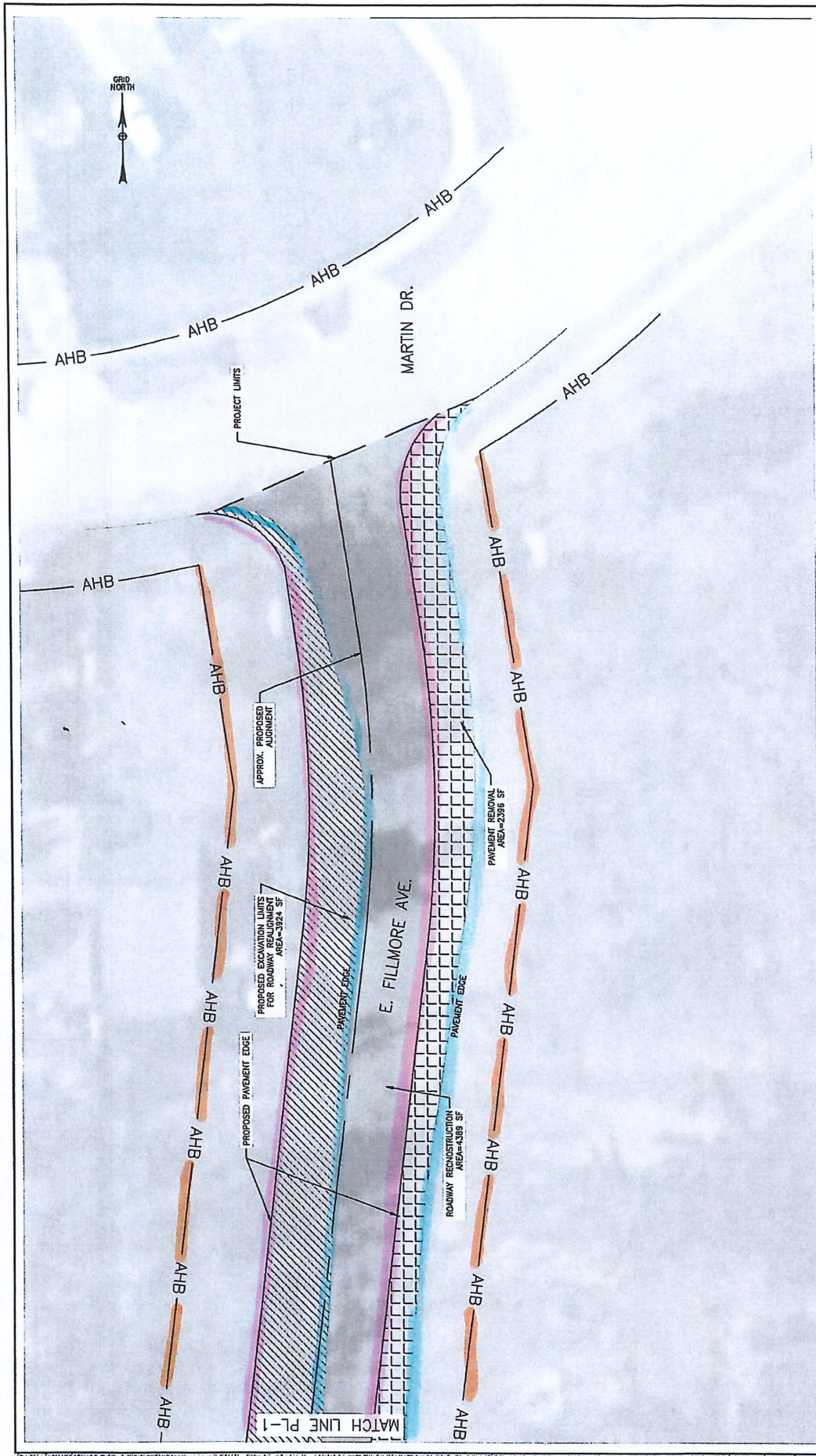

Foite Albert X ASSOCIATES
 Architecture, Engineering, Surveying, Environmental
 300 West 10th Street, Suite 200
 New York, NY 10011
 P: (212) 633-1332 www.fax.com

E. FILLMORE AVE. AREA OF POTENTIAL EFFECT
 CHURCH ST. & E. FILLMORE AVE.
 OVER TANNERY BROOK
 COUNTY OF ERIE
 VILLAGE OF E. AURORA, NEW YORK 14052

DATE	2/20/20
BY	PL-2
PROJECT NO.	220227.00
SCALE	1" = 20'

