

- Tape Measure
- Box Knife
- Level or Laser Level (recommended)
- J Roller (recommended)

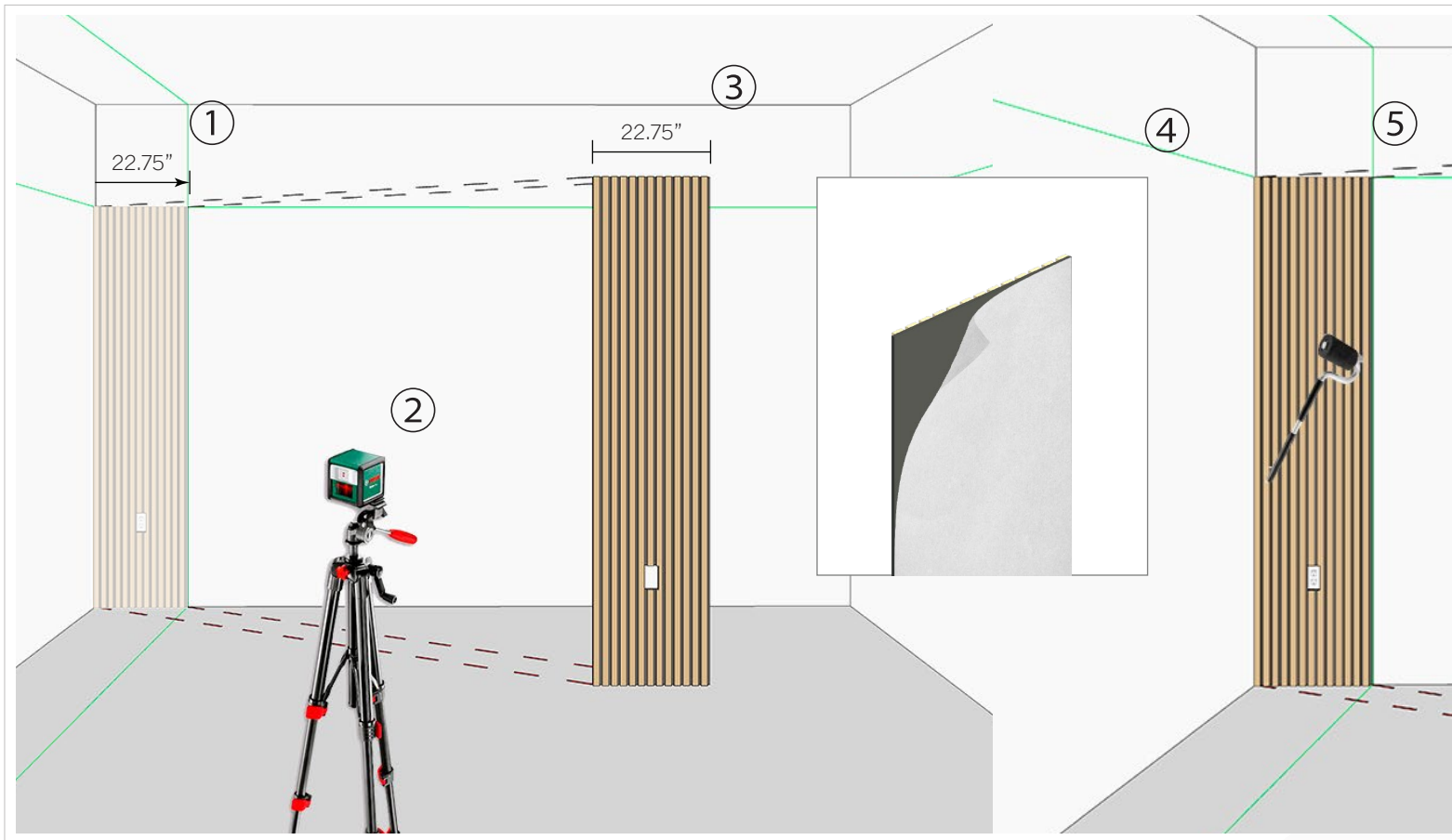

Instructions

1. Identify which end of the wall you are starting on.
2. Set Laser level vertical and 22.75" from the starting point.
3. Test fit panel prior to removing adhesive (especially if you have made in trimming cuts).
4. Remove adhesive backing.
5. Set vertical corner edge on laser line, then lay panel flat applying even pressure across entire surface¹

Subsequent panels can be set based on the first panel with periodic level checks. Always apply a panel with the corner edge against surfaces using very light pressure. When the panel is in position, simply lay the panel flat with some pressure against the prior panel edge.

Guidance for trimming panels to accommodate obstacles (Outlets, alarms, AV equipment, etc):

We recommend always trimming using the edge of the slat and not cutting in the middle of the backer area (between slats). This will help ensure a straight cut. When cutting a vertical cut, cut from the face of the panel using the above recommendation. When cutting horizontally (across slats, cut from the back of the panel. All cuts should be done making multiple strokes with the blade. Do not try to cut with a sawing effect.

Notes:

¹ We recommend using a J Roller to apply pressure evenly across the panel. Please make sure J rollers are clean and free of adhesive. Our self adhesive is pressure activated.