

FAUCET INSTALLATION STEPS

1. Before installation, make sure there is a hole ($\Phi 35$) on the table top. Refer to draft (A).
2. Put the two inlet pipes of the faucet body through the hole which is on the table top. Make sure the washer is on the body. Refer to draft (B)
3. Put the plastic washer and metal washer on the fixing screw and tighten the fixing nut to fix the faucet on the table top. Refer to draft (C)
4. Use the weight ball to clamp the pull out hose, and tighten with the screw, then put the joint of the pull out hose to the joint of the flexible hose. Refer to draft (D).
5. Connect the angle valve and tighten it by wrench. Close the switch of faucet and open the switch of angle valve, keep pressure for 30 minutes, to check if it leaks at all connections. Refer to draft (E).

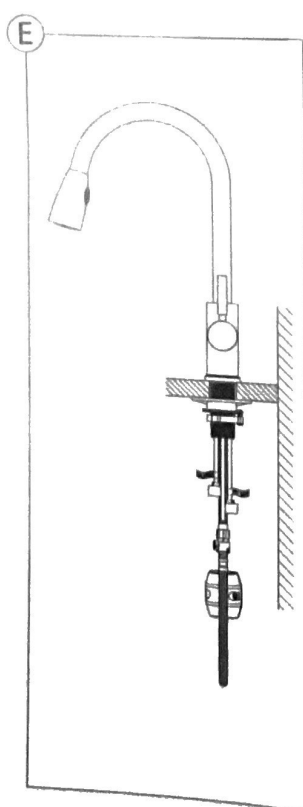
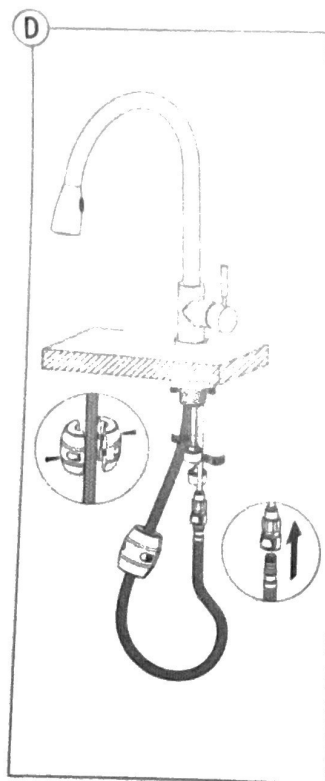
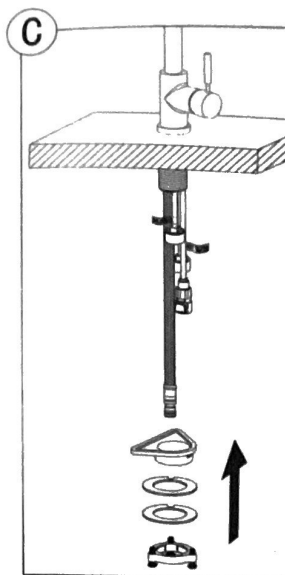
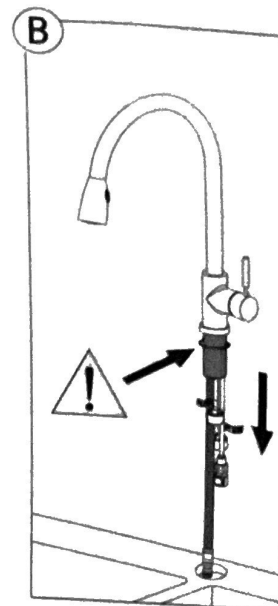
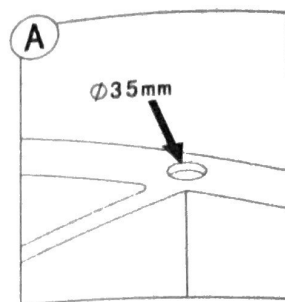

Using explanation

Upturn the handle to open the water.
The larger the angle is, the larger the flow is. Reset is closed.

Turn left the handle, more cold water:
Turn right the handle, more hot water
The spout can be 360 degree rotated.

