



WESTMINSTER

INTERNATIONAL LTD

Telephone : +44 (0)1295 756300

Fax : +44 (0)1295 756302

E-Mail : info@wi-ltd.com

Website : www.wi-ltd.com

WG104 Under Vehicle Inspection System (UVIS)



Using compact video cameras, the WG104 has a slim profile, just ten inches tall which improves the installation time and costs are drastically reduced.

The video technology produces real-time colour imaging. The military-grade, weatherproof design makes the WG104 virtually maintenance-free with no mirrors to clean, replace or adjust.

The WG104 is designed with intuitive on-screen controls so that anybody can become a proficient user less than 30 minutes.

SPECIFICATION

- Additional software features: Accepts bidirectional traffic, inspects vehicles up to 10mph, detailed searchable database
- Camera unit: -30° F to 140° F (-34° C to 60° C)
- Temperature exposure: Control unit: 14° F to 122° F (-10° C to 50° C)
- Warranty: One year manufacturers defect warranty included
- Available Accessories: License Plate Recognition (LPR), extension cable, WG104 field repair kit, vehicle record archive system, monitor upgrades, scene cameras, heater and thermostat system, air debris removal system, extended warranty

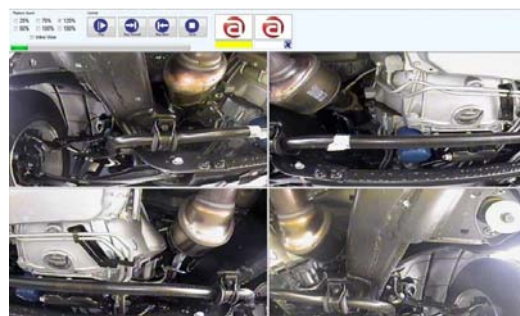

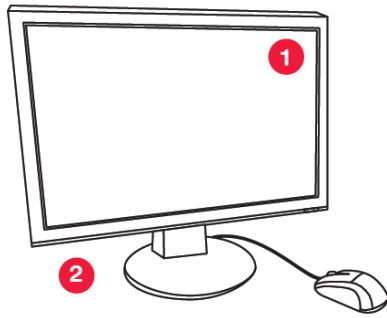

1. On-screen images: Real-time quad-frame display presents views from multiple angles. Easy-to-use on-screen controls allow the operator to pause, rewind, zoom and adjust playback speed. Manual license plate entry enables vehicle tracking and can help identify known threats.
2. Monitor: The 19-inch, LED backlit monitor displays video in 16.7million colours with 1440 x 900 resolution and a 100000:1 contrast ratio for excellent viewing in all lighting conditions.
3. Control unit: Desktop CPU features powerful Intel i5 quad-core processor with 3.2 Ghz and 1GB DDR3 memory for instantaneous imaging. 500Gb HDD storage archives 75,000+ vehicle records.

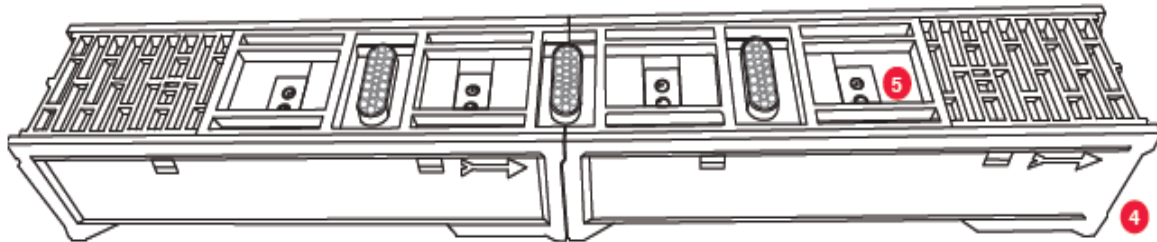

4. In-ground housing: The low-profile housing mounts flush to the road and comes with concrete vault for easier installation. At just 10-inches tall, it requires minimal excavation but supports vehicle loads up to 40,000lbs per axle.
5. Camera: Eight full-colour motion-activated video cameras are individually sealed inside weatherproof aluminium block enclosures and are IP67-rated for extreme conditions. Cameras feature 700-line resolution and use bright-white LED panels, rated for 100,000 hours, for day/night inspections.