

## LED-Steep roof light fitting Series 185...

### Applications:

Industrial, tradesmen's and commercial facilities with extreme conditions, aggressive environments (e.g. oil, grease) or high mechanical exposure, clean rooms, spray booths and spraying rooms (not EX), sand blasting rooms (SSK-versions) etc.

### Design:

**Housing:** Sheet steel, light grey, powder coated (RAL 7035), silicone foam seal

**Safety glass:** Frameless, clear, hinged, tiltable.

**Reflector:** Hinged; white painted sheet steel; detachable, with LED-modules and frosted glare limitation modules.

**Central locking:** Internal, to be opened from outside with 5mm allen key, inner hinges on the opposite side.

**Cable entries:** 3 x M25 (2 cable gland and 2 blanking plugs), looping the cable at one side possible.

### Mechanical installation:

Mounting accessories see spare parts/accessories.

### Technical data:

**LED:** Line-modules 4,000K; CRI>80, ifetime  $L_{90} > 50.000h$  at 25°C ambient temperature, lifetime  $L_{80} > 70,000h$  at max. ambient temperature

**ECG:** 220-240V, 50/60Hz, overload and short circuit protection

**Ambient temperature:** -20°C up to see table of articles

### Options:

- with dimming function via DALI2 interface, compatible with LIMAS Line (DIMD) Light Management System
- for high ambient temperatures
- for wide temperature ranges
- for connection to central or group battery system (ZB) or emergency mains respectively
- in stainless steel, powder coated

### Note:

This light fitting is not suitable for application in areas with permanent high humidity in combination with only short periods of operation, such as sewage or stormwater retention bassins or water treatment plants.

In such cases we recommend the use of our 107... G2 (PRIMO XR) series.

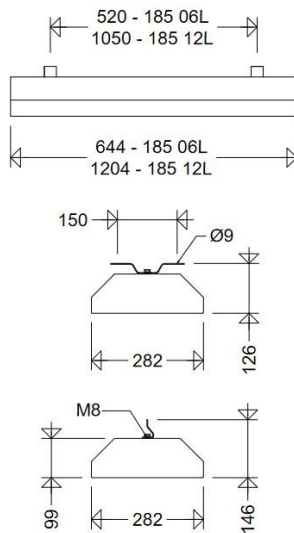
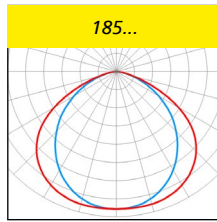

### Product highlights:

- extremely flat and robust design
- smooth housing with all latches inside the housing
- comfortable central locking system with internal hinges
- perfect protection of the LED from mechanical or electrostatic damages through glare limitation elements on top the led
- homogeneous, glarefree Illumination with frosted glare limitation elements, no individual light points visible, comfortable perception of light
- high colour rendering CRI > 80, according to the work place guidelines suitable for nearly all branches
- with V-sign, therefore suitable for application in rooms/locations with increased fire risk due to flammable dusts
- retrofittable Frame for Recessed Installation, Dust protection cover and Swivel Arm Mounting System (modular construction)
- inexpensive cable looping possible
- ECG and reflector with LED-modules replaceable by qualified personnel on-site
- future-proof due to use of standardized LED-modules (Zhaga)
- Suitability for paint booths LABS-tested according to VDMA24364-C2-L



Article no.	Type	Quantity of ECG	Power consumption [W]	Luminous flux [lm]	Luminous efficacy [lm/W]	Ambient temperature max. [°C]	Substitute for ca. *	Weight [kg] without packing material
-------------	------	-----------------	-----------------------	--------------------	--------------------------	-------------------------------	----------------------	--------------------------------------

## 185...



18501 0031	185 06L30	1	22	3.100	141	55	1 x 58W	7,9
18501 0032	185 06L45	1	32	4.660	146	55	2 x 36W	7,9
18501 0033	185 06L60	1	43	6.190	144	45	2 x 58W	7,9
18501 0001	185 12L60	1	43	6.190	144	55	2 x 58W	13,3
18501 0002	185 12L90	2	64	9.310	145	55	3 x 58W	13,8
18501 0003	185 12L120	2	86	12.270	143	45	4 x 58W	13,8

\* The given information is for rough orientation only. In each individual case a lighting calculation is necessary.

Properties, limitations and details for controlling LED-light fittings:

See "Technical Supplement"

All data are correct at the time of printing. Actual technical data can be found under [www.schuch.de](http://www.schuch.de).

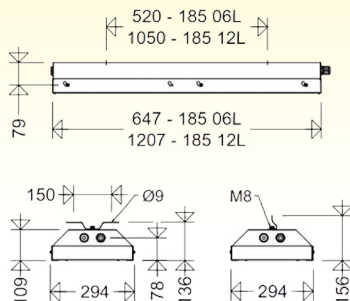
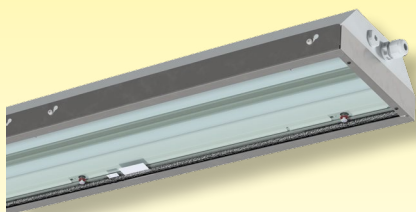

Article no.	Type	Quantity of ECG	Power consumption [W]	Luminous flux [lm]	Luminous efficacy [lm/W]	Ambient temperature max. [°C]	Substitute for ca. *	Weight [kg] without packing material
-------------	------	-----------------	-----------------------	--------------------	--------------------------	-------------------------------	----------------------	--------------------------------------

## 185... SSK



### for blasting rooms and cabins

#### Applications:

Rooms and cabins where blasting material (sand, glass beads, etc.) is used.

#### Design:

As standard version 185..., but: protruding, easily replaceable polycarbonate cover in stainless steel frame to protect the safety glass from damage by blasting material. The replacement interval may differ depending on the blasting material used.

18501 0041	<b>185 06L30 SSK</b>	1	22	3.100	141	55	1 x 58W	9,3
18501 0042	<b>185 06L45 SSK</b>	1	32	4.660	146	55	2 x 36W	9,3
18501 0043	<b>185 06L60 SSK</b>	1	43	6.190	144	45	2 x 58W	9,3
18501 0011	<b>185 12L60 SSK</b>	1	43	6.190	144	55	2 x 58W	16,2
18501 0012	<b>185 12L90 SSK</b>	2	64	9.310	145	55	3 x 58W	16,7
18501 0013	<b>185 12L120 SSK</b>	2	86	12.270	143	45	4 x 58W	16,7

\* The given information is for rough orientation only. In each individual case a lighting calculation is necessary.

### Installation dimensions

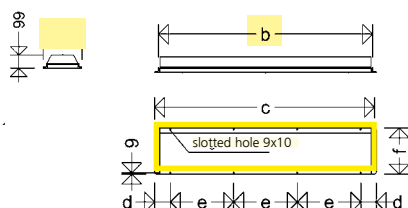

Type	a	b	c	d	e	f
<b>EB 82. 06L</b>	302	660	710	55	300	348
<b>EB 82. 12L</b>	302	1224	1270	125	340	348

## Frame for Recessed Installation

**retrofit possible!**

Light fittings of series 185... can be equipped with a frame even at a later stage.

Mounting by means of M5 bolts to the long sides of the housing (see drawing).

Article No.	Type	
18091 0020	<b>EB 82. 06L</b>	frame for narrow housing for 185 06L
18091 0021	<b>EB 82. 12L</b>	frame for narrow housing for 185 12L

**Attention:** When planning the opening for recess installation please allow additional clearance for the cable glands.

**Attention:** When installing in insulated ceiling and wall cut-outs, the maximum ambient temperature (Tmax) of the luminaire is reduced by 5 °C!

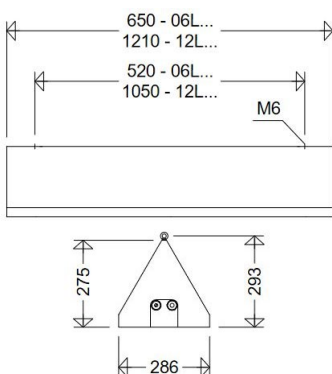

Mounting with RS 6

## Dust protection cover

**retrofit possible!**

Light fittings of series 185... series can be equipped (also retrofitted) with a dust protective cover to prevent dust deposits on the light fitting.

It is fastened to the long sides of the light fitting housing with M5 screws. M6 eyebolts (RS 6 P) are supplied for chain suspension.

Article No.	Type	
18093 0001	<b>SSH 185 06L</b>	dust protection cover for 185 06L
18093 0002	<b>SSH 185 12L</b>	dust protection cover for 185 12L

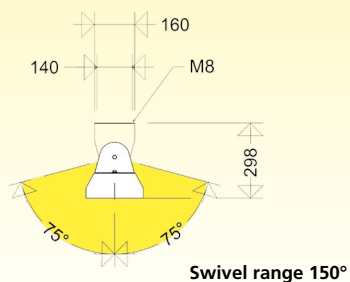
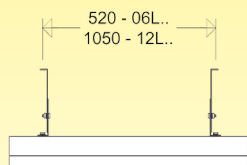

## Swivel Arm Mounting System

**retrofit possible!**

Light fittings of series 185.. can be equipped with a swivel arm mounting system at any time.  
The swivel arms are fixed to the suspen-

sion points at the upper side of the housing. Swivel range:  $\pm 75^\circ$  (see dimensions in diagram).

Article No.	Type	
18092 0001	<b>SWA 181/182</b>	for all lamp lengths, consisting of 2 swivel brackets and screws M8
18092 0002	<b>SWA 181/182E</b>	for all lamp lengths, consisting of 2 swivel brackets and screws M8 stainless steel



### Mounting material

Suspension brackets H8V P



Ceiling brackets 15A P



Wall/ceiling angles WD 45 P



#### Note:

When using the carrier rail TRS 2000 the mounting accessories for TRS 2000 EX should be used (see section „Ex-light fittings“).

## Accessories / Spare Parts

Article No.	Type	
<b>Spare glasses</b>		
82101 9001	<b>821 06L</b>	spare glass for 185 06L
82101 9002	<b>821 12L</b>	spare glass for 185 12L
18090 9027	<b>185 06L PC SSK</b>	PC protective glass (with seal, without longitudinal mounting rail for 185 06L.. SSK
18090 9025	<b>185 12L PC SSK</b>	PC protective glass (with seal, without longitudinal mounting rail for 185 12L.. SSK
<b>Cable entries/cable glands</b>		
25600 9000	<b>2560</b>	plastic cable gland M25 x 1,5
25720 9000	<b>2572</b>	threaded blanking plug M25 x 1,5
<b>Mounting material</b>		
90019 0002	<b>RS 6 P</b>	2 eyebolts M6, galvanized steel
90001 0002	<b>H8V P</b>	2 suspension eyes, stainless steel
90000 0002	<b>15A P</b>	2 ceiling brackets, hot galvanized steel
90032 0002	<b>15AV P</b>	2 ceiling brackets, stainless steel
26000 0005	<b>WD 45 P</b>	2 wall/ceiling angle 45°, steel
26000 0006	<b>WD 45 VP</b>	2 wall/ceiling angle 45°, stainless steel (blasted)