

SIMPLE CREDENZAS ON GLIDES

Designer – Nienkämper

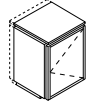

Model Number	Cabinet Finish	Top Finish	L"	X	D"	X	H"	List Price
* 36101/2	Wood	Wood	23³/₈	20	34¹/₄			3,020
36101/3	Paint	Wood						2,710
* 36101/5	Wood	Laminate						2,870
36101/4	Paint	Laminate						2,585



Frosted Glass Doors - Add "/G" to model # and \$75 to price.

* 36111/2	Wood	Wood	23³/₈	25¹/₈	34¹/₄			3,440
36111/3	Paint	Wood						3,080
* 36111/5	Wood	Laminate						3,255
36111/4	Paint	Laminate						2,930

Frosted Glass Doors - Add "/G" to model # and \$75 to price.

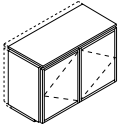

* 36102/2	Wood	Wood	47¹/₄	20	34¹/₄			4,005
36102/3	Paint	Wood						3,595
* 36102/5	Wood	Laminate						3,800
36102/4	Paint	Laminate						3,440

Frosted Glass Doors - Add "/G" to model # and \$150 to price.

* 36112/2	Wood	Wood	47¹/₄	25¹/₈	34¹/₄			4,540
36112/3	Paint	Wood						4,080
* 36112/5	Wood	Laminate						4,320
36112/4	Paint	Laminate						3,895

Frosted Glass Doors - Add "/G" to model # and \$150 to price.

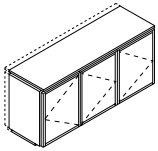

* 36103/2	Wood	Wood	70³/₈	20	34¹/₄			5,605
36103/3	Paint	Wood						5,050
* 36103/5	Wood	Laminate						5,325
36103/4	Paint	Laminate						4,795

Frosted Glass Doors - Add "/G" to model # and \$225 to price.

* 36113/2	Wood	Wood	70³/₈	25¹/₈	34¹/₄			6,360
36113/3	Paint	Wood						5,735
* 36113/5	Wood	Laminate						6,040
36113/4	Paint	Laminate						5,440

Frosted Glass Doors - Add "/G" to model # and \$225 to price.

* Cabinet in 1 piece. Top in 1 piece.

SIMPLE credenzas are available in two standard depths 20" and 25¹/₈".

Standard finish options are selected by model number:

- Wood case with wood top
- Paint case with wood top
- Wood case with laminate top
- Paint case with laminate top

Doors have chrome pull as standard.

Cabinets are built in sections not exceeding three pedestal widths with tops shipped separately. Tops longer than 118" in length are made in two pieces.

To enhance the function of your credenza a range of optional interiors can be selected from the Vox Planning Guide.

Refrigerators and Equipment racking are not available in 20" deep credenzas.

Standard features:

- One adjustable shelf per opening
- Self edge on four sides
- Single pedestal interior dimension:
25³/₈" deep 22"w x 23¹/₂"d x 30⁵/₈"
20" deep 22"w x 18¹/₈"d x 30⁵/₈"

Model # 36104/2

SIMPLE four pedestal credenza with Natural Cherry finish.



SIMPLE CREDENZAS ON GLIDES

Designer – Nienkämper



Self Edge (SE)

Model Number	Cabinet Finish	Top Finish	L"	X	D"	X	H"	List Price
--------------	----------------	------------	----	---	----	---	----	------------

Product Description

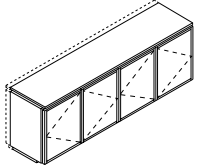

**	36104/2	Wood	Wood	94½	20	34¼		6,585
	36104/3	Paint	Wood					5,930
	36104/5	Wood	Laminate					6,265
	36104/4	Paint	Laminate					5,640

Frosted Glass Doors - Add "/G" to model # and \$300 to price.

**	36114/2	Wood	Wood	94½	25½	34¼		7,485
	36114/3	Paint	Wood					6,730
	36114/5	Wood	Laminate					7,110
	36114/4	Paint	Laminate					6,390

Frosted Glass Doors - Add "/G" to model # and \$300 to price.

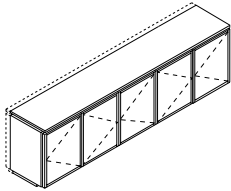

**	36105/2	Wood	Wood	118½	20	34¼		7,920
	36105/3	Paint	Wood					7,135
	36105/5	Wood	Laminate					7,430
	36105/4	Paint	Laminate					6,775

Frosted Glass Doors - Add "/G" to model # and \$375 to price.

**	36115/2	Wood	Wood	118½	25½	34¼		9,000
	36115/3	Paint	Wood					8,105
	36115/5	Wood	Laminate					8,550
	36115/4	Paint	Laminate					7,690

Frosted Glass Doors - Add "/G" to model # and \$375 to price.

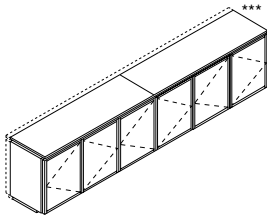

***	36106/2	Wood	Wood	141¼	20	34¼		9,170
	36106/3	Paint	Wood					8,255
	36106/5	Wood	Laminate					8,725
	36106/4	Paint	Laminate					7,845

Frosted Glass Doors - Add "/G" to model # and \$450 to price.

***	36116/2	Wood	Wood	141¼	25½	34¼		10,415
	36116/3	Paint	Wood					9,375
	36116/5	Wood	Laminate					9,895
	36116/4	Paint	Laminate					8,915

Frosted Glass Doors - Add "/G" to model # and \$450 to price.

** Cabinet in 2 piece. Top in 1 piece.

*** Cabinet in 3 pieces. Top in 2 piece.

SIMPLE credenzas are available in two standard depths 20" and 25½".

Standard finish options are selected by model number:

- Wood case with wood top
- Paint case with wood top
- Wood case with laminate top
- Paint case with laminate top

Doors have chrome pull as standard.

Cabinets are built in sections not exceeding three pedestal widths with tops shipped separately. Tops longer than 118" in length are made in two pieces.

To enhance the function of your credenza a range of optional interiors can be selected from the Vox Planning Guide.

Refrigerators and Equipment racking 270-271 are not available in 20" deep credenzas.

Standard features:

- One adjustable shelf per opening
- Self edge on four sides
- Single pedestal interior dimension:
25¾" deep 22"w x 23½"d x 30 5/8"
20" deep 22"w x 18½"d x 30 5/8"

Model # 36104/2
SIMPLE four pedestal credenza with
Natural Cherry finish.



SIMPLE CREDENZAS ON GLIDES WITH MEDIA LIFT

Designer – Nienkämper



Self Edge (SE)

Model Number	Cabinet Finish	Top Finish	L" X D" X H"	List Price	Product Description
--------------	----------------	------------	--------------	------------	---------------------

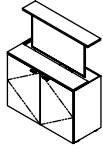

* 36107/2	Wood	Wood	47½" X 20" X 29"	11,820	
36107/3	Paint	Wood		11,325	
* 36107/5	Wood	Laminate		11,565	
36107/4	Paint	Laminate		11,125	

* 36117/2	Wood	Wood	47½" X 25⅝" X 29"	12,450	
36117/3	Paint	Wood		11,910	
* 36117/5	Wood	Laminate		12,270	
36117/4	Paint	Laminate		11,680	

SIMPLE credenzas with Media Lift are available in two standard depths 20" and 25⅝".

Standard finish options are selected by model number:

- Wood case with wood top
- Paint case with wood top
- Wood case with laminate top
- Paint case with laminate top
- All models with finished back.

Media lift can swivel 180 degrees. The maximum TV size it can accommodate is 43". The TV dimension not to exceed 42"w x 25 ¼"h x 4 ½"d.

TV is not included in list price.

Media Lift can accommodate a larger size TV without swivel option.

Media lift can also be installed on Vox credenzas, please contact customer service at 1 800 668 9318 for pricing.

Doors have chrome pull as standard with Media Lift installed at the centre pedestals.

To enhance the function of your credenza a range of optional interiors can be selected from the Vox Planning Guide.

Refrigerators and Equipment racking are not available in 20" deep credenzas.

Standard features:

- One adjustable shelf per opening for single pedestal
- Two narrow adjustable shelves in front of Media Lift centre pedestals
- Self edge on four sides
- Single pedestal interior dimension:
25 ⅜" deep 22"w x 23½"d x 30 ⅝"
20" deep 22"w x 18⅝"d x 30"

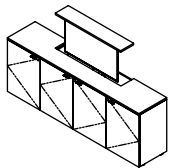

** 36108/2	Wood	Wood	94½" X 20" X 29"	14,925	
36108/3	Paint	Wood		14,135	
* 36108/5	Wood	Laminate		14,525	
36108/4	Paint	Laminate		13,770	

** 36118/2	Wood	Wood	94½" X 25⅝" X 29"	15,980	
36118/3	Paint	Wood		15,080	
* 36118/5	Wood	Laminate		15,535	
36118/4	Paint	Laminate		14,685	

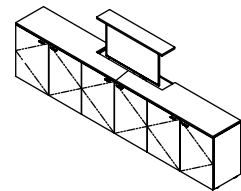

*** 36109/2	Wood	Wood	141¼" X 20" X 29"	18,010	
36109/3	Paint	Wood		16,925	
* 36109/5	Wood	Laminate		17,470	
36109/4	Paint	Laminate		16,425	

*** 36119/2	Wood	Wood	141¼" X 25⅝" X 29"	19,510	
36119/3	Paint	Wood		18,260	
* 36119/5	Wood	Laminate		19,360	
36119/4	Paint	Laminate		17,710	

Model # 36108/4

SIMPLE credenza with Media Lift in white P-lam



- * Cabinet in 1 piece. Top in 1 piece.
- ** Cabinet in 3 pieces. Top in 1 piece.
- *** Cabinet in 3 pieces. Top in 2 pieces.