

# Vox<sup>®</sup> Mega FlipTop



**Prices include freight charges, blanket wrapped, dock delivered, from the manufacturing source to any location in the contiguous United States. Packing and/or crating are available, if required, upcharges apply.**

## TABLE OF CONTENTS

---

<b>Wood Veneer/Finishes</b>	<b>2</b>
<b>Wood Grain Plastic Laminate Surfaces</b>	<b>3</b>
<b>Coloured Plastic Laminate Surfaces</b>	<b>4</b>
<b>Fingerprint Resistance Plastic Laminate Surfaces</b>	<b>5</b>
<b>Base, Surface &amp; Edge Details</b>	<b>6-7</b>
<b>Connectivity</b>	<b>8</b>
<b>Configuration</b>	<b>9</b>
<b>Vox® Mega Fliptop™ Tables List Price</b>	<b>10</b>
<b>Forums</b>	<b>11-13</b>
<b>Terms and Conditions of Sale</b>	<b>14</b>

All wood surfaces are protected with a durable polyurethane clear laquer which includes UV inhibitor. This finish is known for its exceptional durability, as well as abrasion, chemical, impact and scratch resistance. Standard sheen level is 45 degrees. Optional 5, 10 and 35 degree sheen levels are available on request at no additional cost.

Wood Species	Order Code	Veneer/Stain	Upcharge
Maple	F-01	Natural Maple	No upcharge applies.
	F-02	Natural Curly Maple - Rotary Cut	Add 15%.
	F-03	Natural Bird's Eye Maple - Rotary Cut	Call Customer Service for pricing.
	F-04	Maple Stained Pear	No upcharge applies.
Cherry	F-05	Natural Cherry	No upcharge applies.
	F-06	Standard Cherry	No upcharge applies.
	F-07	Cherry Stained Amber	No upcharge applies.
	F-08	Cherry Stained Auburn	No upcharge applies.
	F-09	Cherry Stained Burgundy	No upcharge applies.
Mahogany	F-10	Light Mahogany	No upcharge applies.
	F-11	Medium Mahogany	No upcharge applies.
	F-12	Dark Mahogany	No upcharge applies.
	F-13	Red Mahogany	No upcharge applies.
Anagre	F-14	Natural Figured Anagre - Qtr. Cut Book-Match	Add 15%.
	F-15	Figured Anagre Stained Amber - Qtr. Cut Book-Match	Add 15%.
Sycamore	F-16	Natural Figured Sycamore - Qtr. Cut Book-Match	Add 15%.
Walnut	F-17	Burnt Walnut	No upcharge applies.
	F-19	Natural Walnut	No upcharge applies.
	F-24	Carbon Grey Walnut	No upcharge applies.
	F-27	Creamy Walnut	No upcharge applies.
	F-28	Tawny Walnut	No upcharge applies.
White Oak	F-18F	Natural White Oak - Flat Cut Book-Match (10° sheen)	No upcharge applies.
	F-18R	Natural White Oak - Rift Cut Slip-Match (10° sheen)	Add 5%
	F-26	Charcoal Ash On Oak - Flat Cut Book-Match (10° sheen)	No upcharge applies.
	F-29	Smokey Oak - Rift Cut Slip-Match (10° sheen)	Add 5%
Sapele – Ribbon Stripe	F-20	Natural Ribbon Strip Sepele - Qtr. Cut Slip-Match	No upcharge applies.
Moabe (Cherry substitute)	F-21	Natural Moabe - Quarter - Qtr. Cut Book-Match	No upcharge applies.
Cape Coast Walnut	F-22	Dark Cape Coast Walnut - Qtr. Cut Slip-Match	No upcharge applies.
	F-23	Natural Cape Coast Walnut - Qtr. Cut Slip-Match	No upcharge applies.
Ash	F-25	Slate Grey Ash - Qtr. Cut Slip-Match	No upcharge applies.

Nienkamper products utilize the best quality veneers available, and, combined with Nienkämper’s patented veneering systems, create work environments of incredible quality and beauty.

All veneer furniture comes standard with flat cut book-match veneer; flat cut slip-match veneer can also be specified. Quarter cut slip-match and quarter cut book-match veneers are available at a 5% upcharge. Figured Anagre and Figured Sycamore veneers are Quarter cut book-matched. Bird’s Eye Maple and Curly Maple are rotary cut.

Self and Taper edge tops with veneer are manufactured with a solid wood edge. All edges are then veneer wrapped to create a seamless profile top.

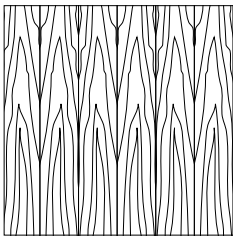

Standard Flat Cut Book-Match V1

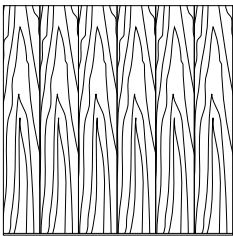

Flat Cut Slip-Match V2

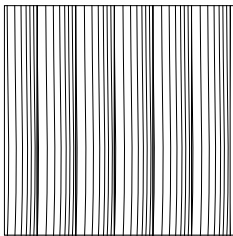

Quarter Cut Slip-Match Add 5% V3

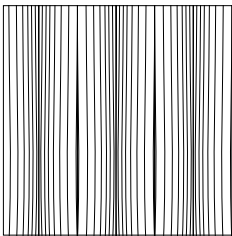

Quarter Cut Book-Match Add 5% V4

## Wood grain plastic laminate surfaces are available on table tops with Facet and Taper edges.

These tops are manufactured with a solid wood edge that is applied prior to the laminate top surface. This method conceals the thickness of the wood edge, while providing the durability required. Wood edges are selected that most closely resemble both the species and the color of the laminate chosen

Nienkämper has pre-selected a number of standard wood grain plastic laminates that represent a cross section of both color and species. Simply include the order code with the model number to make these selections. Alternatively wood grain plastic laminates selected outside of Nienkämper's standard selection can be made by specifying the manufacturer as well as the description and model number of the laminate at the time of order.

Wood Grain Plastic Laminate Surfaces	Order Code	Manufacturer #	Finish
Champagne Sagawood	WL1	Nevamar WM8349T	Textured
Hardrock Maple	WL2	Pionite WM791-SD	Textured/Suede
Amber Curly Maple	WL3	Pionite WM221-SD	Textured/Suede
Anagre	WL4	Pionite WX041	Suede
Monticello Maple	WL5	Wilsonart 7925-38	Fine Velvet Texture
Millwork Cherry	WL7	Pionite WC431	PV-Polished Velvet
Huntington Maple	WL9	Wilsonart 7929-38	Fine Velvet Texture
Wild Cherry	WL10	Formica 5904.43	Artisan
Amber Cherry	WL11	Wilsonart 7919.38	Fine Velvet Texture
Figured Mahogany	WL12	Wilsonart 7040-60	Matte
Fusion Maple	WL13	Wilsonart 7909-78	Fine Grain
New Age Oak	WL14	Wilsonart 7938-78	Fine Grain
Natural Pear	WL15	Wilsonart 7061-78	Fine Grain
Tuscan Walnut	WL16	Wilsonart 7921-78	Fine Grain
Nepal Teak	WL17	Wilsonart 7209-78	Fine Grain
Wild Cherry	WL18	Wilsonart 7054-78	Fine Grain
River Cherry	WL19	Wilsonart 7937-78	Fine Grain
Montana Walnut	WL20	Wilsonart 7110-78	Fine Grain
Windsor Mahogany	WL22	Wilsonart 7039-78	Fine Grain
Williamsburg Cherry	WL23	Wilsonart 7936-78	Fine Grain
Florence Walnut	WL25	Wilsonart 7993-78	Fine Grain
Skyline Walnut	WL26	Wilsonart 7964K-12	Soft Grain
Sterling Ash	WL27	Wilsonart 7995-78	Fine Grain
Ginger Root Maple	WL28	Formica 7288-58	Matt

To specify the wood grain laminate required simply add the Order Code WL\_ to the model number of the product.

Wood grain laminate samples are available from your local sales representative or by calling Nienkämper's customer service department at 1-800-668-9318.

P-LAM

COLOURED P-LAM

Both Taper and Facet edge profiles are available with a colored laminate top.

**Laminate edging on Taper tops.** Edging will match the top surface and is applied prior to the surface laminate. By applying the laminate in this way the seam is positioned horizontally, is much less conspicuous as well as more durable.

**Wood edging** on Facet and Taper Edge tops is applied prior to the laminate. By applying the wood edge in this way the thickness of the wood edge is concealed, while providing the durability required. Wood species and finishes for edging, can be selected from page 4.

For laminates specified outside of Nienkämper’s standard selection, specify the manufacturer as well as the description and model number of the laminate selected at time of order. For Facet edge tops, the laminate must be a post forming grade.

**Translucent edging** on Taper edge tops is applied after the surface laminate. The translucent edge is very durable. Clear translucent edge provides a good match with most white colored laminates, while silver translucent edge provides a metallic look and contrast to colored plastic laminates.



Taper edge in clear translucent with white P-Lam top

Coloured Plastic Laminates Surface	Order Code	Manufacturer #	Finish
Grey (Nienkamper - Light Grey/Putty)	CL-01	Wilsonart 1500-60	Matte
Platinum Gray (Nienkamper - Medium Grey/Clay)	CL-02	Nevamar S6023T	Textured
Slate Grey (Nienkamper - Dark Grey)	CL-03	Wilsonart D91-60	Matte
Black	CL-04	Wilsonart 1595-60	Matte
Angel White	CL-05	Pionite SW-826SD	Textured/Suede
Frosty White	CL-06	Wilsonart 1573-60	Matte
White (for writable surface)	CL-07	Formica 949-90	Gloss

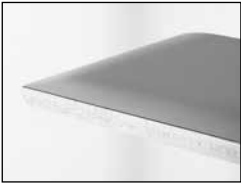
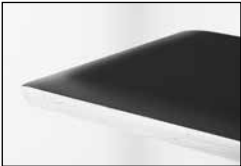

Add the order code behind the edge profile when specifying.

## FINGERPRINT RESISTANCE P-LAM

Fingerprint Resistance Plastic Laminate is an innovative material created for interior design applications and is suitable for both vertical and horizontal interior applications on our nienkamper furniture.

The external surface of Fingerprint Resistance Plastic Laminate involves the use of nanotechnology made possible by next generation acrylic resins.

The unique composition offers extraordinary features coupled with a unique user experience. These include an ultra matte surface (eliminating glare), an ultra sofa feel, an anti-fingerprint surface, thermal healing of micro-scratches, increased durability as well as anti-bacterial and mold-resistant properties.

**Edgeband** with matching color to the Fingerprint Resistance Plastic Laminate is only available on taper edge. For 1" or 1-1/4" thick top with self edge, same Fingerprint Resistance Plastic Laminate can be specified for the self edge or it can be in clear/silver translucent edge.

There is a 10% upcharge on our standard plastic laminate table pricing for Fingerprint Resistance Plastic Laminate.

Colored "Fingerprint Resistance" Plastic Laminate Surface	Order Code	Finish
Black	RL-01	Matte
Gray	RL-02	Matte
Pure White	RL-03	Matte
Sand	RL-04	Matte
Bronze	RL-05	Matte

Edgeband to Match with Colored "Fingerprint Resistance" Plastic Laminate	Order Code
Black	RE-01
Gray	RE-02
Pure White	RE-03
Sand	RE-04
Bronze	RE-05

**VOX® MEGA FLIPTOP**

Looking for a flip top table with a larger top? The Vox® Mega FlipTop™ table provides you a solution. It is easy to move and reconfigure. The tables are ganged together to create an almost seamless conference table.



To configure a boardroom table 240"L x 60"D, you need only 4 Vox® Mega FlipTop™ tables of 60"L x 60"D.

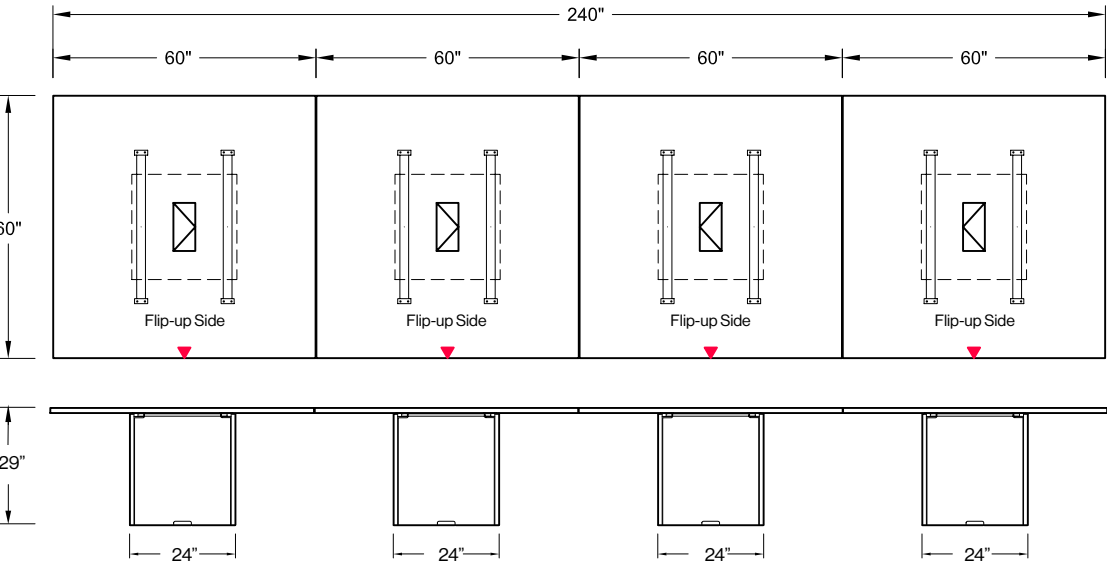

**Top & Base Finishes**

All standard Nienkämper veneer and laminates

**Edge Details**



1/4" thick Self Edge (SE)



# VOX® MEGA FLIPTOP

## Base

Vox® Mega FlipTop™ table is supported by a tapered base which is standard in dimension 24"W x 24"D for all sizes of top. There is a removable panel on the base for easy access of cables inside.



## Surface Shapes & Sizes

Top is 1-1/4" thick and overall height is 29"H.  
Length: 48", 54" & 60"; Depth: 54" & 60"

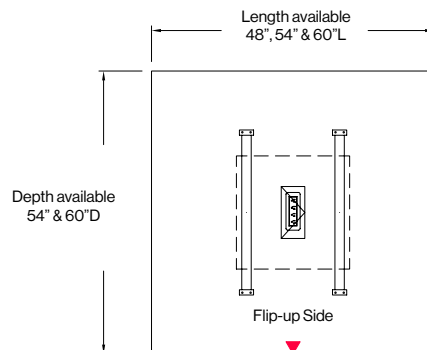

## Elevation

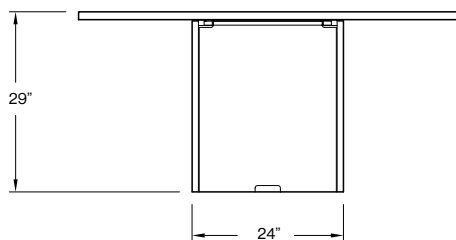

front elevation showing removable panel of the base

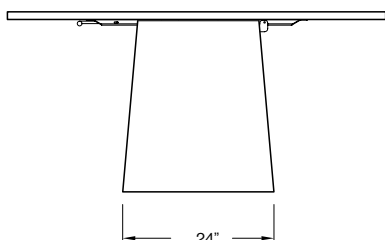

side elevation showing fixed panel of the base

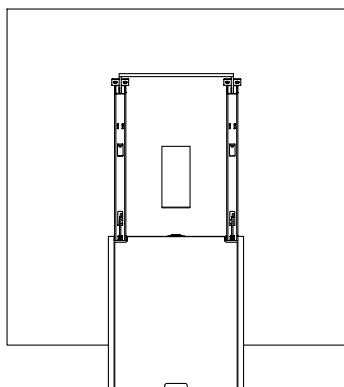

front elevation showing table top flipped up

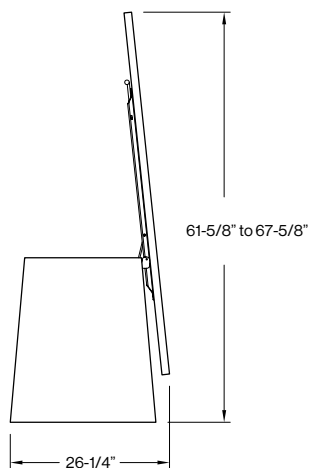

side elevation showing table top flipped up

The 60"W x 60"D Vox® Mega FlipTop™ table has a width of only 27"W when flipped up and will fit through door ways.

Overall height of the table when it is flipped up is 61-5/8"H for 54"D top.

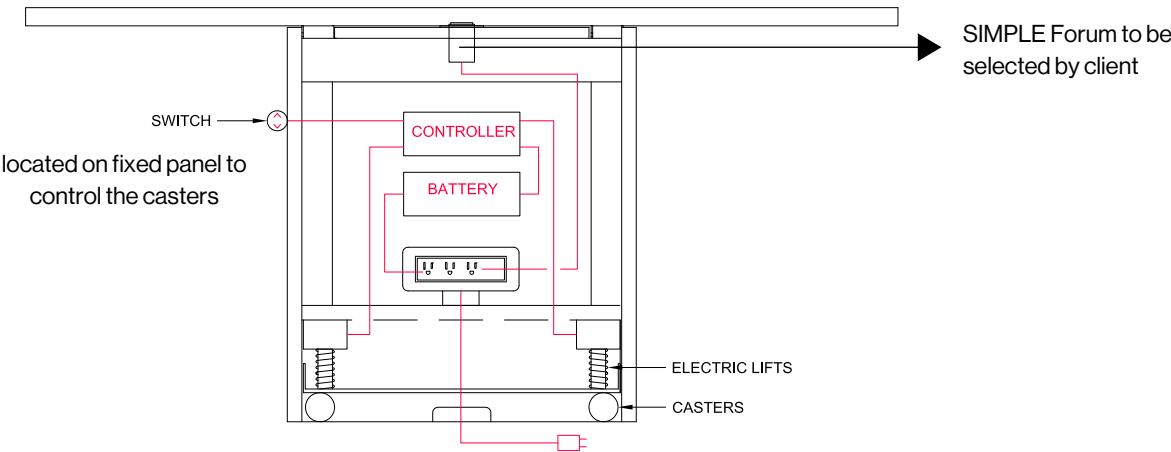

Connectivity



front elevation showing inside of the base

The Vox® Mega FlipTop™ table is standard with a rectangular hinged grommet on the top, available in clear or black anodized aluminum.

Model Number	Dimension	Finish
70840	11" w x 5" d	Clear
		Black anodized aluminum



A SIMPLE Forum (6 port) of your choice can be installed on top of the base, the Forum can be easily accessed from the hinged grommet when the table top is flipped down.

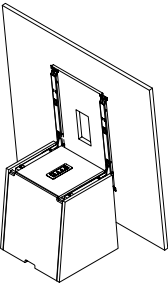

The Vox® Mega FlipTop™ table also comes with a standard SIMPLE Forum (white or black) with three pre wired powers. This forum can power up the battery box of casters' lifting mechanism and the SIMPLE Forum which is located at the top of the base.

## How to reconfigure the Vox® Mega FlipTop™ Table?

Five easy steps:

1. Unlatch the table's integrated ganging mechanism which are always attached to the table and do not require tools to remove.



2. To flip up the top, pull the handle on the underside of the top towards yourself to release the latch. The gas cylinders in the base allows the top to be flipped with one hand.

3. Push the “up” button on the side panel, the 4 swivel casters are raised up so that you can move the table.



4. Once the table is in position, just press the “down” button and the swivel casters will be lowered and the base will sit flush.



5. Lastly, push down the top until you hear a click. The click confirms the top is locked in the down position. Gang the table together with the integrated ganging mechanism.

Note: The electrically operated casters are controlled by a lifting mechanism which is connected with a battery box. Both units can be stored inside the base. Once the battery is charged, it can operate 100 lifts.

VOX® MEGA FLIPTOP

1¼" thick top, overall height 29"H. Base dimension: 24"W x 24"D



Self Edge (SE)

L"	X	D"	Sugg Seat Capacity	Top Finish	Top Sections	Model Number	List Price
48	54	6		Veneer	1	56451/2	14,815
48	54	6		Laminate	1	56451/5	13,820
54	54	8		Veneer	1	56452/2	15,500
54	54	8		Laminate	1	56452/5	14,350
60	54	8		Veneer	1	56453/2	16,020
60	54	8		Laminate	1	56453/5	14,735
48	60	6		Veneer	1	56461/2	15,250
48	60	6		Laminate	1	56461/5	14,155
54	60	8		Veneer	1	56462/2	16,020
54	60	8		Laminate	1	56462/5	14,735
60	60	8		Veneer	1	56463/2	16,920
60	60	8		Laminate	1	56463/5	15,405

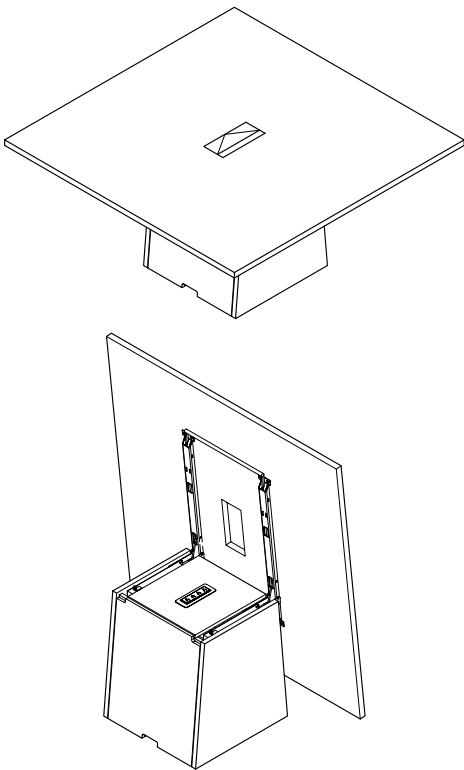

Vox® Mega FlipTop™ Table in walnut veneer with Trench medium back chairs and upholstered arms.

## SIMPLE FORUM – SINGLE SIDED (SURFACE MOUNTED)

List Price

## Pre-configured SIMPLE Forum (6 ports 9¾" L x 2" W)

Model # 39941/5	pre-wired power	<table><tr><td>1P</td><td>1P</td><td>A0</td><td>A0</td><td>B</td><td>B</td></tr></table> <p>2 x pre-wired power with 10ft cord 2 x AMP CAT5E data with 9ft cord 2 x blank plate</p>	1P	1P	A0	A0	B	B	\$695
1P	1P	A0	A0	B	B				
Model # 39941/6	pre-wired power	<table><tr><td>1P</td><td>1P</td><td>A5</td><td>A5</td><td>B</td><td>B</td></tr></table> <p>2 x pre-wired power with 10ft cord 2 x SIEMON CAT6 data with 10ft cord 2 x blank plate</p>	1P	1P	A5	A5	B	B	\$770
1P	1P	A5	A5	B	B				
Model # 39942/5	site-wired power	<table><tr><td>1P-SW</td><td>1P-SW</td><td>A0</td><td>A0</td><td>B</td><td>B</td></tr></table> <p>2 x site-wired power with 6ft metallic shielded cable 2 x AMP CAT5E data with 9ft cord 2 x blank plate</p>	1P-SW	1P-SW	A0	A0	B	B	\$745
1P-SW	1P-SW	A0	A0	B	B				
Model # 39945/5	pre-wired power	<table><tr><td>1P</td><td>1P</td><td>A0</td><td>A0</td><td>HD</td><td>H</td></tr></table> <p>2 x pre-wired power with 10ft cord 2 x AMP CAT5E data with 9ft cord 1 x HDMI coupler with 18" cord 1 x USB port 3.0 with 10ft cord</p>	1P	1P	A0	A0	HD	H	\$870
1P	1P	A0	A0	HD	H				
Model # 39945/6	pre-wired power	<table><tr><td>1P</td><td>1P</td><td>A5</td><td>A5</td><td>HD</td><td>H</td></tr></table> <p>2 x pre-wired power with 10ft cord 2 x SIEMON CAT6 data with 10ft cord 1 x HDMI coupler with 18" cord 1 x USB port 3.0 with 10ft cord</p>	1P	1P	A5	A5	HD	H	\$960
1P	1P	A5	A5	HD	H				
Model # 39947/5	pre-wired power	<table><tr><td>1P</td><td>1P</td><td>1P</td><td>A0</td><td>A0</td><td>A0</td></tr></table> <p>3 x pre-wired power with 10ft cord 3 x AMP CAT5E data with 9ft cord</p>	1P	1P	1P	A0	A0	A0	\$775
1P	1P	1P	A0	A0	A0				
Model # 39947/6	pre-wired power	<table><tr><td>1P</td><td>1P</td><td>1P</td><td>A5</td><td>A5</td><td>A5</td></tr></table> <p>3 x pre-wired power with 10ft cord 3 x SIEMON CAT6 data with 10ft cord</p>	1P	1P	1P	A5	A5	A5	\$915
1P	1P	1P	A5	A5	A5				
Model # 39948/5	site-wired power	<table><tr><td>1P-SW</td><td>1P-SW</td><td>1P-SW</td><td>A0</td><td>A0</td><td>A0</td></tr></table> <p>3 x site-wired power with 6ft metallic shielded cable 3 x AMP CAT5E data with 9ft cord</p>	1P-SW	1P-SW	1P-SW	A0	A0	A0	\$840
1P-SW	1P-SW	1P-SW	A0	A0	A0				

SIMPLE FORUM – SINGLE SIDED (SURFACE MOUNTED)

List Price

Pre-configured SIMPLE Forum (6 ports, for client’s own data fitting)

Model # 39951	pre-wired power	<table><tr><td>1P</td><td>1P</td><td>O</td><td>O</td><td>O</td><td>O</td></tr></table>	1P	1P	O	O	O	O	\$565
1P	1P	O	O	O	O				
2 x pre-wired power with 10ft cord									
4 x open port/data adapter to fit in client's own data fitting and cord									
Model # 39953	pre-wired power	<table><tr><td>1P</td><td>1P</td><td>1P</td><td>O</td><td>O</td><td>O</td></tr></table>	1P	1P	1P	O	O	O	\$585
1P	1P	1P	O	O	O				
3 x pre-wired power with 10ft cord									
3 x open port/data adapter to fit in client's own data fitting and cord									

- Adapter “AA”**  
Systimax/CommScope  
Uniprise/CommScope
- Adapter “BB”**  
L-Com Keystone Modular  
Tyco SL/110 Connect Series Modular Jacks  
Siemon Keystone Style  
Allen Tel Versa Tap Series  
Leviton Quick Port® Series  
Nordx Keystone Style  
Tyco SL Conpler Series

- Adapter “CC”**  
Krone 6000 Series/ADC  
Hubbell Xcelerator™ Keystone Series
- Adapter “DD”**  
blank
- Adapter “EE”**  
Ortronics TracJack Series

- Adapter “FF”**  
Panduit Mini-Com Series
- Adapter “GG”**  
microphone jack / 3pin XLR, solder type only
- Adapter “HH”**  
Adapter “HH” - video monitor jack / DB-15, pand mount solder type.

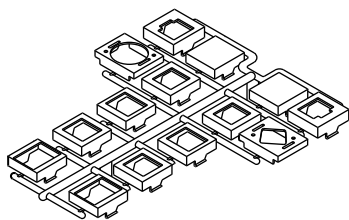

• Snap in fitting adapters are also provide for 3-pin XLR microphone jack (solder type only) and DB-15 video monitor jack (panel mount solder style only)

Configure your own SIMPLE Forum by selecting a base model and require elements.

CUSTOM SIMPLE FORUM		LIST PRICE
<div><div></div></div>		\$335
CX6- _____		
 Side 1		LIST PRICE
Select the elements as per below:		
<div></div>	S-1P - 1 power receptacle with 10' white cord	\$135
<div></div>	S-1P-SW - 1 power receptacle hard wired with a 6' whip	\$155
<div></div>	A0- AMP CAT5E data fitting with 9' connector cable	\$150
	A5 - SIEMON CAT 6 data fitting with 10' connector cable	\$170
<div></div>	C - Audio- 3.5mm Mini stereo Jack with 10' cord	\$85
<div></div>	H - USB port 3.0 with 10ft cord	\$125
<div></div>	2U - Stacked USB charger A+C	\$160
<div></div>	G - DB15HD, VGA connector, 10' cord	\$185
<div></div>	HD - HDMI Coupler with 18" cord	\$185
<div></div>	B - Blank plate	\$60
<div></div>	O - Open port, for client's own data fitting. Each port selected will be supplied with one set of data adapter kit	\$60
<div></div>	L - Belay 1" dia. hole opening rubber strain relief pass through cords	\$60

# TERMS AND CONDITIONS OF SALE

---

## PRICES

All prices are list prices, freight included, blanket-wrapped, dock delivered, from the manufacturing source to any location in the contiguous United States.

Brokerage is paid by Nienkämper for product shipped to the United States.

Due to existing conditions in regard to cost of labor and materials, we reserve the right to change prices without notice.

## TERMS

Net 30 days from date of invoice to accredited buyers. Two per cent (2%) interest charged monthly on overdue accounts. Deposit of 50% is required with order. Terms will be established upon credit evaluation. Due to delays in processing references, first orders may be treated as C.B.D. orders.

## ORDER CONFIRMATION

Orders are accepted upon issuance of our order confirmation and are subject to the terms set forth therein; notwithstanding any variance from the terms of the buyer's order form.

Nienkämper is not liable for any delay or failure to deliver caused by labor or transportation difficulties, accidents, acts of God, failure of sources of supply, or other causes beyond our control, and changes will affect the delivery date.

## CHANGE OF ORDERS OR CANCELLATIONS

Changes or cancellations are subject to our ability to conform. A charge will be levied against canceled or changed orders based on costs already incurred by Nienkämper. All changes must be in writing and submitted on a revised purchase order. Changes will affect the delivery date.

## STORAGE

If goods cannot be accepted when ready, we may transfer them to storage (which is to be deemed as delivery for invoice purposes). The customer accepts risks and will be charged at prevailing rates.

## FREIGHT

Prices include freight charges, blanket-wrapped, dock delivered, from the manufacturing source to any location in the contiguous United States. Packing and/or crating are available, if required, upcharges apply.

## CLAIMS

All furniture is given to the carrier and signed for in good condition. It is the responsibility of the receiver to sign for the goods in the presence of the carrier and note the condition in which they are received. Freight claims should be filed with the carrier.

## WARRANTY

There are no express or implied warranties, conditions and obligations of the manufacturer, whether statutory or otherwise that extend beyond the description on the face hereof. Our furniture is made to the highest standard and is warranted free from defects of material and workmanship for five years from the date of delivery. During the warranty period we will repair or replace such merchandise as shall prove to be defective, during normal usage in accordance with manufacturer's specifications. The manufacturer shall not be liable for defect wholly attributable to normal manufacturing process. Replacement or repair of the Product shall be the sole remedy of the Customer, and the manufacturer shall not be liable for any direct, indirect, incidental, or consequential loss or damage suffered by the Customer by reason of any defect in workmanship or manufacture of the Product or inability to use the Product. Moreover, this warranty does not cover accidental damage, abuse, alteration, ordinary wear and tear of Goods, negligence and misuse nor variations over which we have no control such as heat or humidity or damage to which the Goods are connected that is not attributable to the failure of the goods themselves. This warranty is null and void when the product is installed with hardware other than that supplied and/or when installed differently than recommended in the installation guide. Modification to the product or hardware may result in failure of the product and cause damage and/or injury.

## WOOD FINISHES

Nienkämper offers a wide variety of standard light finishes on cherry, mahogany and figured anagré wood veneers, and a clear natural finish on figured anagré, figured sycamore, maple, bird's eye maple and curly maple.

Light finishes do not mask the grain and other characteristics of each wood species. It is important to understand that pieces of the same type of wood will not look identical when a light finish is used. The appearance of the finish will also depend on the natural color of the veneer. Cherry darkens over time as the wood ages. Pin knots and gum pockets are inherent traits.

Wood is a naturally variable raw material; its variances are not within the furniture manufacturer's control and are therefore not considered defects under this warranty.



