

# SP Central Point of Sale Package (Single or Double Drawer)



## Features and Benefits

- Maximizes staff and workflow efficiency
- Auto-prompts key forms and requests during sales process
- Minimizes revenue loss

SP Central's Point of Sale Package allows a pharmacy to operate the point of sale application from any ScriptPro workstation. The net result is maximized operator and workspace efficiency. Point of Sale Package brings ScriptPro's robust, ergonomic workstations to every work area in your store.

Point of Sale provides automatic prompts for form, third party, and credit card signatures, along with counseling requests during the sales process. You scan one batch barcode to ring up all prescriptions for a patient – ensuring no revenue loss on unscanned prescriptions. Point of Sale also supports OTC purchases and defaults for patient discounts and payment preferences.



## About ScriptPro

We create innovative, seamlessly-integrated robotics and workflow systems that optimize pharmacy services. As patient care progresses from inpatient to outpatient and long-term care settings, the need for advanced systems to support medication therapy is evolving. Our solutions include strategic planning and financial management services that help health systems succeed in a dynamic and financially challenging environment.

# SP Central Point of Sale Package (Single or Double Drawer)



## Specifications\*

### Point of Sale Package:

- A. Customer Display: 0.85 lb (0.39 kg)
- B. Receipt Printer: 13.7 lbs (6.2 kg)
- C. Cash Drawer:
  - 1. Single Drawer: 25.3 lbs (11.5 kg)
  - 2. Double Drawer: 50.6 lbs (23 kg)

**Electrical Input:** 100-240 VAC, 50/60 Hz, 1.6 AMP 1 Phase. Outlet located within 5 feet (1.5m) of power connection.

**Computer/Software:** Client on ScriptPro-installed network server; Pentium Single Processor Server PC. TCP/IP socket connections; Windows Operating System. Requires SP Datapoint, SP Checkpoint, or SP Station. Receipt Printer may be installed on an SP workstation without a till.

### Temperatures:

- Operating: 41°F to 86°F (5°C to 30°C)
- Storage: 5°F to 104°F (-15°C to 40°C)
- Dissipated Heat: 1,000 BTU/Hr max

**Customer Display:** 20 column 2 line character size; 3.5 mm x 5.0 mm PITCH; Vacuum fluorescent/green.

**Receipt Printer:** Thermal line printing; prints 170 mm/sec or 53.5 lines/sec; 9 x 17 font; 56/42 column capacity. Slip printing 5.14 lines/sec; 40 column capacity.

### Cash Drawer:

- C.1. Single Drawer: 5 bill storage compartments; 5 coin storage compartments; media storage lockable; optional under counter mount.
- C.2. Double Drawer: 10 bill storage compartments; 10 coin storage compartments; media storage lockable.

**Supported Platforms:** SP Central Pharmacy Management System

### A. & B. Customer Display and Receipt Printer

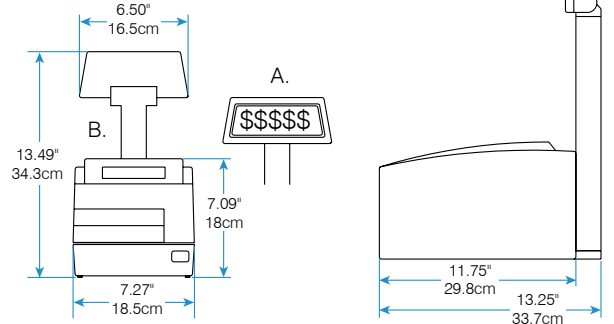

### C. Cash Drawer

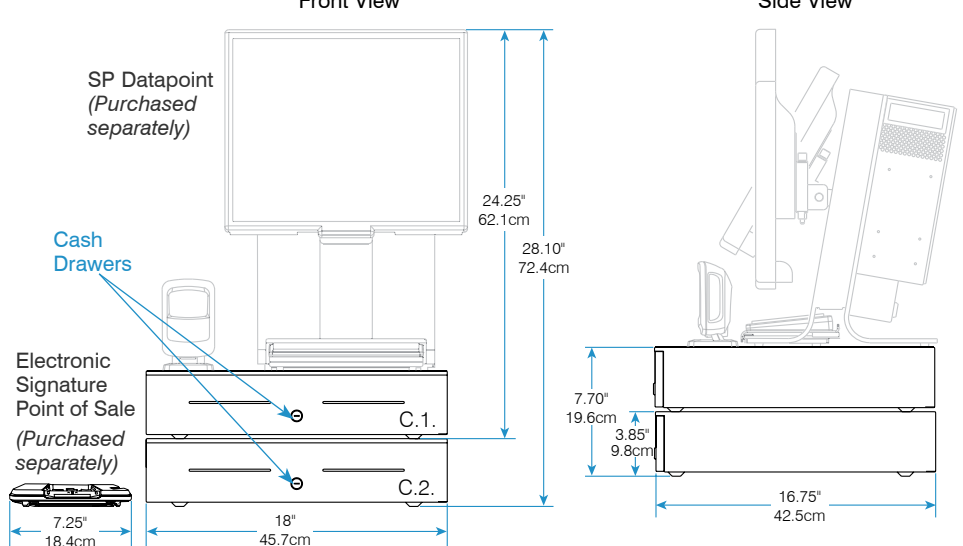

### Top View

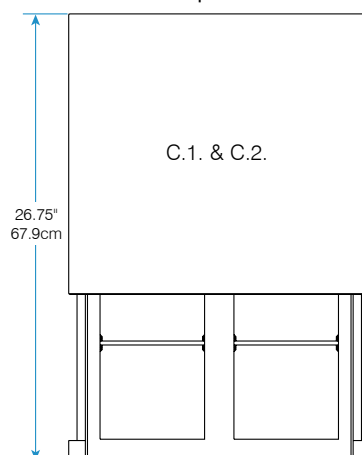

### Storage Till Top View

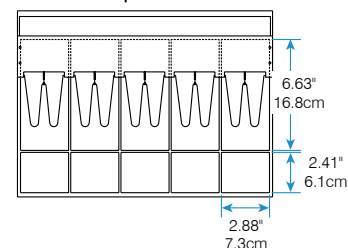

\*Specifications subject to change without notice.