

NEURO HiTRONIC

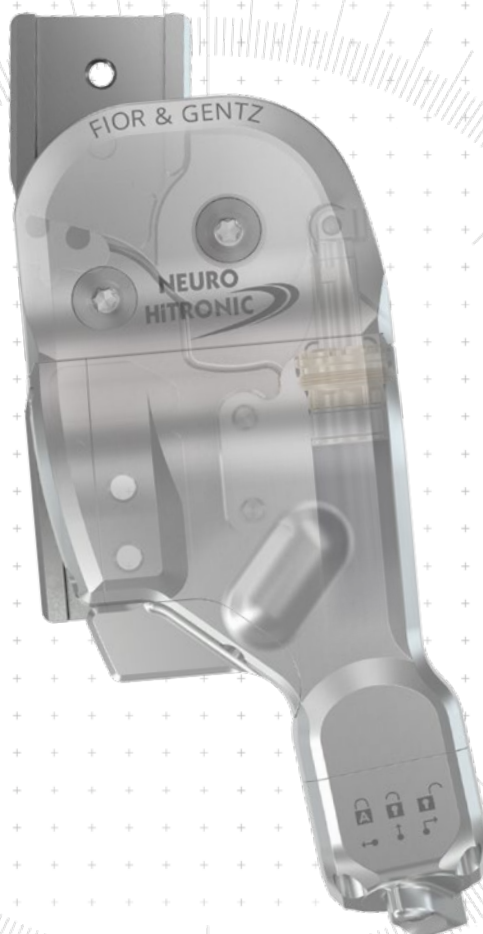

Bluetooth® and Apps

Via Bluetooth®, you can easily connect the controller to the remote control, the Expert app (for orthotists) and the User app (for patients).



The Expert app is required to put the orthosis into operation and to adjust it. The app must be activated once via the login area of the FIOR & GENTZ website.

The User app operates the orthosis. It is available as a complement to the remote control.



*The Bluetooth® word mark and logos are registered trademarks of Bluetooth SIG, Inc. and any use of such marks by FIOR & GENTZ is under license.

Main Function



monocentric, automatic stance phase control with posterior offset
- preassembled in 5° flexion

Activation

electrohydraulic locking and unlocking via motion sensors

Type of Extension Stop



static extension stop

Adjustment Options

flexion angle can be adjusted as required (0°, 10°) by exchanging the extension stop/the flexion stop disc

Other Functions

mode change via remote control or apps

basic function in
Auto mode

- locked in stance phase, free moving in swing phase
- range of motion in extension can be limited as required by exchanging the extension stop/the flexion stop disc (swing phase)
- flexion angle can be adjusted as required by exchanging the extension stop/the flexion stop disc (stance phase)

alternative function in
Lock mode

- permanently mechanically locked via remote control/apps

alternative function in
Free mode

- permanently mechanically unlocked via rotary switch under the system joint or electromechanically via remote control/apps



To produce an orthosis with a NEURO HITRONIC system knee joint, you need the following components:

- system knee joint (page F30.4)
- component set (page F30.7)
- tool set, incl. lamination dummy for the controller and shaping dummy (page F30.9f.)
- system side bars/anchors (page J1ff.)
- Expert app
- User app (optional for the patient)



20mm

Joint Dimensions [mm]

Dimension	Description	System Width a 20mm
b	joint head width	68
c	joint height	146
d	posterior offset	20
e	distance pivot point – lower system case	32
f	distance pivot point – upper system case	8
	joint thickness	34.5

Joint Weights [g]

Material	Unit	System Width 20mm
titanium	piece	342

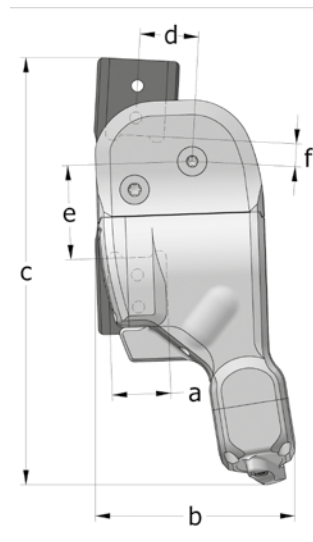

The NEURO HiTRONIC system knee joint is delivered with the following articles:

AGOMET® F330, 5g
 orthosis joint grease, 3g
 assembly/lamination dummy

- ➔ Please order the component set, the lamination dummy for the controller, the shaping dummy and the system side bars/anchors separately.
- ➔ You will find the component set on catalogue page F30.7.
- ➔ You will find the remote control for the patient on catalogue page F30.7.
- ➔ You will find the lamination dummy for the controller on catalogue page F30.10.
- ➔ You will find the shaping dummy on catalogue page F30.9.
- ➔ You will find system side bars/anchors on catalogue page I1ff.

Note: the Expert app is required to put an orthosis with a NEURO HiTRONIC system knee joint into operation and to adjust it. The app must be activated once via the login area of the FIOR & GENTZ website. You can download the Expert app for any number of smartphones/tablets for Android and iOS and use it to adjust the orthosis. The User app is available to patients to complement their remote control and can be operated via their smartphone/tablet or their Apple Watch*.

* Apple Watch is a trademark of Apple Inc., registered in the U.S. and other countries.



straight
fig. 1

Straight (Fig. 1)			
Material	Leg Side	Unit	Article Number for System Width
			20mm
titanium	left lateral or right medial	piece	SL3055-L/TI
	left medial or right lateral	piece	SL3055-R/TI

Spare Parts

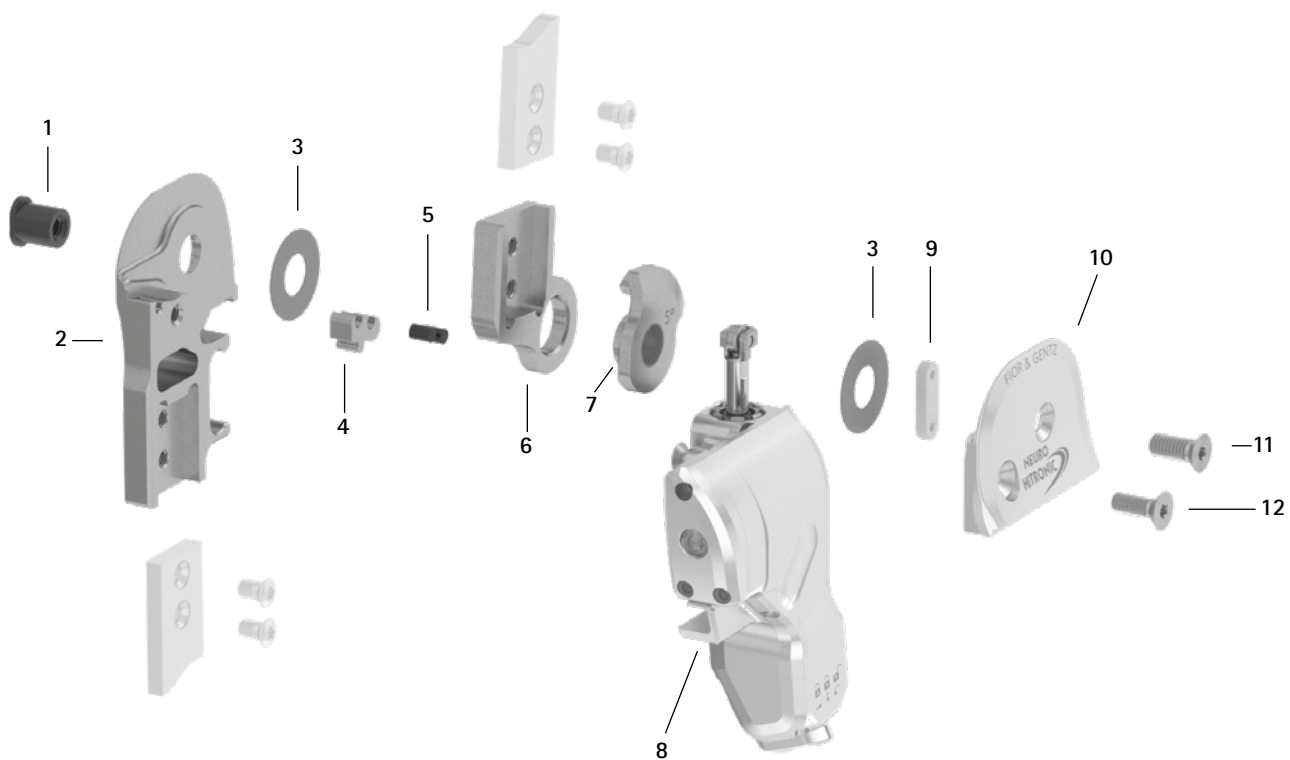

5° Flexion Stop Disc with Sliding Bushing, Preassembled (7)

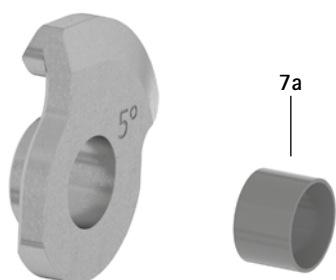

Functional Unit, Preassembled (8)



Spare Parts		
Item	Article Number for System Width 20mm	Description
1	SB1069-L1110	bearing nut
2	SL0315-L/TI	lower part, left lateral, straight, titanium
2	SL0315-R/TI	lower part, right lateral, straight, titanium
3	GS2411-*	sliding washer*
4	SL9005-E005	5° extension stop
5	PN1000-L05/5	extension stop damper
6	SL0305-L/TI	upper part, left lateral, straight, titanium
6	SL0305-R/TI	upper part, right lateral, straight, titanium
7	SL0365-2L	5° flexion stop disc with sliding bushing
7	SL0365-2R	5° flexion stop disc with sliding bushing
7a	BP1211-L077	sliding bushing
8	SL3955-L	functional unit, left lateral
8	SL3955-R	functional unit, right lateral
8a	SL0355-11	roll unit
8b	SL0355-12	air filter
8c	SL0355-16/L	cable cover, left lateral
8c	SL0355-16/R	cable cover, right lateral
8d	SC1403-L08/1	raised countersunk head screw with hexalobular socket
9	SL0355-01	guide piece
10	SL0355-L/AL	cover plate, left lateral
10	SL0355-R/AL	cover plate, right lateral
11	SC1406-L14	countersunk flat head screw with hexalobular socket (axle screw)
12	SC1405-L14	countersunk flat head screw with hexalobular socket

* Sliding Washers

Article Number for System Width 20mm
Ø = 24mm
GS2411-040
GS2411-045
GS2411-050
GS2411-055
GS2411-060

The last three digits of the article number stand for the thickness of the sliding washer, e.g. GS2411-040. The thickness of this sliding washer is 0.40mm. In total, the sliding washers are available in five different thicknesses. The thickness of a sliding washer is indicated by the markings. For example, a sliding washer with two notches is 0.40mm thick, whereas a sliding washer with one notch is 0.55mm thick.

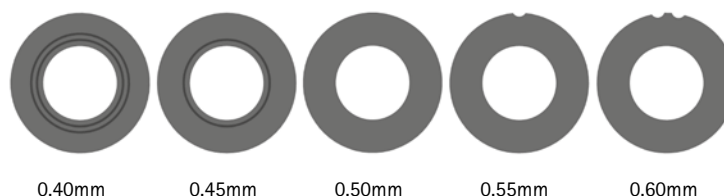

➔ You will find system side bars and system anchors on catalogue page 11ff.

Component Set (with Bluetooth and Integrated Lithium-Polymer Battery, 1)

Item	Article Number for System Width 20mm	Description	Unit	Quantity Unilateral
1	SL3850-LR	component set, unilateral	set	1
1a-1f	SL3850-S	controller set	set	1
1g-1l	SK3850-P	remote control set	set	1
1m-1s	SL3005-6M	maintenance set*	set	1
w/o fig.	OB1000-XL	cloth bag for orthoses with logo	piece	1

* The maintenance set for the first maintenance after 6 months is included in the scope of delivery of the component set.

Controller Set (1a-1f)

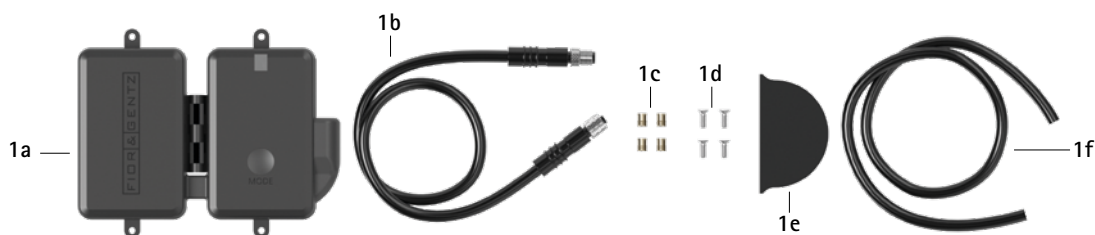

Controller Set

Item	Article Number for System Width 20mm	Description	Unit	Quantity Unilateral
1a-1f	SL3850-S	controller set	set	1
1a	ET3850	controller with Bluetooth with lithium-polymer battery	piece	1
1b	ET0711-01	connection cable for functional unit, 300mm	piece	1
1c	VE0831-A3**	thread insert**	piece	4
1d	SC1302-L06**	countersunk flat head screw, cross recessed H**	piece	4
1e	ET0971-1	lamination dummy for cable length compensation	piece	1
1f	SL0935-14	lamination dummy for connection cable, 190mm	piece	1

** required for mounting the controller

Remote Control Set (1g-1l)



Remote Control Set

Item	Article Number for System Width 20mm	Description	Unit	Quantity Unilateral
1g-1l	SK3850-P	remote control set	set	1
1g	ET3840-P	remote control with Bluetooth for the patient	piece	1
1h	ET0780	adapter	piece	1
1i	ET0710-01	charging cable	piece	1
1j	PR4000	lanyard FIOR & GENTZ	piece	1
1k	HE3800-SK/L	letter sticker L for remote control, left leg	piece	1
1l	HE3800-SK/R	letter sticker R for remote control, right leg	piece	1

Maintenance Set (1m–1s)

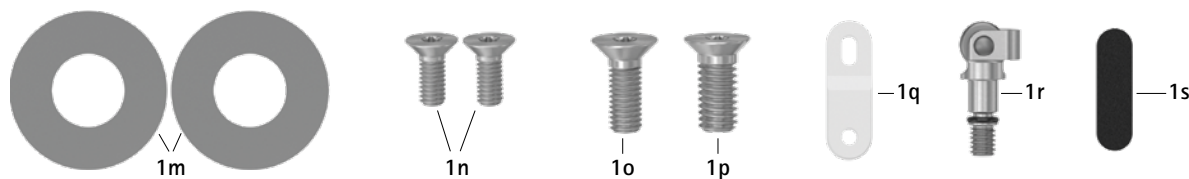

Maintenance Set

Item	Article Number for System Width 20mm	Description	Unit	Quantity Unilateral
1m-1s	SL3005-6M	maintenance set	set	1
1m	GS2411-***	sliding washer***	piece	2
1n	SC1404-L10	countersunk flat head screw with hexalobular socket	piece	2
1o	SC1405-L14	countersunk flat head screw with hexalobular socket	piece	1
1p	SC1406-L14	countersunk flat head screw with hexalobular socket (axle screw)	piece	1
1q	SL0355-01	guide piece	piece	1
1r	SL0355-11	roll unit	piece	1
1s	SL0355-12	air filter	piece	1

*** You will find the article numbers of the sliding washers on catalogue page F30.6.

Extension Stops (2–3)

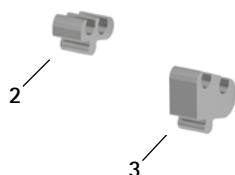

0° Flexion Stop Disc with Sliding Bushing, 10° Flexion Stop Disc with Sliding Bushing, Preassembled (4)

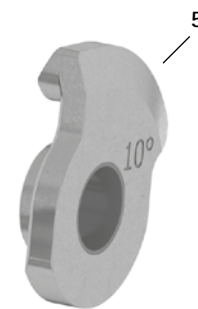

Accessory Parts

Item	Article Number for System Width 20mm	Description
2	SL9005-E000	0° extension stop
3	SL9005-E010	10° extension stop
4	SL0365-L	0° flexion stop disc with sliding bushing, left lateral
4	SL0365-R	0° flexion stop disc with sliding bushing, right lateral
5	SL0365-4L	10° flexion stop disc with sliding bushing, left lateral
5	SL0365-4R	10° flexion stop disc with sliding bushing, right lateral

Item	Article Number for System Width 20mm	Description	Unit
1	SL0935-L	assembly/lamination dummy, left lateral	piece
1	SL0935-R	assembly/lamination dummy, right lateral	piece

This diagram shows an exploded view of a mechanical assembly. The components are arranged in a sequence from left to right, indicating their assembly order. The parts include a long shaft, a small pin, a larger pin, a bracket, a pulley, a motor housing, and a callout '2' pointing to a specific part.

Item	Article Number for System Width 20mm	Description	Unit
2	SL0935-1	shaping dummy, left lateral and right lateral	piece

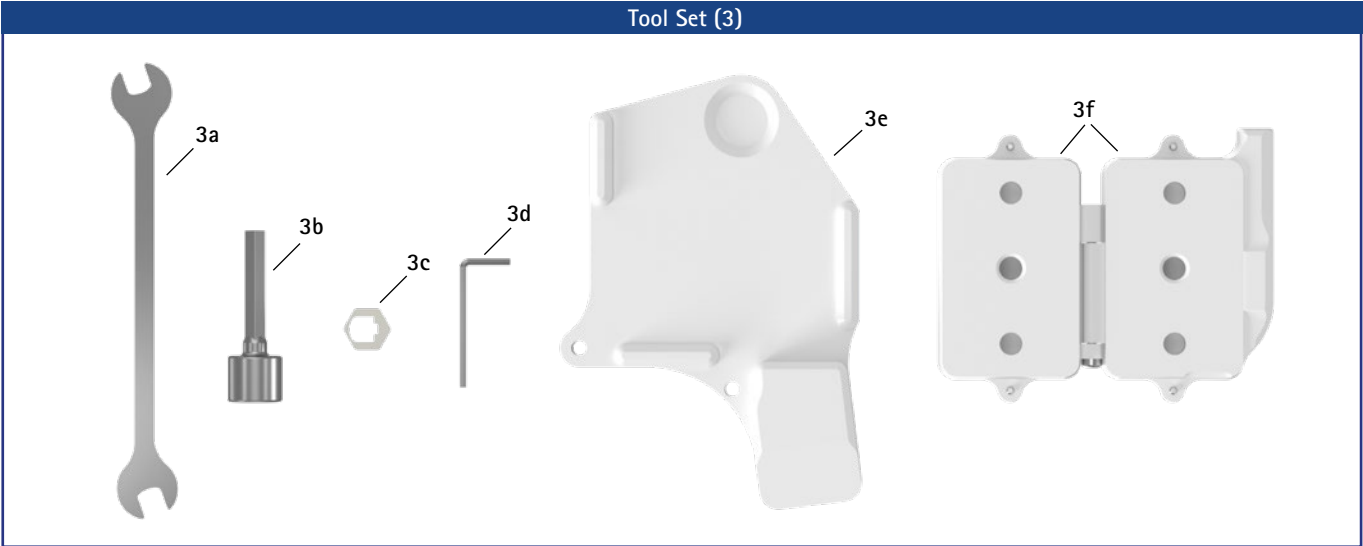

Tool Set			
Item	Article Number for System Width 20mm	Description	Unit
3	SL3005-WZ	tool set	set
3a	WZ5018-0612	double open-end wrench 6.5mm	piece
3b	WZ5602-A13	socket wrench insert 13mm, 1/4*	piece
3c	WE3055-SL	adaptor for socket wrench insert	piece
3d	WZ5611-I20	hexagon key wrench 2mm	piece
3e	SL0935-1	shaping dummy	piece
3f	ET0935	lamination dummy for controller, two parts*	set

* The components of the lamination dummy for controller are listed in the table below.

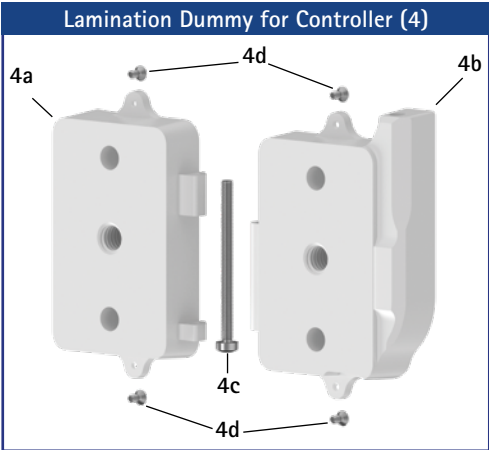

Lamination Dummy for Controller			
Item	Article Number for System Width 20mm	Description	Unit
4	ET0935	lamination dummy for controller, two parts	set
4a	ET0935-1	lamination dummy for controller, battery side	piece
4b	ET0935-2	lamination dummy for controller, cable side	piece
4c	SC0403-L40	pan head screw with hexalobular socket	piece
4d	SC1302-L04	countersunk flat head screw with cross recess H	piece

➔ You will find an overview of our tools on catalogue page J1ff.