



# RevoLock™ Lanyard by CLICK

## Diagnostic Fabrication Instructions



### Advisory

Must be installed by a professional trained in RevoLock™ fabrication. Lace will wear. At minimum, inspect monthly and replace every 6 months. Loss of suspension can occur if lace fails. Do not use on patients with nerve issues. Keep lace away from open flame and sharp edges. Secure insert to liner before tensioning system. See advisories in other languages [clickmedical.co/advisories](http://clickmedical.co/advisories)

### Disclaimer:

For diagnostic use only.  
Not intended for use outside of clinic.

- 1 Drill 5/16" (8mm) hole in distal end of plaster model.

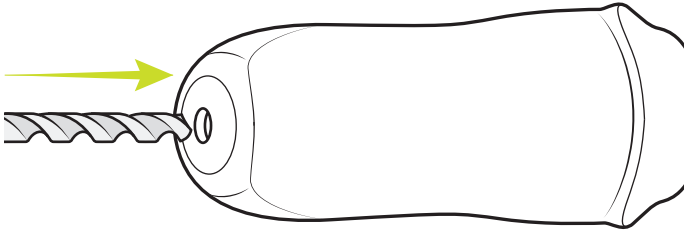

- 2 Insert fabrication post into hole. Secure with composite adhesive or plaster.

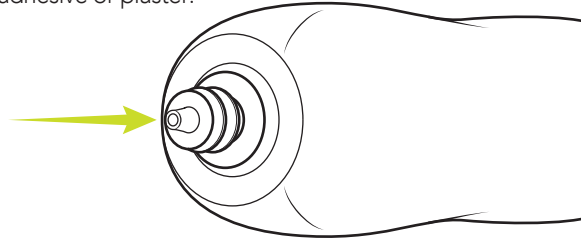

- 3 Pull nylon over mold. Tie nylon into groove of fabrication post. Slide housing onto post.

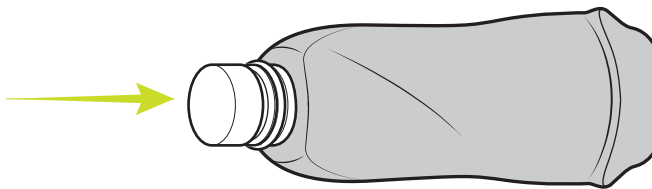

- 4 Fully insert set screw. Add O-ring.

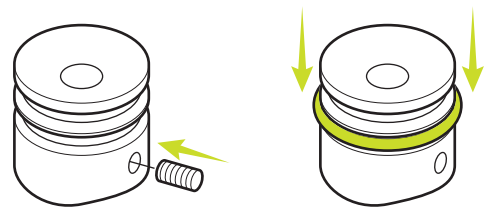

- 5 Pull plastic.

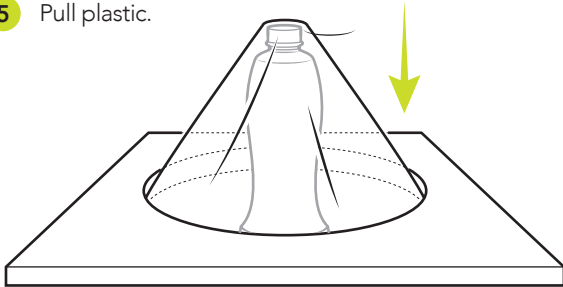

- 6 Tie around O-ring.



- 7 Drill with 1/4" bit to expose head of set screw.

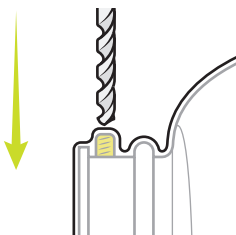

- 8 Extract bolt.

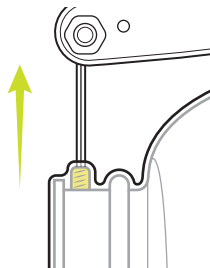

- 9 Sand entire socket.

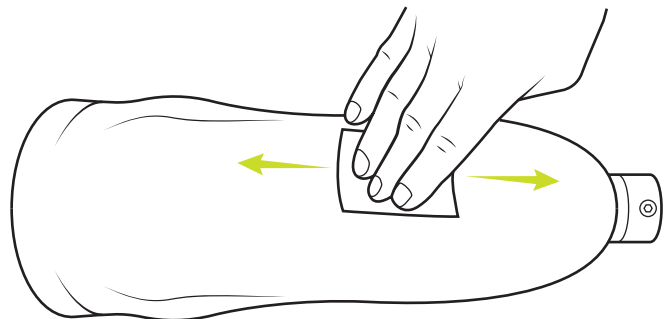

continued: ➡

→ continued:

- 10** Determine desired reel location.  
Use a composite adhesive to bond dummy to socket.

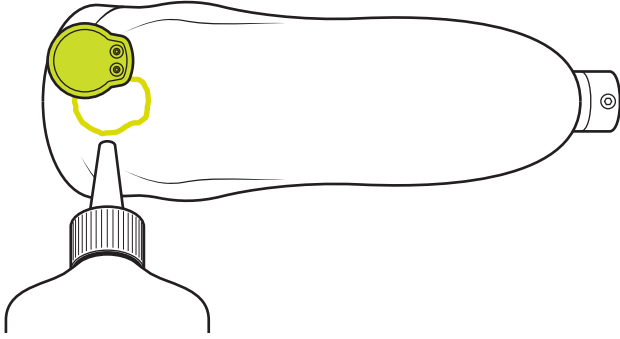

- 11** Insert tubing and spring into distal housing. Run free end of tubing to lamination dummy. Cut to length and insert tubing into dummy.

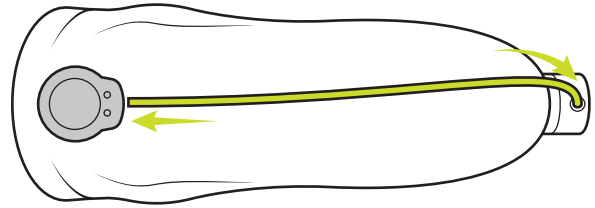

- 12** Use a composite adhesive to bond spring and tube to housing.

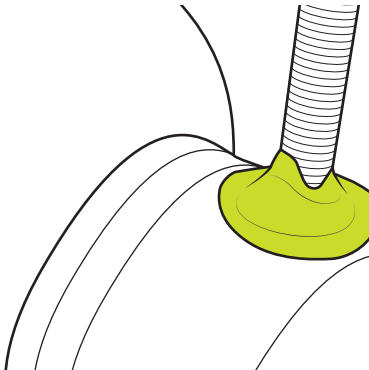

- 13** Bond tubing to plastic with adhesive. Bridge any gaps between tubing and socket.

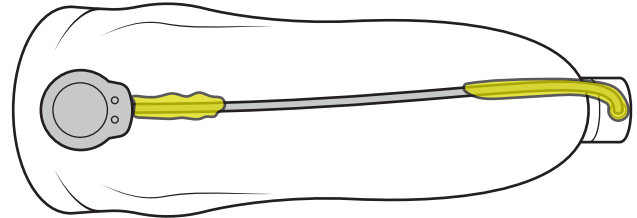

- 14** Tightly wrap socket with fiberglass cast tape.

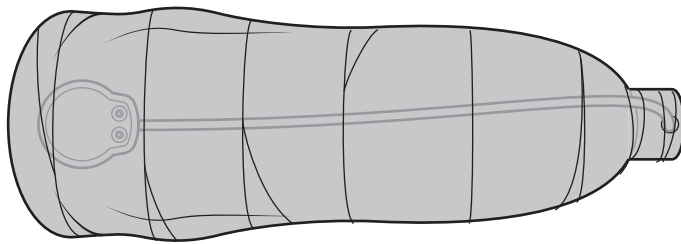

- 15** Grind down to dummy. Remove screws and dummy.

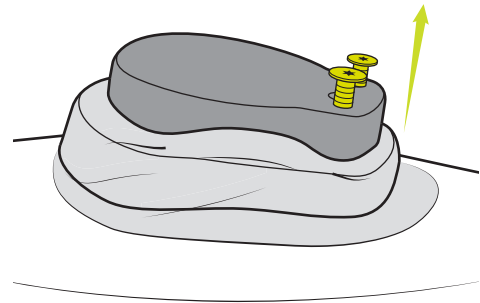

**\*\*Grind excess fiberglass, leaving a 3mm-tall lip\*\***

- 16** Remove model and lamination post.

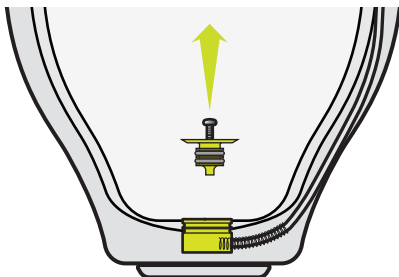

**\*\*See lamination instructions for reel attachment.\*\***

CONTINUE TO STEP 10 OF  
LAMINATION INSTRUCTIONS  
FOR REEL ATTACHMENT

|   |  |   |  |   |
|---|--|---|--|---|
|  | <b>WARRANTY:</b><br><a href="http://www.clickmedical.co/terms/#warranty">www.clickmedical.co/terms/#warranty</a><br><b>U.S. Customers:</b><br>Contact Click Medical directly<br>Help@ClickMedical.co<br>Help Line: +1 970 670 7012<br><b>International Customers:</b><br>Please contact your local distributor | <b>EC REP</b>   | <b>MDSS GmbH</b><br>Schiffgraben 41<br>30175 Hannover,<br>Germany  |  |
|   |  |  | Click Medical, LLC<br>1205 Hilltop Parkway, W101<br>Steamboat Springs, CO, 80487<br>USA<br>+1-970-670-7012 |   |