

BHA-603

Digital

Hearing Amplifier

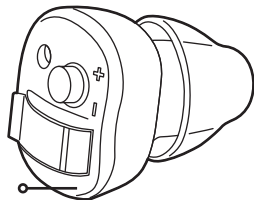

Operation Instructions

- 1 -

GETTING STARTED

Britzgo prides itself on providing the highest quality personal hearing amplifiers. Our amplifiers offer clear sound with noise reduction, and are backed by a full 1-year warranty.

WARRANTY INFORMATION

We stand behind our product 100%. If for any reason you're not satisfied, you may return your product for a full refund within 90 days or 12 months for exchange.

To request a refund or replacement please email help@britzgo.com or call (866) 360-4567

- 5 -

THE PACKAGING LIST

(Single: left or right)

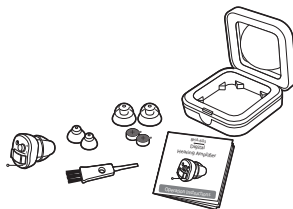

- x 1 Hearing Amplifier with 13 mm Dome
- x 2 Power One **P10** Zinc Air Battery
- x 1 Hard Protective Case
- x 1 9 mm Dome
- x 1 11 mm Dome
- x 1 Large Whistle Cancelling Double Dome
- x 1 Small Whistle Cancelling Double Dome
- x 1 Cleaning brush
- x 1 User Guide

- 2 -

SWITCH AMPLIFIER POWER ON/OFF

To turn the amplifier ON, close the door of the battery compartment. To turn the amplifier OFF, open the door of battery compartment either partially or totally.

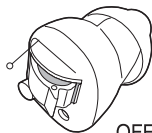
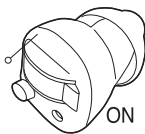

OFF

- 6 -

HEARING AMPLIFIER PARTS

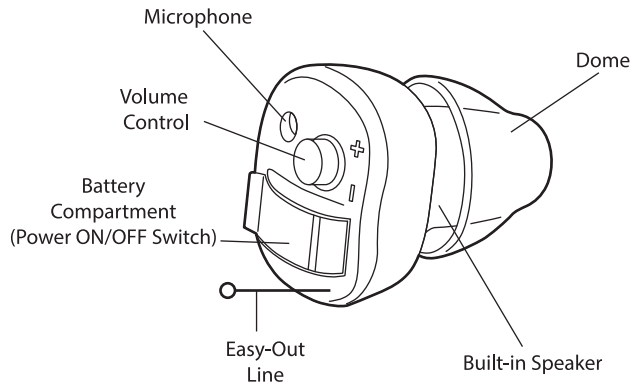

- 3 -

ADJUSTING VOLUME FOR AMPLIFIER

The digital Chip in your amplifier contains 4 levels of volume. The amplifier arrives with the volume in the lowest setting. This can be easily adjusted by one finger.

As the volume is adjusted you will hear an audible "Beep". The amount of "Beep's" indicate which volume you are in. The volume reverts to volume 1 after passing volume 4.

The amplifier will retain volume settings for next use.

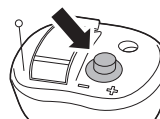

- 7 -

WEARING HEARING AMPLIFIER

Carefully remove any wax from your ear canal before inserting your device. This hearing device fits both the left and the right ear. Place the hearing amplifier over the top of your ear, so that the casing is behind your ear and the tube is in front.

Push the ear dome into your ear until it sits completely in the canal. The ear dome should be just inside the ear canal. If the ear dome is placed correctly you should not see it.

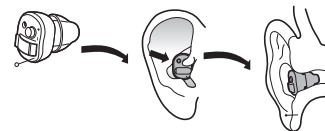

- 8 -

CHANGING AMPLIFIER DOMES

The ear dome can be easily pulled off from the amplifier and will immediately return to its original form.

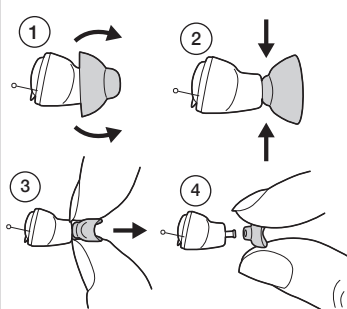

- 9 -

To install a new ear dome, turn inside out and press on to the Amplifier. Flip edge to its original form and ensure a snug fit.

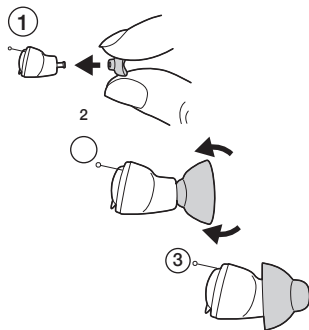

- 10 -

INSERT BATTERY IN AMPLIFIER

1. Open the battery gate at the bottom of amplifier
2. Place the battery in the holder with the sticker facing up
3. Remove the sticker and close battery gate
4. To replace the battery, follow steps 1-4

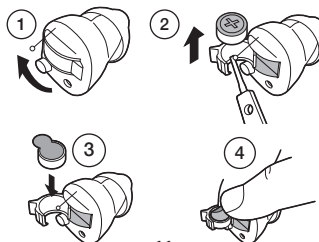

- 11 -

MAINTENANCE

- Keep free of Hairspray and Cosmetics, Remove if exposed
- Do not expose Amplifier to Heat and High temperatures
- Do not use a hair dryer while wearing the Amplifier
- Keep your amplifier in its case while not in use
- It is extremely harmful to expose the device to magnetic and high frequency fields so please remove the amplifier before exposing to an X-Ray machine or MRI.
- Do not leave your amplifier in direct sunlight while not in use
- Do not go swimming with your amplifier on or expose to water.
- Regular cleaning of the device with a lint-free cloth will help prolong its life.
- Keep ears clean and free of wax

- 12 -

TROUBLE SHOOTING

Why Can I hear a Whistle sound when I use the Amplifier?

To properly insert the hearing amplifier please turn down to lowest volume prior to inserting into the ear canal. While there might be an initial whistling this will clear when the ear dome is correctly fitted into the ear canal. There should be no space between the sides of the ear canal and the dome itself

What should I do if I hear no sound?

We recommend that you first try a new battery. After the new battery is installed try adjusting the volume up & down to see if there is any audible difference. If it is still not working please ensure ear dome are clean and not occluded by earwax or debris.

- 13 -

My amplifier works well, but the volume is too low.

Check that the volume cannot be turned up using the volume up button. The battery may be running out, try replacing with a new battery. Ensure that the dome are clean of any ear wax and occlusions.

My amplifier works well, but the volume is too loud.

Try adjusting the volume to its lowest level. If that does not work then you may have too good of hearing for the amplifier. Our amplifiers are not for everyone so if this is the case then please contact us and we will arrange for a return and full refund.

- 14 -

There is a disturbing noise in the background that will not go away

The device may need more breaking in, we recommend following our Hearing recovery plan to get your brain used to the new sound. If this does not help matter the unit may be defective.

We stand behind our product 100% so if this is the case please contact us and a replacement unit will be sent As Soon As possible.

ACCESSORIES

Britzgo offers a range of different sizes of domes and batteries available on the website : www.britzgo.com



- 15 -

FEEDBACK



At Britzgo we pride ourselves on our customer satisfaction.

If you are completely satisfied with your purchase we would greatly appreciate your feedback.

If you are not satisfied please allow us the opportunity to make it right. You may reach our customer service team by email at help@britzgo.com or by phone (866) 360-4567

Thank you for your purchase, it is appreciated

- 16 -