

## Surface Cleaner Instructions

**USE:** Cleaner for BASWAphon Applications.

**GENERAL INFORMATION:** BASWAphon Surface Cleaner consists of two separate components, the Main Solvent and the Booster Solution, which are mixed together just before use. After mixing, the product develops oxidation properties and serves to remove odors, stains and dirt, as well as inhibits corrosion. Contact BASWA acoustic before using on tinted applications.

### DIRECTIONS:



**1** Mix Booster Solution and Main Solvent in provided tray. Oxidation will begin.

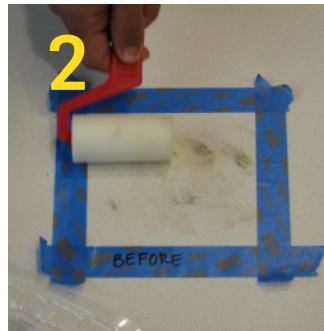

**2** Apply Cleaner to provided sponge roller and roll onto stained area.

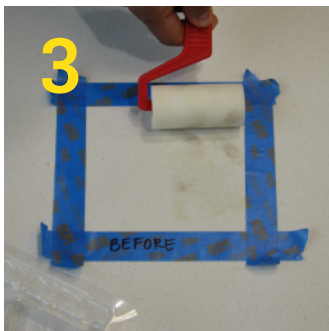

**3** After application has set for 15 seconds, stains will begin to lift.

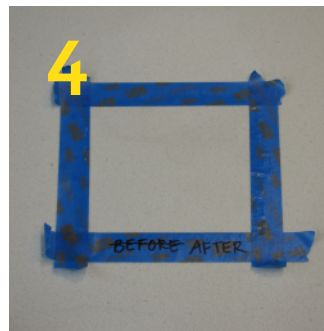

**4** Allow area to dry overnight. Evaluate results.

**SHELF LIFE:** Unmixed, BASWAphon Surface Cleaner has a shelf life of two (2) years. After mixing, it is best to use within one week. Be aware that oxidation while container is closed can cause a build up of gas.

**CAUTION:** Do not ingest. Avoid contact with eyes and skin. Wash hands after using. Keep containers closed when not in use. Do not transfer contents to other containers for storage. **KEEP OUT OF THE REACH OF CHILDREN**

**FIRST AID:** In case of eye contact, flush thoroughly with large amounts of water. Get medical attention if irritation persists. If swallowed, call Poison Control Center, hospital emergency room or physician immediately.

**BASWA acoustic North America, LLC**

21863 Aurora Road, Cleveland, Ohio 44146

855.90.BASWA | baswaphon.com |  @baswaacousticna